

DETAILS

Product Number	CN12931_LENA-W-DL
Family	Lena
Type	RefPack
Color	metal
Diameter	111 mm
Height	88.1 mm
Style	round
Optic Material	PC
Holder Material	PC
Fastening	socket, screw
Status	ready
ROHS Compliant	Yes
Date Updated	23/02/2014



OPTICAL PROPERTIES

LED	Viewing Angle	Light Beam	Efficiency	cd/lm	connector
LUXEON K12	45 degrees		74 %	1.400	-
LUXEON K16	46 degrees		72 %	1.300	-

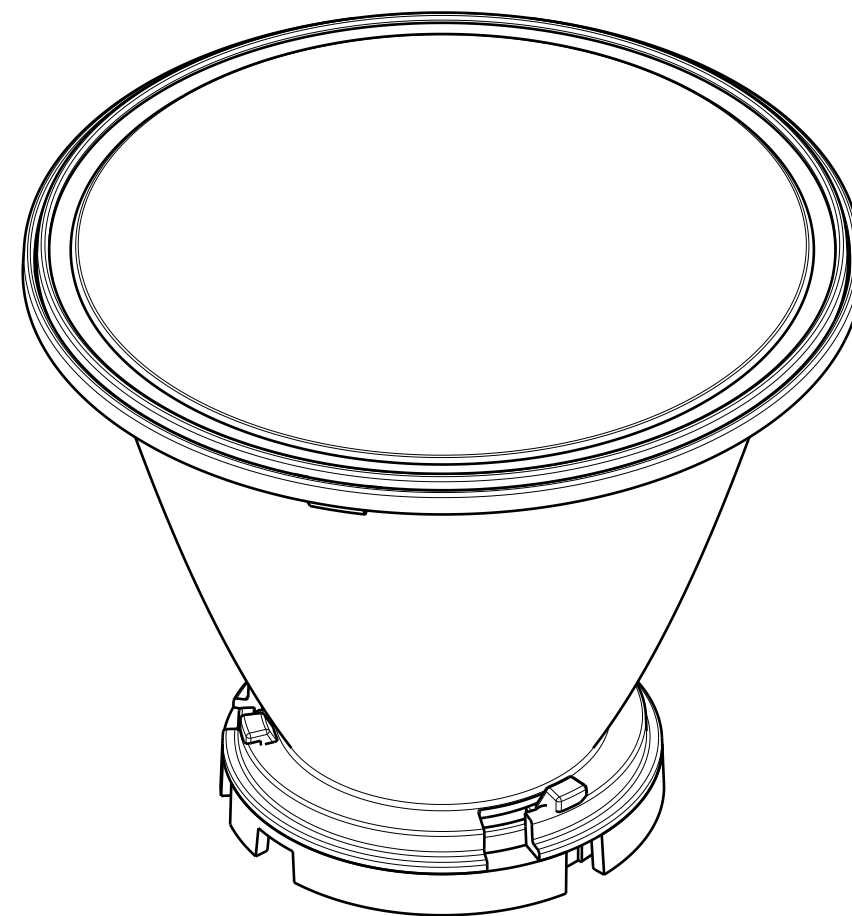
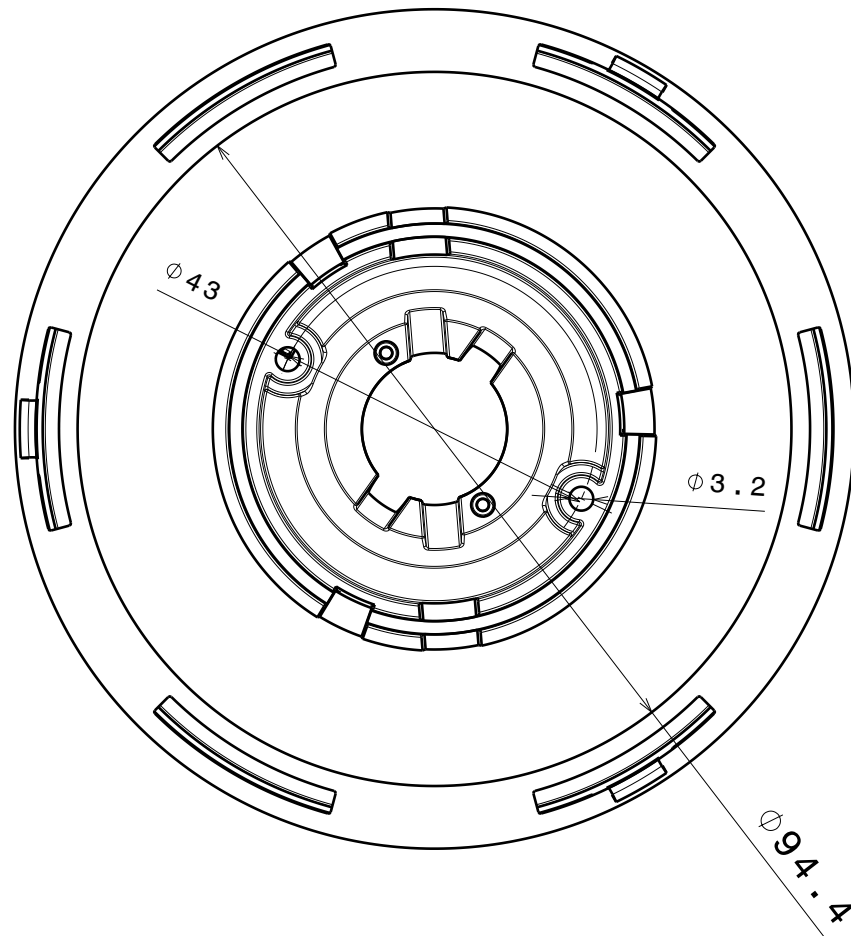
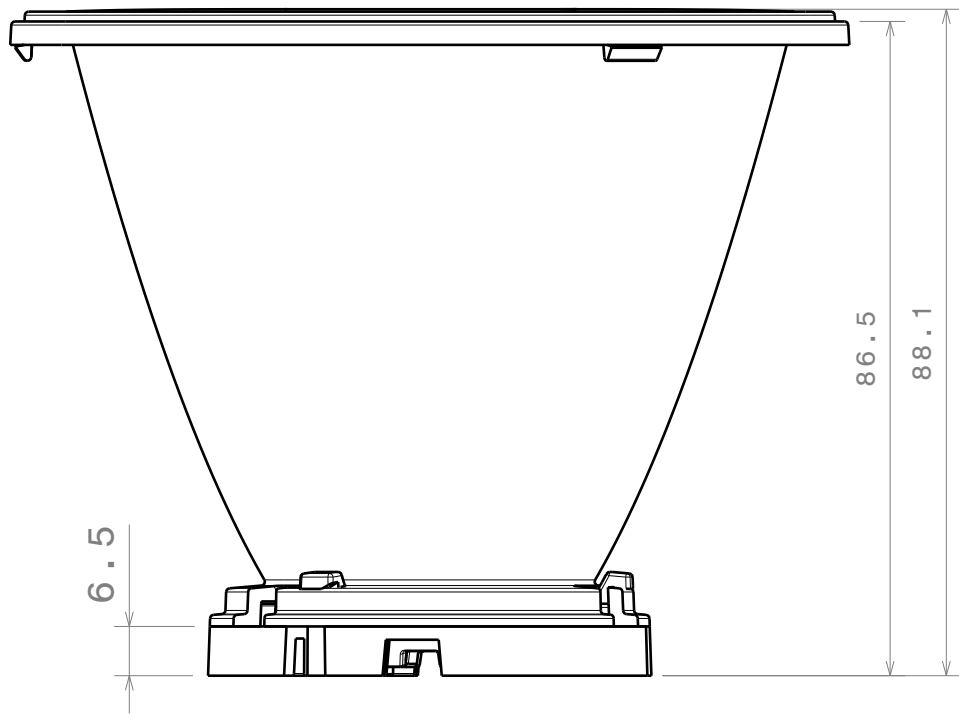

Isometric view

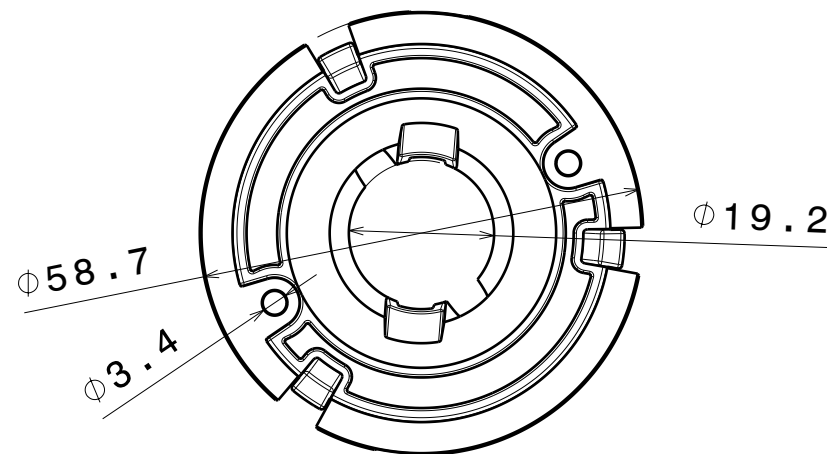
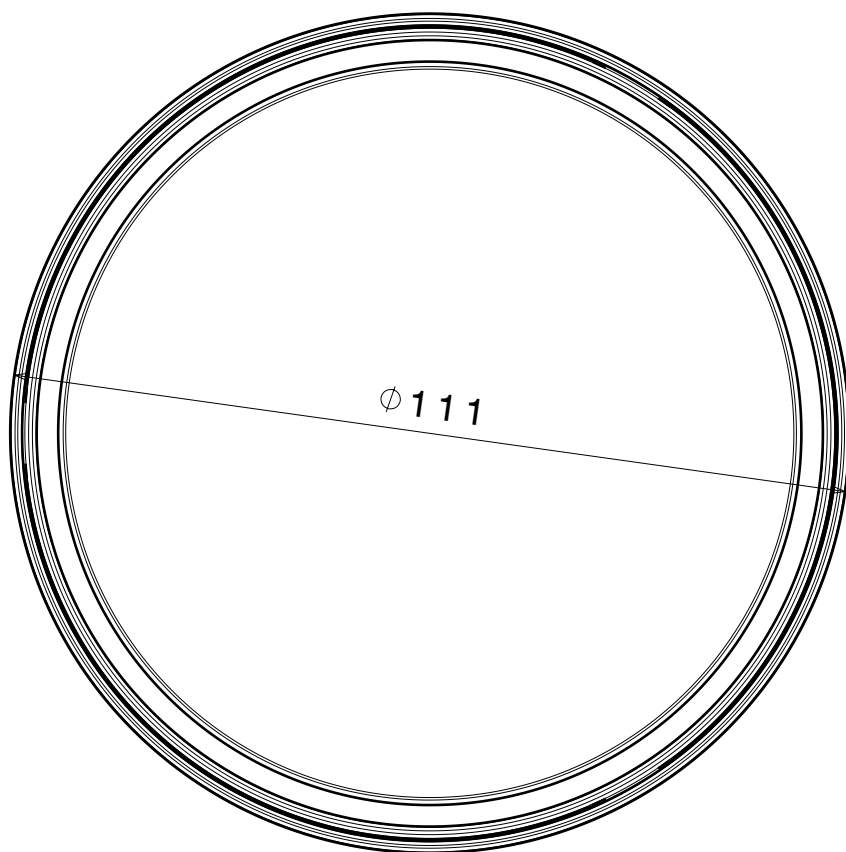

Material:

subLens
- PC

Reflector
- PC
- Metal coating and clear lacquer

Holder base
- PC
- Color white

Base part designed for
Philips Lumileds LUXEON K, 12up and 16up versions

This drawing is our property.
It can't be reproduced
or communicated without
our written agreement.



Ledil Oy
Salorankatu 10
FIN 24240 SALO
Finland

DRAWN BY	DATE
as	3.8.2012
CHECKED BY	DATE
VS	3.8.2012
DESIGNED BY	DATE
p1	-

DRAWING TITLE		Part Drawing	
LENA-LUXEON-K Mechanical drawing			
SIZE	PART NUMBER	REV	
A3		001	
SCALE	1:1	WEIGHT	SHEET 1/1

Luminaire: LEDiL Oy CN12931_LENA-W-DL_(Luxeon_K12) Eff.73.4%
Lamps: 1 x Luxeon K12 (808.51lm@250mA)

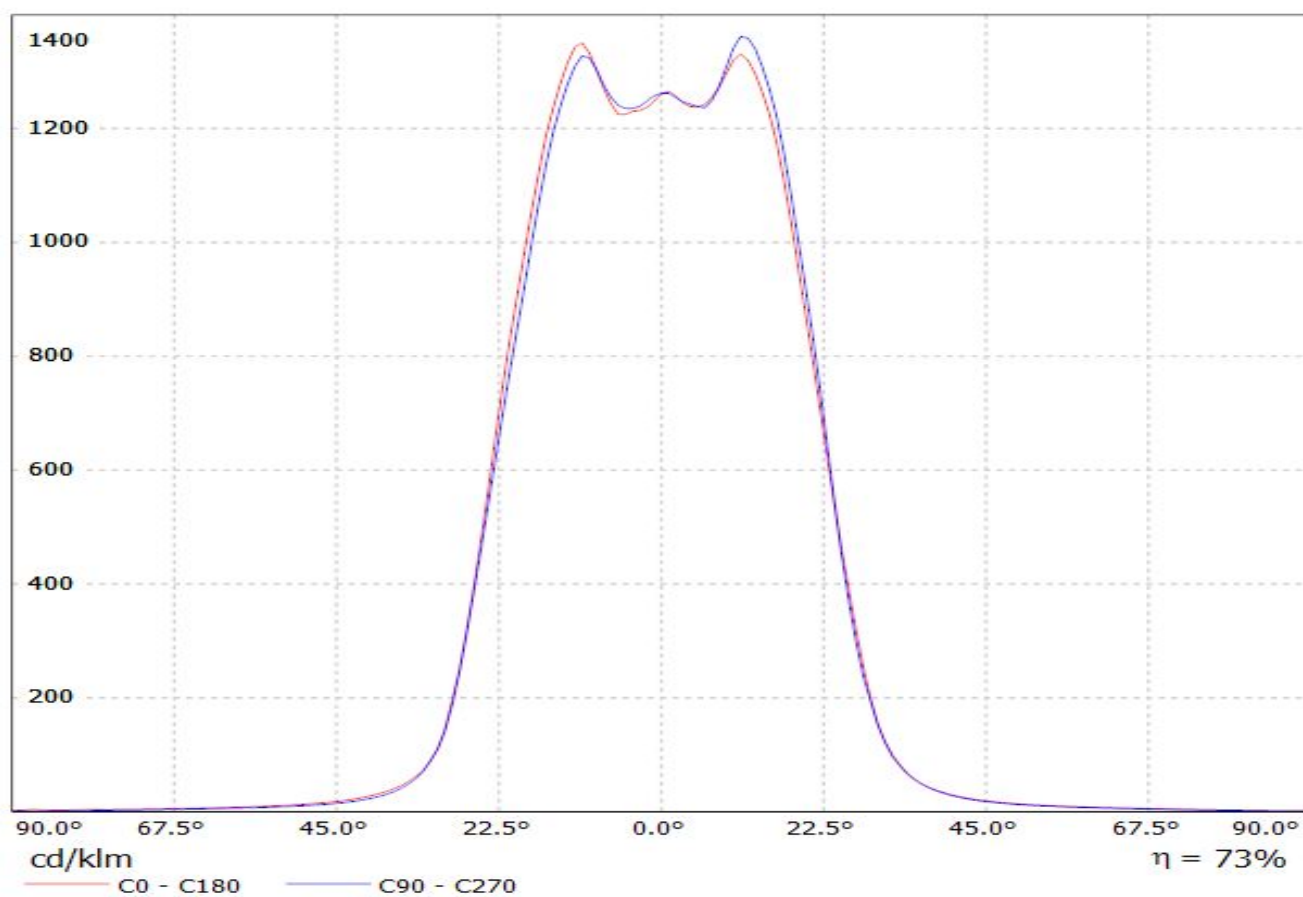

Luminaire: LEDiL Oy CN12931_LENA-W-DL_(Luxeon_K16) Eff.71.4%
Lamps: 1 x Luxeon_K16 (1208.05lm@250mA)

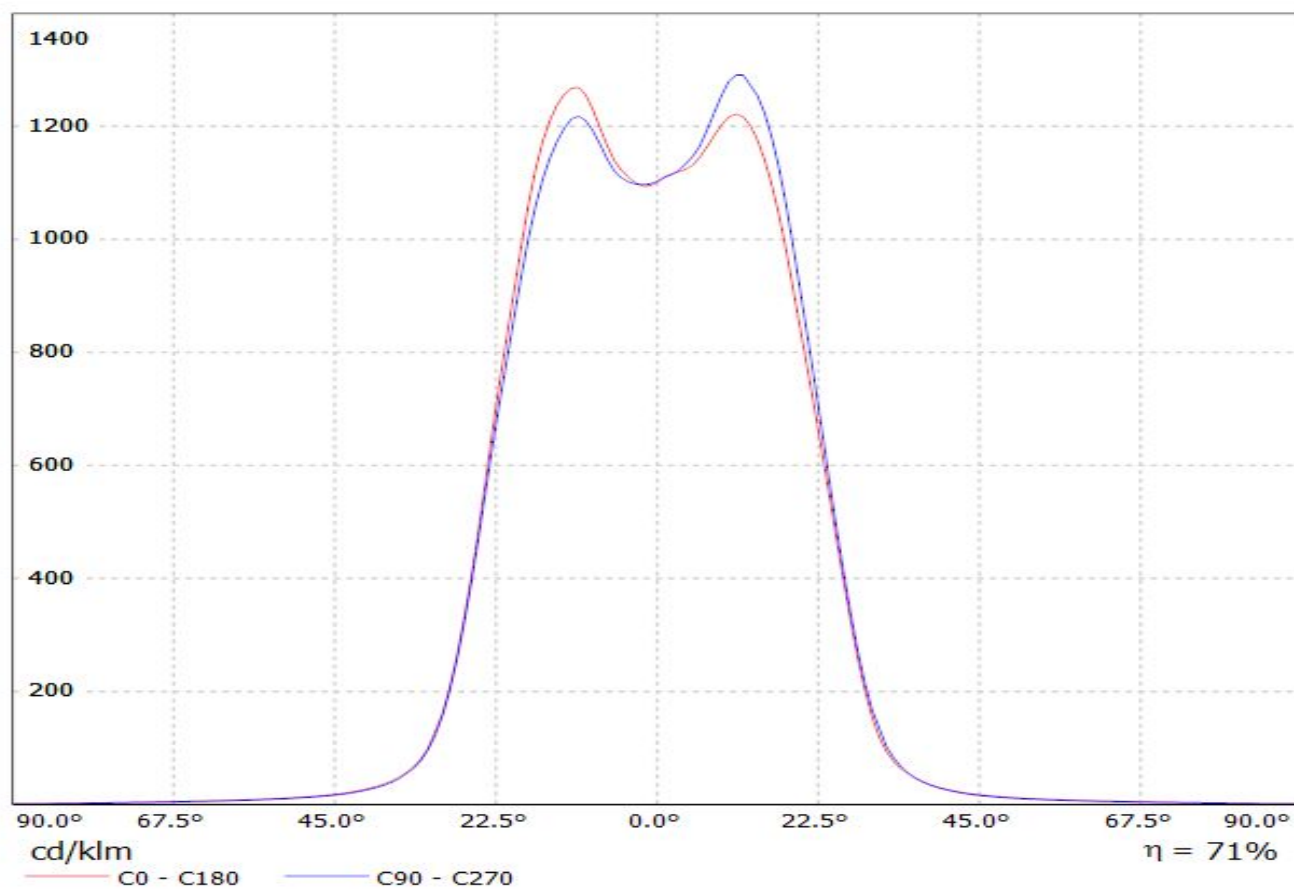

Luminaire: LEDiL Oy CN12931_LENA-W-DL_(Luxeon_K12) Eff.73.4%
Lamps: 1 x Luxeon K12 (808.51lm@250mA)

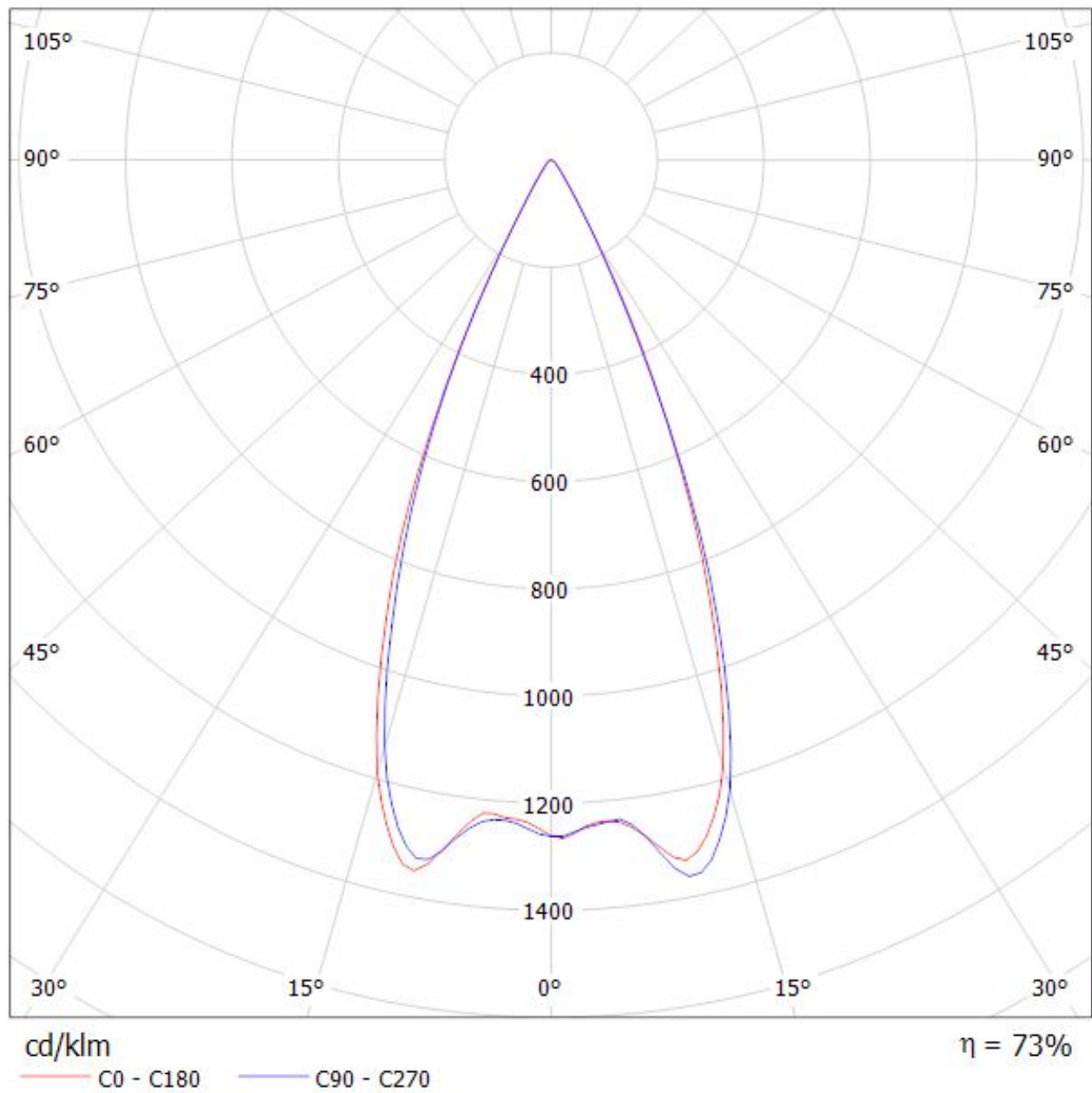

Luminaire: LEDiL Oy CN12931_LENA-W-DL_(Luxeon_K16) Eff.71.4%
Lamps: 1 x Luxeon_K16 (1208.05lm@250mA)

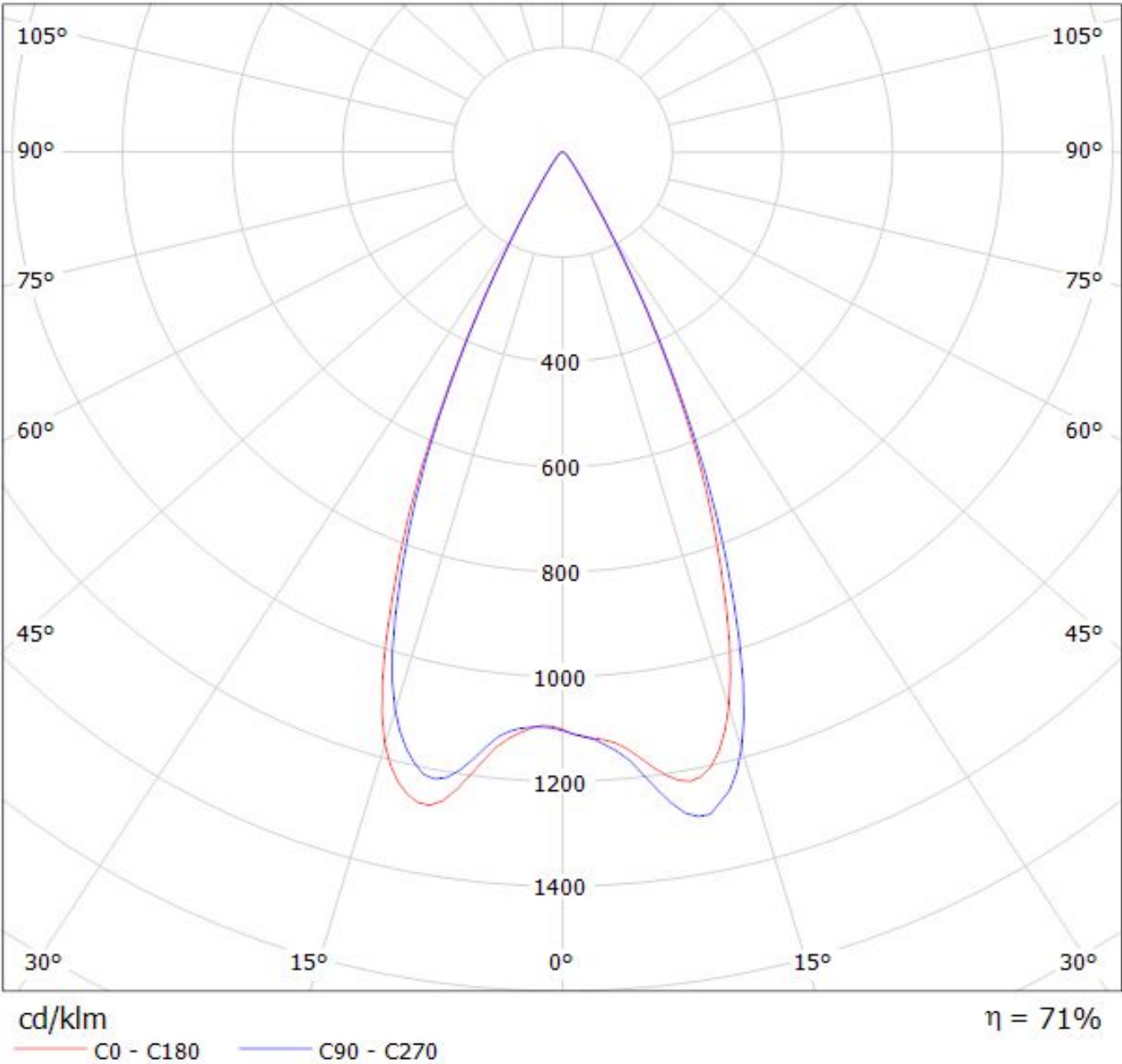

NOTE: The typical divergence will be changed by different color, chip size and chip position tolerance. The typical total divergence is the full angle measured where the luminous intensity is half of the peak value.

GENERAL INFORMATION

- Product series especially designed & optimized for series of LEDs.
- Special care taken to make light distribution as uniform as possible.
- Reflector is made of aluminium coated PC (120 degrees of Celcius / 248 degrees of Fahrenheit) with protective lacquer (short term 100 degrees of Celcius / 212 degrees of Fahrenheit).