

# P25SMT

SMT GULL WING SURFACE MOUNT  
TECHNOLOGY



## FEATURES

- 2.5mm height
- 7.0mm length
- lateral C-contact
- contacts with abrasion resistant hard gold plating
- solid, tinned PCB pins

Solid PCB pins ensure trouble-free assembly and safe connection. Contacts with abrasion resistant hard gold plating have low and stable contact resistance. ISO 9001:2000 approved production together with 100% electronic final inspection and testing guarantee reliable operation. Figures are clearly visible and detention mechanism is precise for fast and easy operation.

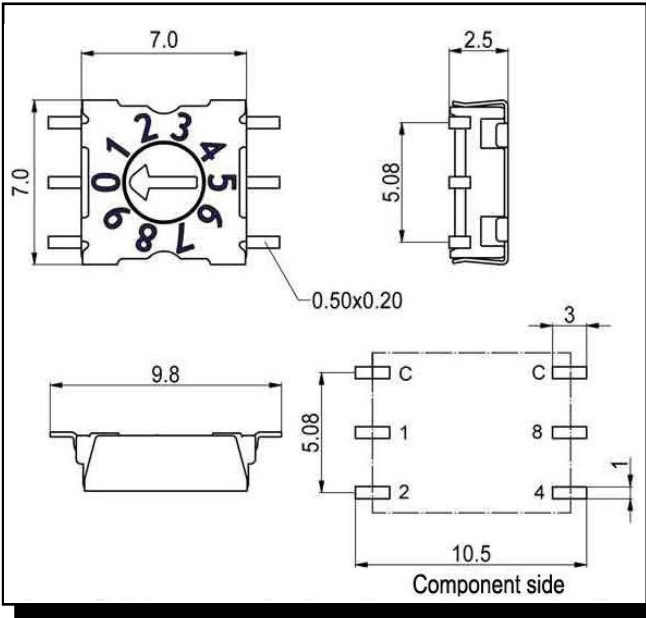

## GENERAL SPECIFICATIONS

### MECHANICAL DATA

Type	horizontal
Fixation mode	SMT
Height	2.5 mm
Length	7.0 mm
Width	7.0 mm
Pin connection	3+3
Perm. ambient temperature	-50 ... +125 °C
Perm. storage temperature	-55 ... +135 °C
Torque	min. 0.7 Ncm
Positions per rotation	10, 16
Shock and vibration testing	acc. DIN IEC 60068
Humidity	21 days at 40°C, 93%RH

### ELECTRICAL DATA

Operating voltage	≤ 42 V
Contact load, static	≤ 0.4 A
Contact load, dynamic	≤ 0.1 A
Minimum load	1µA 20mVDC
Test voltage	250V 50Hz/1min
Contact resistance	< 80 mΩ
Insulation resistance	> 100 MΩ

### CODES

	Pos	Rotor	Code
BCD	10	red	○ Code: P25SMT _ 01 _ _
BCD Complement	10	orange	○ Code: P25SMT _ 02 _ _
Hexadecimal	16	grey	○ Code: P25SMT _ 03 _ _
Hexadecimal Complement	16	white	○ Code: P25SMT _ 06 _ _



Arrow shaped slot  
○ Code: P25SMT 1 \_ \_



Spindle  
○ Code: P25SMT 3 \_ \_



Slotted spindle  
○ Code: P25SMT 8 \_ \_