

DOOR-COUPLING ROTARY MECHANISM IP64,
EMERGENCY STOP, SIZE S00...S3,
330 MM SHAFT

General technical data:

product brand name		SIRIUS
product designation		door-coupling rotary operating mechanism
Design of the product		EMERGENCY OFF door-coupling rotary operating mechanism
Design of activation		long shaft
Acceptability for application		Circuit breaker S00, S0, S2, S3
Protection class IP / on the front		IP64
Ambient temperature		
• during storage	°C	-50 ... +80
• during operating	°C	-20 ... +70
Operating cycles / maximum	1/h	15
Color / of the activation element		red / yellow

Installation/mounting/dimensions:

mounting position		any
Type of mounting		screw fixing
Width	mm	66
Height	mm	66
Depth	mm	50

Length	mm	330
Diameter	mm	22.5
Distance, to be maintained, to earthed part		
• forwards	mm	0
• backwards	mm	0
• upwards	mm	0
• sideways	mm	0
• downwards	mm	0

Certificates/approvals:

Verification of suitability

CE / UL / CSA

Shipping Approval

other



[other](#)

Further information:

Information- and Downloadcenter (Catalogs, Brochures,...)

<http://www.siemens.com/industrial-controls/catalogs>

Industry Mall (Online ordering system)

<http://www.siemens.com/industrial-controls/mall>

CAX-Online-Generator

<http://www.siemens.com/cax>

Service&Support (Manuals, Certificates, Characteristics, FAQs,...)

<http://support.automation.siemens.com/WW/view/en/3RV2926-0L/all>

Image database (product images, 2D dimension drawings, 3D models, device circuit diagrams, ...)

http://www.automation.siemens.com/bilddb/cax_en.aspx?mlfb=3RV2926-0L

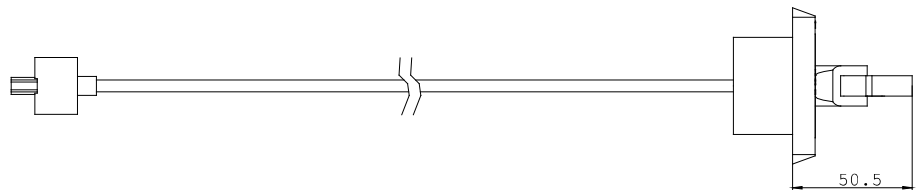
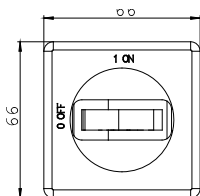

last change:

Jul 17, 2012