

Materials and Finish

Shell: Stell, Stainless Steel
Tin/Lead Plating

Insulator: UL94V-0 Rated
PBT Thermoplastic
Color- Black

Contacts: Phosphor Bronze
Plating- 0.76um (30u")
Gold on Contact Area,
3.8um (150u") Tin/Lead
on Solder Tail, all over
1.27um (50u") Nickel

Mechanical Specifications

Durability: >1000 cycles

Mating Force:
20 Newtons maximum

Withdrawal Force:
5 Newtons minimum

Electrical Specifications

Voltage Rating: 30VAC (rms)

Current Rating:
1A max. per contact not
to exceed 30°C Temp. rise

Dielectric Withstanding Voltage:
750VAC @ sea level

Capacitance:
2pF maximum

Contact Resistance:
less than 30 milliohms
per contact pair after
1500 mating cycles.

Insulation Resistance:
Greater than 100 Megohms

Operating Temperature:
-55°C to + 85°C

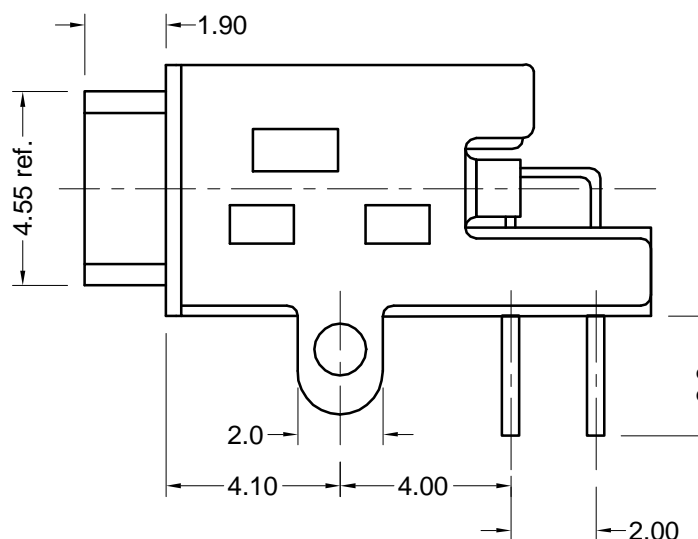
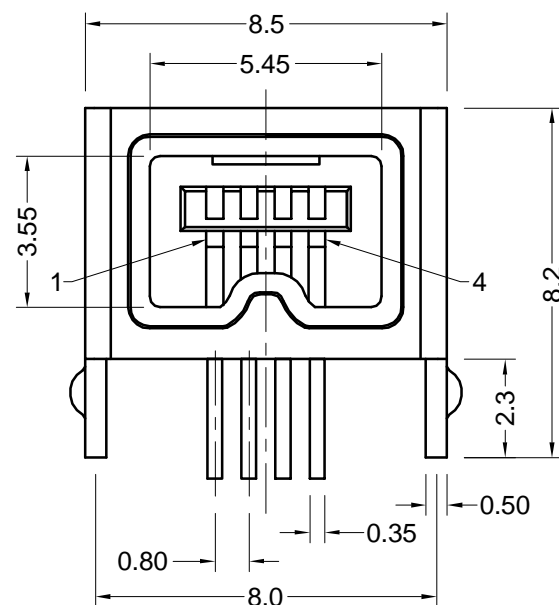
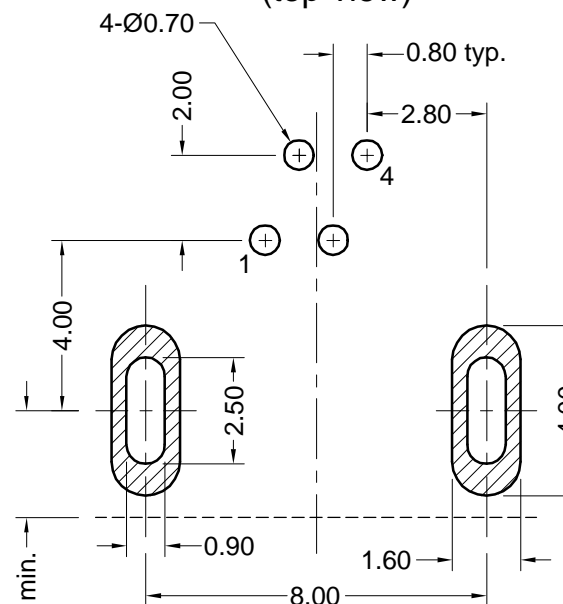

Tolerances	
X.X ± 0.25	
X.XX ± 0.15	
Unless Stated Otherwise	

**Recommended PCB Layout
(top view)**

REVISION	DATE	DESCRIPTION	DRAWN BY	CHECKED BY	UNITS	KMFS-PR-201B-30	4-pin Firewire IEEE 1394a Socket Right Angle, Black, 30u" Au, for 1.6mm PCBs	
A1	11/7/01	Release DWG	C. Leiva		mm			
A2	4/11/02	ECD #01-217	REVISED BY	APPROVED BY	DATE			
A3	5/10/02	ECD #02-057	C. Leiva		10/26/01			

Mouser Electronics

Authorized Distributor

Click to View Pricing, Inventory, Delivery & Lifecycle Information:

[Kycon:](#)

[KMFS-PR-201B-30](#)