

DATA MCS 18 SWITCHES – MOMENTARY ACTION

BENEFITS

- Absolutely unique, extremely low design
- Almost flush with the front plate
- High-quality gold and silver contacts
- Excellent price/performance ratio
- Available with various colours and lettering
- Reliable tactile feedback
- Ideal switch for applications with 2 to 6 keypoints
- Suitable for highly versatile applications

		MCS 18 gold contacts	MCS 18 silver contacts
Electrical data			
Contact material		gold	silver
Switching voltage	[mV]	min. 50 DC	min. 5V DC
	[V]	max. 24 DC	max. 48 DC
Switching current max.	[mA]	80	125
Rated breaking capacity	[W]	0.36	0.72
Lifetime (at rated breaking capacity)		> 10 ⁶	> 10 ⁶
Initial contact resistance, new	[mΩ]	< 50	< 50
Initial contact resistance, after lifetime	[mΩ]	< 150	< 150
Insulation resistance	[Ω]	> 10 ⁸	> 10 ⁸
Contact bounce time	[ms]	typ. 0.1	typ. 0.1
Mechanical data			
Actuating force	[N]	3 ± 1	3 ± 1
Contact travel	[mm]	0.5 ± 0.1	0.5 ± 0.1
End stop strength	[N]	> 50	> 50
Lifetime	[operations]	> 10 ⁶	> 10 ⁶
Other data			
Solderability	[°C/s]	235 / 2	235 / 2
Soldering heat resistance	[°C/s]	260 / 5	260 / 5
Ambient temperature	[°C]	-25 – +60	-25 – +60
Storage temperature	[°C]	-25 – +60	-25 – +60
Degree of protection		IP 65	IP 65
Materials			
Socket		Thermoplast PES	Thermoplast PES
Face foil		PETP	PETP
Bezel		Thermoplast PBTP	Thermoplast PBTP
Contact material gold / silver	[μm]	CuZn 37, 3 μm Ni 2 μm Au	CuZn 37, 2.5 μm Ag

OVERVIEW MCS 18 SWITCHES – MOMENTARY ACTION



Specification for lettering,
see page 29.

MCS 18

MCS 18

FEATURES

Contact material	Ag	Au
Degree of protection	IP 65	IP 65

PART NUMBER *

square	1241.1108.	x	xxx	1241.1109.	x	xxx
round	1241.1110.	x	xxx	1241.1111.	x	xxx
Colour of bezel						
red		3			3	
grey		6			6	
black		7			7	
Colour of face foil without legend						
yellow			091			091
red			093			093
green			095			095
grey			096			096
black			097			097
white			098			098
Standard lettering						
Order index	see page 29			see page 29		

Dimensions:

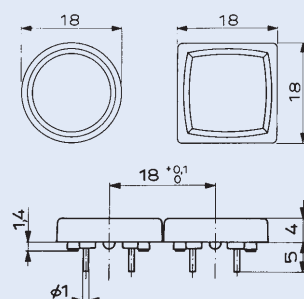

Drilling diagram:

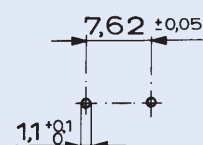

Circuit diagram:

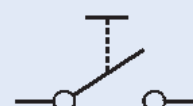

* X in the Part No. must be replaced by the desired version



LETTERING

Depending on the application and font, there are various lettering possibilities. The following standards can be used for key letterings:

ORDER INDEX LETTERING

A = 001	P = 016	4 = 031	↕ = 046	EIN = 061
B = 002	Q = 017	5 = 032	→ = 047	AUS = 062
C = 003	R = 018	6 = 033	← = 048	AUF = 063
D = 004	S = 019	7 = 034	↓ = 049	AB = 064
E = 005	T = 020	8 = 035	↑ = 050	ON = 065
F = 006	U = 021	9 = 036	% = 051	OFF = 066
G = 007	V = 022	+ = 037	√ = 052	UP = 067
H = 008	W = 023	- = 038	CTRL = 053	DOWN = 068
I = 009	X = 024	· = 039	RETURN = 054	HIGH = 069
J = 010	Y = 025	x = 040	SHIFT = 055	LOW = 070
K = 011	Z = 026	÷ = 041	LOCK = 056	ON/OFF = 071
L = 012	0 = 027	* = 042	STOP = 057	START = 072
M = 013	1 = 028	= = 043	ENTER = 058	
N = 014	2 = 029	# = 044	BACK = 059	
O = 015	3 = 030	↔ = 045	LINE = 060	

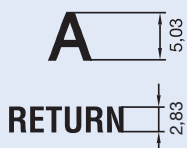

MCS 18, LETTER HEIGHTS AND FONTS

- Single characters, Univers 65
- Legends max. 6 characters in line, Univers 65
- Insert label and front foil anthracite, RAL 7016
- Characters and symbols light grey, RAL 7035

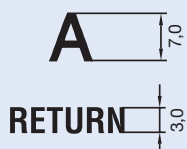

SSM 27, LETTER HEIGHTS AND FONTS

- Single characters, Univers 65
- Legends max. 6 characters in line, Akzident-Grotesk condensed bold type
- Front foil anthracite, RAL 7016
- Characters and symbols light grey, RAL 7035