

**Product number** FN13323_STELLA-A

Family	STELLA
Type	Pack
LED	CLL03x/CLU034
Color	Black
Diameter	90 mm
Height	22 mm
Style	Round
Optic Material	Silicone
Holder Material	PA66GF30
Fastening	Screw
Status	On production

FWHM	Asymmetric degrees
Efficiency	92 %
cd/lm	0.616
Gerber File	Available

Suggested distance between the lenses 5 mm minimum

NOTE: The typical divergence will be changed by different color, chip size and chip position tolerance. The typical total divergence is the full angle measured where the luminous intensity is half of the peak value.

II

⌊

W

m

A

Front view

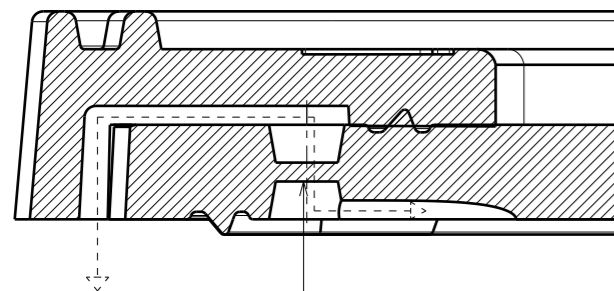
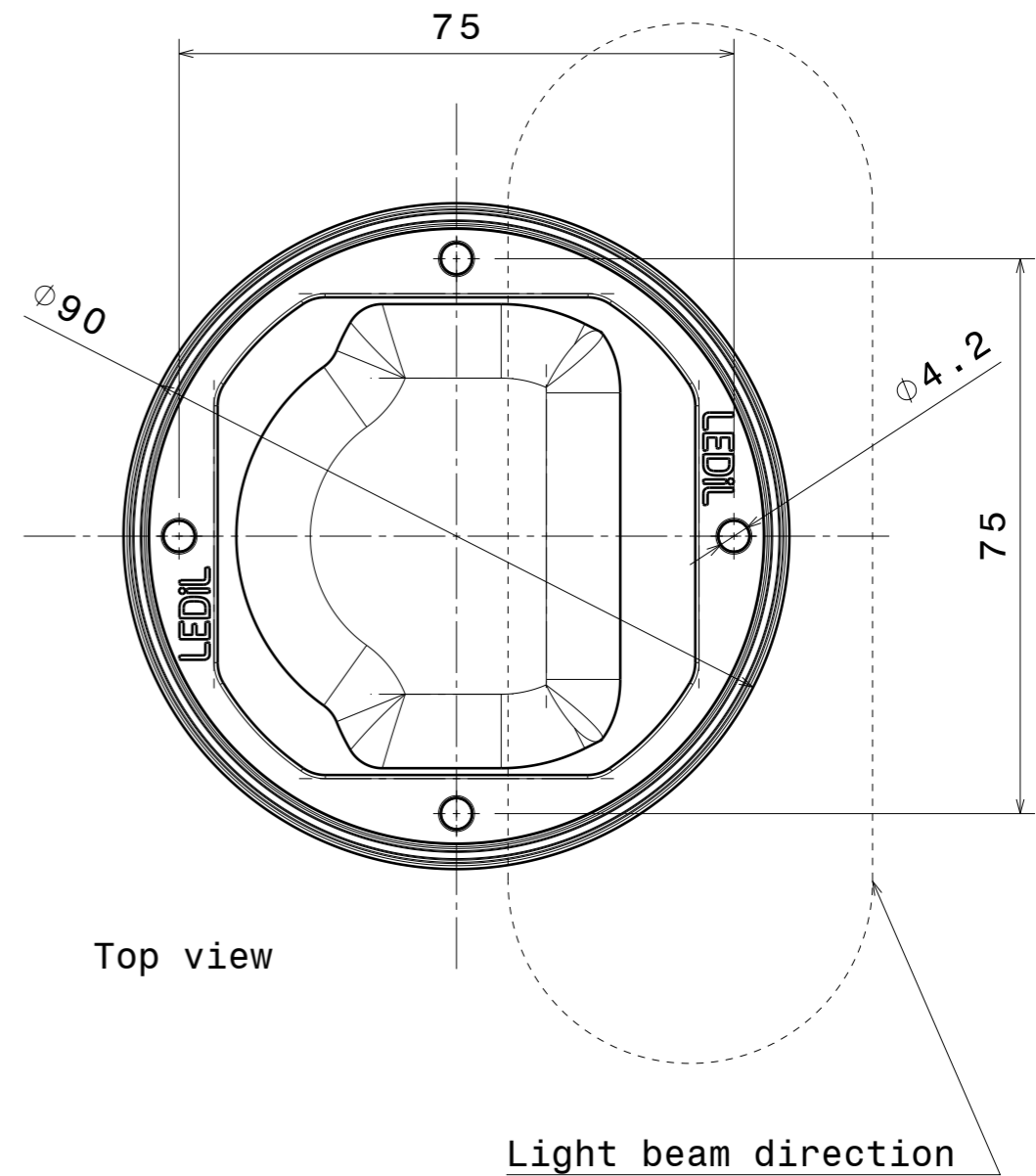
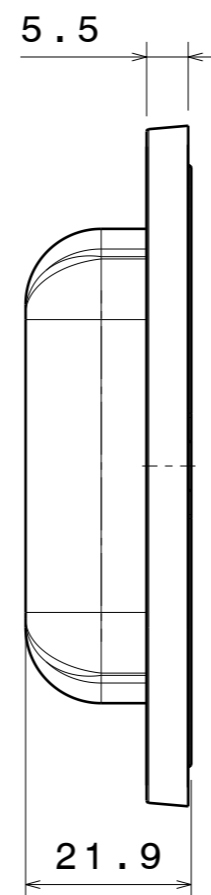
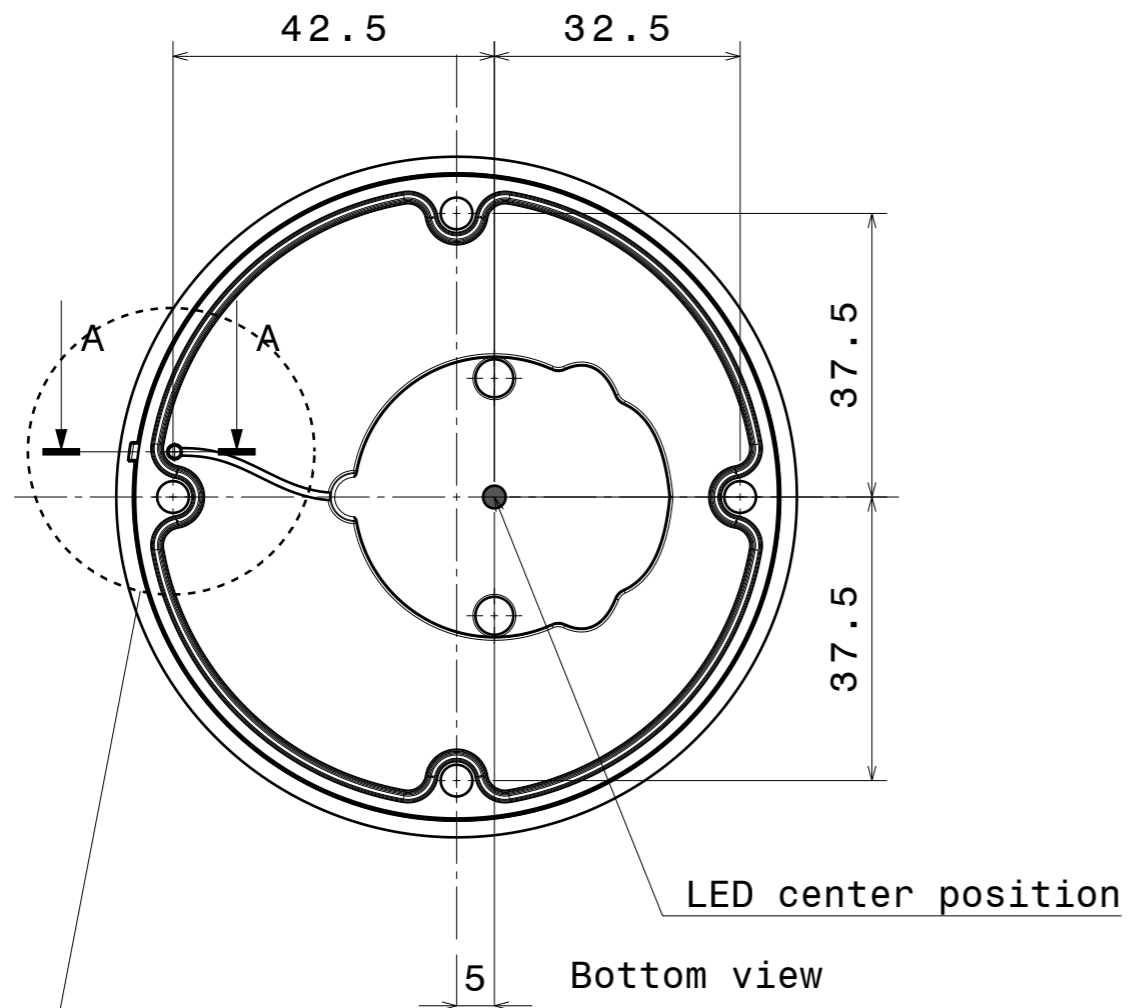

Section view A-A
Scale: 5:1

Venting pipe:
Piercing this membrane
will Allow lens breathing

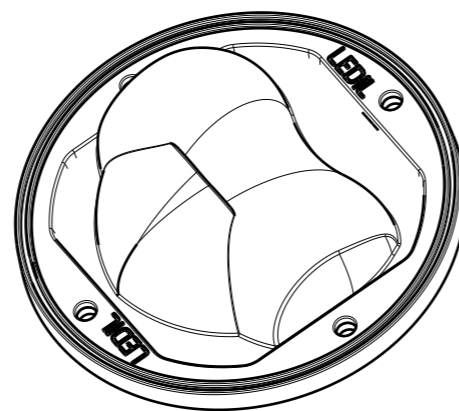

Isometric view

Lens material:	Optical grade LSR
Frame material:	PA66GF30, black

Tolerances if not otherwise shown
According to DIN ISO 2768-1
Linear measures:
Up to 30mm class M, otherwise class C.
According to DIN ISO 2768-2
Form and position: class L



Ledil Oy
Salorankatu 10
FIN 24240 SALO
Finland

THIRD ANGLE PROJECTION:

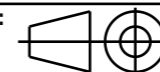

	DRAWING TITLE
--	---------------

STELLA-A datasheet

This drawing is the property of LEDiL Oy. It may not be reproduced, copied or communicated without a written agreement with LEDiL Oy."

SIZE	A3
------	----

PART NUMBER

FN13323

SCALE

1:1 | WEIGHT

(g)

SHEET 1 / 1

H

G

B

A

4

3

2

1

Luminaire: LEDiL Oy FN13323_STELLA-A_(CLL030) Eff. 92%

Lamps: 1 x Citizen_CLL030_(CLL030-1205A5-303H1A7) 690lm@250mA CCT=3000K P=9W I=250mA

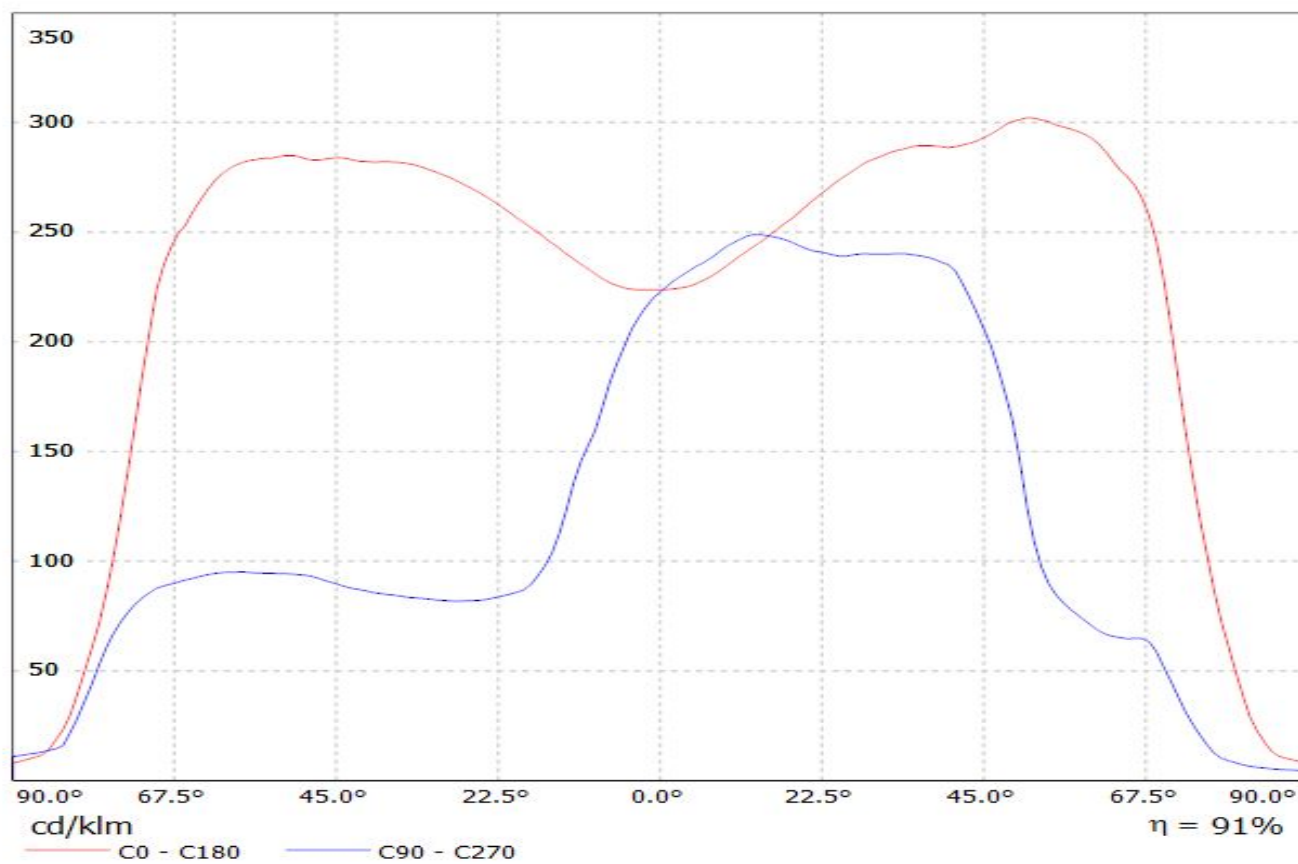

Luminaire: LEDiL Oy FN13323_STELLA-A_(CLL030) Eff. 92%

Lamps: 1 x Citizen_CLL030_(CLL030-1205A5-303H1A7) 690lm@250mA CCT=3000K P=9W I=250mA

