

HEX NUT AND WASHER SHIPPED UNASSEMBLED

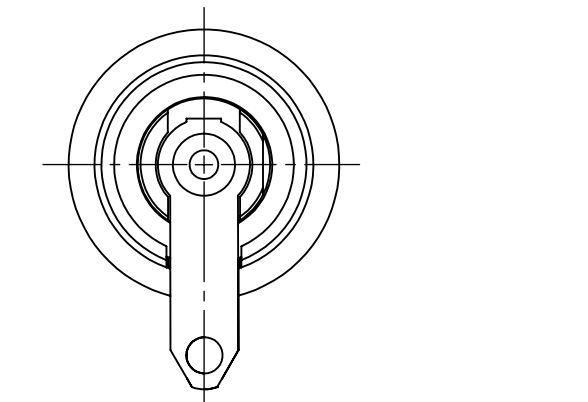
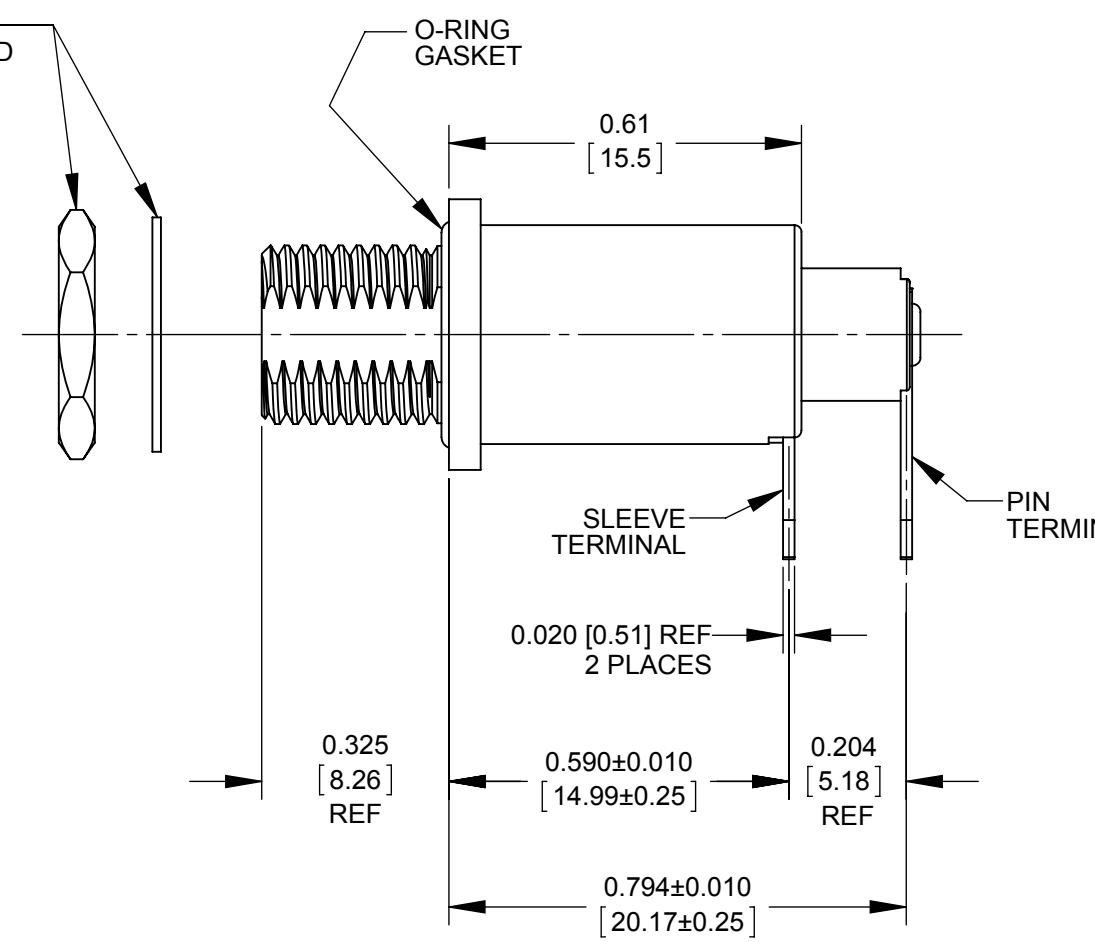

PIN

SLEEVE

SCHEMATIC

CUSTOMER DRAWING

NOTES:

1. MATERIALS:

BUSHING/HOUSING - COPPER ALLOY, NICKEL PLATED
INSULATOR - THERMOPLASTIC, BLACK
TERMINALS - COPPER ALLOY, MATTE TIN PLATED
CENTER CONTACT PIN - COPPER ALLOY, GOLD PLATED
SLEEVE CONTACT - COPPER ALLOY, GOLD PLATED
O-RINGS - THERMOPLASTIC RUBBER
HEX NUT - COPPER ALLOY, NICKEL PLATED
WASHER - STEEL, NICKEL PLATED

2. THIS PRODUCT IS RoHS COMPLIANT.

REV	ECO NUMBER	DATE	BY	APVD
A	27391	11-10-14	PC	TJK
REVISIONS				

UNLESS OTHERWISE SPECIFIED				
1. ALL DIMENSIONS IN INCHES [mm]				
- TWO PLACE DECIMALS ± 0.02 [0.5]				
- THREE PLACE DECIMALS ± 0.005 [0.13]				
DO NOT SCALE DRAWING				

THIS DRAWING DESCRIBES A DESIGN CONSIDERED PROPRIETARY IN NATURE, DEVELOPED AND MANUFACTURED BY SWITCHCRAFT INC. AND IS RELEASED ON A CONFIDENTIAL BASIS FOR IDENTIFICATION PURPOSES ONLY.									
SIZE		WIDTH		MULT		LBS/M		TEMPER	
FINISH SPEC No.					MATERIAL SPEC No.				
FIRST USED ON				SCALE 3:1		Switchcraft®			
DATE DRAWN	BY	CHKD		APVD					
9-26-13	SRC	SRC		SRC					
9-26-13		9-26-13		11-10-14		SHEET 1 OF 1			
NAME RIGHT ANGLE SEALED 10 AMP POWER JACK, RoHS					PART No. RAPC10U				REV A