

# Digi Connect® Wi-Wave

802.11b/g Radio Card for Embedded Systems

Highly integrated 802.11b/g WLAN card with USB interface for embedded applications offers secure wireless network connectivity and long-term product availability.



## Overview

Built using Digi's own 802.11b/g wireless LAN technology, the Digi Connect Wi-Wave offers the industry's first off-the-shelf 802.11b/g USB radio card meeting the long-term product availability and specific operating temperature requirements of embedded designs and their extended product life cycles.

The Digi Connect Wi-Wave delivers a pre-certified, flexible and secure WLAN radio solution for a wide variety of sophisticated embedded applications. These include medical devices, retail systems, transportation, security/access control, building and industrial automation, networked displays, warehousing, gaming and more.

Combined with complete out-of-the-box Linux and Microsoft Windows CE 5.0/6.0 target platform support and easy hardware integration through the ubiquitous USB 2.0 interface, the Digi Connect Wi-Wave provides the ideal long-term WLAN connectivity solution for embedded systems.

### Platforms and Services



Design Services



Accessory Kits



Support



Supported Software Platforms

## Block Diagram

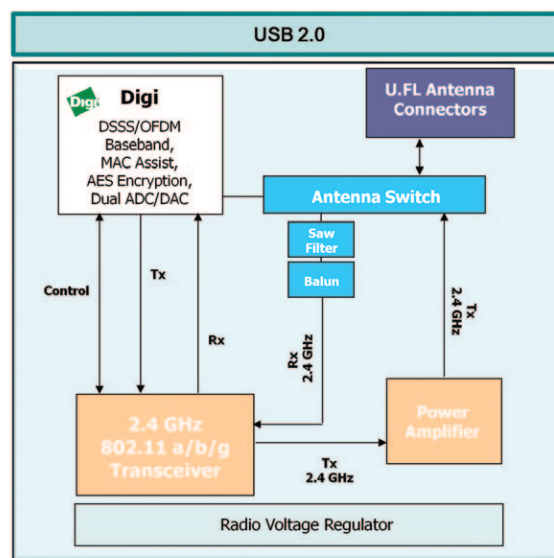

## Features/Benefits

- Highly integrated PCI Express Mini Card form factor
- Simple USB based hardware integration
- Strong WPA2/802.11i security support
- Industrial operating temperature range
- Fully-certified radio reduces design risk and accelerates time-to-market
- Digi's own WLAN technology for true long-term product availability in embedded designs
- Driver support for Linux and Microsoft® Windows® Embedded CE 5.0/6.0 (ARM, MIPS, x86)



## Development Kits

### Development Kit Overview

#### Development Kit for Linux and Microsoft Windows Embedded CE



The Digi Connect Wi-Wave card offers complete out-of-the box support of Linux (2.6.29 or greater), Microsoft Windows CE 5.0 and Microsoft Windows CE 6.0 platforms on ARM®, MIPS, and x86 target platforms. This allows customers to leverage the feature-complete selection of high-level software components and applications in Microsoft Windows Embedded CE or the readily available library of Linux software and community support on a broad range of new and existing target platforms.

The development and evaluation kit contains everything required to immediately start the development/evaluation process. This includes documentation, a development board for easy connection to the target host system through a standard USB interface cable, out-of-the-box antenna options, the Digi software platform support CD, and other accessories.

- Complete development kit for evaluation and prototyping
- Driver support for Microsoft Windows Embedded CE 5.0/6.0 and Linux
- Seamless software and hardware integration
- Digi Board Support Package (BSP) source code included

### Development Kit Contents

Software Platforms	Linux and Microsoft Windows Embedded CE 5.0/6.0 (ARM, x86, MIPS)
Module	Digi Connect Wi-Wave 802.11b/g
Development Board	Development board with socket with retaining clip, 2 x U.FL connectors, 2 x RP-SMA connectors, USB type B connector, signal headers, status LEDs, power connector
CD/DVD	Digi software platform support CD with drivers, tools and documentation
Documentation	Quick start guide, installation and user's guide, hardware reference manual
Power Supplies and Accessories	2 x U.FL cables, Antennas, USB cable, Power supply with country/region specific plugs
Kit Part Numbers	DC-WWV-EKIT

### Specifications

#### Digi Connect® Wi-Wave

Hardware	
Form Factor	Compliant with PCI Express Mini Card form factor and electrical specification
Host Interface	USB 2.0 device full-/ high-speed
Baseband Processor	Digi DSSS/OFDM baseband processor technology with MAC assist and AES hardware encryption
Dimensions	L x W x H: 2.006 in (50.95 mm) x 1.181 in (30.00 mm) x 0.187 in (4.75 mm) Top: 0.095 in (2.40 mm); Bottom: 0.053 in (1.35 mm)
Network Interface - Wireless	
Standard	IEEE 802.11b/g
Frequency	2.4 GHz
Data Rate	Up to 54 Mbps with automatic rate fallback
Modulation	DBPSK (1 Mbps), DQPSK (2 Mbps), CCK (11,5.5 Mbps), BPSK (6,9 Mbps), QPSK (12,18 Mbps), 16-QAM (24,36 Mbps), 64-QAM (48, 54 Mbps)
Transmit Power	15dBm (~32mW) @ 1,2,5.5 and 11Mbps; 12dBm (~16mW) @ 6,12,18,24,36,48 and 54Mbps
Receive Sensitivity (Typical)	-68 dBm @ 54 Mbps, -85 dBm @ 11 Mbps, -85 dBm @ 6 Mbps, -87 dBm @ 1 Mbps
Antenna Connectors	2 x U.FL
Dual-Diversity (Receive)	•
Infrastructure Mode (BSS)	•
Ad Hoc Mode (IBSS)	•
Power Saving Mode	•

- Module Feature

# Specifications

# Digi Connect® Wi-Wave

## WLAN Security

WEP (Wired Equivalent Privacy)	64/128-bit encryption (RC4)
WPA/WPA2/802.11i*	128-bit TKIP/CCMP (AES) encryption Enterprise mode (802.1X): LEAP (WEP only), PEAP, TTLS, TLS; GTC, MD5, OTP, PAP, CHAP, MSCHAP, MSCHAPv2, TTLS-MSCHAPv2 Pre-shared key mode (PSK)

## Power Requirements

Voltage	3.3 V DC $\pm$ 9% (3.00 to 3.60V)
Current	Transmit: 600 mA max, 430 mA typical Receive: 350 mA max, 235 mA typical Suspend: 150 mA typical

## Environmental

Operating Temperature	-40° C to +85° C (-40° F to +185° F)
Storage Temperature	-40° C to +125° C (-40° F to +257° F)
Relative Humidity	5% to 95% (non-condensing)
Altitude	12,000 feet (3,658 meters)

## Regulatory Approvals

FCC Part 15 Class B, EN 55022 Class B	•
EN 61000-3-2 and EN 61000-3-3	•
ICES-003 Class B, VCCI Class II, AS 3548	•
FCC Part 15 Sub C Section 15.247	•
IC RSS-210 Issue 5 Section 6.2.2(o)	•
EN 300 328, EN 301 489-17	•
UL 60950-1, EN 60950 (EU)	•
CSA C22.2, No. 60950	•
EN 55024	•

• Module Feature

\* WPA2/802.11i supplicant features depending on target operating system

## Digi Connect® Wi-Wave

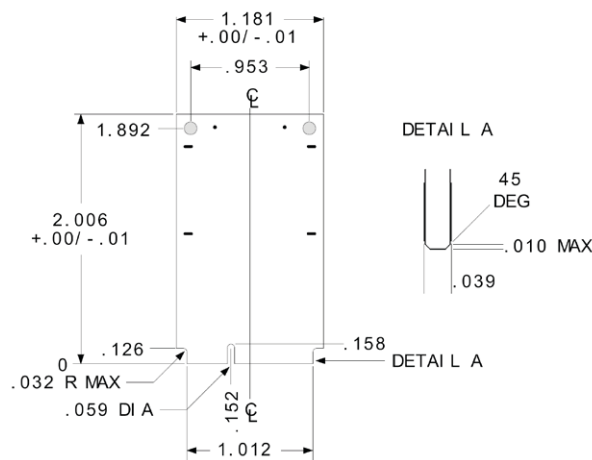

Visit [www.digiembedded.com](http://www.digiembedded.com) for part numbers.



**DIGI SERVICE AND SUPPORT** - You can purchase with confidence knowing that Digi is here to support you with expert technical support and a strong five-year warranty. [www.digi.com/support](http://www.digi.com/support)

**Digi International**  
877-912-3444  
952-912-3444  
[info@digi.com](mailto:info@digi.com)

**Digi International France**  
+33-1-55-61-98-98  
[www.digi.fr](http://www.digi.fr)

**Digi International KK**  
+81-3-5428-0261  
[www.digi-intl.co.jp](http://www.digi-intl.co.jp)

**Digi International (HK) Limited**  
+852-2833-1008  
[www.digi.cn](http://www.digi.cn)

**BUY ONLINE • [www.digiembedded.com](http://www.digiembedded.com)**



91001459  
C1/710

© 2008-2010 Digi International Inc. Digi, Digi International, the Digi logo, Digi Connect and the Making Wireless M2M logo are trademarks or registered trademarks of Digi International Inc. in the United States and other countries worldwide. ARM is a registered trademark of ARM Limited. Microsoft, Windows and the Windows logo are trademarks or registered trademarks of Microsoft Corporation in the United States and/or other countries. All other trademarks are the property of their respective owners. All information provided is subject to change without notice.



# Mouser Electronics

Authorized Distributor

Click to View Pricing, Inventory, Delivery & Lifecycle Information:

[Digi International:](#)

[DC-WWV-1G](#) [DC-WWV-2A-B](#) [DC-WWV-2A](#)