

No.415-EA (With Stopper) /420-EA Revolving Caster

PRODUCT



Specification

No.415-EA					
Model No.	F(Turning Radius)	Allowable Load (kg)	Net Weight (g)	Code No.	
No.415-EA-R50-1	R58	30	221	9777	
No.415-EA-R65-2	R62		275	9778	
No.415-EA-R75-3	R68	40	320	9779	
No.415-EA-R100-4	R83	50	670	9780	
No.415-EA-R125-5	R103	60	806	9781	
No.415-EA-R150-6	R118		1110	9782	
No.415-EA-N50-1	R47	40	190	9783	
No.415-EA-N65-2	R58		218	9784	
No.415-EA-N75-3	R68	50	241	9785	
No.415-EA-N100-4	R83	60	480	9786	
No.415-EA-N125-5	R103	70	540	9787	

No.420-EA					
Model No.	F(Turning Radius)	Allowable Load (kg)	Net Weight (g)	Code No.	
No.420-EA-R50-1	R47	30	185	9765	
No.420-EA-R65-2	R58		245	9766	
No.420-EA-R75-3	R68	40	290	9767	
No.420-EA-R100-4	R83	50	595	9768	
No.420-EA-R125-5	R103	60	740	9769	
No.420-EA-R150-6	R118		1038	9770	
No.420-EA-N50-1	R47	40	163	9771	
No.420-EA-N65-2	R58		196	9772	
No.420-EA-N75-3	R68	50	220	9773	
No.420-EA-N100-4	R83	60	460	9774	
No.420-EA-N125-5	R103	70	530	9775	

Size List				Applied for both No.415-EA and No.420-EA			
No.	D	E	H	S	W		d
					Rubber Wheel	Nylon Wheel	
1	φ 50	21	68	35	20	21	M12×1.75
2	φ 65	24	85		21		
3	φ 75	29	95				
4	φ 100	32	126	40	27	25	M16×2.0
5	φ 125	39	152				
6	φ 150	42	180				

Material of Wheel	R-Rubber wheel
	N-Nylon wheel

Ask for materials for wheel other than rubber and nylon, depending on the size (D size).  
A caster with bearing is also available.

Characteristic

With its bolted shaft, it suits for a device where beautiful appearance and light weight are required.

Application

Steel made office utilities / Furniture / Interior transporters

No.415-EA (with stopper)

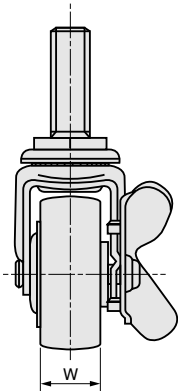
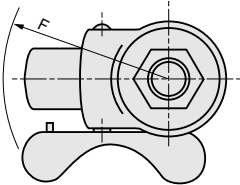

No.420-EA

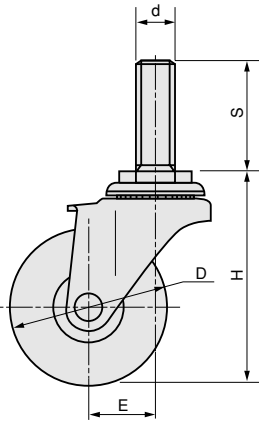
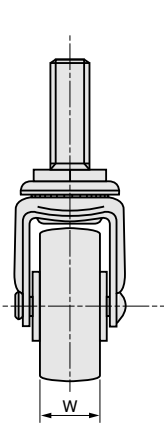
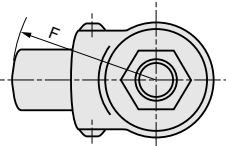
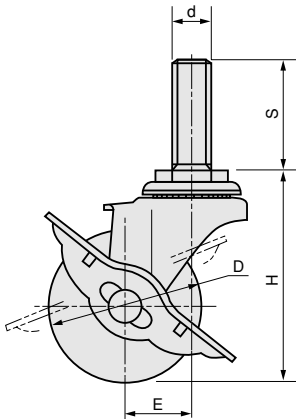

Wrench  
Specify by model No. of the caster.

