

Tous droits strictement reserves. Reproduction ou communication a des tiers interdite sous quelque forme que ce soit sans autorisation ecrite du proprietaire. Propriete de FCI Electronics. Droits de reproduction FCI Electronics INC.

All rights strictly reserved. Reproduction or issue to third parties in any form whatever is not permitted without written authority from the proprietor. Property of FCI Electronics. Copyright FCI Electronics INC.

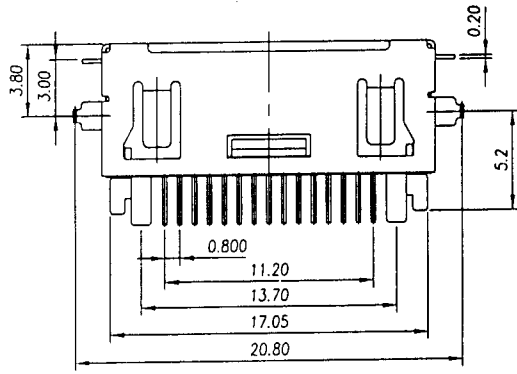

PART NUMBER
SEE NOTE 5

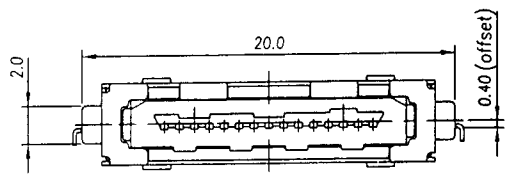
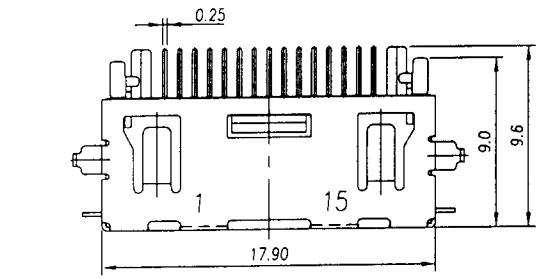

CONTACT POS.	DIM. B±0.10 MM
#1, #15	3.7
#2 ~ #14	3.0

TABLE 1

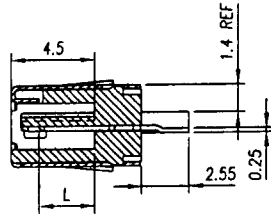
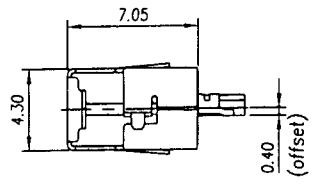

CONTACT DETAIL

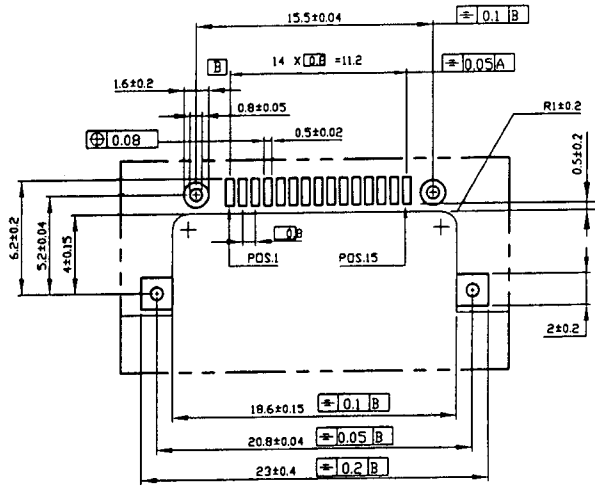

RECOMMENDED P.C.B. LAYOUT

mat'l. code				tolerances unless otherwise specified		CUSTOMER COPY	Electronics www.fciconnect.com	title	
ltr	ec'n no	dr	date	linear	.X ±0.38			PCMCIA 15 POS. I/O	
A	T10069	JH	8/7/97		.XX ±0.25	projection		PCB CONNECTOR TYPE 2	
B	T10097	J. H	3/22/01		.XXX ±0.20				
				angles	0° ±2°				
				dr	JASON HSU 4/22/99	mm		product family	73
				enrg	JASON HSU 4/22/99			size/ dwg no	
				chr	J. TSAO 4/22/99	scale		A4 55604	
				appd	L. WANG 4/22/99			code	TWN
sheet	revision	B	B					sheet	1 of 2
index	sheet	1	2						

cage code
22526

Tous droits strictement reserves. Reproduction ou communication a des tiers interdite sous quelque forme que ce soit sans autorisation ecrite du proprietaire. Propriete de FCI Electronics. Copyright FCI Electronics INC. All rights strictly reserved. Reproduction or issue to third parties in any form whatever is not permitted without written authority from the proprietor. Property of FCI Electronics

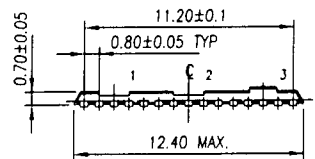

A3 CLOSED SYSTEM

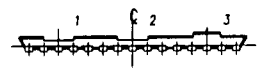

B3 TYPE

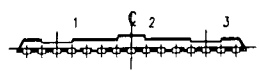

A2 LAN OPEN SYSTEM

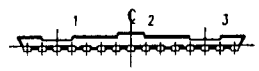

B2 TYPE

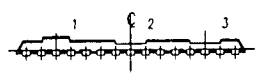

A1 TYPE



B1 TYPE

FIGURE 1

NOTE:

- 1. MATERIAL:
 - INSULATOR: LCP UL94V-0.
 - CONTACT: P.H. CR5191.
 - SHIELDING: STAINLESS STEEL.
 - PLATING: SELECT 30u" Au MIN. ON CONTACT AREA. TIN/LEAD 100u" ON SOLDERING TAIL. NICKLE PLATED 50u" OVERALL.

2. ELECTRONIC:

- VOLTAGE: 100V AC
- CURRENT RATE: 0.5A PER CONTACT
- OPERATING TEMPERATURE: -10°C ~ +70°C
- DURABILITY: 5000 CYCLES MIN. (HARSH ENVIRONMENT) 10000 CYCLES MIN. (OFFICE ENVIRONMENT)

3. MECHANICAL:

- INSERTION FORCE: 2kg MAX.
- WITHDRAW FORCE: 0.3 kg MIN.
- LATCH FULL LOCK: 5.5 kg MAX.

4. POLARIZING KEY TYPE AS FIG.1 SHOWN ON LEFT VIEW.

5. ORDERING DATA:

55604- X X X X

- PACKAGING SPEC AS TABLE 2, * TAPE & REEL, 1000 PCS PER REEL. ADD 'T' TO PART NO. e.g. 61512-001T.
- * PACKAGING TRAY, 70 PCS/TRAY. ADD 'S' TO PART NO. e.g. 61512-001S.

POLARIZING KEY OPTION:

- 0: A3 TYPE AS FIG.1
- 1: A2 TYPE AS FIG.1
- 2: A1 TYPE AS FIG.1
- 3: B3 TYPE AS FIG.1
- 4: B2 TYPE AS FIG.1
- 5: B1 TYPE AS FIG.1

PLATING:

- 5: 30u" GOLD WITHOUT PdNi PLATED.

PRODUCT NO.	DIM. A±0.05	PACKAGING QUANTITIES	
		INNER	CARTON
55604-0X1T	0.4	1000/REEL	5000
55604-0X1S	0.4	70/TRAY	1750

TABLE 2

mat'l. code				tolerances unless otherwise specified				CUSTOMER COPY		FCI Electronics www.fciconnect.com	
ltr	ecr no	dr	date	linear	.X ±0.38			projection		title PCMCIA 15 POS. I/O PCB CONNECTOR TYPE 2	
B					.XX ±0.25						
					.XXX ±0.20						
				angles	0° ±2°				mm	product family 73 size dwg no A4 55604	
				dr	JASON HSU	4/22/99					
				enr	JASON HSU	4/22/99					
				chr	J. TSAO	4/22/99					
				appd	L. WANG	4/22/99					
sheet index	revision sheet	B 1	B 2								