

Product Data Sheet



16XX SC

Replace XX with 02, 04, 06, 08 or 12 for number of poles

1600 Series with Short Circuiting Bar

30 Amps, 600 Volts AC/DC
(Unprepared Wire)

or

75 Amps, 600 Volts AC/DC when wired
with crimp type ring, spade or fork
terminal

21/32" Line to Line Spacing

Wire Range (with unprepared wire):

#10 – 22 AWG Copper

Size and number of lugged wires investigated in end use.

Application torque – 20 in.lb.

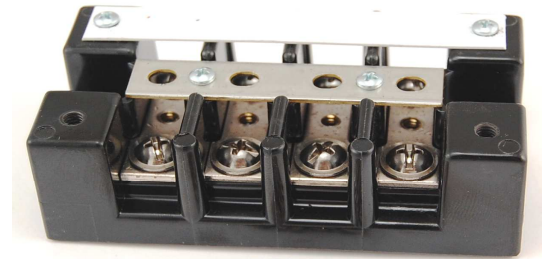

4 pole shown

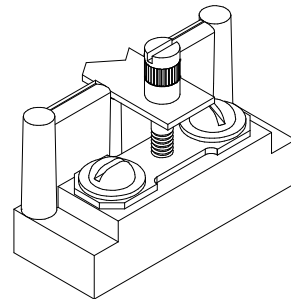

Short Circuiting Bar with
Brass Shorting Pin

**Four (4) screws supplied per
part for 1604, 1606, 1608 and
1612. Two (2) screws for 1602**

Shorting Bar is designed for current transformer application. It is NOT intended to be used as a jumper for power circuits

Electrical Ratings:

- 30A (unprepared wire)
- 75A (when wired with crimp type ring, spade or fork terminal)
- 600 Volts AC/DC (UL 1059 Class C, User Group - General Industrial)
- Factory and Field Wiring
- Use Listed terminals and tools for field installation of prepared conductors

Mechanical Ratings:

- Maximum insulator base temperature: 150°C (302°F) UL RTI
- Storage and transportation temperature range: -35°C to 125°C (-31°F to 257°F)
- Flammability rating of insulator base: UL 94 V-0

Materials:

- Connector: Brass, nickel plated
- Insulator base: phenolic
- Screws: Brass, nickel plated, #10-32 combination Phillips-slotted standard
- Marking Strip: Vinyl (white)
- Marking strip anchor screws: Steel, zinc plated
- Short Circuit Bar: Brass, tin plated
- Insert: Brass
- Shorting Pin: Brass, nickel plated (supplied loose)

Agency Approvals:

- UL Recognized, UL 1059 Terminal Block Standard, File No. XCFR2.E62806
- CSA Certified, CSA C22.2 No. 158, File No. LR19766
- CE compliant to IEC 60947-7-1
- RoHS Compliant

- Panel mountable: #10 fastener, torque to 25-30 in. lbs.

Accessories:

- Additional Shorting Pins: 9616901
- Slotted Screw available
- Printing Available on Marking Strip:



Note If marking strip is ordered separately order MS 16XX Side

Consult factory for custom printed applications

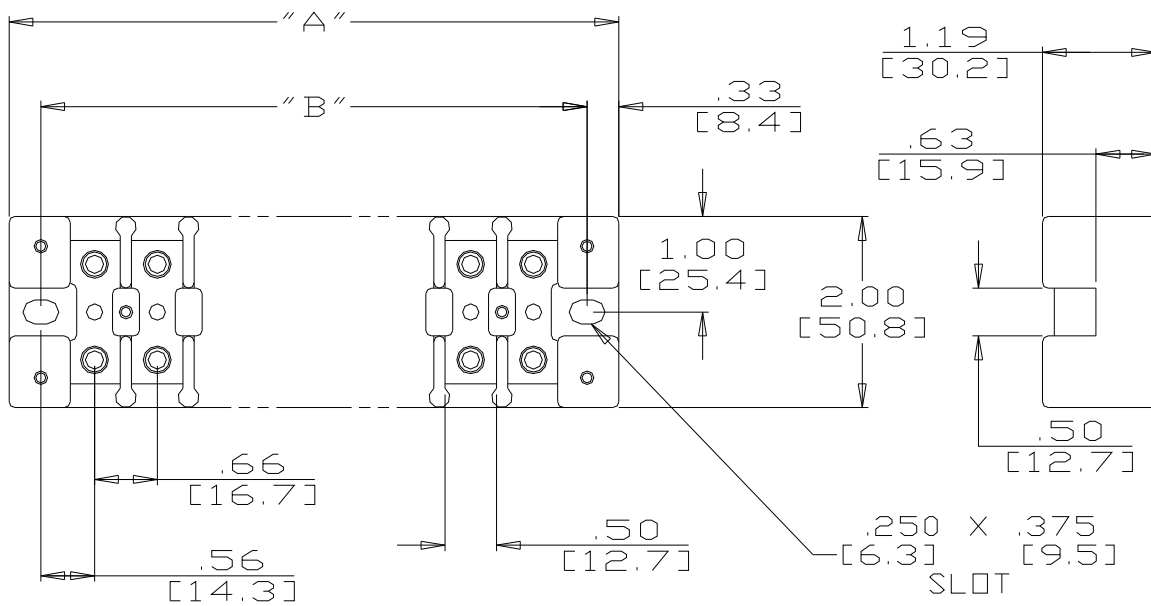

Catalog #	# of Poles	A	B
1604	4	3.75	3.09
1606	6	5.06	4.41
1608	8	6.38	5.72
1612	12	9.00	8.34

MM = Dim X 25.4

WWW.MARATHONSP.COM
1-419-352-8441

PDS 0208 REV C 01/27/17