

samtec

**MOLD-TO-POSITION
PRODUCT**

 Minimums or set-up charges
may apply. Call Samtec.

IC-308-SGT

IC-422-EGG

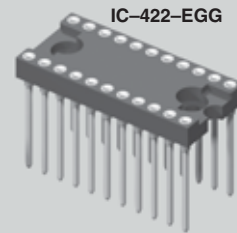
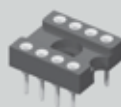

SCREW MOUNT DIP SOCKETS^{IC} SERIES

 Mates with:
AP, APS, APO,
APA, APH

Highest reliability DIP sockets

IC series DIP sockets feature U.L. rated G.F. polyester body with mounting holes and use precision machined lead sockets for high reliability in the most demanding applications.

SPECIFICATIONS

Insulator Material:

Black Glass Filled

Polyester

Flammability Rating:

UL 94V-0

Insulation Resistance:

5000 megohm @ 500 VDC

Temperature Range:

-55°C to +125°C

Withstanding Voltage:

1000 VRMS @ 60 Hz

Contact:

BeCu

Shell:

Brass except style K

Phosphor Bronze

Plating:

Au over 50µ" Ni or Sn over

100µ" Cu or 50µ" Ni

Current Rating:

1 amp continuous @

100 VDC per contact

Contact Resistance:

10 milliohms @ 200 milliamp

Socket Retention in Body:

5 lbs against barb

Lead Size Range:

.015" to .022" DIA

and most IC leads

Insertion Force:

Standard = 9 oz avg, 16 oz

max (.017" DIA probe); Low

Insertion Force = 2.5 oz avg,

5.5 oz max (.018" DIA probe)

Withdrawal Force:

Standard = 2.5 oz avg, 1.5 oz

min (after 12 insertions with

.017" DIA probe); Low Insertion

Force = 2.0 oz avg, 0.35 oz min

(after 12 insertions with .018"

DIA probe)

Note:

 Some sizes, styles and
options are non-standard,
non-returnable.

 TYPE
SOCKET

 ROW SPACING &
NO. OF CONTACTS

 IC
= IC
Socket

-S*, -A*, or -J

= Printed Circuit

* For LIF Specify -ZS or -ZA

LEAD STYLE	X DIA	Y TAIL	Z
-S or -ZS	(0.51) .020	(3.18) .125	(7.62) .300
-A or -ZA	(0.51) .020	(4.57) .180	(8.89) .350
-J	(0.64) .025	(10.41) .410	(15.24) .600

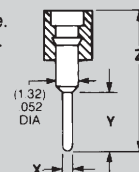
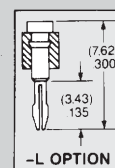
 Locking lead
(-L) available.
See OPTION.

 Style S, ZS, A, ZA & J Insertion Depth = .095" to .150"
 Style S Component Part No. = SC-1P1
 Style ZS Component Part No. = EZ-1P1
 Style A Component Part No. = SC-6P1
 Style ZA Component Part No. = EZ-6P1
 Style J Component Part No. = SC-1P3
 Option L Insertion Depth = .095" to .150"
 Option L Component Part No. = SC-1L1 or EZ-1L1

Low Insertion Force (LIF) Contacts Available.

-306 = .300 Row / 6 Contacts

-308 = .300 Row / 8 Contacts

-310 = .300 Row / 10 Contacts

Part No.	A Length	B Width
IC-306	(8.89) .350	(10.16) .400
IC-308	(11.43) .450	(10.16) .400
*IC-310	(13.97) .550	(10.16) .400

* Mounting hole off center on 10 position.

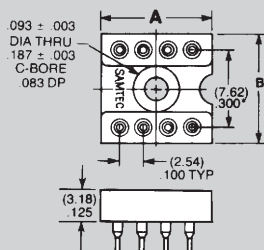

-314 = .300 Row / 14 Contacts

-316 = .300 Row / 16 Contacts

-318 = .300 Row / 18 Contacts

-320 = .300 Row / 20 Contacts

-324 = .300 Row / 24 Contacts

-422 = .400 Row / 22 Contacts

-424 = .400 Row / 24 Contacts

Part No.	A Length	B Width	E Mnt Holes
IC-314	(17.78) .700	(10.16) .400	(10.16) .400
IC-316	(20.32) .800	(10.16) .400	(12.70) .500
IC-318	(22.86) .900	(10.16) .400	(15.24) .600
IC-320	(25.40) 1.000	(10.16) .400	(17.78) .700
IC-324	(30.48) 1.200	(10.16) .400	(22.86) .900
IC-422	(27.94) 1.100	(10.16) .400	(20.32) .800
IC-424	(30.48) 1.200	(12.70) .500	(22.86) .900

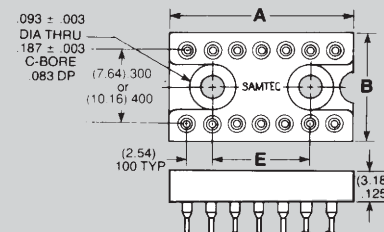

Due to technical progress, all designs, specifications and components are subject to change without notice.

WWW.SAMTEC.COM

SAMTEC USA • Tel: 1-800-SAMTEC-9 or 812-944-6733 • Fax: 812-948-5047

SAMTEC GERMANY • Tel: +49 (0) 89 / 89460-0 • Fax: +49 (0) 89 / 89460-299

SAMTEC NORDIC/BALTIC • Tel: +46-84477280 • Fax: +46-844720413

SAMTEC JAPAN • Tel: 045-475-1385 • Fax: 045-475-1340

SAMTEC HONG KONG • Tel: 852-26904858 • Fax: 852-26904842

SAMTEC SILICON VALLEY • Tel: 408-395-5900 • Fax: 408-395-1520

SAMTEC FRANCE • Tel: 01 60 95 06 60 • Fax: 01 60 95 06 61

SAMTEC ISRAEL • Tel: 972-3-7526600 • Fax: 972-3-7526690

SAMTEC CHINA • Tel: 86-21-61103766 • Fax: 86-21-61103766

SAMTEC SOUTH AFRICA • Tel: 27 11 452 8112 • Fax: 27 86 6714432

SAMTEC UK • Tel: 01236 739292 • Fax: 01236 727113

SAMTEC ITALY • Tel: 39 039 6890337 • Fax: 39 039 6890315

SAMTEC INDIA • Tel: +91-80-3272 1612 • Fax: +91-80-4152 8187

SAMTEC TAIWAN • Tel: 886-2-2735-6109 • Fax: 886-2-2735-5036

SAMTEC ANZ • Tel: 613 9512 7747 • Fax: 613 9512 7745

samtec

MOLD-TO-POSITION PRODUCT

Minimums or set-up charges
may apply. Call Samtec.

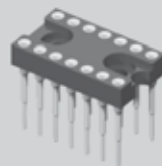

IC-314-WGT

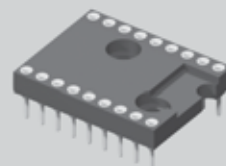

IC-618-SGT

-W = Wire-Wrap For LIF Specify -ZW

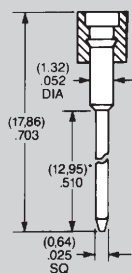

Shorter
w/w tail
lengths
available.
See
OPTION.

Insertion Depth
= .125" to .175"
Style W Component
Part No. = SC-1W1(1)
Style ZW Component
Part No. = EZ-1W1(1)
Style W-2 Component
Part No. = SC-1W1(2)
Style ZW-2 Component
Part No. = EZ-1W1(2)
Style W-3 Component
Part No. = SC-1W1(3)
Style ZW-3 Component
Part No. = EZ-1W1(3)

-E = Elevated For LIF Specify -ZE or -ZH

LEAD STYLE	X DIA	W TAIL	Y	Z
-E or -ZE	(0.51) .020	(4.32) .170	(8.86) .349	(13.77) .543
-ZH	(0.46) .018	(3.81) .150	(12.95) .510	(17.86) .703

Insertion Depth = .125" to .175"
Style E Component Part No. = SC-2P3
Style ZE Component Part No. = EZ-2P3
Style ZH Component Part No. = EZ-2P2

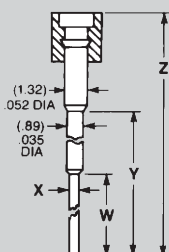

PLATING OPTION

GG
= 30μ" Gold Contact
10μ" Gold Shell

GT
= 30μ" Gold Contact
Tin Shell

TT
= Tin Contact
and Shell
(-S, -ZS, -W, -ZW,
-A, -H only)

ST
= 10μ" Gold Contact
Tin Shell
(-S & -ZS only)

OPTION (Leave Blank for Standard Version)

-2
= (9.14) .360
Wire-Wrap
Tail

Wire-Wrap Option

Requires Style
-W or -ZW

-3
= (6.60) .260
Wire-Wrap
Tail

Specify desired
suffix for shorter
Wire-Wrap tail.

-L
= Locking
Socket

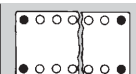

Requires Style
-S or -ZS and
.035"± .003"
board hole.

Requires GT
plating option

-610 = .600 Row / 10 Contacts

-614 = .600 Row / 14 Contacts

-616 = .600 Row / 16 Contacts

-618 = .600 Row / 18 Contacts

Part No.	A Length
IC-610	(12.70) .500
IC-614	(17.78) .700
IC-616	(20.32) .800
IC-618	(22.86) .900

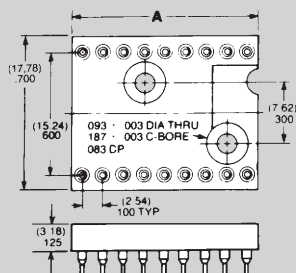

-624 = .600 Row / 24 Contacts

-628 = .600 Row / 28 Contacts

-632 = .600 Row / 32 Contacts

-640 = .600 Row / 40 Contacts

-940 = .900 Row / 40 Contacts

-950 = .900 Row / 50 Contacts

-964 = .900 Row / 64 Contacts

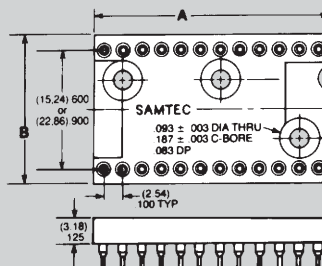

Part No.	A Length	B Width
IC-624	(30.48) 1.200	(17.78) .700
IC-628	(35.56) 1.400	(17.78) .700
IC-632	(40.64) 1.600	(17.78) .700
IC-640	(50.80) 2.000	(17.78) .700
*IC-940		
*IC-950	(63.50) 2.500	(26.27) 1.050
IC-964	(81.28) 3.200	

*IC-940 and IC-950
are non-standard
non-returnable.

†Mounting hole off center on 50 positions

Due to technical progress, all designs, specifications and components are subject to change without notice.

WWW.SAMTEC.COM

SAMTEC USA • Tel: 1-800-SAMTEC-9 or 812-944-6733 • Fax: 812-948-5047
SAMTEC GERMANY • Tel: +49 (0) 89 / 89460-0 • Fax: +49 (0) 89 / 89460-299
SAMTEC NORDIC/BALTIC • Tel: +46-84477280 • Fax: +46-844720413
SAMTEC ASIA PACIFIC • Tel: 65 6745-5955 • Fax: 65 6841-1502
SAMTEC HONG KONG • Tel: 852-26904858 • Fax: 852-26904842
SAMTEC JAPAN • Tel: 045-475-1385 • Fax: 045-475-1340
SAMTEC KOREA • Tel: 82-31-717-5685 • Fax: 82-31-717-5681
SAMTEC SILICON VALLEY • Tel: 408-395-5900 • Fax: 408-395-1520
SAMTEC FRANCE • Tel: 01 60 95 06 60 • Fax: 01 60 95 06 61
SAMTEC CHINA • Tel: 86-21-61103766 • Fax: 86-21-61103766
SAMTEC SOUTH AFRICA • Tel: 27 11 452 8112 • Fax: 27 86 6714432
SAMTEC UK • Tel: 01236 739292 • Fax: 01236 727113
SAMTEC ITALY • Tel: 39 039 6890337 • Fax: 39 039 6890315
SAMTEC INDIA • Tel: +91-80-3272 1612 • Fax: +91-80-4152 8187
SAMTEC TAIWAN • Tel: 886-2-2735-6109 • Fax: 886-2-2735-5036
SAMTEC ANZ • Tel: 613 9512 7747 • Fax: 613 9512 7745