

## NOTES:

1.0 PINS WITHOUT ELECTRICAL CONNECTION ARE OMITTED.

## ELECTRICAL SPECIFICATIONS:

1.0 TURNS RATIO: (P2-P1) : (J2-J1) : 1CT : 1CT  $\pm 3\%$   
(P4-P3) : (J6-J3) : 1CT : 1CT  $\pm 3\%$   
(P8-P7) : (J5-J4) : 1CT : 1CT  $\pm 3\%$   
(P10-P9) : (J8-J7) : 1CT : 1CT  $\pm 3\%$

2.0 INDUCTANCE: (P1-P2) ; (P3-P4) : 350 uH MIN. @ 0.01V, 100KHz, 8 mA DC BIAS  
(P4-P7) ; (P10-P9) : 350 uH MIN. @ 0.01V, 100KHz, 8 mA DC BIAS

3.0 LEAKAGE INDUCTANCE: P2-P1 (WITH J2 AND J1 SHORT) : 0.3uH MAX. @ 1MHz  
P4-P3 (WITH J6 AND J3 SHORT) : 0.3uH MAX. @ 1MHz  
P8-P7 (WITH J5 AND J4 SHORT) : 0.3uH MAX. @ 1MHz  
P10-P9 (WITH J8 AND J7 SHORT) : 0.3uH MAX. @ 1MHz

4.0 INTERWINDING CAPACITANCE: (P1-P2) : (J2-J1) : 70pf MAX @ 1MHz  
(P4-P3) : (J6-J3) : 70pf MAX @ 1MHz  
(P8-P7) : (J5-J4) : 70pf MAX @ 1MHz  
(P10-P9) : (J8-J7) : 70pf MAX @ 1MHz

5.0 DC RESISTANCE: (J6-J3) ; (J2-J1) ; (J4-J5) ; (J7-J8) : 1.2 ohms Max.

Bel Stewart Connector  
11118 Susquehanna Trail, South  
Glen Rock, Pa 17327-9199  
717.234.7512

**MagJack**

<http://www.stewartconnector.com>

THIS DRAWING AND THE SUBJECT MATTER SHOWN THEREON ARE CONFIDENTIAL AND PROPERTY OF BEL STEWART CONNECTOR AND SHALL NOT BE REPRODUCED, COPIED, OR USED IN ANY MANNER WITHOUT PRIOR WRITTEN CONTENT OF BEL STEWART CONNECTOR. THE SUBJECT MATTER MAY BE PATENTED OR A PATENT MAY BE PENDING.

SHEET  
1 OF 4

DRAWING NO.

SI-10258

REV.  
01

6.0 RETURN LOSS: 1MHz TO 30MHz	: 18dB MIN.
30MHz TO 100MHz	: $12-20 \text{ LOG } \left( \frac{F}{80\text{MHz}} \right)$
7.0 DIELECTRIC WITHSTAND: (J1,J2) TO (P2,P3) ; (J5,J4) TO (P6-P5)	: 1500 VAC
(J3,J6) TO (P7,P4) ; (J8,J7) TO (P9, P8)	: 1500 VAC
8.0 INSERTION LOSS: RS=RL=100 ohms	
100KHz TO 100MHz	: 1.1 dB MAX
9.0 RISE TIME: RS=100 OHMS AND RL = 100 OHMS	
OUTPUT VOLTAGE = 1 V peak	: 3.0 nS MAX
PULSE WIDTH= 112nS	: 3.0 nS MAX
10.0 CROSS TALK: 1-60 MHz	: 35 dB MIN
60-100 MHz	: 25 dB MIN
11.0 COMMON TO COMMON MODE ATTENUATION: 1MHz TO 100MHz	: 35dB TYP

Bel Stewart Connector  
11118 Susquehanna Trail, South  
Glen Rock, Pa 17327-9199  
717.234.7512

**MagJack®**

<http://www.stewartconnector.com>

THIS DRAWING AND THE SUBJECT MATTER SHOWN THEREON ARE CONFIDENTIAL AND PROPERTY OF BEL STEWART CONNECTOR AND SHALL NOT BE REPRODUCED, COPIED, OR USED IN ANY MANNER WITHOUT PRIOR WRITTEN CONTENT OF BEL STEWART CONNECTOR. THE SUBJECT MATTER MAY BE PATENTED OR A PATENT MAY BE PENDING.

SHEET  
2 OF 4

DRAWING NO.

SI-10258

REV.  
01

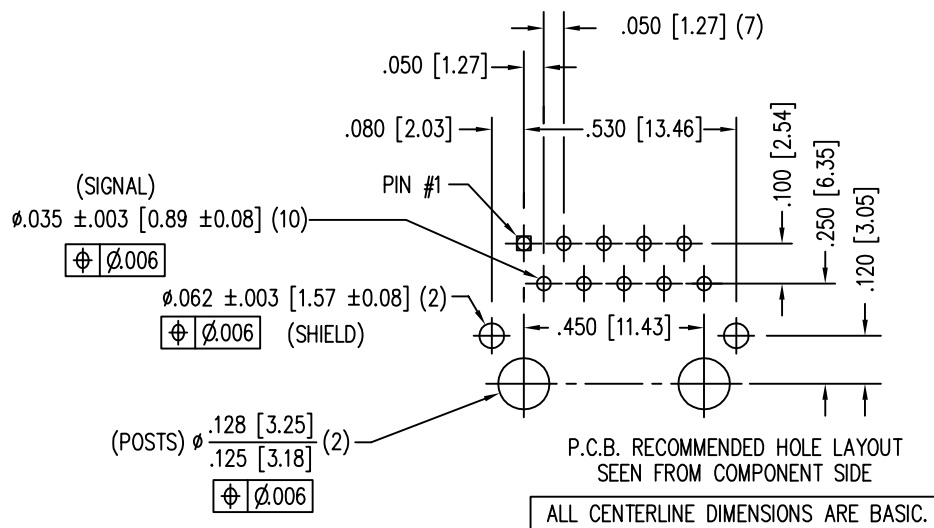
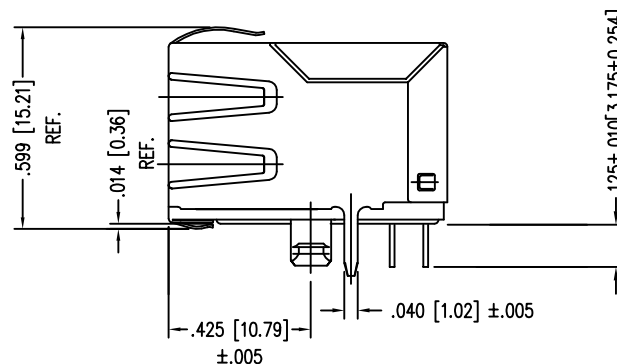
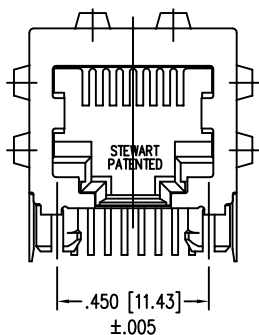

NOTES:

- TOLERANCES COMPLY WITH F.C.C. DIMENSION REQUIREMENTS
- DIMENSIONS SHOWN ARE SUBJECT TO CHANGE WITHOUT NOTICE.
- PIN NOT ELECTRICALLY CONNECTED MAYBE OMITTED.  
SEE ELECTRICAL DRAWING FOR OMITTED PINS.
- WAVE SOLDER COMPATABLE -125°C/90SEC

AVAILABLE WITH:

- STANDARD 50 MICRO-INCH SELECTIVE GOLD PLATING

**Bel Stewart Connector**  
11118 Susquehanna Trail, South  
Glen Rock, Pa 17327-9199  
717.234.7512

# MagJack®

<http://www.stewartconnector.com>

THIS DRAWING AND THE SUBJECT MATTER SHOWN THEREON ARE CONFIDENTIAL AND PROPERTY OF BEL STEWART CONNECTOR AND SHALL NOT BE REPRODUCED, COPIED, OR USED IN ANY MANNER WITHOUT PRIOR WRITTEN CONSENT OF BEL STEWART CONNECTOR. THE SUBJECT MATTER MAY BE PATENTED OR A PATENT MAY BE PENDING.

SHEET  
3 OF 4

DRAWING NO.
-------------

SI-10258

REV. 0

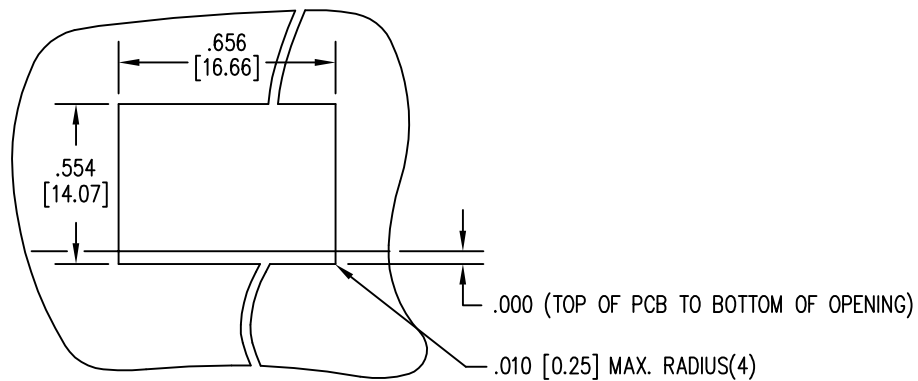

SUGGESTED PANEL OPENING

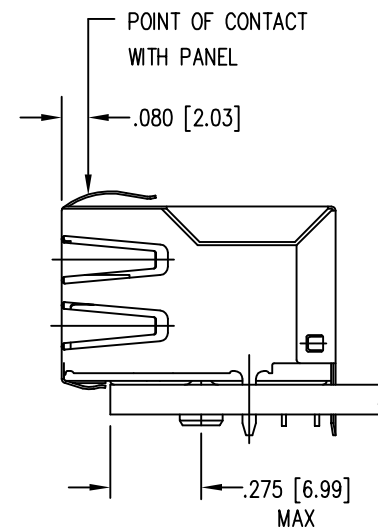

THE SUGGESTED PANEL OPENING IS INTENDED  
TO GIVE THE USER THE ABILITY TO HAVE  
REASONABLE JACK / PANEL CLEARANCES  
YET MAINTAIN RELIABLE GROUNDING  
CAPABILITY.

THIS DRAWING AND THE SUBJECT MATTER SHOWN THEREON ARE CONFIDENTIAL AND PROPERTY OF BEL STEWART CONNECTOR AND SHALL NOT BE REPRODUCED, COPIED, OR USED IN ANY MANNER WITHOUT PRIOR WRITTEN CONTENT OF BEL STEWART CONNECTOR. THE SUBJECT MATTER MAY BE PATENTED OR A PATENT MAY BE PENDING.

Bel Stewart Connector  
11118 Susquehanna Trail, South  
Glen Rock, Pa 17327-9199  
717.234.7512

**MagJack®**

<http://www.stewartconnector.com>

SHEET  
4 OF 4

DRAWING NO.

SI-10258

REV. 01