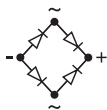

**CBR1-D010 SERIES****SILICON BRIDGE RECTIFIER  
1 AMP, 100 THRU 1000 VOLTS****DIP CASE**[www.centrasemi.com](http://www.centrasemi.com)**DESCRIPTION:**

The CENTRAL SEMICONDUCTOR CBR1-D010 series types are full wave silicon bridge rectifiers mounted in a durable epoxy molded case. These devices are ideal for printed circuit board mounting and fit into a standard DIP socket (0.1"/2.54mm spacing).

**NOTE:** Also available in fast recovery. Please contact factory for details.

**MARKING: FULL PART NUMBER****MAXIMUM RATINGS:** ( $T_A=25^{\circ}\text{C}$  unless otherwise noted)

|  | SYMBOL         | CBR1<br>-D010 | CBR1<br>-D020 | CBR1<br>-D040 | CBR1<br>-D060 | CBR1<br>-D080 | CBR1<br>-D100 | UNITS              |
|--|----------------|---------------|---------------|---------------|---------------|---------------|---------------|--------------------|
| Peak Repetitive Reverse Voltage                      | $V_{RRM}$      | 100           | 200           | 400           | 600           | 800           | 1000          | V                  |
| DC Blocking Voltage                                  | $V_R$          | 100           | 200           | 400           | 600           | 800           | 1000          | V                  |
| RMS Reverse Voltage                                  | $V_{R(RMS)}$   | 70            | 140           | 280           | 420           | 560           | 700           | V                  |
| Average Forward Current ( $T_A=50^{\circ}\text{C}$ ) | $I_O$          |               |               |               | 1.0           |               |               | A                  |
| Peak Forward Surge Current                           | $I_{FSM}$      |               |               |               | 50            |               |               | A                  |
| Operating and Storage<br>Junction Temperature        | $T_J, T_{stg}$ |               |               | -65 to +150   |               |               |               | $^{\circ}\text{C}$ |

**ELECTRICAL CHARACTERISTICS PER DIODE:** ( $T_A=25^{\circ}\text{C}$  unless otherwise noted)

| SYMBOL | TEST CONDITIONS             | MIN | MAX | UNITS         |
|--------|-----------------------------|-----|-----|---------------|
| $I_R$  | $V_R=\text{Rated } V_{RRM}$ |     | 10  | $\mu\text{A}$ |
| $V_F$  | $I_F=1.0\text{A}$           |     | 1.1 | V             |

**CBR1-D010 SERIES**  
**SILICON BRIDGE RECTIFIER**  
**1 AMP, 100 THRU 1000 VOLTS**



**DIP CASE - MECHANICAL OUTLINE**

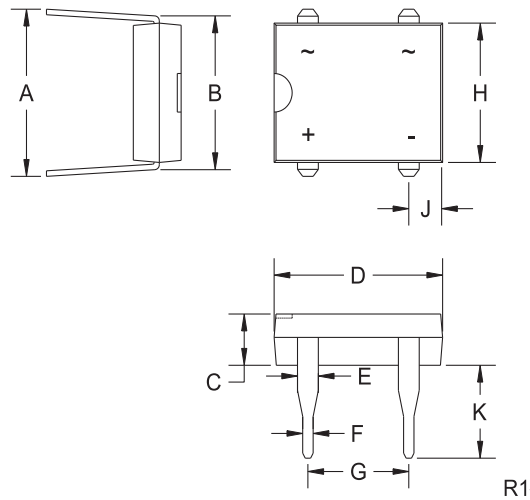

R1

| DIMENSIONS |        |       |             |      |
|------------|--------|-------|-------------|------|
| SYMBOL     | INCHES |       | MILLIMETERS |      |
|            | MIN    | MAX   | MIN         | MAX  |
| A          | 0.300  | 0.350 | 7.62        | 8.89 |
| B          | 0.285  | 0.315 | 7.24        | 8.00 |
| C          | 0.086  | 0.098 | 2.18        | 2.49 |
| D          | 0.316  | 0.335 | 8.03        | 8.51 |
| E          | 0.035  | 0.045 | 0.89        | 1.14 |
| F          | 0.018  | 0.022 | 0.46        | 0.56 |
| G          | 0.195  | 0.205 | 4.95        | 5.21 |
| H          | 0.245  | 0.255 | 6.22        | 6.48 |
| J          | 0.055  | 0.075 | 1.40        | 1.91 |
| K          | 0.150  | 0.185 | 3.81        | 4.70 |

DIP (REV: R1)

**MARKING: FULL PART NUMBER**

R3 (11-June 2012)

## OUTSTANDING SUPPORT AND SUPERIOR SERVICES



---

### PRODUCT SUPPORT

Central's operations team provides the highest level of support to insure product is delivered on-time.

- Supply management (Customer portals)
- Inventory bonding
- Consolidated shipping options
- Custom bar coding for shipments
- Custom product packing

---

### DESIGNER SUPPORT/SERVICES

Central's applications engineering team is ready to discuss your design challenges. Just ask.

- Free quick ship samples (2<sup>nd</sup> day air)
- Online technical data and parametric search
- SPICE models
- Custom electrical curves
- Environmental regulation compliance
- Customer specific screening
- Up-screening capabilities
- Special wafer diffusions
- PbSn plating options
- Package details
- Application notes
- Application and design sample kits
- Custom product and package development

---

### REQUESTING PRODUCT PLATING

1. If requesting Tin/Lead plated devices, add the suffix " TIN/LEAD" to the part number when ordering (example: 2N2222A TIN/LEAD).
2. If requesting Lead (Pb) Free plated devices, add the suffix " PBFREE" to the part number when ordering (example: 2N2222A PBFREE).

---

### CONTACT US

#### Corporate Headquarters & Customer Support Team

Central Semiconductor Corp.  
145 Adams Avenue  
Hauppauge, NY 11788 USA  
Main Tel: (631) 435-1110  
Main Fax: (631) 435-1824  
Support Team Fax: (631) 435-3388  
[www.centrasemi.com](http://www.centrasemi.com)

**Worldwide Field Representatives:**  
[www.centrasemi.com/wwreps](http://www.centrasemi.com/wwreps)

**Worldwide Distributors:**  
[www.centrasemi.com/wwdistributors](http://www.centrasemi.com/wwdistributors)

---

For the latest version of Central Semiconductor's **LIMITATIONS AND DAMAGES DISCLAIMER**, which is part of Central's Standard Terms and Conditions of sale, visit: [www.centrasemi.com/terms](http://www.centrasemi.com/terms)