

TABLE 1				
CONTACT SPECIFICATION				
-XX	-S, -D, -T	-S-RA	-D-RA	-T-RA
-01	C-15-1-X	N/A	N/A	N/A
-02	C-15-2-X	C-15-2-X	C-15-2-X	C-15-2-X
			C-15-3-X	C-15-3-X
				C-15-4-X
-03	C-15-3-X	C-15-3-X	C-15-3-X	N/A
			C-15-4-X	N/A
-04	C-15-4-X	C-15-4-X	N/A	N/A
-21	C-60-1-X	N/A	N/A	N/A
-22	C-60-2-X	C-60-2-X	C-60-2-X	C-60-2-X
			C-60-3-X	C-60-3-X
				C-60-4-X
-23	C-60-3-X	C-60-3-X	C-60-3-X	N/A
			C-60-4-X	N/A
-24	C-60-4-X	C-60-4-X	N/A	N/A

SSQ-1XX-XX-XXX-X-XX-XXX-XX-XX

No OF POSITIONS

-01 THRU -50
(PER ROW)

LEAD STYLE

(SEE TABLE 1)

-01 THRU -04: STANDARD INSERTION FORCE
-21 THRU -24: LOW INSERTION FORCE

PLATING SPECIFICATION

-G: 20μ" GOLD IN CONTACT AREA,
3μ" SELECTIVE GOLD ON TAIL

-T: MATTE TIN ON ENTIRE PIN

(NOT AVAILABLE FOR -21 THROUGH -24 LEAD STYLES)

-S: 30μ" SELECTIVE GOLD IN CONTACT AREA,
MATTE TIN ON TAIL

-H: 30μ" GOLD IN CONTACT AREA,
3μ" SELECTIVE GOLD ON TAIL

-F: 3µ" SELECTIVE GOLD IN CONTACT AREA,
MATTE TIN ON TAIL.

-TL: TIN/LEAD (90/10±5%) ON ENTIRE PIN
(AVAILABLE ONLY ON LEAD STYLE -01)

-TM: MATTE TIN ON ENTIRE PIN

(NOT AVAILABLE FOR -21 THROUGH -24 LEAD STYLES)

-SM: 30μ" SELECTIVE GOLD IN CONTACT AREA,
MATTE TIN ON TAIL.

-FM: 3 μ " SELECTIVE GOLD IN CONTACT AREA,
MATTE TIN ON TAIL.

-L: 10μ" SELECTIVE GOLD IN CONTACT AREA,
MATTE TIN ON TAIL.

-STL: 30μ" SELECTIVE GOLD IN CONTACT AREA,
TIN/LEAD (90/10±5%) ON TAIL

TIN/LEAD (90/10±5%) ON TAIL
(AVAILABLE ONLY ON LEAD STYLE -01)

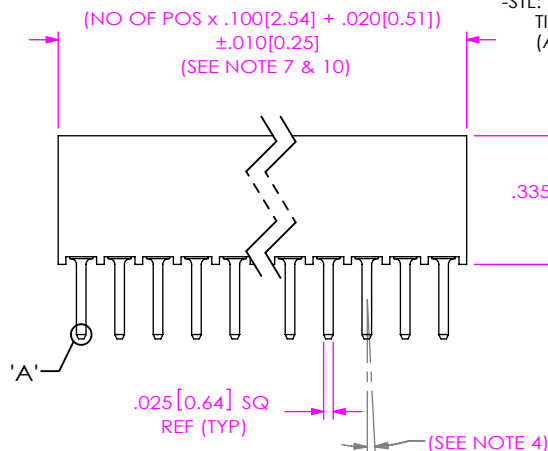

NOTES:

1.  REPRESENTS A CRITICAL DIMENSION.
2. MINIMUM PUSHOUT FORCE: 1.5 LB.
3. MAXIMUM ALLOWABLE BOW: .003[.08] INCH/INCH.
4. MAXIMUM ALLOWABLE SWAY: HAND FILL 4° (TYP).
MACHINE FILL 1° (TYP).
5. MAXIMUM VARIATION BETWEEN PIN ROWS: .010[0.25].
6. END WALLS AFTER CUTTING SHOULD BE .020 ± .003 [0.51 ± .08]
7. MAXIMUM CUT FLASH: .010[0.25].
8. SHEAR LOCATION TO BE WITHIN .001[0.03] OF THE
BREAK OFF CENTER LOCATION FOR MACHINE FILL.
9. NOTCH ON -P-RA OPTION TO BE ORIENTED AS SHOWN.
10. NO FLASH IS ALLOWED BELOW LEADS OR IN HOLES OF BODY.
11. +.000[0.00]/-.005[0.13] FOR MACHINE FILL ONLY,
SSQ-1XX-XX-X-S, SSQ-1XX-XX-X-D, SSQ-1XX-XX-X-T (IN-PROCESS),
SSQ-1XX-XX-X-SA.

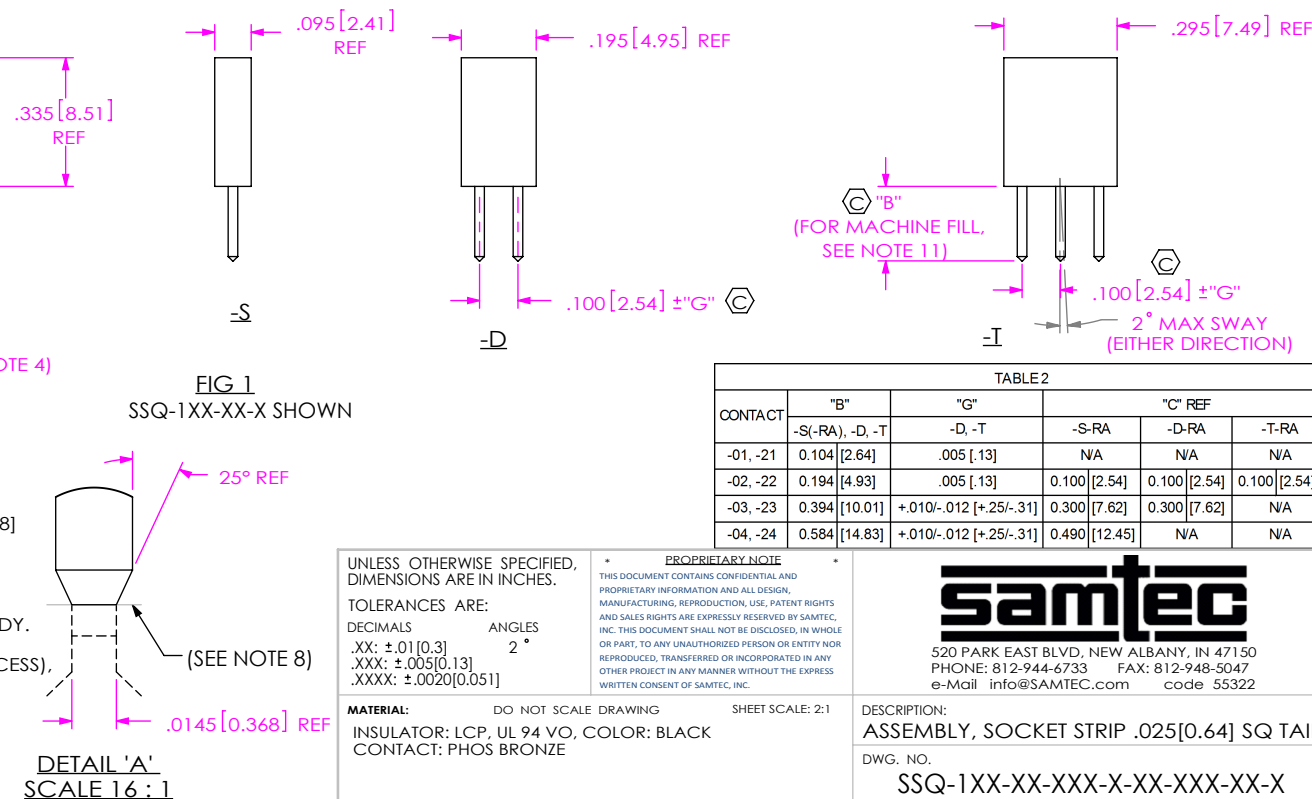

CONTACT	"B"	"G"	"C" REF		
	-S(-RA), -D, -T	-D, -T	-S-RA	-D-RA	-T-RA
-01, -21	0.104 [2.64]	.005 [13]	N/A	N/A	N/A
-02, -22	0.194 [4.93]	.005 [13]	0.100 [2.54]	0.100 [2.54]	0.100 [2.54]
-03, -23	0.394 [10.01]	+010/-012 [+25/-31]	0.300 [7.62]	0.300 [7.62]	N/A
-04, -24	0.584 [14.83]	+010/-012 [+25/-31]	0.490 [12.45]	N/A	N/A

UNLESS OTHERWISE SPECIFIED,
DIMENSIONS ARE IN INCHES.

PROPRIETARY NOTE

THIS DOCUMENT CONTAINS CONFIDENTIAL AND PROPRIETARY INFORMATION AND ALL DESIGN, MANUFACTURING, REPRODUCTION, USE, PATENT RIGHTS AND SALES RIGHTS ARE EXPRESSLY RESERVED BY SAMTEC, INC. THIS DOCUMENT SHALL NOT BE DISCLOSED, IN WHOLE OR PART, TO ANY UNAUTHORIZED PERSON OR ENTITY NOR REPRODUCED, TRANSFERRED OR INCORPORATED IN ANY OTHER PROJECT IN ANY MANNER WITHOUT THE EXPRESS WRITTEN CONSENT OF SAMTEC, INC.

TOLERANCES ARE:

DECIMALS	ANGLES
.XX: $\pm .01$ [0.3]	2°
.XXX: $\pm .005$ [0.13]	
.XXXX: $\pm .0020$ [0.051]	

MATERIAL: DO NOT SCALE DRAWING

INSULATOR: LCP, UL 94 VO, COLOR: BLACK
CONTACT: PHOS BRONZE

SHEET SCALE: 2:1

DESCRIPTION:

ASSEMBLY, SOCKET STRIP .025[0.64] SQ TAIL

DWG. NO.

SSQ-1XX-XX-XXX-X-XX-XXX-XX-X

BY: PURVIS 06/12/1987

SHEET 1 OF 3

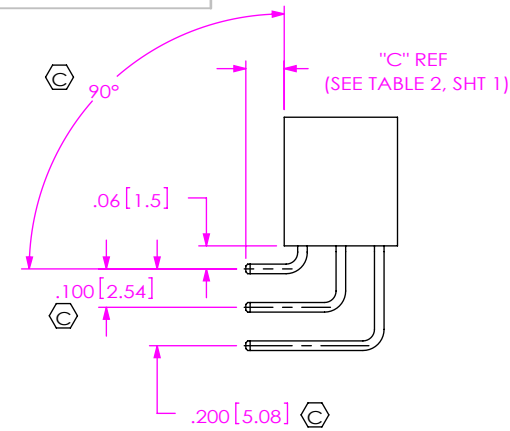

FIG 2
(DIFFERENT AS SHOWN,
OTHERWISE SAME AS FIG 1)
SSQ-1XX-X-S-RA
SSQ-1XX-X-D-RA
SSQ-1XX-X-T-RA
SSQ-1XX-X-P-RA

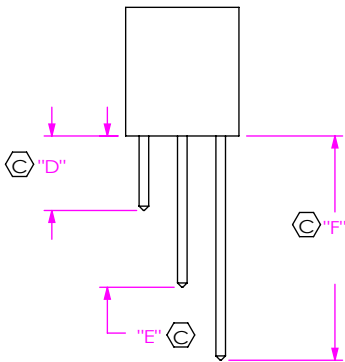

FIG 3
IN-PROCESS RIGHT ANGLE

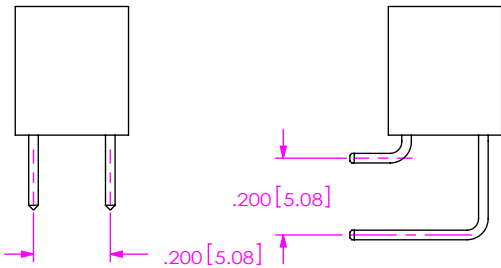

FIG 4
SSQ-1XX-XXX-X-Q-RA SHOWN
(DIFFERENT AS SHOWN,
OTHERWISE SAME AS FIG 1, FIG 2)

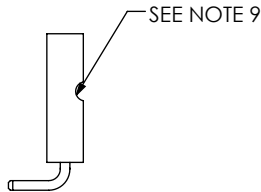
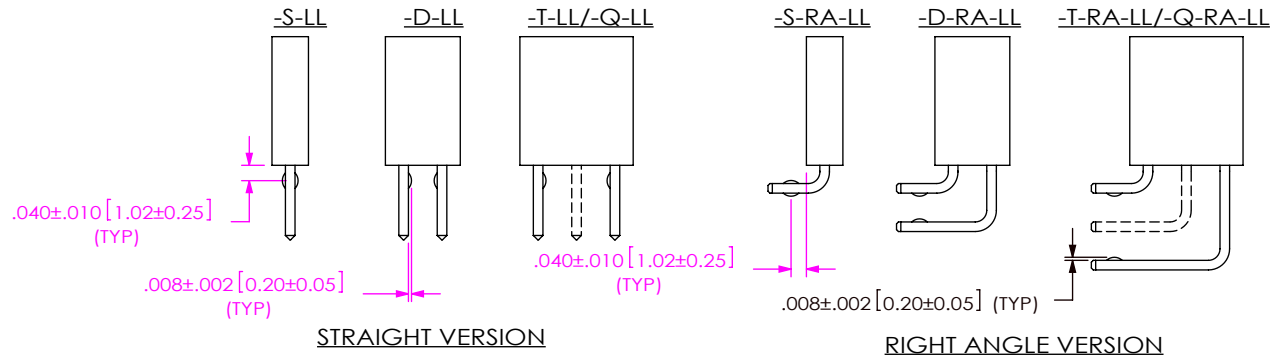

FIG 5
SSQ-1XX-XXX-X-RA-P SHOWN
(DIFFERENT AS SHOWN,
OTHERWISE SAME AS FIG 2)



STRAIGHT VERSION

RIGHT ANGLE VERSION

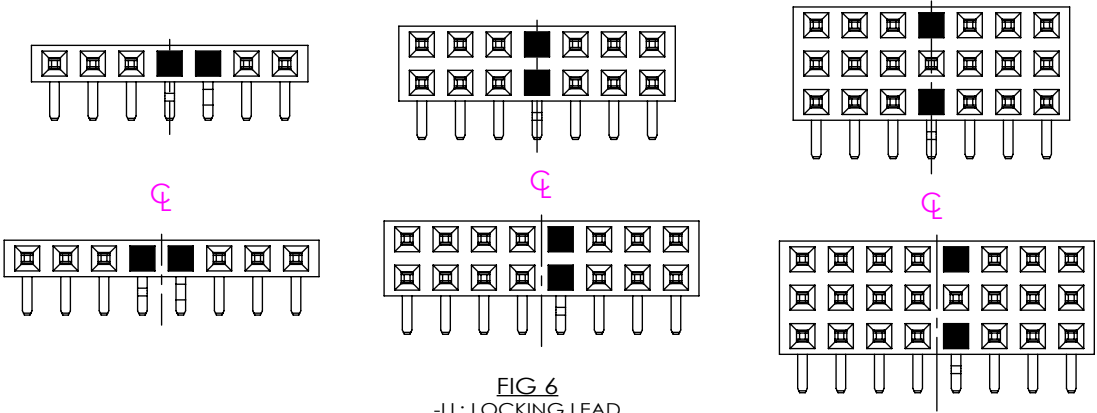

FIG 6
-LL: LOCKING LEAD
■ = CRIMP LOCATION
(DIFFERENT AS SHOWN,
OTHERWISE SAME AS FIG 1)

TABLE 3			
IN PROCESS	"D"	"E"	"F"
SSQ-1XX-02-X-D-RA	0.194 [4.93]	0.394 [10.01]	N/A
SSQ-1XX-03-X-D-RA	0.394 [10.01]	0.594 [15.09]	N/A
SSQ-1XX-02-X-T-RA	0.194 [4.93]	0.394 [10.01]	0.594 [15.09]

PROPRIETARY NOTE
THIS DOCUMENT CONTAINS CONFIDENTIAL AND
PROPRIETARY INFORMATION AND ALL DESIGN,
MANUFACTURING, REPRODUCTION, USE, PATENT RIGHTS
AND SALES RIGHTS ARE EXPRESSLY RESERVED BY SAMTEC,
INC. THIS DOCUMENT SHALL NOT BE DISCLOSED, IN WHOLE
OR PART, TO ANY UNAUTHORIZED PERSON OR ENTITY NOR
REPRODUCED, TRANSFERRED OR INCORPORATED IN ANY
OTHER PROJECT IN ANY MANNER WITHOUT THE EXPRESS
WRITTEN CONSENT OF SAMTEC, INC.

DO NOT SCALE DRAWING

SHEET SCALE: 2:1



520 PARK EAST BLVD, NEW ALBANY, IN 47150
PHONE: 812-944-6733 FAX: 812-948-5047
e-Mail info@SAMTEC.com code 55322

DESCRIPTION:
ASSEMBLY, SOCKET STRIP .025[0.64] SQ TAIL

DWG. NO.
SSQ-1XX-XX-XXX-X-XX-XXX-XX-X

BY: PURVIS 06/12/1987 SHEET 2 OF 3

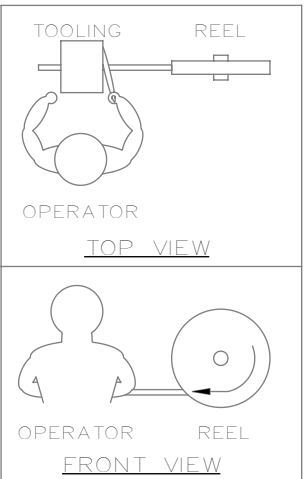
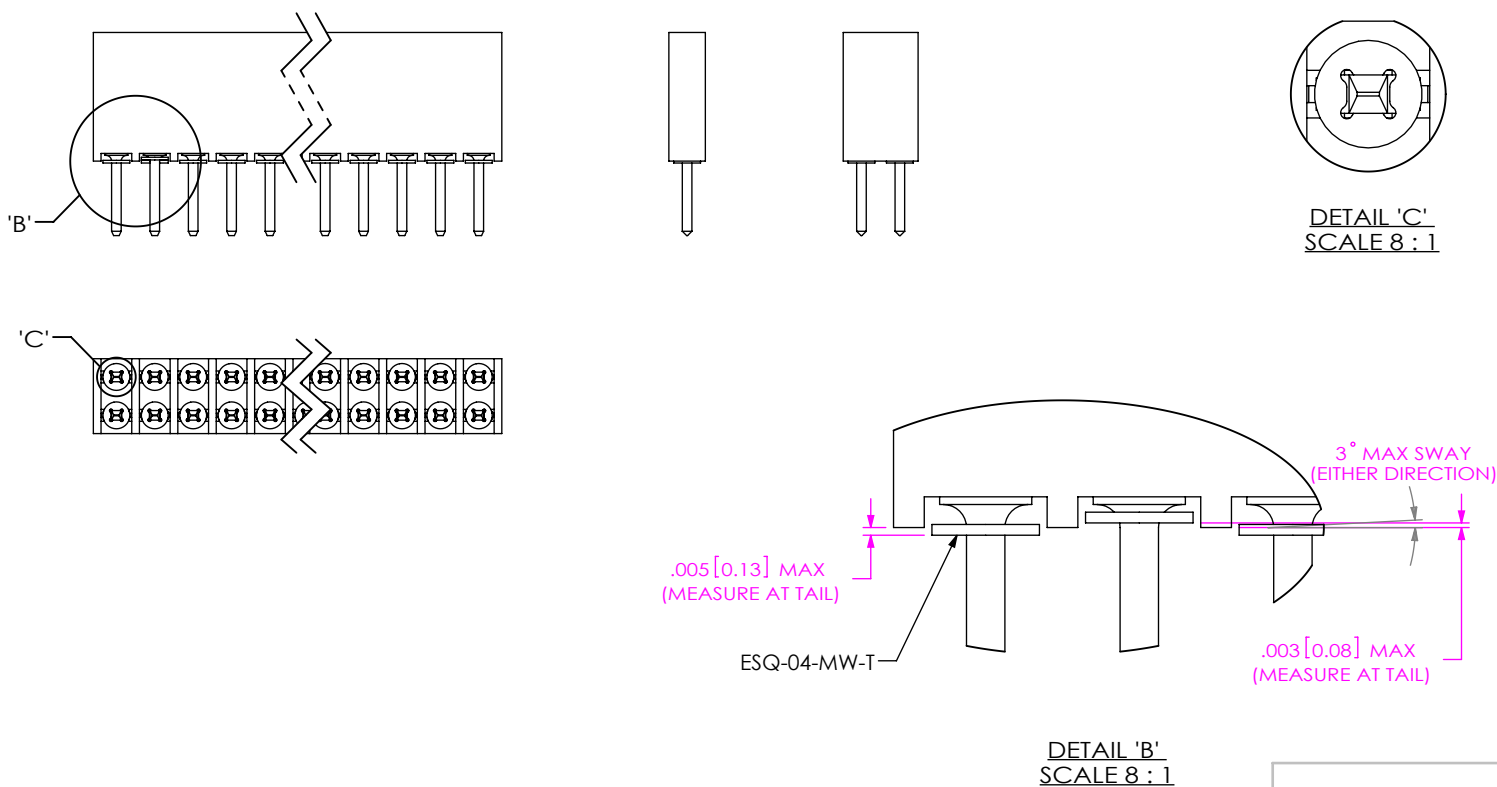

WASHER REEL ASSEMBLY
ORIENTAION VIEW

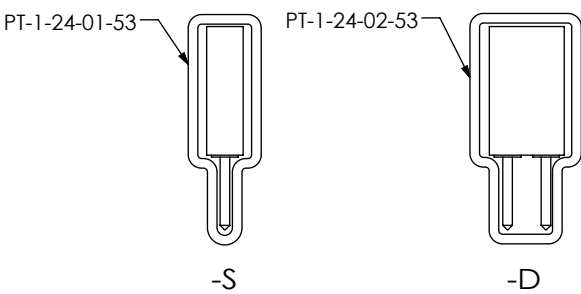

FIG 9
FOR METAL WASHERS ONLY
(ALL OTHER OPTIONS BULK PACKAGED)

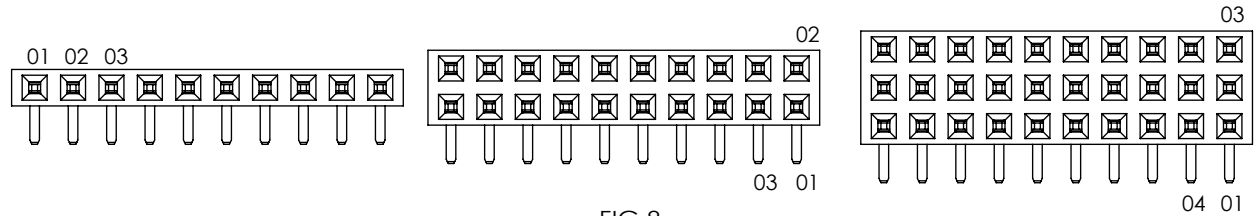

FIG 8
POLARIZATION LOCATION
INSERT PK-15-N INTO SPECIFIED POS
AND BREAK OFF TAB

PROPRIETARY NOTE
THIS DOCUMENT CONTAINS CONFIDENTIAL AND
PROPRIETARY INFORMATION AND ALL DESIGN,
MANUFACTURING, REPRODUCTION, USE, PATENT RIGHTS
AND SALES RIGHTS ARE EXPRESSLY RESERVED BY SAMTEC,
INC. THIS DOCUMENT SHALL NOT BE DISCLOSED, IN WHOLE
OR PART, TO ANY UNAUTHORIZED PERSON OR ENTITY NOR
REPRODUCED, TRANSFERRED OR INCORPORATED IN ANY
OTHER PROJECT IN ANY MANNER WITHOUT THE EXPRESS
WRITTEN CONSENT OF SAMTEC, INC.

DO NOT SCALE DRAWING
SHEET SCALE: 2:1



520 PARK EAST BLVD, NEW ALBANY, IN 47150
PHONE: 812-944-6733 FAX: 812-948-5047
e-Mail: info@SAMTEC.com code 55322

DESCRIPTION:
ASSEMBLY, SOCKET STRIP .025[0.64] SQ TAIL
DWG. NO.
SSQ-1XX-XX-XXX-X-XX-XXX-XX-X

BY: PURVIS 06/12/1987 SHEET 3 OF 3