

SUMMARY

Wires

Low	68
High	0
Coax	0
Triax	0
Quad	0
Fiber	0
Fluidic	0

Series	LM
Termination type	Male crimp
IP rating	68
Cable Ø	11.35 - 22.70 mm
Matching parts	HEW.LM.368.XLNP
Status	active
Alternative part	



Image is for illustrative purpose only

Download

[Request a quote](#)

[Catalog](#)

TECHNICAL DETAILS

Mechanics

Shell Style/Model	FM*: Straight plug, key (N) or keys (P, R, S, T, U, V, W and X) with knurled grip and mold stop
Keying	5 keys (alpha=95, beta=115, gamma=35, delta=25, plug: male contacts, receptacle: female contacts)
Housing Material	Environment friendly aluminium (nickel plated, anthracite color) shell and nut, other pieces bronze/brass
Cable Fixing	∅ 11.35 - 22.7 mm
Variant	

Performance

Configuration	
Insulator	
Rated Current	2.5 Amps

Specifications

Contact Type: Crimp

LEMO products and services are provided "as is". LEMO makes no warranties or representations with regard to LEMO product & services or use of them, express, implied or statutory, including for accuracy, completeness, or security. The user is fully responsible for his products and applications using LEMO components.

Max. Matings: 5000
Contact Retention: 22 N
Contact Dia.: 0.7 mm (0.028in)
Bucket Dia.: 0.45 mm (0.018in)
Min. Conductor: 0.035 mm^2 (AWG 32)
Max. Conductor: 0.09 mm^2 (AWG 28)
R (max): 6.1 mOhm
Test voltage (kV rms) Contact-contact: 1.40
Test voltage (kV rms) Contact-shell: 1.65

Others

Humidity (max): <=95% [at 60 deg C / 140 F]
Vibration: 15 g [10 Hz - 2000 Hz]
Shock Resistance: 100 g [6 ms]
Operating temperature: -55°C/ +200°C
Climatical Category: 15/200/21 (Al. shell)
Lighting strike EIA 364-75 10K amps - 6 times
EMI Shielding EIA 364-66A - 1Ghz-80 dB,3GHz-70 dB,6GHz- 58dB
IP Rating: 68

DRAWINGS

Draws

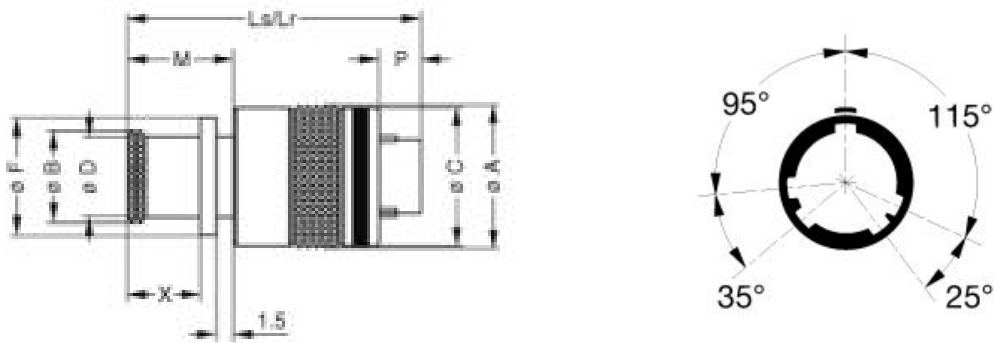

Dimensions

	A	B	C	D	F	Lr	Ls	M	P	X
mm.	28.5	23.9	28	22.7	25.8	31.6	31.6	10.6	3.4	7.6
in.	1,12	0,94	1,10	0,89	1,02	1,24	1,24	0,42	0,13	0,30

LEMO products and services are provided “as is”. LEMO makes no warranties or representations with regard to LEMO product & services or use of them, express, implied or statutory, including for accuracy, completeness, or security. The user is fully responsible for his products and applications using LEMO components.

RECOMMENDED BY LEMO

Tools

Crimp Tool: DPC.91.701.V

Crimp settings: AWG/Selector = 28-30-32/4-3-3

Positionner: DCE.91.070.5MVC

Extractor: DCF.93.070.4LT

Replacement contact: FGN.0M.556.ZZC

Cables

LEMO products and services are provided "as is". LEMO makes no warranties or representations with regard to LEMO product & services or use of them, express, implied or statutory, including for accuracy, completeness, or security. The user is fully responsible for his products and applications using LEMO components.