

## Fiber Optic Couplers and Adaptors

These devices are used to join together individual connectorized fiber assemblies. They are often used in a patch panel and are mounted on sub-panels. If the two connectorized fiber assemblies to be connected have the same style fiber connectors (ST to ST, SC to SC, etc.) then the connecting device is called a coupler. If the two connectorized fiber assemblies to be connected have different style connectors then the connecting device is called an adaptor.

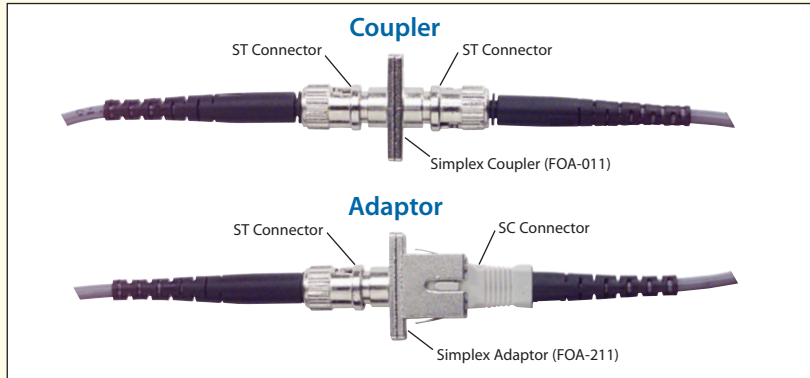

## Common Adaptor Mounting Diagrams

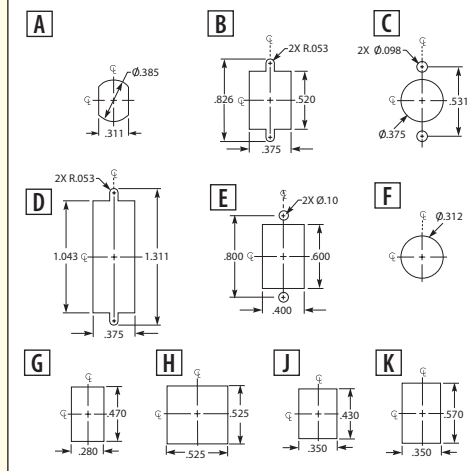

The alignment sleeve is the most critical component of a fiber optic adaptor. Bronze sleeves are more durable but the precision is not as good as ceramic. Ceramic ferrules offer a more precise alignment, but they are somewhat less durable. Bronze alignment sleeves are commonly used in multimode applications where precision alignment is not as critical.

## Cutaway Side View of ST-ST Coupler

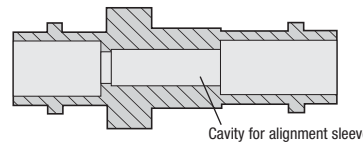

CERAMIC Alignment Sleeve

- Better alignment
- More expensive

BRONZE Alignment Sleeve

- Better durability
- Less expensive



Item #	Description	Body	Sleeve	Mtg. Code	1-9	10-24	25-99	100-249	250-499
--------	-------------	------	--------	-----------	-----	-------	-------	---------	---------

### Fiber Optic Simplex and Duplex Couplers

These fiber optic couplers are for the most part available in both Simplex (single connection) and Duplex (two connections) styles. Most are available with both plastic and metal bodies and with bronze or ceramic alignment sleeves. Suitable for both PC and UPC polish fibers.

### ST to ST Simplex Fiber Optic Couplers

FOA-001	Fiber Coupler	Metal	Bronze	A	3.00	2.70	2.40	2.10	1.80
FOA-001A	Fiber Coupler	Metal	Ceramic	A	5.00	4.50	4.00	3.50	3.00
FOA-011	Fiber Coupler	Metal	Bronze	B	3.00	2.70	2.40	2.10	1.80
FOA-011A	Fiber Coupler	Metal	Ceramic	B	5.00	4.50	4.00	3.50	3.00

### ST to ST Duplex Fiber Optic Couplers

FOA-401	Fiber Coupler	Metal	Bronze	D	5.00	4.50	4.00	3.50	3.00
FOA-401A	Fiber Coupler	Metal	Ceramic	D	10.00	9.00	8.00	7.00	6.00

### SC to SC Simplex Fiber Optic Couplers

FOA-002	Fiber Coupler	Plastic	Bronze	B	4.00	3.60	3.20	2.80	2.40
FOA-002A	Fiber Coupler	Plastic	Ceramic	B	5.50	4.95	4.40	3.85	3.30
FOA-002M	Fiber Coupler	Metal	Bronze	B	5.00	4.50	4.00	3.50	3.00
FOA-002MA	Fiber Coupler	Metal	Ceramic	B	7.50	6.75	6.00	5.25	4.50

### SC to SC Duplex Fiber Optic Couplers

FOA-005	Fiber Coupler	Plastic	Bronze	D	5.50	4.95	4.40	3.85	3.30
FOA-005A	Fiber Coupler	Plastic	Ceramic	D	8.00	7.20	6.40	5.60	4.80
FOA-005M	Fiber Coupler	Metal	Bronze	D	8.00	7.20	6.40	5.60	4.80
FOA-005MA	Fiber Coupler	Metal	Ceramic	D	10.00	9.00	8.00	7.00	6.00

### FC to FC Simplex Fiber Optic Couplers

FOA-003	Fiber Coupler	Metal	Bronze	C	6.50	5.85	5.20	4.55	3.90
FOA-003A	Fiber Coupler	Metal	Ceramic	C	9.50	8.55	7.60	6.65	5.70
FOA-013	Fiber Coupler	Metal	Bronze	B	6.50	5.85	5.20	4.55	3.90
FOA-013A	Fiber Coupler	Metal	Ceramic	B	9.50	8.55	7.60	6.65	5.70
FOA-033	Fiber Coupler	Metal	Bronze	A	6.50	5.85	5.20	4.55	3.90
FOA-033A	Fiber Coupler	Metal	Ceramic	A	9.50	8.55	7.60	6.65	5.70

### SMA906 to SMA906 Simplex Fiber Optic Coupler

FOA-004	Fiber Coupler	Metal	None	F	20.75	19.92	19.09	18.26	17.43
---------	---------------	-------	------	---	-------	-------	-------	-------	-------

### LC to LC Simplex / Duplex Fiber Optic Coupler

FOA-500A	Simplex Fiber Coupler	Plastic	Ceramic	G	9.50	8.55	7.60	6.65	5.70
FOA-550A	Duplex Fiber Coupler	Plastic	Ceramic	H	14.75	13.28	11.80	10.33	8.85

### MU to MU Simplex / Duplex Fiber Optic Coupler

FOA-701	Simplex Fiber Coupler	Plastic	Ceramic	J	10.50	9.87	9.24	8.61	7.98
FOA-702	Duplex Fiber Coupler	Plastic	Ceramic	K	17.25	16.22	15.18	14.15	13.11

### MT-RJ to MT-RJ Fiber Optic Coupler

Use of this coupler requires one of the two mating MTRJ connectors to contain alignment pins.

FOA-600	Fiber Coupler	Plastic	None	B	4.00	3.60	3.20	2.80	2.40
---------	---------------	---------	------	---	------	------	------	------	------

### MTP to MTP Fiber Optic Coupler

FOA-012	Fiber Coupler	Plastic	None	E	25.00	23.00	21.00	19.00	17.00
---------	---------------	---------	------	---	-------	-------	-------	-------	-------