

DO NOT
SCALE FROM
THIS PRINT

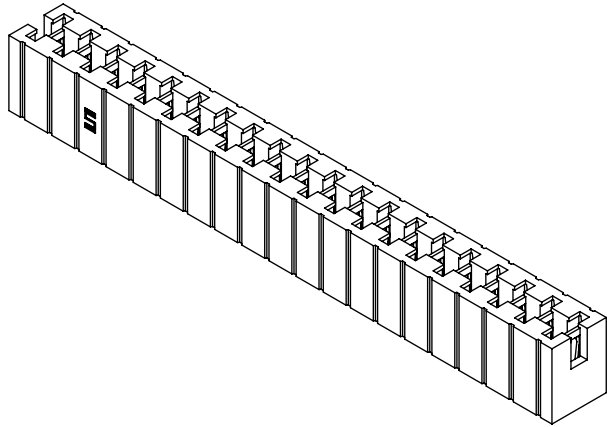

MNT-1XX-XX-X

No OF POSITION
-01 THRU -20

LEAD STYLE

SPECIFY COLOR IN BODY SUFFIX -XX
BK = BLACK

PLATING SPECIFICATION

-T: MATTE TIN
-G: 10μ" GOLD IN CONTACT
AREA, MATTE TIN ON REMAINDER
-H: 30μ" GOLD IN CONTACT
AREA, MATTE TIN REMAINDER

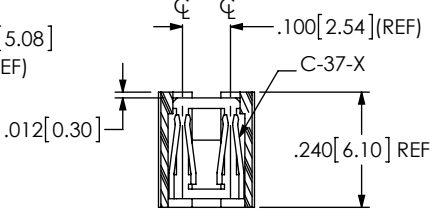
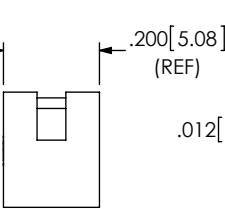
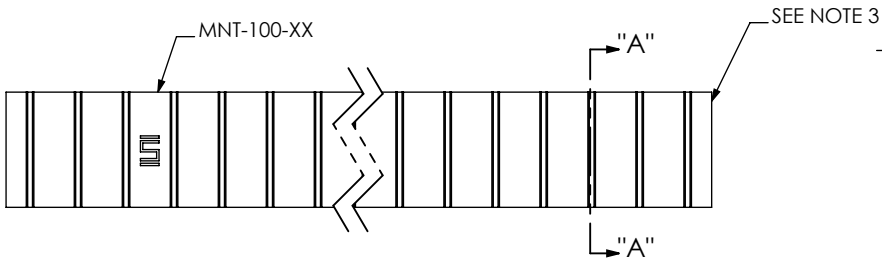
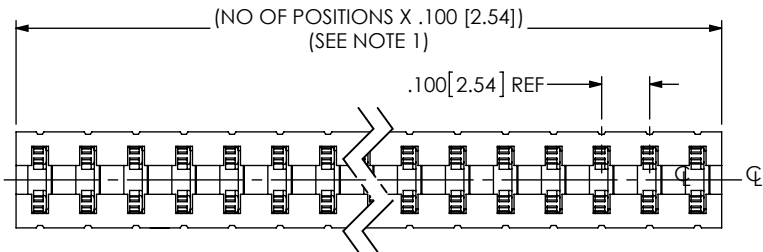

SECTION "A"-"A"
SCALE 2.5 : 1

NOTES:

1. MULTI-CUT WIDTH TOLERANCED TO $\pm .015 [0.38]$ REPRESENTS A CRITICAL DIMENSION. ROTO-CUT WIDTH TOLERANCED TO $\pm .010 [0.25]$.
2. MINIMUM RETENTION: 24 oz
3. ENDWALL AFTER CUTTING $.0245 \pm .010 [.622 \pm .25]$
4. $.015 [0.38]$ MAXIMUM CUT FLASH. LOOSE CUT FLASH MUST BE REMOVED.

UNLESS OTHERWISE SPECIFIED,
DIMENSIONS ARE IN INCHES.

TOLERANCES ARE:

DECIMALS ANGLES
.XX: $\pm .01 [.3]$ 2°
.XXX: $\pm .005 [.13]$
.XXXX: $\pm .0020 [.051]$

PROPRIETARY NOTE

THIS DOCUMENT CONTAINS CONFIDENTIAL AND
PROPRIETARY INFORMATION AND ALL DESIGN,
MANUFACTURING, REPRODUCTION, USE, PATENT RIGHTS
AND SALES RIGHTS ARE EXPRESSLY RESERVED BY SAMTEC,
INC. THIS DOCUMENT SHALL NOT BE DISCLOSED, IN WHOLE
OR PART, TO ANY UNAUTHORIZED PERSON OR ENTITY NOR
REPRODUCED, TRANSFERRED OR INCORPORATED IN ANY
OTHER PROJECT IN ANY MANNER WITHOUT THE EXPRESS
WRITTEN CONSENT OF SAMTEC, INC.



520 PARK EAST BLVD, NEW ALBANY, IN 47150
PHONE: 812-944-6733 FAX: 812-948-5047
e-Mail info@SAMTEC.com code 55322

DO NOT SCALE DRAWING

SHEET SCALE: 3:1

INSULATOR: LCP, UL 94 V-O, COLOR BLACK
50% REGRIND
TERMINAL: BeCu, 1/2 HARD, AGE HARDENED

DESCRIPTION:
.050 .050 EDGE MOUNT SOCKET STRIP DUAL ROW ASSEMBLY

DWG. NO. MNT-1XX-XX-X

BY: KOLB

2-20-89

SHEET 1 OF 1