

Connectors in 3.81 mm pitch Series BC/SC 3.81

SC-SMT 3.81/././180

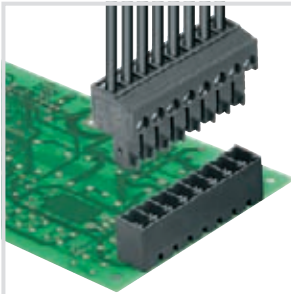

High-temperature-resistant male header.

- Plugging direction is perpendicular to PCB
- Available in closed (G) and with solder flange (LF).
- Packed either in box (BX) or on anti-static roll (tape-on-reel, RL)
- Pin length of either 1.5 mm or 3.2 mm

Weidmüller's 3.81-mm-pitch (0.15 inch) plug-in connectors are compatible with the layouts of standard connectors and offer space for labelling and coding.

Technical data

In compliance with IEC 60664-1 / IEC 61984				
Clamping range, max.	mm ²			
Solid core H05(07) V-U	mm ²			
Stranded H07 V-R				
Flexible H05(07) V-K	mm ²			
Flexible with ferrule	mm ²			
Ferrule with plastic collar	mm ²			
Stripping length	mm			
Screwdriver blade	mm			
According to norm				
Tightening torque range	Nm			
Rated current, max.	A	17.5	17	
At ambient temperature		20°C	40°C	
For conductor cross-section	mm ²			
Overvoltage category		III	III	II
Pollution severity		3	2	2
Rated voltage	V	160	160	320
Rated impulse voltage	kV	2.5	2.5	2.5
UL / CUL (Use Group)		B	C	D
Rated voltage	V	300		300
Rated current	A	10		10
AWG conductor	AWG		-	
CSA (Use Group)		B	C	D
Rated voltage	V	300		300
Rated current	A	10		10
AWG conductor	AWG		-	
General data				
Type of insulation material		LCP GF		
Flammability class UL 94		V-0		
Contact base material		Copper alloy		
Material of contact surface		tinned		
Pin dimensions = d	mm	1.0, Octagonal		
Solder eyelet Ø = D	mm	1.3		
Solder eyelet Ø tolerance	mm	+ 0,1		

Product data

IEC: 320 V / 17.5 A
UL: 300 V / 10 A

For additional articles and information, refer to catalog.weidmueller.com

Note:

- Additional colours on request
- Gold-plated contact surfaces on request
- Rated current related to rated cross-section and min. No. of poles.
- Rated data refer only to the component itself. Clearance and creepage distances to other components are to be designed in accordance with the relevant application standards.
- P on drg. = pitch

SC-SMT 3.81/././180G Box



Dimensioned drawing

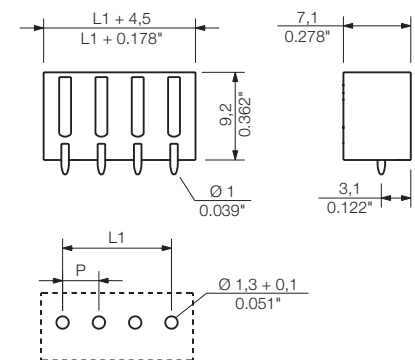

Accessories

Note: Refer to the Accessories chapter for additional accessories.

Coding	Order No.
SC-SMT 3.81 KO GR	1968900000

Ordering data

Solder pin length				1.5 mm	3.2 mm
Colour				black	black
Pitch 3.81 mm					
Pol.	L1	(inch)	Qty.	Order No.	Order No.
2	3.81	0.150	50	1863720000	1862920000
3	7.62	0.300	50	1863730000	1862940000
4	11.43	0.450	50	1863750000	1862950000
5	15.24	0.600	50	1863780000	1863010000
6	19.05	0.750	50	1863830000	1863020000
7	22.86	0.900	50	1863880000	1863030000
8	26.67	1.050	50	1863900000	1863240000
9	30.48	1.200	50	1863910000	1863270000
10	34.29	1.350	50	1863920000	1863290000
11	38.10	1.500	50	1863930000	1863320000
12	41.91	1.650	50	1863940000	1863330000
13	45.72	1.800	50	1863950000	1863350000
14	49.53	1.950	50	1863960000	1863370000
15	53.34	2.100	50	1864030000	1863400000
16	57.15	2.250	50	1864040000	1863420000