



COMPONENT FOR ENCLOSURE,  
22MM LAMP HOLDER BA 9S WITHOUT LAMP RATED  
VOLTAGE ACC.TO LAMP SCREW TERMINAL

### Contact block / lampholder

product designation		lampholder
Number of NC contacts / for auxiliary contacts		0
Number of NO contacts / for auxiliary contacts		0
Number of change-over switches / for auxiliary contacts		0
Product function / positive opening		No
Number of lampholders		1
Execution of the mounting		BA 9s
Nature of fluorescent material		filament lamp
Design of the electrical connection		screw-type terminals

### General technical details:

Degree of pollution		class 3
Design of the fuse link / for short-circuit protection of the auxiliary switch / with type of assignment 1 / required		gG / Dz 10 A
Type of voltage / of the operating voltage		AC/DC
Item designation		P H
Ambient temperature		

• during operating	°C	-25 ... +60
• during storage	°C	-25 ... +80
<b>protection class IP</b>		
• of the terminal		IP20
• of the housing		IP40
<b>Operating voltage</b>		
• at 50 Hz / at AC / rated value	V	6 ... 230
• at 60 Hz / at AC / rated value	V	6 ... 230
• for DC		
• rated value	V	6 ... 230
<b>Suitability for integration</b>		
• pressure selection button		front element
• front element		Yes
• suspension switch		Yes
• suspension pushbutton		Yes
<b>Insulation voltage / rated value</b>	V	250
<b>Impulse voltage resistance / rated value</b>	kV	4
<b>Tightening torque / for auxiliary contacts / with screw-type terminals</b>	N·m	0.8
<b>Product component</b>		
• fluorescent materials		No
• diode		No
• lamp transformer		No
• series resistance		No
<b>Type of mounting</b>		floor mounting

#### Connections:

##### Type of the connectable conductor cross-section

- for auxiliary contacts / solid
- for auxiliary contacts / solid / with conductor end processing
- for auxiliary contacts / finely stranded / with conductor end processing
- for AWG conductors / for auxiliary contacts

2x (1 ... 1.5 mm<sup>2</sup>)  
2x (0.5 ... 0.75 mm<sup>2</sup>)  
2x (0.5 ... 1.5 mm<sup>2</sup>)  
2x (18 ... 14)

#### Certificates/approvals:

##### General Product Approval

##### other



[Confirmation](#)

[Environmental  
Confirmations](#)

#### Further information:

---

**Information- and Downloadcenter (Catalogs, Brochures,...)**

<http://www.siemens.com/industrial-controls/catalogs>

---

**Industry Mall (Online ordering system)**

<http://www.siemens.com/industrial-controls/mall>

---

**Cax online generator:**

<http://www.siemens.com/cax>

---

**Service&Support (Manuals, Certificates, Characteristics, FAQs,...)**

<http://support.automation.siemens.com/WW/view/en/3SB3420-1A/all>

---

**Image database (product images, 2D dimension drawings, 3D models, device circuit diagrams, ...)**

[http://www.automation.siemens.com/bilddb/cax\\_en.aspx?mlfb=3SB3420-1A](http://www.automation.siemens.com/bilddb/cax_en.aspx?mlfb=3SB3420-1A)

---

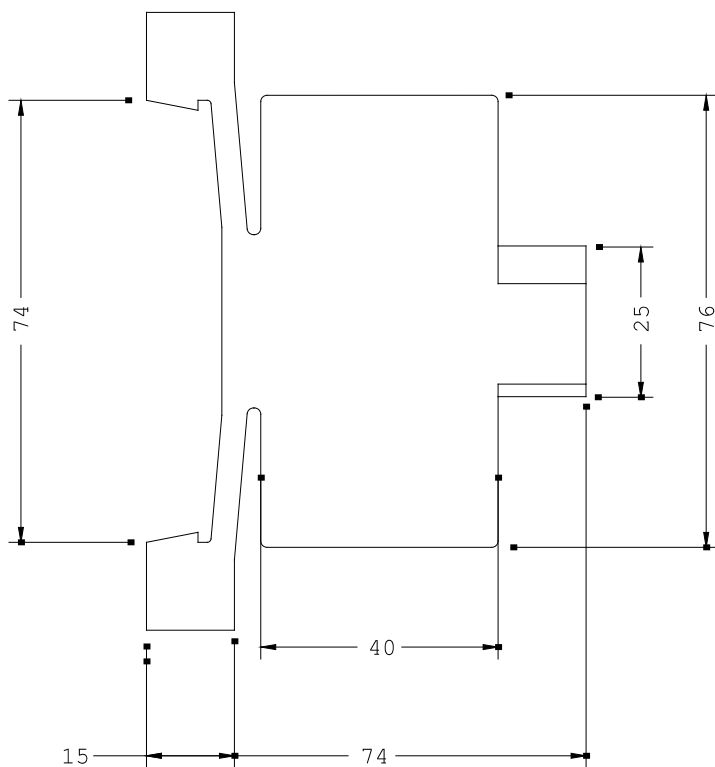
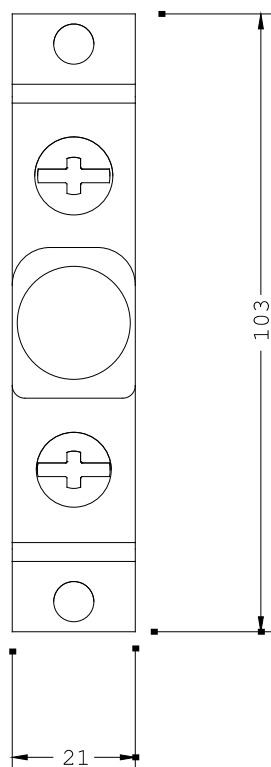

**last change:**

Dec 7, 2012