

POS 1 POS 2 POS 3

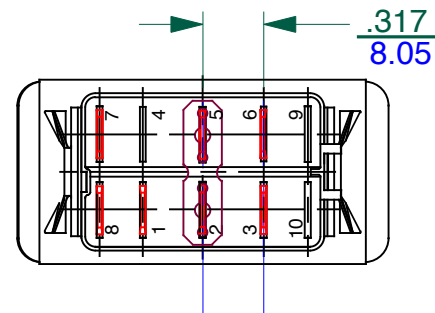
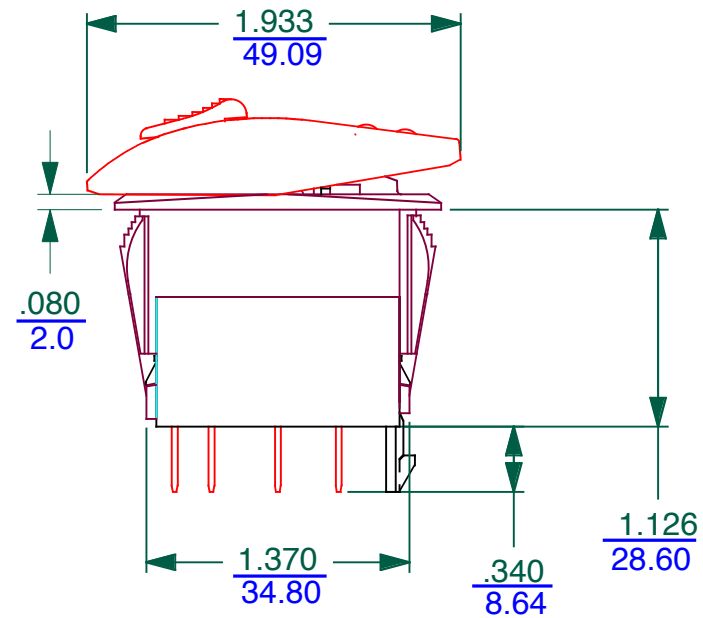
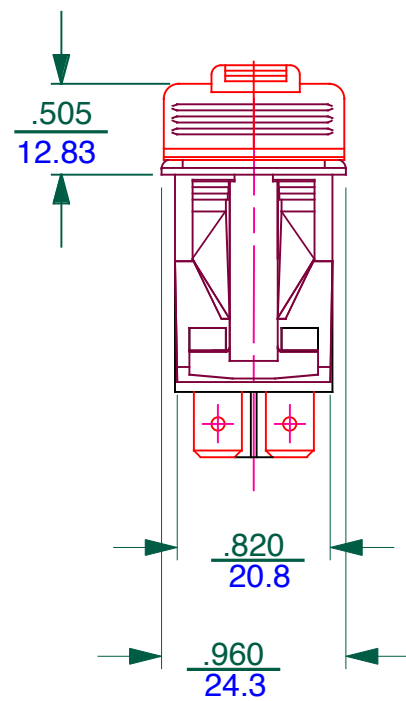

DWG NO.
VX1KXWXX-C8100-000-XBLU1

A diagram of a rectangle with a red border. Above the rectangle, a horizontal dimension line with arrows at both ends is labeled $\frac{.830}{21.0}$. To the right of the rectangle, a vertical dimension line with arrows at both ends is labeled $\frac{1.450}{36.83}$.

PANEL THICKNESS
(SNAP - IN BRACKET)
.030 MIN ---- .187 MAX
.76 4.75

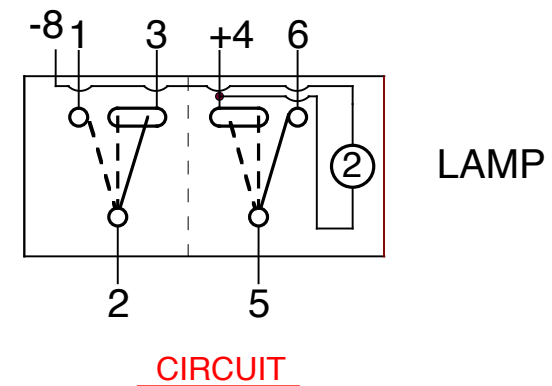
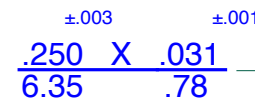

LET	REVISIONS	DATE

0.4 VA MAX. @ 28V MAX
(RESISTIVE)

<u>POS 1</u>	<u>POS 2</u>	<u>POS 3</u>
ON	ON	(ON)
2 TO 3	2 TO 3	2 TO 1
5 TO 6	5 TO 4	5 TO 4

1. BRACKET IS BLACK NYLON
2. ROCKER IS BLACK NYLON
WITH WHITE POLYCARBONATE
LENS
3. LOCK COLOR IS BLACK
4. 12V BLUE LED T4+ TO T8-
5. SPECIAL BRACKET DESIGNED
TO PREVENT ACTUATION
FROM POS 2 TO POS 1 ONLY
YOU MUST ACTUATE THE LOCK
AND PRESS DOWN ROCKER
TO ACTUATE THE SWITCH FROM
POS 2 TO POS 1
THE LOCK DOES NOT HAVE TO
BE USED TO ACTUATE THE
SWITCH FROM POS 2 TO POS 3

FINISH

NOTICE TO ALL PERSONS RECEIVING
THIS DRAWING. THIS DOCUMENT IS THE
PROPERTY OF CARLINGSWITCH, INC.
AND IS NOT TO BE DISCLOSED,
REPRODUCED IN WHOLE OR IN PART OR
USED FOR MANUFACTURING PURPOSES
BY ANYONE WITHOUT THE CONSENT OF
CARLINGSWITCH, INC.

X.XXX ±.015



DIMENSIONS
IN [mm]

DR BY	DATE
KRAMARZ	8-8-12

CHK BY	DATE
--------	------

APPD BY	DATE
---------	------

TITLE	"V" SERIES SWITCH
-------	-------------------

SIZE	DWG NO.	REV.
B	VX1KXWXX-C8100-000-XBLU1	

USED ON	SCALE: FULL	SHT 1 OF 1
---------	-------------	------------