

3RU1116-1FB0 OVERLOAD RELAY, 3.5...5 A,

Technical / CAx data

☒ Technical Data ☐ CAx data

As of 2012-02-20

OVERLOAD RELAY, 3.5...5 A, 1NO+1NC, SIZE S00, CLASS 10, FOR CONTACTOR MOUNTING



General technical details:

product brand name		SIRIUS
product designation		thermal overload relay
Protection class IP / on the front		IP20
Insulation voltage / with degree of pollution 3 / rated value	V	690
Installation altitude / at a height over sea level / maximum	m	2,000
Ambient temperature		
• during operating	°C	-20...+70
• during storage	°C	-55...+80
• during transport	°C	-55...+80
Relative humidity / during operating phase / maximum	%	100
Resistance against shock		8g / 10 ms
Impulse voltage resistance / rated value	kV	6
Active power loss / total / typical	W	6.6
Item designation		
• according to DIN 40719 extendable after IEC 204-2 / according to IEC 750		F
• according to DIN EN 61346-2		F
Operating current / of the fuse link / rated value	A	20
Trip class		CLASS 10
Type of assignment		2
type of protection		DMT 98 ATEX G 001
Size of overload relay		S00
Size of the contactor / can be combined / company-specific		S00

Protection against electrical shock		finger-safe	
Main circuit:			
Number of poles / for main current circuit	3		
Operating voltage / at AC-3 / rated value <ul style="list-style-type: none">maximum	V	690	
Service power / at AC-3 <ul style="list-style-type: none">at 400 V	kW	1.5	
Adjustable response current <ul style="list-style-type: none">of the current-dependent overload release	A	3.5...5	
Auxiliary circuit:			
Contact reliability / of the auxiliary contacts	acceptability for PLC control (17 V, 5 mA)		
Number of NC contacts	1		
Number of NO contacts	1		
Number of change-over switches	0		
Operating current / of the auxiliary contacts / at AC-15 <ul style="list-style-type: none">at 24 Vat 110 Vat 120 Vat 125 Vat 230 Vat 400 V	A	3	
	A	3	
	A	3	
	A	3	
	A	2	
	A	1	
Operating current / of the auxiliary contacts / at DC-13 <ul style="list-style-type: none">at 24 Vat 110 Vat 125 Vat 220 V	A	1	
	A	0.22	
	A	0.22	
	A	0.11	
Short-circuit:			
Design of the fuse link / for short-circuit protection of the auxiliary switch / required	fuse gL/gG: 6 A, quick: 10 A		
Installation/mounting/dimensions:			
Built in orientation	with vertical mounting surface +/-135°rotatable, with vertical mounting surface +/- 45°tiltable to the front and back		
Type of mounting	direct mounting		
Height	mm	87	
Width	mm	45	
Depth	mm	78	
Distance, to be maintained, to the ranks assembly <ul style="list-style-type: none">upwardsdownwardsforwardsbackwardssideways	mm	0	
	mm	0	
	mm	0	
	mm	0	
	mm	0	
Distance, to be maintained, to earthed part <ul style="list-style-type: none">upwardsdownwardsforwardsbackwardssideways	mm	0	
	mm	0	
	mm	0	
	mm	0	
	mm	6	
Distance, to be maintained, conductive elements <ul style="list-style-type: none">upwardsdownwardsforwardsbackwards	mm	0	
	mm	0	
	mm	0	
	mm	0	

- sideways

mm 6

Connection type:

Product function

- removable terminal for auxiliary and control circuit

No

Design of the electrical connection

- for main current circuit
- for auxiliary and control current circuit

screw-type terminals

screw-type terminals

Type of the connectable conductor cross-section

- for main contacts
 - finely stranded
 - with conductor end processing
- for auxiliary contacts
 - solid
 - finely stranded
 - with conductor end processing
- for AWG conductors
 - for main contacts
 - for auxiliary contacts

2x (0.5 ... 1.5 mm²), 2x (0.75 ... 2.5 mm²)

2x (0.5 ... 1.5 mm²), 2x (0.75 ... 2.5 mm²)

2x (0.5 ... 1.5 mm²), 2x (0.75 ... 2.5 mm²)

2x (20 ... 16), 2x (18 ... 14), 2x 12

2x (20 ... 16), 2x (18 ... 14)

Conductor cross section that can be connected

- for main contacts
 - solid
 - stranded wire
 - with conductor end processing
- for auxiliary contact
 - solid
 - stranded wire
 - with conductor end processing

mm² 0.5...4

mm² 0.5...2.5

mm² 0.5...2.5

mm² 0.5...2.5

AWG number / as coded connectable conductor cross-section

- for main contacts / minimum
- for auxiliary contact

20

20...14

Certificates/approvals:

Verification of suitability

CSA / UL / CC / GL / LRS / BV / DNV / RMRS / RINA / PRS / ABS

Varification of suitability / ATEX

Yes

General Product Approval



CQC



CSA

ROSTEST

Shipping Approval



ABS (American Bureau of Shipping)



BV (Bureau Veritas)



DNV (Det Norske Veritas)

Shipping Approval

other



RINA (Registro Italiano Navale)



RMRS (Russian Maritime Register)

Manufacturer

Further information:

Information- and Downloadcenter (Catalogs, Brochures,...)

<http://www.siemens.com/industrial-controls/catalogs>

Industry Mall (Online ordering system)

<http://www.siemens.com/industrial-controls/mall>

CAX-Online-Generator

<http://www.siemens.com/cax>

Service&Support (Manuals, Certificates, Characteristics, FAQs,...)

<http://support.automation.siemens.com/WW/view/en/3RU1116-1FB0/all>

Image database (product images, 2D dimension drawings, 3D models, device circuit diagrams, ...)
http://www.automation.siemens.com/bilddb/cax_en.aspx?mlfb=3RU1116-1FB0

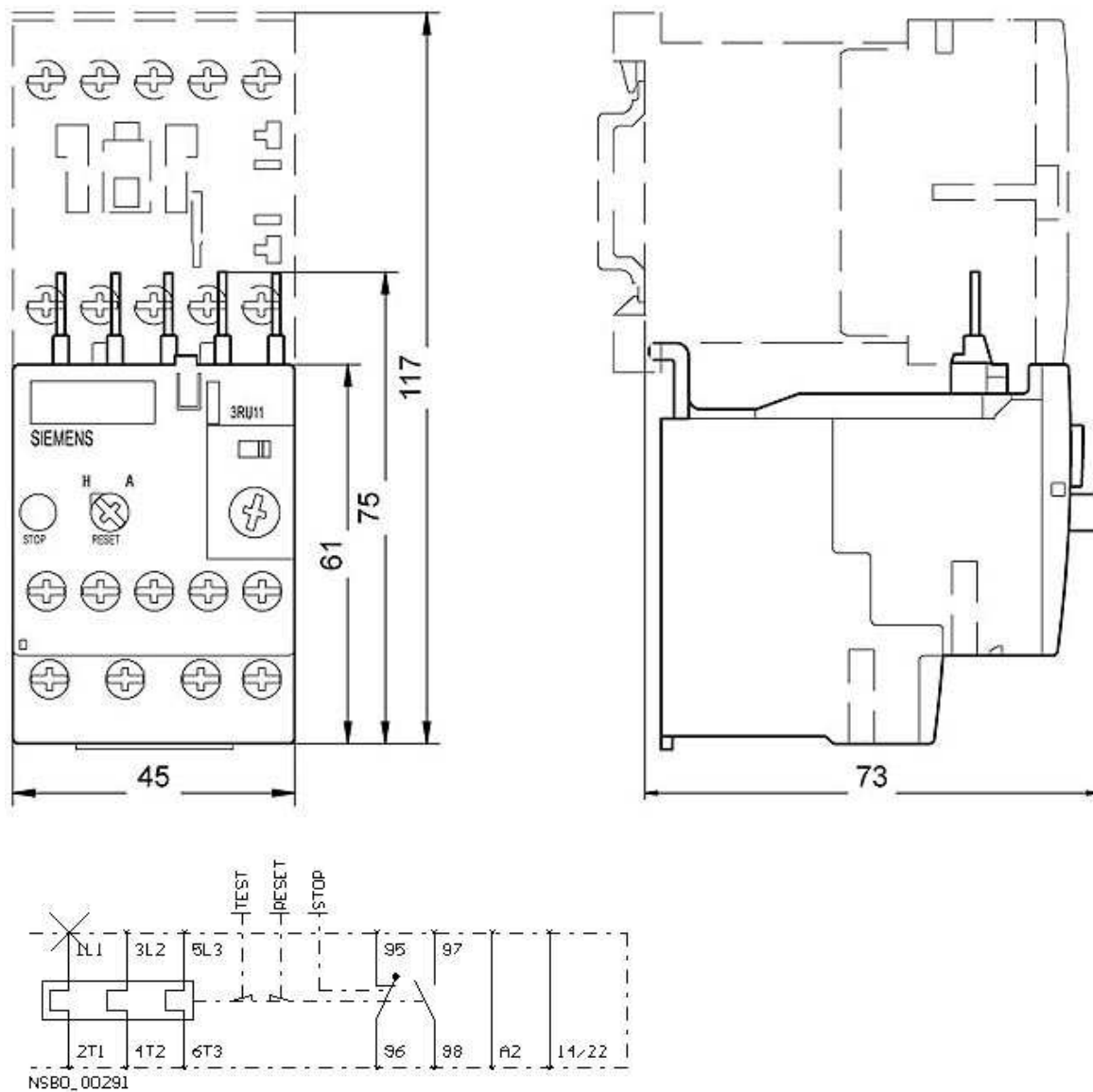

last change:

Feb 6, 2012