

DO NOT
SCALE FROM
THIS PRINT

RECOMMENDED LAYOUT FOR THE -DV SCREW DOWN OPTIONS
(0.177[4.50] HOLES CENTERED ON LSHM DV LAYOUT)

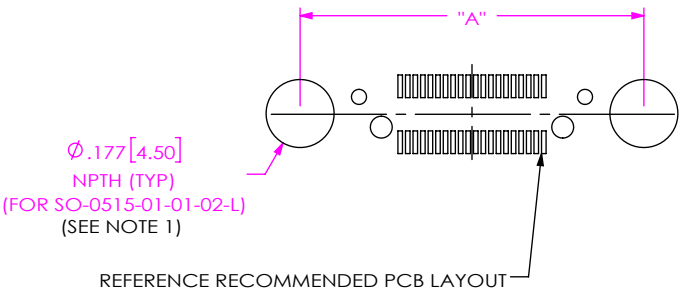
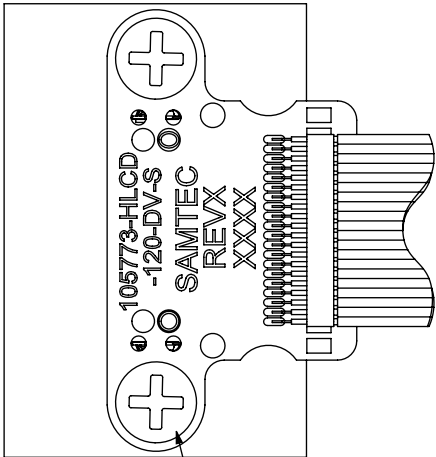
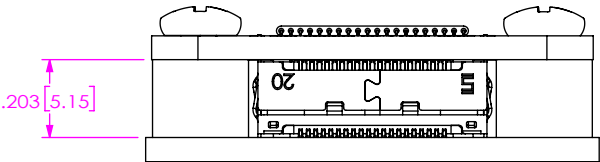

TABLE 1

NUMBER OF POS.	"A"
-05	0.5999 [15.237]
-10	0.6984 [17.739]
-20	0.8953 [22.741]
-30	1.1953 [30.361]
-40	1.4953 [37.981]
-50	1.7953 [45.601]

(SEE NOTE 1)
(SEE NOTE 1)



(SEE NOTE 1)
4/40 x 5/16" PHIL. HEAD
ROUND MACH. SCREW
MAX TORQUE 2-4 IN-OZ
(MAX TORQUE RECOMMENDATION
CAN BE INCREASED IF PCB
BOTTOMS OUT ON STANDOFF)

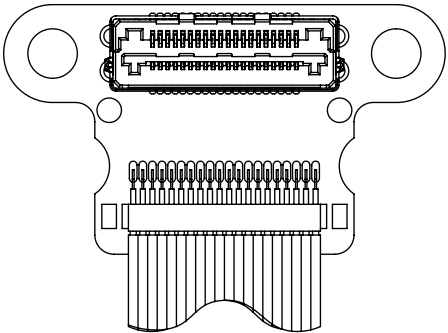
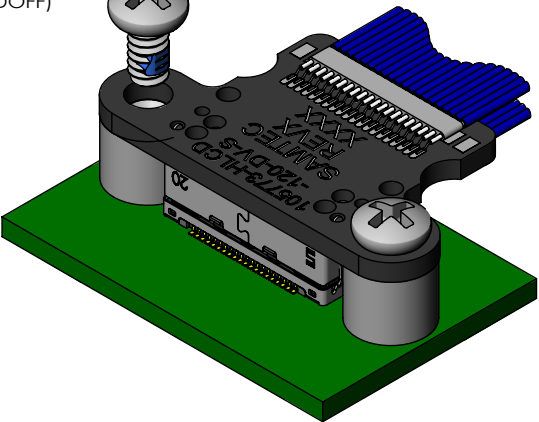
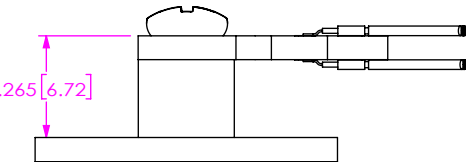

- NOTES:
- 05 AND -10 POSITION NOT APPLICABLE FOR USE WITH SO-0515-01-01-02-L AND 4/40 X 5/16" MACHINE SCREW. MICRO STANDOFF REQUIRED AT CUSTOMER DISCRETION AND JSOM-0515-01 IS RECOMMENDED. CONTACT SAMTEC HDR FOR FURTHER INQUIRIES.
 - THE HLCD CABLE ASSEMBLY IS SPECIFICALLY DESIGNED TO MATE WITH THE LSHM -S SHIELDED CONNECTOR. THE LSHM SHIELD SHOULD BE TIED TO THE GROUND REFERENCE PLANE IN THE CUSTOMER'S PCB.

TOLERANCES DO NOT APPLY TO REFERENCE DIMENSIONS. UNLESS OTHERWISE SPECIFIED, DIMENSIONS ARE IN INCHES. TOLERANCES ARE:
DECIMALS ANGLES
.XX: $\pm .01 [3]$ 2°
.XXX: $\pm .005 [13]$
.XXXX: $\pm .0020 [51]$

PROPRIETARY NOTE
THIS DOCUMENT CONTAINS CONFIDENTIAL AND PROPRIETARY INFORMATION AND ALL DESIGN, MANUFACTURING, REPRODUCTION, USE, PATENT RIGHTS AND SALES RIGHTS ARE EXPRESSLY RESERVED BY SAMTEC, INC. THIS DOCUMENT SHALL NOT BE DISCLOSED, IN WHOLE OR PART, TO ANY UNAUTHORIZED PERSON OR ENTITY NOR REPRODUCED, TRANSFERRED OR INCORPORATED IN ANY OTHER PROJECT IN ANY MANNER WITHOUT THE EXPRESS WRITTEN CONSENT OF SAMTEC, INC.



520 PARK EAST BLVD, NEW ALBANY, IN 47150
PHONE: 812-944-6733 FAX: 812-948-5047
e-Mail info@SAMTEC.com code 55322

DO NOT SCALE DRAWING SHEET SCALE: 2:1

DESCRIPTION:
HLCD MATING APPLICATION VIEWS

DWG. NO.
HLCD APPLICATIONS

BY:ANDREW C 09/10/2013 SHEET 1 OF 4

DV TO DV
PIN 1 MATES TO PIN 2

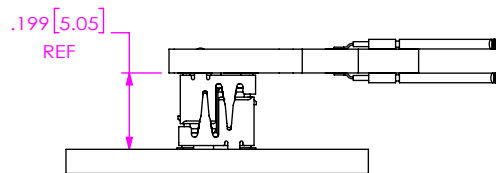

DV TO DH
PIN 1 MATES TO PIN N

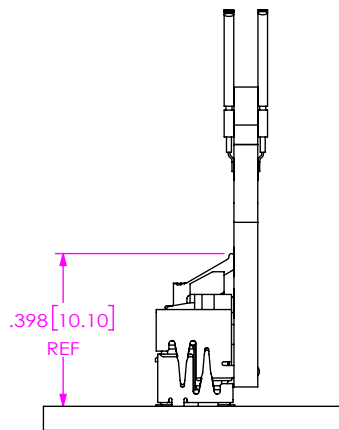

DV TO RH
PIN 1 MATES TO PIN (N-1)

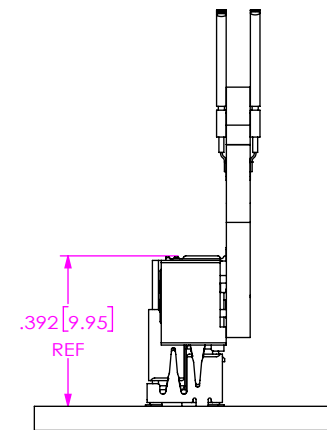

DH TO RH
PIN 1 MATES TO PIN 1

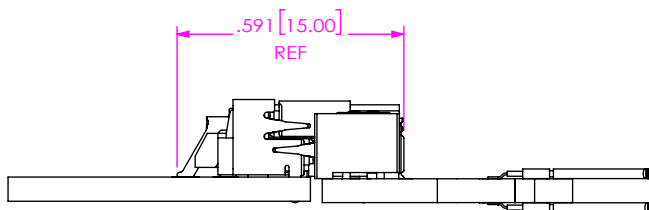

DH TO DH
PIN 1 MATES TO PIN 2
(RH TO RH MATE IS ALSO PIN 1 TO PIN 2)

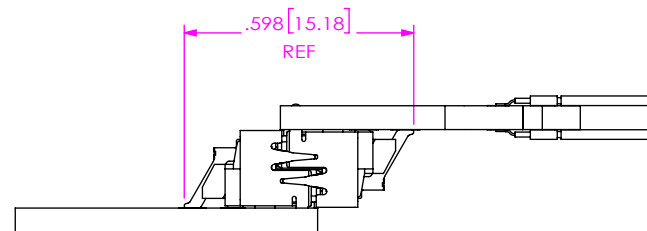

* **PROPRIETARY NOTE** *

THIS DOCUMENT CONTAINS CONFIDENTIAL AND PROPRIETARY INFORMATION AND ALL DESIGN, MANUFACTURING, REPRODUCTION, USE, PATENT RIGHTS AND SALES RIGHTS ARE EXPRESSLY RESERVED BY SAMTEC, INC. THIS DOCUMENT SHALL NOT BE DISCLOSED, IN WHOLE OR PART, TO ANY UNAUTHORIZED PERSON OR ENTITY NOR REPRODUCED, TRANSFERRED OR INCORPORATED IN ANY OTHER PROJECT IN ANY MANNER WITHOUT THE EXPRESS WRITTEN CONSENT OF SAMTEC, INC.

DO NOT SCALE DRAWING

SHEET SCALE: 1:1

samtec

520 PARK EAST BLVD, NEW ALBANY, IN 47150
PHONE: 812-944-6733 FAX: 812-948-5047
e-Mail: info@SAMTEC.com code 55322

DESCRIPTION:
HLCD MATING APPLICATION VIEWS

DWG. NO.
HLCD APPLICATIONS

BY: ANDREW C 09/10/2013 SHEET 2 OF 4

STANDARD BOARD - TO - BOARD

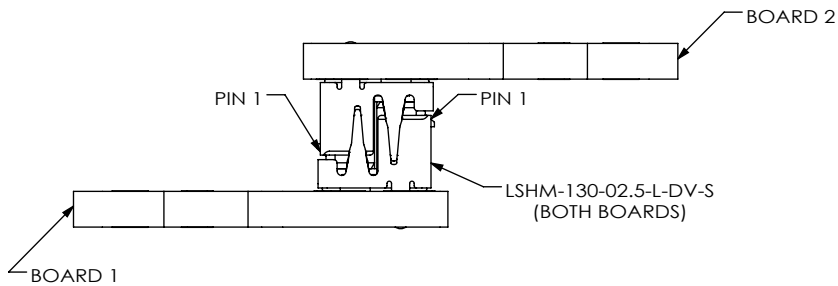

BOARDS NEED TO BE SPLIT WHILE MAINTAINING MAPPING FOR TESTING

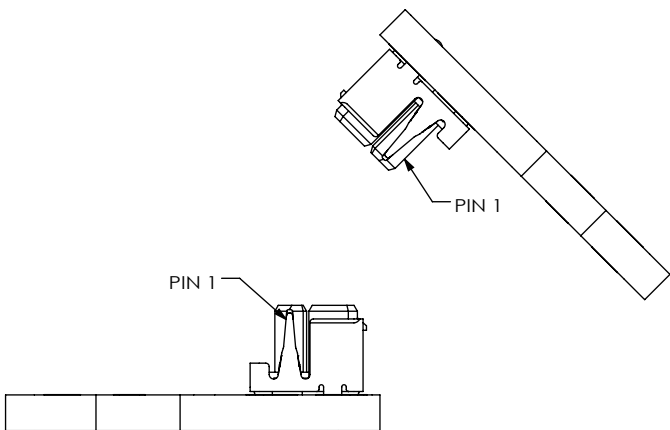

MAPPING BETWEEN BOARDS IS STILL 1:2

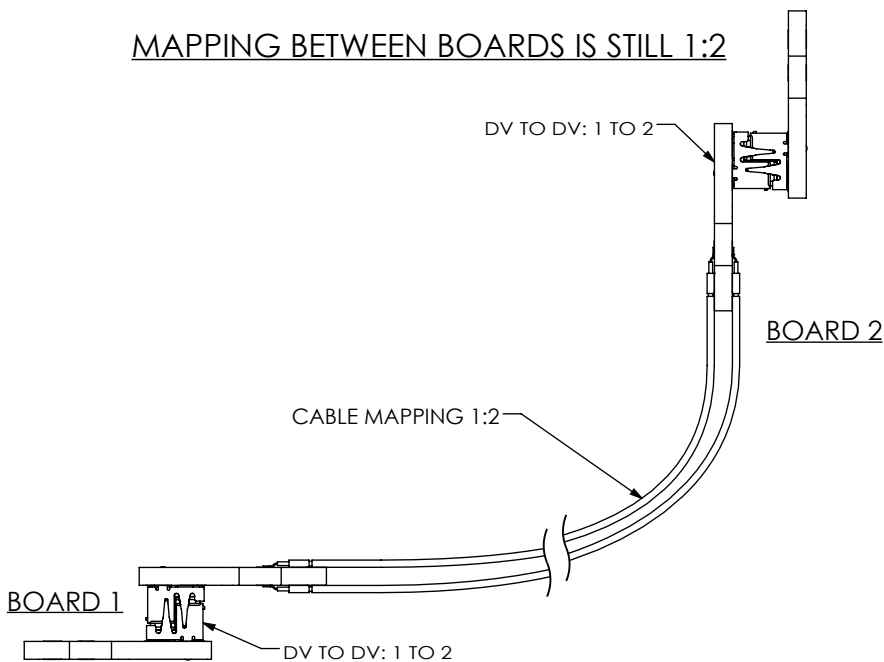

APPLICATION EXAMPLE

- BOARD 1 HAS LSHM-130-02.5-L-DV-S
- BOARD 2 HAS LSHM-130-02.5-L-DV-S
- EXISTING PIN MAPPING IS PIN 1, BOARD 1 TO PIN 2, BOARD 2
- CUSTOMER WISHES TO SEPARATE BOARDS FOR TESTING PURPOSES, BUT MUST KEEP SAME PIN 1 TO PIN 2 CONNECTIVITY BETWEEN BOARDS
- CABLE CHOSEN IS HLCD-30-XX.XX-BR-BR-2
- THE HLCD CABLE ASSEMBLY IS SPECIFICALLY DESIGNED TO MATE WITH THE LSHM -S SHIELDED CONNECTOR. THE LSHM SHIELD SHOULD BE TIED TO THE GROUND REFERENCE PLANE IN THE CUSTOMER'S PCB.

PROPRIETARY NOTE
THIS DOCUMENT CONTAINS CONFIDENTIAL AND PROPRIETARY INFORMATION AND ALL DESIGN, MANUFACTURING, REPRODUCTION, USE, PATENT RIGHTS AND SALES RIGHTS ARE EXPRESSLY RESERVED BY SAMTEC, INC. THIS DOCUMENT SHALL NOT BE DISCLOSED, IN WHOLE OR PART, TO ANY UNAUTHORIZED PERSON OR ENTITY NOR REPRODUCED, TRANSFERRED OR INCORPORATED IN ANY OTHER PROJECT IN ANY MANNER WITHOUT THE EXPRESS WRITTEN CONSENT OF SAMTEC, INC.

SHEET SCALE: 1:1

samtec

520 PARK EAST BLVD, NEW ALBANY, IN 47150
PHONE: 812-944-6733 FAX: 812-948-5047
e-Mail info@SAMTEC.com code 55322

DESCRIPTION:
HLCD MATING APPLICATION VIEWS

DWG. NO.
HLCD APPLICATIONS

BY: ANDREW C 09/10/2013 SHEET 3 OF 4

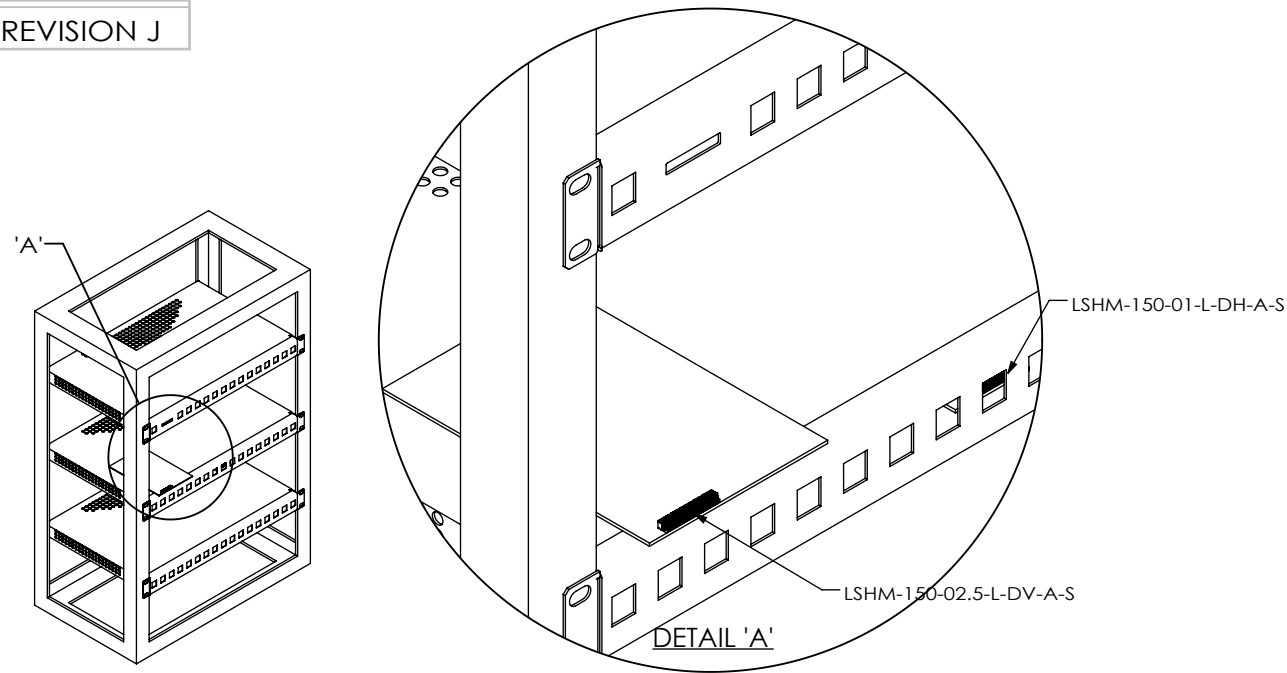

APPLICATION EXAMPLE

- TOP BOARD HAS LSHM-150-01-L-DH-A-S
- LOWER BOARD HAS LSHM-150-02.5-L-DV-A-S
- CUSTOMER WISHES TO CONNECT PIN 1 ON TOP BOARD TO PIN 99 (N-1) ON LOWER BOARD
- CABLE CHOSEN IS HLCD-50-XX.XX-BL-BD-3
- THE HLCD CABLE ASSEMBLY IS SPECIFICALLY DESIGNED TO MATE WITH THE LSHM -S SHIELDED CONNECTOR. THE LSHM SHIELD SHOULD BE TIED TO THE GROUND REFERENCE PLANE IN THE CUSTOMER'S PCB.

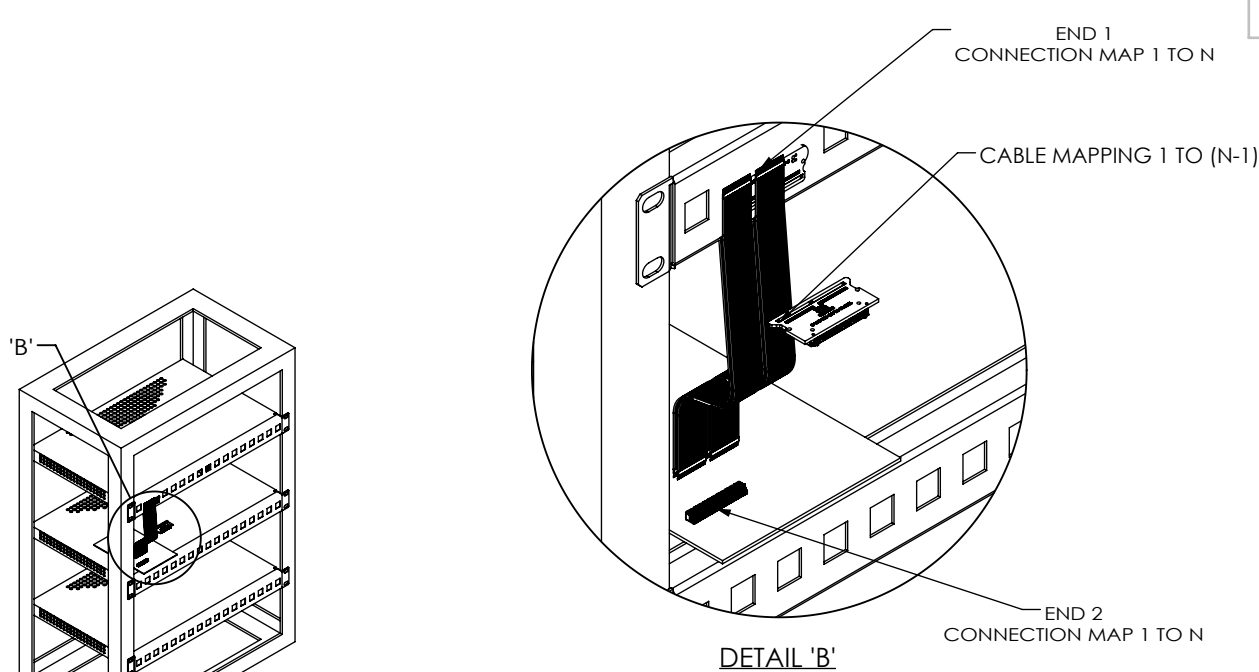

PROPRIETARY NOTE
THIS DOCUMENT CONTAINS CONFIDENTIAL AND PROPRIETARY INFORMATION AND ALL DESIGN, MANUFACTURING, REPRODUCTION, USE, PATENT RIGHTS AND SALES RIGHTS ARE EXPRESSLY RESERVED BY SAMTEC, INC. THIS DOCUMENT SHALL NOT BE DISCLOSED, IN WHOLE OR PART, TO ANY UNAUTHORIZED PERSON OR ENTITY NOR REPRODUCED, TRANSFERRED OR INCORPORATED IN ANY OTHER PROJECT IN ANY MANNER WITHOUT THE EXPRESS WRITTEN CONSENT OF SAMTEC, INC.



520 PARK EAST BLVD, NEW ALBANY, IN 47150
PHONE: 812-944-6733 FAX: 812-948-5047
e-Mail: info@SAMTEC.com code 55322

DO NOT SCALE DRAWING

DESCRIPTION:
HLCD MATING APPLICATION VIEWS

DWG. NO.
HLCD APPLICATIONS

BY: ANDREW C 09/10/2013 SHEET 4 OF 4