

DATE	REV	ECN	APP'D. BY
9-19-02	A0	5562	JAF

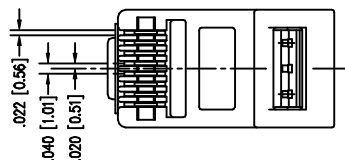

EIGHT CONDUCTOR/EIGHT POSITION LINE CORD MODULE;
CLEAR; FOR FLAT OR OVAL CABLE; FOR CONDUCTORS
WITH MAXIMUM OUTSIDE DIAMETER OF .037/.042 [.940/1.067]

CONSISTING OF:
PRE-INSERTED FRONT PLASTIC 943-SP-370808M2-F
MANAGEMENT BAR 370808M2-MB-A264

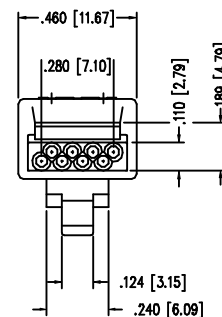
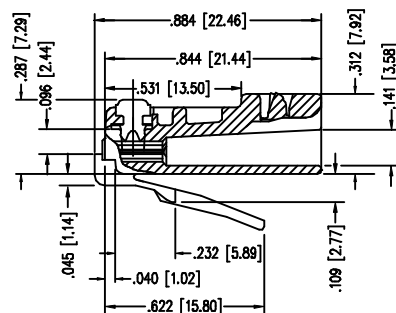
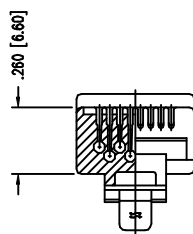

SPECIFICATIONS OF STEWART CONNECTOR'S MODULAR PLUGS

- CONTACT MATERIAL: 8% PHOSPHOR BRONZE
- CONTACT PLATING: 50 MICRO-INCH (1.27 MICRON)
SELECTIVE 24 CARAT HARD GOLD PLATE IN CONTACT AREA
OVER 100 MICRO-INCH (2.54 MICRON) MINIMUM NICKEL PLATE
PER CURRENT SELECTIVE GOLD PLATING REQUIREMENTS.
- PLUG MATERIAL: POLYCARBONATE
- PLUG SPECIFICATIONS: MEETS CATEGORY 5 PERFORMANCE SPECS
AS TESTED PER ANNEX B OF EIA/TIA 2840
- PLUG TOLERANCES AND DIMENSIONS: COMPLIES WITH F.C.C REQUIREMENTS
ALL OTHER DIM'S ±.005 (±0.127MM)
DIM'S WITH "*" TO BE CENTRAL ABOUT CENTER LINE
- FLAME AUTO EXTINGUISH: 94-V0 (U.L. RECOGNIZED-FILE
NO. E132408 (N))
- LEVEL: -40°C TO +125°C
- OPERATION TEMPERATURE: 1000 CYCLES (USING STEWART
CONNECTOR JACKS)
- INSERTION/EXTRACTION LIFE: 10 MILLOHMS MAX. (USING
STEWART CONNECTOR JACKS)
- CONTACT RESISTANCE: 30 VAC/42 VDC AT 1.5 AMPS

943-SP-370808M2-A264

PART NUMBER

UNCONTROLLED DOCUMENT

THIRD ANGLE PROJECTION

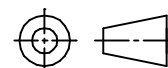

DIMENSIONS SHOWN ARE SUBJECT
TO CHANGE WITHOUT NOTICE

DIMENSIONS: INCHES [METRIC]
UNLESS OTHERWISE SPECIFIED
TOLERANCES ARE ±.005 [0.13]
ANGLES ARE ± 1°

SHEET NO. 1 OF 1

Stewart Connector

<http://www.stewartconnector.com>

11118 Susquehanna Trail South
Glen Rock, PA 17327-9199
(717) 235-7512 Fax: (717) 235-7954

TITLE: CAT 5 PLUG

THIS DRAWING AND THE SUBJECT MATTER SHOWN THEREON
ARE CONFIDENTIAL AND THE PROPRIETARY PROPERTY OF
STEWART CONNECTOR ("SCS") AND SHALL NOT BE
REPRODUCED, COPIED OR USED IN ANY MANNER WITHOUT
PRIOR WRITTEN CONSENT OF "SCS". THE SUBJECT MATTER
MAY BE PATENTED OR A PATENT MAY BE PENDING. © SCS

DRN BY: R. S.	DATE 7-18-95
CKD BY: R. S.	DATE 7-18-95
APPD BY: J. W.	DATE 7-28-95
DWG NO. CT370006	REV. A0



MANAGEMENT BAR