

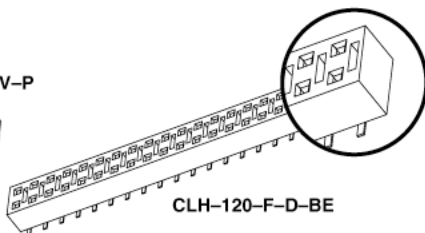

CLH-108-F-D-DV-P

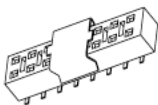

CLH-120-F-D-BE

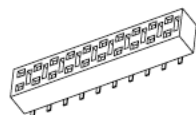

CLH-110-F-D-DV



-SM, -LM,  
-FM only:

RoHS Compliant  
Pb  
LEAD

www.samtec.com/lead-free

Surface  
**SMT**  
Mount

# LOW PROFILE SOCKET CLH SERIES

Mates with:  
TSW, MTSW, HW, DW,  
EW, ZW, TLW, TSM,  
MTLW

## SPECIFICATIONS

For complete specifications and recommended PCB layouts see www.samtec.com?CLH

Insulator Material:  
Black Liquid Crystal Polymer



Contact Material:  
Phosphor Bronze

Operating Temp Range:  
-55°C to +125°C with Gold  
-55°C to +105°C with Tin

Plating:

Au or Sn over

50µ" (1,27µm) Ni

Contact Resistance:

10 mΩ max

Insertion Depth:

(2,67mm) .105" to

(3,43mm) .135"

plug from top, (3,18mm) .125"

min plus board thickness plug

from bottom

Insertion Force:

4.0oz (1,11N) average

Normal Force:

50 grams (0,48N)

Withdrawal Force:

1.1oz (0,31N) average

Max Cycles:

100 with 10µ" (0,25µm) Au

RoHS Compliant:

Yes

## Processing:

Max Processing Temp:

230°C for 60 seconds, or

260°C for 20 seconds 3x

with Matte Sn plating

Lead-Free Solderable:

Yes, with Matte Sn plating

SMT Lead Coplanarity:

(0,10mm) .004" max



Note: Some lengths, styles and options are non-standard, non-returnable.

## APPLICATION SPECIFIC OPTION

Polarized option available. Call Samtec.

**-S or -SM**  
Pre-plated 30µ" (0,76µm) Gold on contact, Tin-Lead (-S) or Matte Tin (-SM) on tail

**-L or -LM**  
= Pre-plated 10µ" (0,25µm) Gold on contact, Tin-Lead (-L) or Matte Tin (-LM) on tail

**-F or -FM**  
= Pre-plated Gold flash on contact, Tin-Lead (-F) or Matte Tin (-FM) on tail

**-DV**  
= Top Entry

**-BE**  
= Bottom Entry

**-K**  
(Best Cost Option)  
= (6,50mm) .256" DIA Polyimide film Pick & Place Pad (4 positions min.)

**-P**  
= Pick & Place Pad (4 positions minimum)

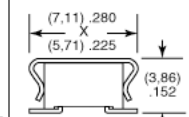

Not always necessary for auto placement. See Flex Processing.



**-A**  
= Alignment Pin (5 positions minimum)

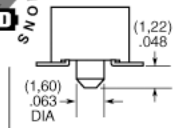

**-LC**  
= Locking Clip

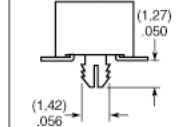

**-TR**  
= Tape & Reel Packaging



CURRENT RATING	
AMBIENT TEMPERATURE	TSM mated with CLH
20°C	3.2A
40°C	2.8A
60°C	2.3A
80°C	1.6A

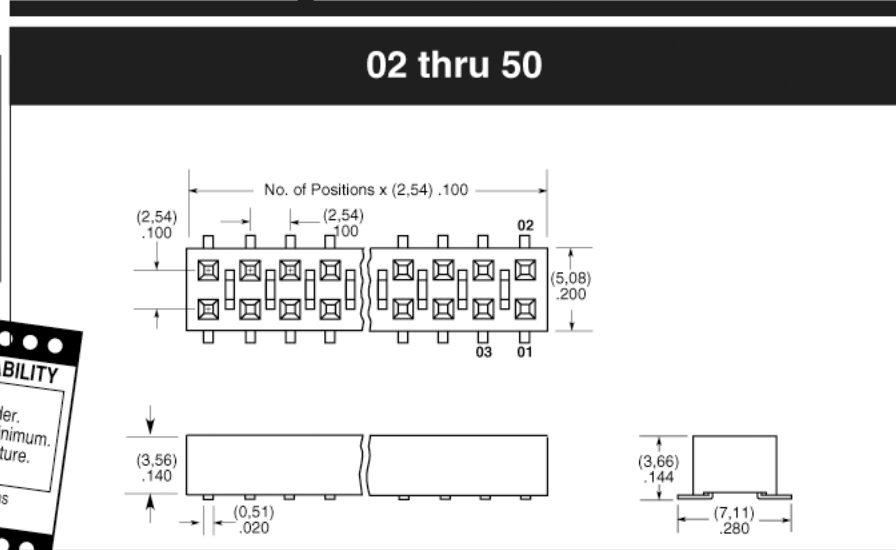

**TAPE & REEL AVAILABILITY**  
No tooling charges.  
125 piece minimum order.  
Order any quantity above minimum.  
In-house design, manufacture.  
Quick turn-around.  
Call Samtec for specifications and ordering information.

Due to technical progress, all designs, specifications and components are subject to change without notice.

WWW.SAMTEC.COM