

3RU1116-1EB0 OVERLOAD RELAY, 2.8...4 A,

Technical / CAx data

☒ Technical Data ☐ CAx data

OVERLOAD RELAY, 2.8...4 A, 1NO+1NC, SIZE S00, CLASS 10, FOR CONTACTOR MOUNTING



General technical details:

product brand name		SIRIUS
product designation		thermal overload relay
Protection class IP / on the front		IP20
Insulation voltage / with degree of pollution 3 / rated value	V	690
Installation altitude / at a height over sea level / maximum	m	2,000
Ambient temperature		
• during operating	°C	-20...+70
• during storage	°C	-55...+80
• during transport	°C	-55...+80
Relative humidity / during operating phase / maximum	%	100
Resistance against shock		8g / 10 ms
Impulse voltage resistance / rated value	kV	6
Active power loss / total / typical	W	6.6
Item designation		
• according to DIN 40719 extendable after IEC 204-2 / according to IEC 750		F
• according to DIN EN 61346-2		F
Operating current / of the fuse link / rated value	A	16
Trip class		CLASS 10
Type of assignment		2
type of protection		DMT 98 ATEX G 001
Size of overload relay		S00
Size of the contactor / can be combined / company-specific		S00
Protection against electrical shock		finger-safe

Main circuit:

Number of poles / for main current circuit	3	
Operating voltage / at AC-3 / rated value	V	690
• maximum		
Service power / at AC-3	kW	1.5
• at 400 V		
Adjustable response current	A	2.8...4
• of the current-dependent overload release		

Auxiliary circuit:

Contact reliability / of the auxiliary contacts	acceptability for PLC control (17 V, 5 mA)	
Number of NC contacts	1	
Number of NO contacts	1	
Number of change-over switches	0	
Operating current / of the auxiliary contacts / at AC-15		
• at 24 V	A	3
• at 110 V	A	3
• at 120 V	A	3
• at 125 V	A	3
• at 230 V	A	2
• at 400 V	A	1
Operating current / of the auxiliary contacts / at DC-13		
• at 24 V	A	1
• at 110 V	A	0.22
• at 125 V	A	0.22
• at 220 V	A	0.11

Short-circuit:

Design of the fuse link / for short-circuit protection of the auxiliary switch / required	fuse gL/gG: 6 A, quick: 10 A
--------------------------------------------------------------------------------------------------	------------------------------

Installation/mounting/dimensions:

Built in orientation	with vertical mounting surface +/-135°rotatable, with vertical mounting surface +/- 45°tiltable to the front and back	
Type of mounting	direct mounting	
Height	mm	87
Width	mm	45
Depth	mm	78
Distance, to be maintained, to the ranks assembly		
• upwards	mm	0
• downwards	mm	0
• forwards	mm	0
• backwards	mm	0
• sideways	mm	0
Distance, to be maintained, to earthed part		
• upwards	mm	0
• downwards	mm	0
• forwards	mm	0
• backwards	mm	0
• sideways	mm	6
Distance, to be maintained, conductive elements		
• upwards	mm	0
• downwards	mm	0
• forwards	mm	0
• backwards	mm	0
• sideways	mm	6

Connection type:

Product function	
<ul style="list-style-type: none"> removable terminal for auxiliary and control circuit 	No
Design of the electrical connection	
<ul style="list-style-type: none"> for main current circuit for auxiliary and control current circuit 	screw-type terminals screw-type terminals
Type of the connectable conductor cross-section	
<ul style="list-style-type: none"> for main contacts solid finely stranded <ul style="list-style-type: none"> with conductor end processing for auxiliary contacts solid finely stranded <ul style="list-style-type: none"> with conductor end processing for AWG conductors for main contacts for auxiliary contacts 	2x (0.5 ... 1.5 mm²), 2x (0.75 ... 2.5 mm²), 2x 4 mm² max. 2x (0.5 ... 1.5 mm²), 2x (0.75 ... 2.5 mm²) 2x (0.5 ... 1.5 mm²), 2x (0.75 ... 2.5 mm²) 2x (0.5 ... 1.5 mm²), 2x (0.75 ... 2.5 mm²) 2x (20 ... 16), 2x (18 ... 14), 2x 12 2x (20 ... 16), 2x (18 ... 14)
Conductor cross section that can be connected	
<ul style="list-style-type: none"> for main contacts solid stranded wire <ul style="list-style-type: none"> with conductor end processing for auxiliary contact solid stranded wire <ul style="list-style-type: none"> with conductor end processing 	mm² 0.5...4 mm² 0.5...2.5 mm² 0.5...2.5 mm² 0.5...2.5
AWG number / as coded connectable conductor cross-section	
<ul style="list-style-type: none"> for main contacts / minimum for auxiliary contact 	20 20...14

Certificates/approvals:

Verification of suitability	CSA / UL / CC / GL / LRS / BV / DNV / RMRS / RINA / PRS / ABS
Varification of suitability / ATEX	Yes

General Product Approval

For use in hazardous locations

<input checked="" type="checkbox"/> CCC	<input checked="" type="checkbox"/> CSA	<input checked="" type="checkbox"/> GOST	<input checked="" type="checkbox"/> UL	<input checked="" type="checkbox"/> ATEX-EC-Type
-----------------------------------------	-----------------------------------------	------------------------------------------	----------------------------------------	--------------------------------------------------

Test Certificates

Special Test Certificate	Type Test Certificates/Test Report
--------------------------	------------------------------------

Shipping Approval

<input checked="" type="checkbox"/> ABS (America)	<input checked="" type="checkbox"/> BV / Bureau Veritas	<input checked="" type="checkbox"/> DNV / Det Norske Veritas	<input checked="" type="checkbox"/> GL / Germanischer Lloyd	<input checked="" type="checkbox"/> LRS / Lloyds Register	<input checked="" type="checkbox"/> PRS / Polski Register
---------------------------------------------------	---------------------------------------------------------	--------------------------------------------------------------	-------------------------------------------------------------	-----------------------------------------------------------	-----------------------------------------------------------

Shipping Approval

other

<input checked="" type="checkbox"/> RINA / Registro Italiano Navale	<input checked="" type="checkbox"/> RMRS / Russian Maritime Register of Shipping	Confirmation	Declaration of Conformity	other	<input checked="" type="checkbox"/> Environmental
---------------------------------------------------------------------	----------------------------------------------------------------------------------	--------------	---------------------------	-------	---------------------------------------------------

Further information:

Information- and Downloadcenter (Catalogs, Brochures,...)

<http://www.siemens.com/industrial-controls/catalogs>

Industry Mall (Online ordering system)

<http://www.siemens.com/industrial-controls/mall>

CAX-Online-Generator

<http://www.siemens.com/cax>

Service&Support (Manuals, Certificates, Characteristics, FAQs,...)

<http://support.automation.siemens.com/WW/view/en/3RU1116-1EB0/all>

Image database (product images, 2D dimension drawings, 3D models, device circuit diagrams, ...)

http://www.automation.siemens.com/bilddb/cax_en.aspx?mlfb=3RU1116-1EB0

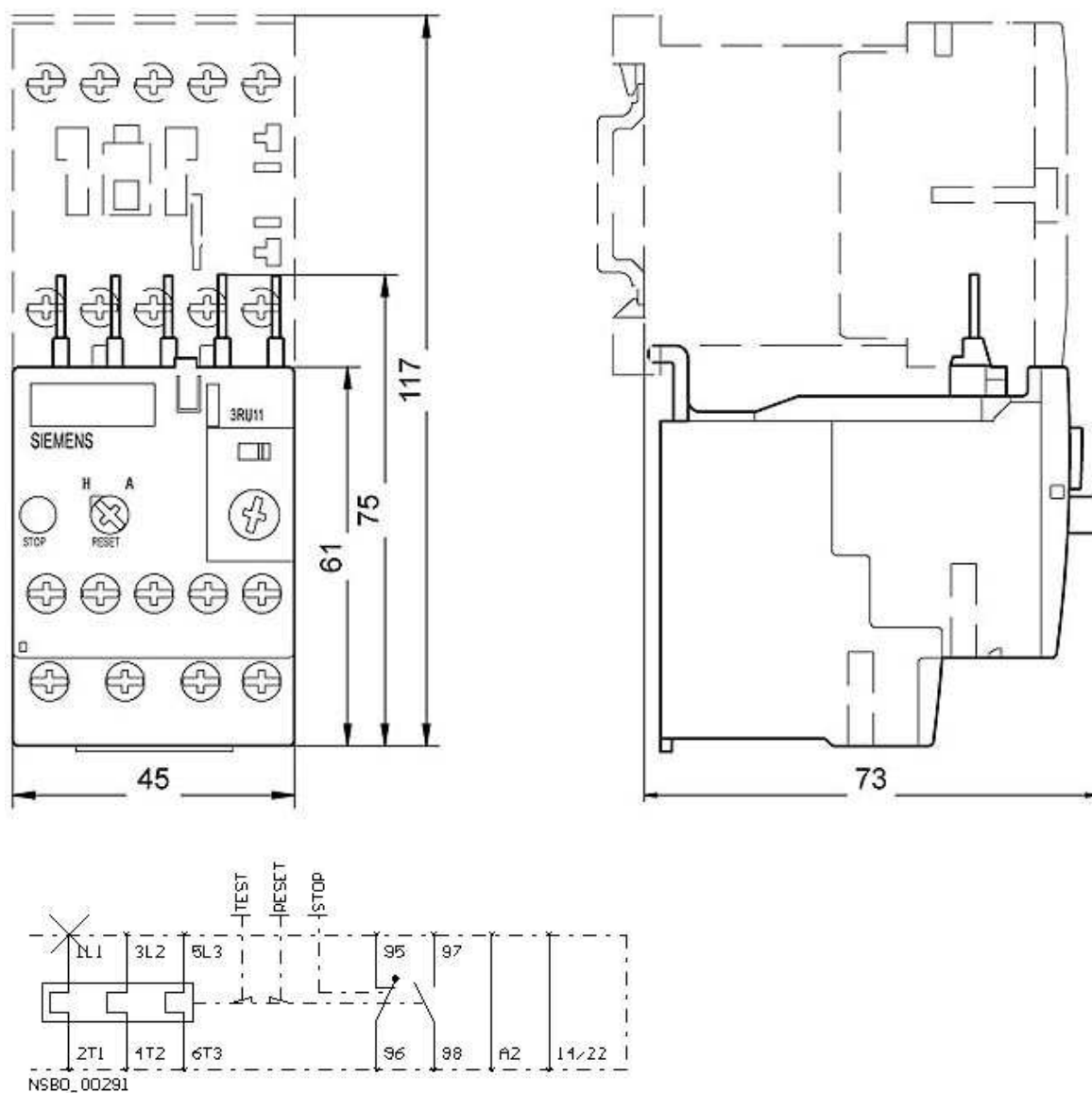

last change:

Mar 27, 2012