

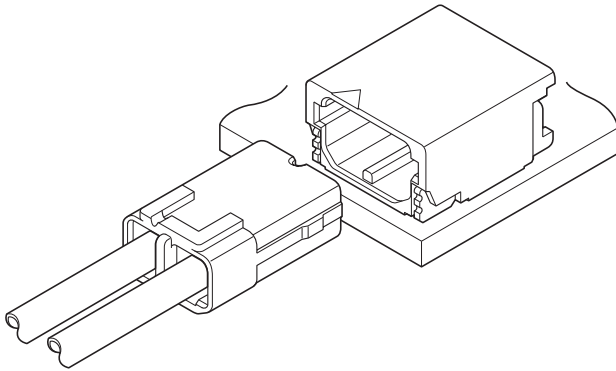

# SFH CONNECTOR

**1.8mm pitch/Disconnectable Crimp style connectors**



**This low profile type connector with height of 3.0mm is designed for connection to stroboscope flash and realized space saving.**

- **Contact lance**
- **Countermeasure for inverse insertion and locking feature**

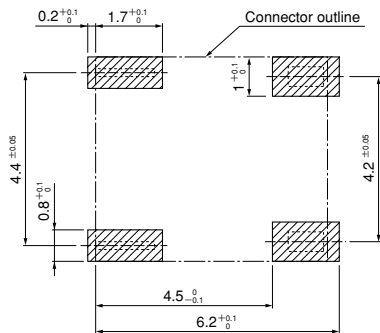

- Note: 1. The above figure is the figure viewed from the connector mounting side.  
 2. Tolerances are non-cumulative:  $\pm 0.05\text{mm}$  for all centers.  
 3. The dimensions above should serve as a guideline. Contact JST for details.

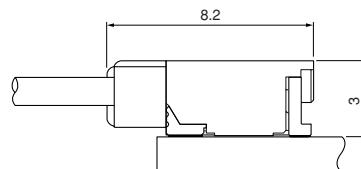

## Contact

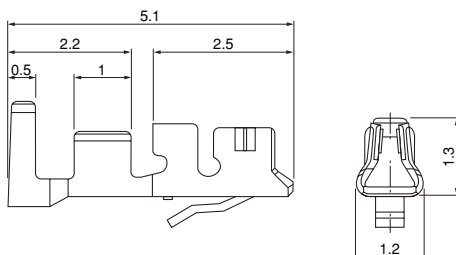

## Specifications

- Current rating: 4A AC, DC (AWG #22)
- Voltage rating: 350V AC, DC
- Temperature range:  $-25^{\circ}\text{C}$  to  $+85^{\circ}\text{C}$   
(including temperature rise in applying electrical current)
- Contact resistance: Initial value/ 10m  $\Omega$  max.  
After environmental testing/ 20m  $\Omega$  max.
- Insulation resistance: 1,000M  $\Omega$  min.
- Withstanding voltage: 1,700V AC/minute
- Applicable wire: Conductor size/ AWG #30 to #22  
Insulation O.D./ 0.7 to 1.3mm

- \* Compliant with RoHS.
- \* Refer to "General Instruction and Notice when using Terminals and Connectors" at the end of this catalog.
- \* Contact JST for details.

## Standards

Recognized E60389

Certified LR20812

Model No.	Applicable wire			Q'ty / reel
	mm <sup>2</sup>	AWG#	Insulation O.D. (mm)	
<b>SSFH-001T-P0.5</b>	0.13~0.33	26~22	0.95~1.3	15,000
<b>SSFH-002T-P0.5</b>	0.05~0.13	30~26	0.7 ~1.25	15,000

### Material and Finish

Copper alloy, tin-plated (reflow treatment)

### RoHS compliance

Contact	Crimping machine	Applicator		
		Crimp applicator	Dies	Crimp applicator with dies
<b>SSFH-001T-P0.5</b>	AP-K2N	MKS-L	MK/SSFH-001-05	APLMK SSFH001-05
		—	—	—
<b>SSFH-002T-P0.5</b>	AP-K2N	MKS-L	MK/SSFH-002-05	APLMK SSFH002-05
		—	—	—

# SFH CONNECTOR

## Housing

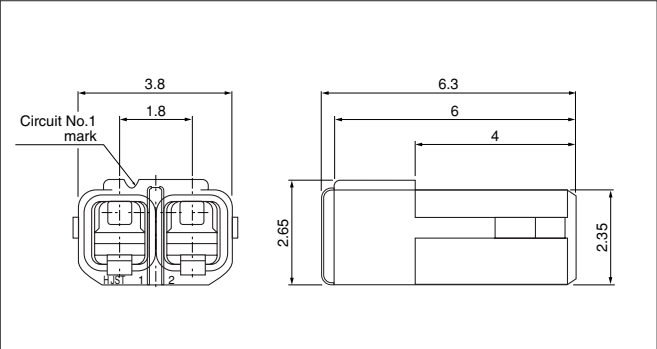

Circuits	Model No.	Q'ty / bag
2	<b>SFHR-02V-R</b>	1,000
Material		
Thermoplastic resin, UL94V-0		

**RoHS compliance**  
<For reference> As the color identification, the following alphabet shall be put in the underlined part.  
For availability, delivery and minimum order quantity, contact JST.  
ex. **SFHR-02V-R**  
R...red  
L...lemon yellow

## Shrouded header

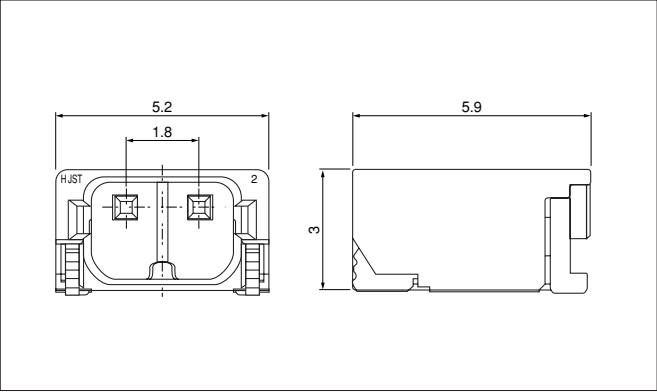

Circuits	Model No.	Q'ty / reel
2	<b>SM02B-SFHRS-TF</b>	2,000
Material and Finish		
Press pin: Copper alloy, copper-undercoated, tin-plated (reflow treatment) Wafer: Heat resisting resin, UL94V-0 Solder tab: Copper alloy, copper-undercoated, tin-plated (reflow treatment)		

**RoHS compliance** This product displays (LF)(SN) on a label.  
<For reference> As the color identification, the following alphabet shall be put in the underlined part.  
For availability, delivery and minimum order quantity, contact JST.  
ex. **SM02B-SFHRS-TF**  
R...red  
L...lemon yellow