

RED L.E.D

PARAMETERS	SYMBOL	TYP.	UNITS
AVE CURRENT	I _A	12	mA
EMISSION WAVELENGTH	λ _p	632	nm
LUMINOUS INTENSITY	I _F	350	mcd

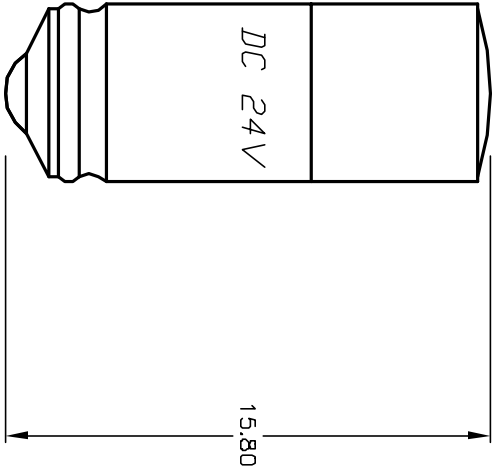
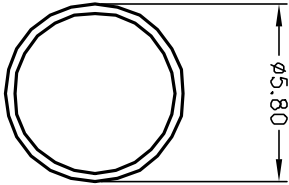

NOTES:

- 1. ALL DIMENSIONS IN MM
- 2. GENERAL TOLERANCE: X.X=±0.4
X.XX=±0.25
- 3. VOLTAGE: 24V DC SEE ABOVE
- 4. OPERATING TEMP. -20°C to 60°C

IE-SWITCH®			
TITLE			
50-004-23 (RED LED)			
SCALE			
4:1			
DATE			
2/01/02			
DR			
CJB			
DWG			
F050423			
REV			
A			

REV.	ECN No.	DESCRIPTION	DATE	CHKD
A	11896	RELEASED FOR PRODUCTION	3/15/02	CJB

THE INFORMATION CONTAINED IN THIS DOCUMENT IS PROPRIETARY TO E-SWITCH AND IS NOT TO BE COPIED OR TRANSFERRED

Mouser Electronics

Authorized Distributor

Click to View Pricing, Inventory, Delivery & Lifecycle Information:

[E-Switch:](#)

[50004-23](#)