

No.420-ER Stationary Caster



Characteristic

It is the caster to transport a large volume subject rather than a heavy weight subject.

Application

Large or Medium size devices / working platforms.

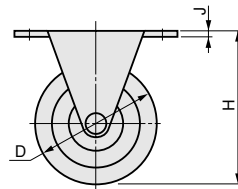
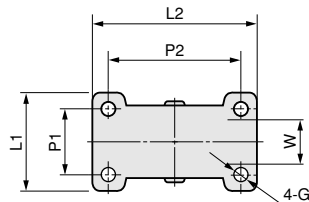

Specification

Model No.	Allowable Load (kg)	Net Weight(g)	Code No.	
No.420-ER-R50-1	30	140	9789	
No.420-ER-R65-2		198	9790	
No.420-ER-R75-3	40	230	9791	
No.420-ER-R100-4	50	550	9792	
No.420-ER-R125-5	60	690	9793	
No.420-ER-N50-1	40	108	9795	
No.420-ER-N65-2			9796	
No.420-ER-N75-3	50	135	9797	
No.420-ER-N100-4	60	148	9798	
No.420-ER-N125-5	70	342	9799	

Size List

No.	D	G	H	J	L1	L2	P1	P2	W	
									Rubber Wheel	Nylon Wheel
1	φ 50	φ 6.5	65	12.3	42	70	28	56	20	21
2	φ 65		82						21	
3	φ 75		92						21	
4	φ 100	φ 8.8	122	12.8	58	100	40	82	27	25
5	φ 125		148							

Material of Wheel	R-Rubber wheel
	N-Nylon wheel

Ask for materials for wheel other than rubber and nylon, depending on the size (D size). A caster with bearing is also available.