

## Sensor/Actuator cable - SAC-4P-M8MR/1,5-542/M8FS SH BK - 1406008

Please be informed that the data shown in this PDF Document is generated from our Online Catalog. Please find the complete data in the user's documentation. Our General Terms of Use for Downloads are valid (<http://download.phoenixcontact.com>)



Sensor/Actuator cable, 4-position, PVC, yellow, shielded, Plug angled M8, on Socket straight M8, Cable length: 1.5 m



### Key commercial data

|                      |   |
|----------------------|---|
| Packing unit         | 1 PCE   |
| GTIN                 | <br>4 046356 800211 |
| Custom tariff number | 85444290  |
| Country of origin    | UNITED STATES   |

### Technical data

#### Dimensions

|                 |       |
|-----------------|-------|
| Length of cable | 1.5 m |
|-----------------|-------|

#### Ambient conditions

|                                 |                                  |
|---------------------------------|----------------------------------|
| Ambient temperature (operation) | -25 °C ... 90 °C (Plug / socket) |
| Degree of protection            | IP65                             |
|                                 | IP67                             |

#### General

|                       |                                      |
|-----------------------|--------------------------------------|
| Rated current at 40°C | 4 A                                  |
| Rated voltage         | 30 V                                 |
| Number of positions   | 4                                    |
| Contact resistance    | ≤ 5 mΩ                               |
| Insulation resistance | ≥ 100 MΩ                             |
| Standards/regulations | M8 plug-in connector IEC 61076-2-104 |
| Coding                | A - standard                         |

# Sensor/Actuator cable - SAC-4P-M8MR/1,5-542/M8FS SH BK - 1406008

## Technical data

### General

|                             |   |
|-----------------------------|---|
| Surge voltage category      | II  |
| Pollution degree            | 3   |
| Insertion/withdrawal cycles | ≥ 100                                       |
| Torque                      | 0.2 Nm (M8 plug-in connectors)              |
| Contact material            | CuSn  |
| Contact surface material    | Ni/Au                                       |
| Contact carrier material    | TPU GF                                      |
| Material of grip body       | TPU, hardly inflammable, self-extinguishing |
| Material, knurls            | Zinc die-cast, nickel-plated                |
| Sealing material            | NBR   |
| Status display              | No  |

### Line characteristics

|   |   |
|---|---|
| Cable type                                    | PVC yellow 105 °C                             |
| Cable type (abbreviation)                     | 542   |
| UL AWM style                                  | 2517 (105°C/300 V)                            |
| AWG signal line                               | 24  |
| Core diameter including insulation            | 1.12 mm ±0.03 mm                              |
| Wire colors                                   | brown, blue, black, white                     |
| Overall twist                                 | 4 wires, twisted                              |
| Shielding                                     | Tinned copper braided shield                  |
| Optical shield covering                       | 85 %  |
| External sheath, color                        | yellow  |
| External cable diameter D                     | 4.9 mm ± 0.2 mm                               |
| Minimum bending radius, flexible installation | 12 x D  |
| Cable weight                                  | 37 kg/km                                      |
| Outer sheath, material                        | PVC   |
| Material conductor insulation                 | PVC   |
| Conductor material                            | Tin-plated Cu litz wires                      |
| Nominal voltage, cabel                        | 300 V   |
| Other resistance                              | UV resistant                                  |
| Ambient temperature (operation)               | -30 °C ... 105 °C (cable, fixed installation) |

## Classifications

### eCl@ss

|            |          |
|------------|----------|
| eCl@ss 4.0 | 27060306 |
| eCl@ss 4.1 | 27060306 |

## Sensor/Actuator cable - SAC-4P-M8MR/1,5-542/M8FS SH BK - 1406008

### Classifications

#### eCl@ss

|            |          |
|------------|----------|
| eCl@ss 5.0 | 27061801 |
| eCl@ss 5.1 | 27061801 |
| eCl@ss 6.0 | 27061801 |
| eCl@ss 7.0 | 27061801 |

#### ETIM

|          |          |
|----------|----------|
| ETIM 3.0 | EC001855 |
| ETIM 4.0 | EC001855 |
| ETIM 5.0 | EC001855 |

#### UNSPSC

|               |          |
|---------------|----------|
| UNSPSC 6.01   | 31251501 |
| UNSPSC 7.0901 | 31251501 |
| UNSPSC 11     | 31251501 |
| UNSPSC 12.01  | 31251501 |
| UNSPSC 13.2   | 31251501 |

### Approvals

#### Approvals

#### Approvals

UL Listed / cUL Listed / cULus Listed

#### Ex Approvals

#### Approvals submitted

#### Approval details

|   |       |
|---|-------|
| UL Listed  |       |
| Nominal current I <sub>N</sub>  | 4 A   |
| Nominal voltage U <sub>N</sub>  | 125 V |

## Sensor/Actuator cable - SAC-4P-M8MR/1,5-542/M8FS SH BK - 1406008

### Approvals

|  |       |
|--|-------|
| cUL Listed  |       |
| Nominal current I <sub>N</sub>   | 4 A   |
| Nominal voltage U <sub>N</sub>   | 125 V |

|  |  |
|--|--|
| cULus Listed  |  |
|--|--|

### Accessories

#### Accessories

#### Marking

Insert label - PABA WH/15 - 1013151



Insert label, Strip, white, Unlabeled, Can be labeled with: Plotter, Mounting type: Thread on, Cable diameter: 0.6-50 mm, Lettering field: 15 x 4 mm

Insert label - PABA YE/15 - 1013698



Insert label, Strip, yellow, Unlabeled, Can be labeled with: Plotter, Mounting type: Thread on, Cable diameter: 0.6-50 mm, Lettering field: 15 x 4 mm

Insert label - PABA RD/15 - 1013944



Insert label, Strip, red, Unlabeled, Can be labeled with: Plotter, Mounting type: Thread on, Cable diameter: 0.6-50 mm, Lettering field: 15 x 4 mm

## Sensor/Actuator cable - SAC-4P-M8MR/1,5-542/M8FS SH BK - 1406008

### Accessories

Conductor marker carrier - PATO 2/15 - 1013122



Conductor marker carrier, transparent, Unlabeled, Mounting type: Clip on, Cable diameter: 2.8-4.4 mm, Lettering field: 4 x 15 mm

Conductor marker carrier - PATO 3/15 - 1013135



Conductor marker carrier, transparent, Unlabeled, Mounting type: Clip on, Cable diameter: 4.4-6.7 mm, Lettering field: 4 x 15 mm

Conductor marker carrier - PATO 4/15 - 1013148



Conductor marker carrier, transparent, Unlabeled, Mounting type: Clip on, Cable diameter: 6.7-10 mm, Lettering field: 4 x 15 mm

Marker pen - B-STIFT - 1051993



Marker pen, for manual labeling of unprinted Zack strips, smear-proof and waterproof, line thickness 0.5 mm

### Protection and sealing elements

Sealing cap - PROT-M 8 FS-PA-CHAIN - 1430857



M8 sealing cap made of plastic with fixing band for sensor cables, for M8 plugs

## Sensor/Actuator cable - SAC-4P-M8MR/1,5-542/M8FS SH BK - 1406008

### Accessories

Screw plug - PROT-M 8 MS-PA-CHAIN - 1430860

M8 sealing cap made of plastic with fixing band for sensor cables, for M8 sockets



### Tools

Torque screwdriver - TSD 02 SAC - 1208487



Torque screwdriver, with preset torque of 0.2 Nm and 4 mm hexagonal drive for M8 connectors

Tool - SAC BIT M8-D10 - 1208461



Nut for assembling sensor/actuator cables with M8 connector and for M8 connectors with QUICKON fast connection technology, for 4 mm hexagonal drive

### Drawings

Schematic diagram

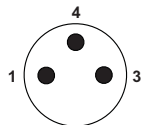

Pin assignment M8 plug, 3-pos., view male side

Schematic diagram

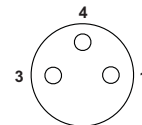

Pin assignment M8 socket, 3-pos., view female side

## Sensor/Actuator cable - SAC-4P-M8MR/1,5-542/M8FS SH BK - 1406008

Dimensioned drawing

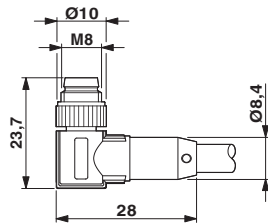

Plug M8 x 1, angled, shielded

Circuit diagram

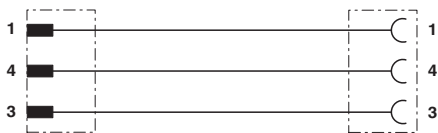

Contact assignment of M8 plugs/sockets

Dimensioned drawing

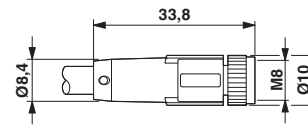

Socket M8 x 1, straight, shielded

Schematic diagram

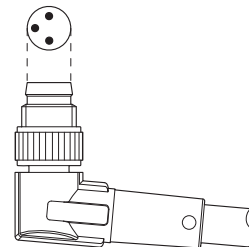

Layout of connector pin assignments