

© COPYRIGHT 1997 BY SPC TECHNOLOGY. ALL RIGHTS RESERVED. NO PORTION OF THIS PUBLICATION, WHETHER IN WHOLE OR IN PART CAN BE REPRODUCED WITHOUT THE EXPRESS WRITTEN CONSENT OF SPC TECHNOLOGY.

REVISIONS					DDC, NO. SPC-FD05, Total Pages: 2		
DCP #	REV	DESCRIPTION	DRAWN	DATE	CHECKD	DATE	APPRVD
18	A	RELEASED	D.J.C.	4/3/97	J.C.	4/8/97	B.B.
428	B	CHANGE ELECTRONIC FILE NAME	DJC	2/12/98	JC	2/17/98	JC

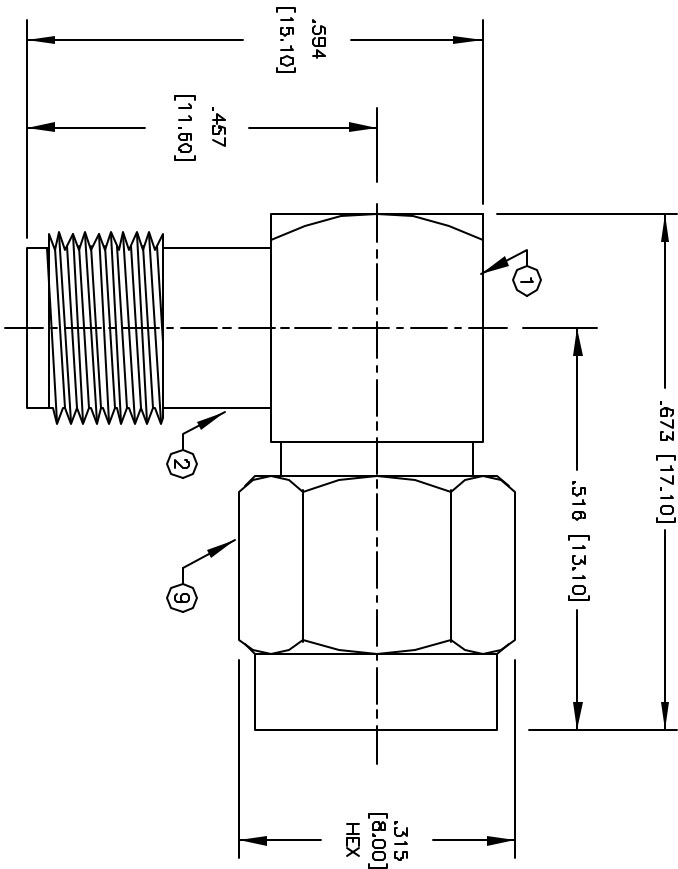

SPECIFICATIONS:

IMPEDANCE: 50 OHMS
WORKING VOLTAGE: 335 VRMS @ SEA LEVEL
FREQUENCY RANGE: 0-12.4 GHz

10	END CAP	1	BRASS	GOLD
9	SHELL	1	BRASS	GOLD
8	RETAINING RING	1	BERYLLIUM COPPER	NONE
7	GASKET	1	S.I. RUBBER	BRIGHT ORANGE
6	DIELECTRIC	1	TEFLON	NONE
5	DIELECTRIC	1	TEFLON	NONE
4	CONTACT	1	BERYLLIUM COPPER	GOLD
3	PIN	1	BRASS	GOLD
2	FEMALE BODY	1	BRASS	GOLD
1	MALE BODY	1	BRASS	GOLD
ITEM	DESCRIPTION	QTY	MATERIAL	FINISH

DISCLAIMER
ALL STATEMENTS AND TECHNICAL INFORMATION CONTAINED HEREIN ARE BASED UPON INFORMATION AND/OR TESTS WE BELIEVE TO BE ACCURATE AND RELIABLE. SINCE CONDITIONS OF USE ARE BEYOND OUR CONTROL, THE USER SHALL DETERMINE THE SUITABILITY OF THE PRODUCT FOR THE INTENDED USE AND ASSUME ALL RISK AND LIABILITY WHATSOEVER IN CONNECTION THEREWITH.



DIMENSIONS ARE FOR REFERENCE PURPOSES ONLY.		DRAWN BY:	DATE:	DRAWING TITLE:			
		DANIEL CAREY	4/3/97	SMA FEMALE TO SMA MALE R/A ADAPTER			
		CHECKED BY:	DATE:	SIZE	DWG. NO.	CAD FILE	REV
		JOHN COLE	4/8/97	A	8589-0847	16N2729.DWG	B
		APPROVED BY:	DATE:	SCALE:	NTS	U.O.M.: INCHES [mm]	SHEET: 1 OF 1
		BRETT BRAATZ	4/16/97				