

PART  
NAME

DIN RAIL MOUNTING CLIP

PART  
No.

DNC-4796

REV.  
DATE

8-10-12

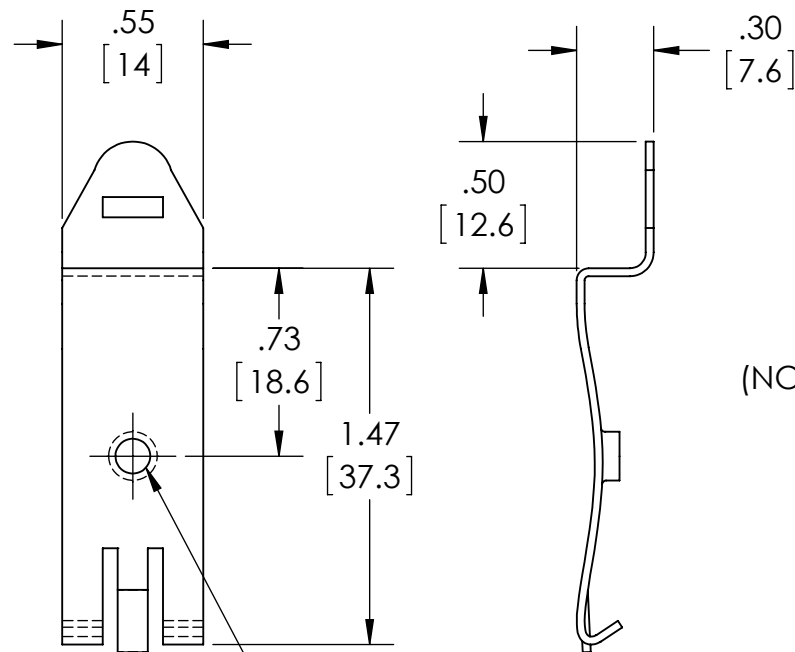

M4x0.7 TAPPED

REF. BOX  
(NOT SUPPLIED)

REF. 35MM DIN RAIL

DRILL A  $\phi$ .169" [4.3mm]  
(#18 DRILL) HOLE FOR  
MOUNTING THE CLIP

MATERIAL - 20 GA. [0.8mm] STEEL

FINISH - ZINC PLATED

SHIPPED IN PLASTIC BAG CONSISTING OF  
ONE CLIP, ONE M4x0.7 x 8mm LG. MACHINE  
SCREW AND ONE M5 LOCKWASHER.