

PART NUMBER CODING

SFH210-PP_C-D_-ID-BK

COLOR

BK= BLACK

NUMBER OF POSITIONS

(CONTACTS PER ROW)

PLATING

(SEE PLATING TABLE)

PLATING TABLE

CONTACT SURFACE	TERMINATION
P = GOLD FLASH	GOLD FLASH
V = GOLD FLASH	NICKEL
K = .000015" GOLD	NICKEL
J = .000015" GOLD	GOLD FLASH
E = .000100" PURE TIN, MATTE	.000100" PURE TIN, MATTE

REVISIONS

REV.	ECO. NO	DESCRIPTION	DATE	BY
A	1930	INITIAL RELEASE	3/17/2009	JH
B	2159	UPDATE FLAT RIBBON CABLE SPEC.	07/05/2010	LH
C	3374	REMOVE 30 AND 32 POSITION OF DIMENSION .047[1.20] ON PAGE 2	02/01/2016	LH

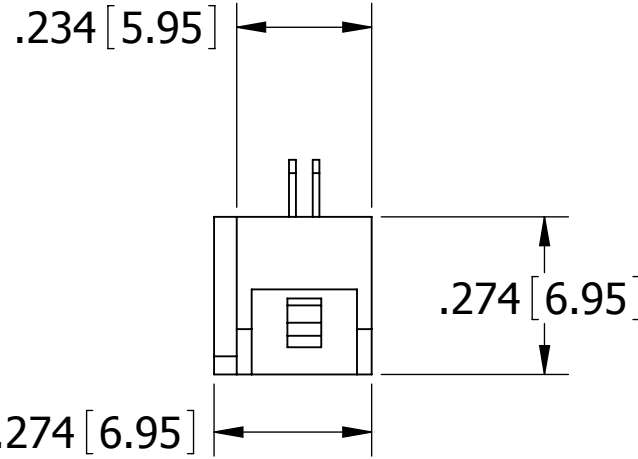
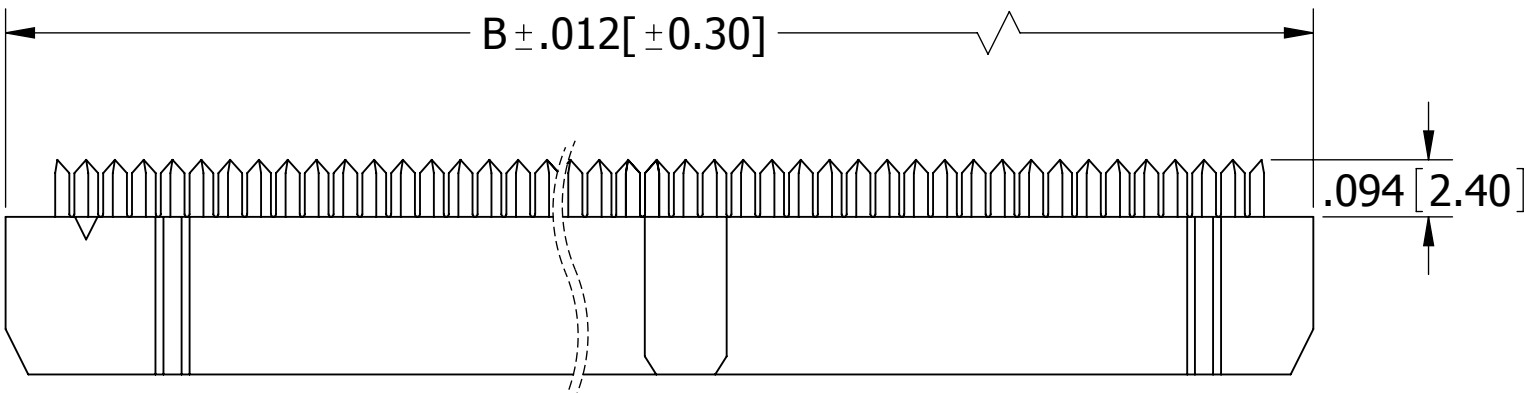
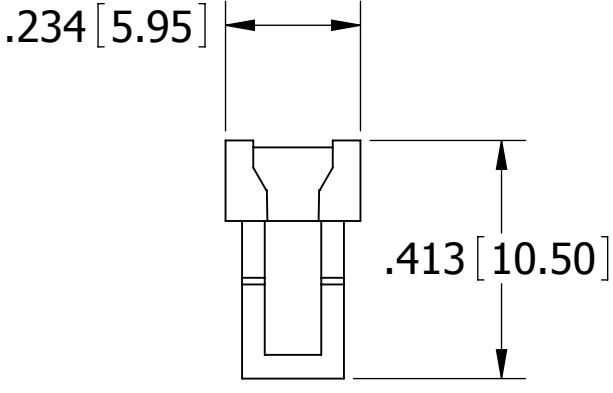
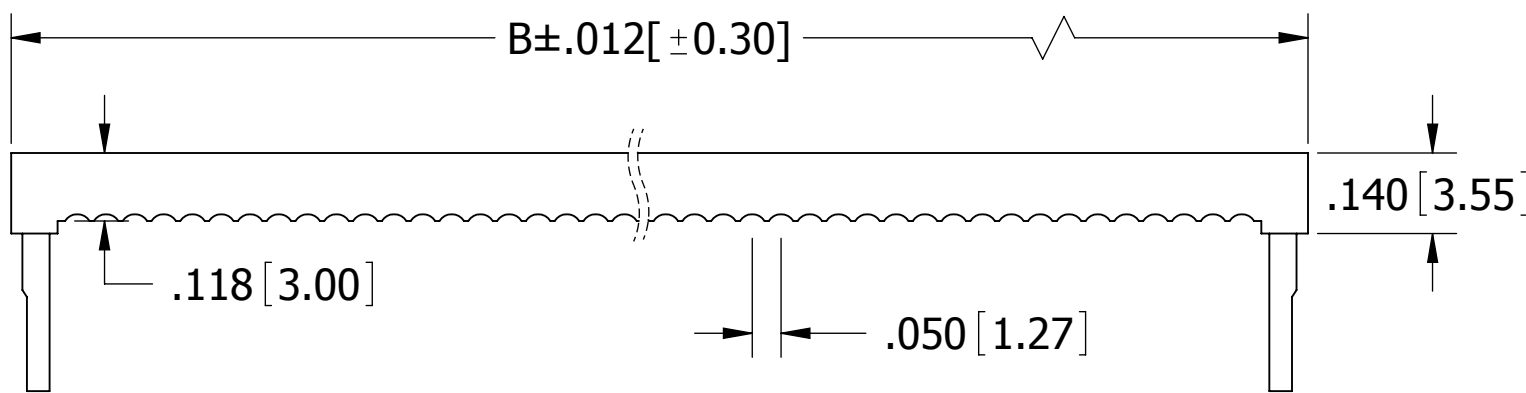

(POSITION 07 THRU 25)

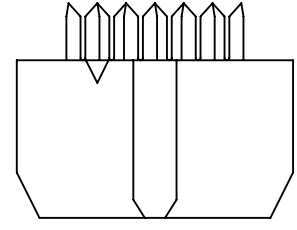
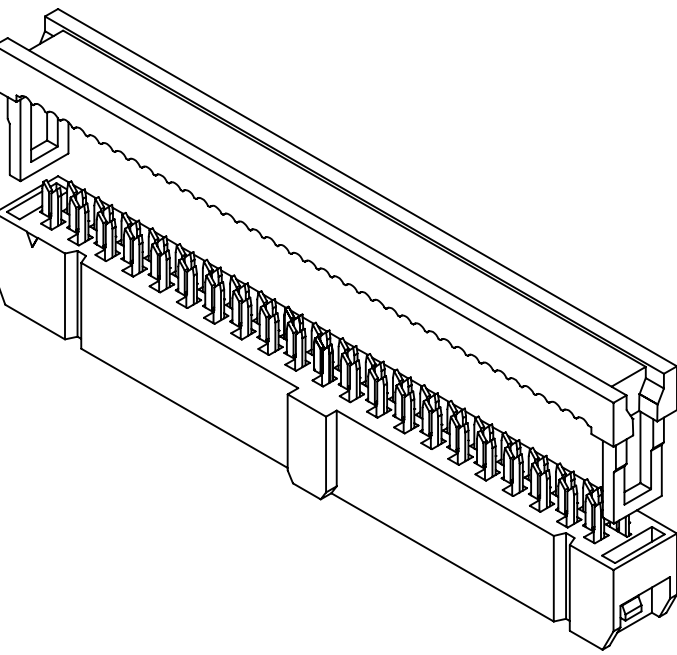
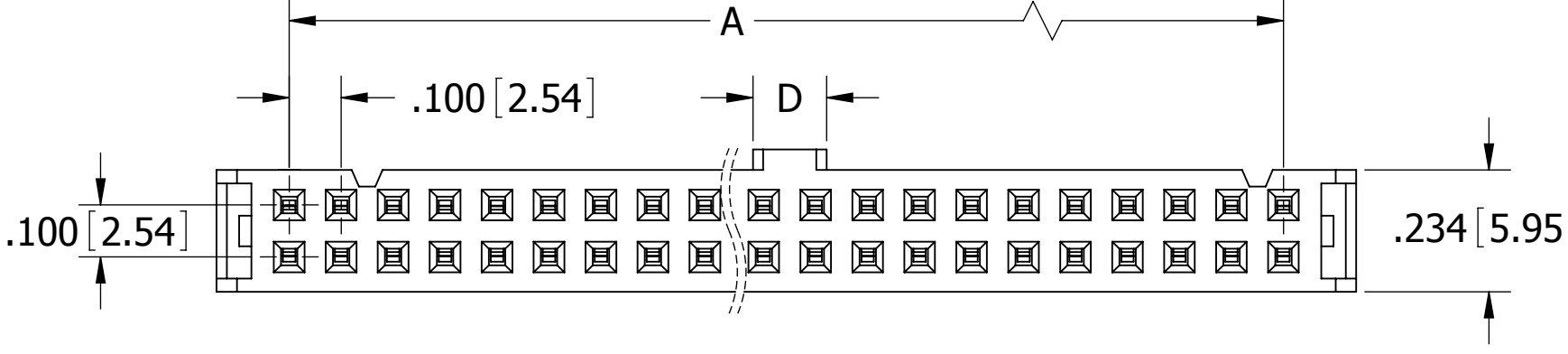

(POSITION 03)

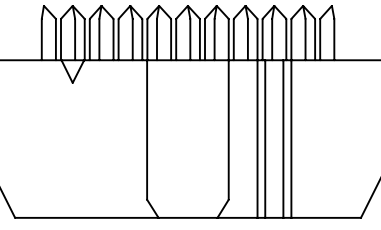

(POSITION 05)

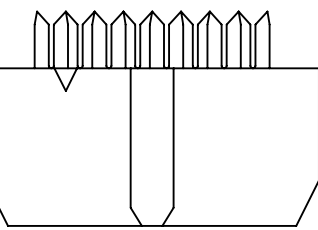

(POSITION 04)

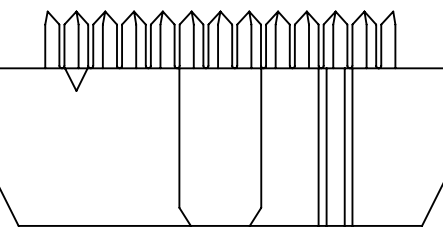

(POSITION 06)

PART NUMBER	POSITIONS/ CONTACTS	A		B		D	
		INCH	MM	INCH	MM	INCH	MM
SFH210-PP_C-D03-ID-BK	03/06	0.200	5.08	0.480	12.18	0.075	1.90
SFH210-PP_C-D04-ID-BK	04/08	0.300	7.62	0.580	14.72		
SFH210-PP_C-D05-ID-BK	05/10	0.400	10.16	0.680	17.26	0.142	3.60
SFH210-PP_C-D06-ID-BK	06/12	0.500	12.70	0.780	19.80		
SFH210-PP_C-D07-ID-BK	07/14	0.600	15.24	0.880	22.34		
SFH210-PP_C-D08-ID-BK	08/16	0.700	17.78	0.980	24.88		
SFH210-PP_C-D09-ID-BK	09/18	0.800	20.32	1.080	27.42		
SFH210-PP_C-D10-ID-BK	10/20	0.900	22.86	1.180	29.96		
SFH210-PP_C-D12-ID-BK	12/24	1.100	27.94	1.380	35.04		
SFH210-PP_C-D13-ID-BK	13/26	1.200	30.48	1.480	37.58		
SFH210-PP_C-D15-ID-BK	15/30	1.400	35.56	1.680	42.66		
SFH210-PP_C-D17-ID-BK	17/34	1.600	40.64	1.880	47.74		
SFH210-PP_C-D18-ID-BK	18/36	1.700	43.18	1.985	50.43		
SFH210-PP_C-D20-ID-BK	20/40	1.900	48.26	2.180	55.36		
SFH210-PP_C-D22-ID-BK	22/44	2.100	53.34	2.387	60.64		
SFH210-PP_C-D25-ID-BK	25/50	2.400	60.96	2.680	68.06		
POSITION 30 & 32: SEE SHEET 2 FOR P/N	30/60	SEE SHEET 2 FOR DIMENSIONS					
	32/64						

- NOTES:
1. INSULATOR MATERIAL: PBT 30% GLASS FIBER.
 2. CONTACT MATERIAL: PHOSPHOR BRONZE.
 3. OPERATING TEMPERATURE: -40 °C TO +105 °C.
 4. UL FLAMMABILITY RATING: 94V-0.
 5. CURRENT RATING: 1 AMP PER CONTACT.
 6. INSULATION RESISTANCE: 3,000 MEGOMHS MIN.
 7. CONTACT RESISTANCE: 30m OHMS MAX.
 8. DIELECTRIC WITHSTANDING: 500 V AC.
 9. MATES WITH SBH11 SERIES
 10. FOR .050"[1.27mm] PITCH FLAT RIBBON CABLE, 26 - 28 AWG WIRE RANGE.

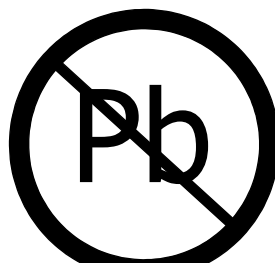

RoHS COMPLIANT

UNLESS OTHERWISE SPECIFIED:
DIMENSIONS ARE IN INCHES [MM]

TOLERANCES:

ANGULAR: ± 1°

DECIMALS

.XX=± .01 [.3]

.XXX=± .008 [.20]

.XXXX=± .0040 [.100]

DRAWN	DATE	NAME
	03/17/2009	JH

THE INFORMATION HEREIN CONTAINS
PROPRIETARY INFORMATION OF
SULLINS ELECTRONICS AND IS NOT
TO BE REPRODUCED, USED OR
DISCLOSED TO OTHERS FOR ANY
PURPOSE EXCEPT AS SPECIFICALLY
AUTHORIZED IN WRITING BY AN
OFFICER OF SULLINS ELECTRONICS.

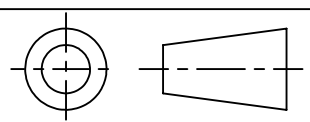

TITLE			
IDC SOCKET, .100" CC/RS			
PART NUMBER			
SFH210-PP_C-D_-ID-BK			
SIZE	CAGE CODE	DWG. NO.	REV
C	54453	11222	C
SCALE: 2:1		SHEET 1 OF 2	

