



## Photoelectric sensors W12-3, Photoelectric proximity sensor, Background suppression

WTB12-3F2431



**Model Name** > [WTB12-3F2431](#)  
**Part No.** > [1041420](#)



#### At a glance

- State of the art technology provides precise background suppression
- Withstands harsh environments
- PinPoint LED technology with highly visible light spot; variants available with IR LED for highly critical applications
- Rugged die-cast zinc housing, with optional Teflon® coating
- Versatile mounting options due to dovetail mounting - mounting holes and oblong holes
- Highly visible status LEDs
- Sensing range adjustment with potentiometer or teach-in pushbutton
- IO-Link communication available (optional)

#### Your benefits

State of the art technology, e.g. OES3 provides precise background suppression and reliable detection of challenging objects

High immunity to ambient light, optical reflections and crosstalk ensures fewer false readings and less downtime

PinPoint LED technology provides a highly visible light spot that enables quick and easy sensor alignment

Highly visible status LEDs simplify sensing distance adjustments and reduce installation time

A rugged metal housing withstands high-pressure cleaners and cleaning agents, reducing downtime

Complementary outputs in one housing reduce inventory and procurement costs

IO-Link enables quick remote diagnostics and maintenance (optional)

Easy installation using SICK accessories



#### Features

Dimensions (W x H x D):	15.6 mm x 48.5 mm x 42 mm
Sensing range max.:	20 mm ... 350 mm <sup>1)</sup>
Sensing range:	20 mm ... 350 mm
Housing design (light emission):	Rectangular
Light source:	LED <sup>2)</sup>
Type of light:	Visible red light

Wave length:	640 nm
Sensitivity adjustment:	Potentiometer, 5-turn
Delay time:	Fix:
Time type:	Time delay off
Off delay:	20 ms
Sensor/detection principle:	Photoelectric proximity sensor, Background suppression
Light spot (distance):	6 mm (200 mm)

<sup>1)</sup> Object with 90 % reflectance (referred to standard white DIN 5033) <sup>2)</sup> Average service life 100,000 h at Ta = +25 °C

## Mechanics/electronics

Enclosure rating:	IP 66 IP 67 IP 69K
Supply voltage:	10 V DC ... 30 V DC <sup>1)</sup>
Residual ripple:	≤ 5 Vpp <sup>2)</sup>
Power consumption:	≤ 60 mA <sup>3)</sup>
Switching output:	PNP, light/dark-switching, Complementary
Output current I <sub>max.</sub> :	100 mA
Response time:	≤ 330 μs <sup>4)</sup>
Switching frequency:	1,500 Hz <sup>5)</sup>
Connection type:	Connector M12, 4-pin
Protection class:	II
Circuit protection:::	A, C, D <sup>6)</sup> <sup>7)</sup> <sup>8)</sup>
Weight:	120 g
Ambient operating temperature:	-40 °C ... 60 °C
Ambient storage temperature:	-40 °C ... 75 °C
Special device:	-
UL File-No.:	UL No. NRKH.E181493 & cUL No. NRKH7.E181493

<sup>1)</sup> Limit values, operation in short-circuit protected network max. 8 A <sup>2)</sup> May not exceed or fall short of V<sub>S</sub> <sup>3)</sup> Without load <sup>4)</sup> Signal transit time with resistive load <sup>5)</sup> With light/dark ratio 1:1 <sup>6)</sup> A = V<sub>S</sub> connections reverse-polarity protected <sup>7)</sup> C = interference suppression <sup>8)</sup> D = outputs overcurrent and short-circuit protected

## Dimensional drawing

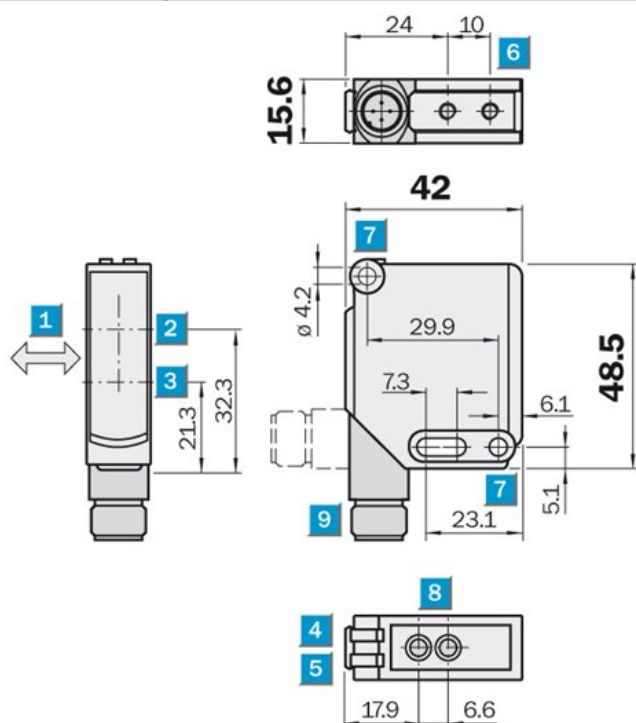

- [1] Standard direction of the material being scanned
- [2] Optical axis, receiver
- [3] Optical axis, sender
- [4] Status indicator LED green: supply voltage active
- [5] Status indicator LED, yellow: Status of received light beam
- [6] M4 threaded mounting hole, 4 mm deep
- [7] Mounting hole, Ø 4.2 mm
- [8] Scanning distance adjustment, double Teach button
- [9] Connection

## Einstell-Möglichkeiten

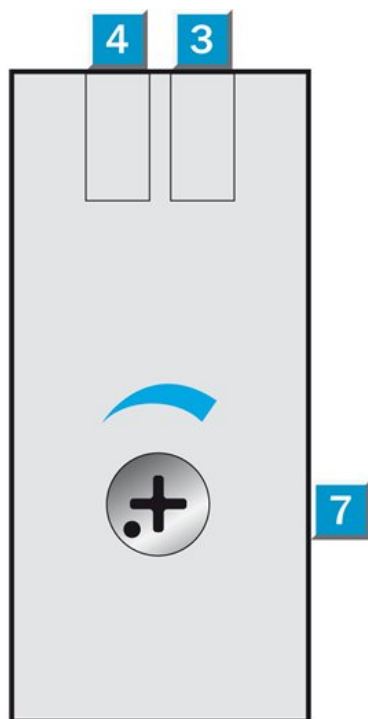

- [3] Status indicator LED, yellow: Status of received light beam
- [4] Status indicator LED green: supply voltage active
- [7] Sensing distance adjustment: Poti

## Connection diagram

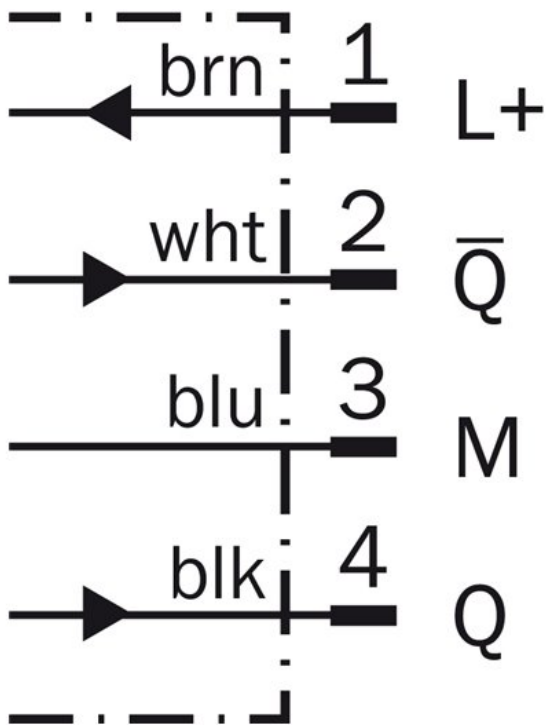

## Connection type

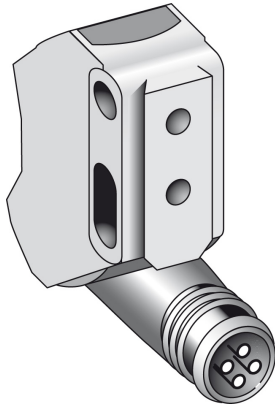

## Characteristic curve

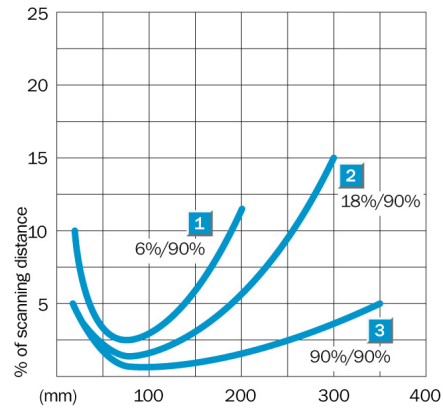

## Sensing range diagram

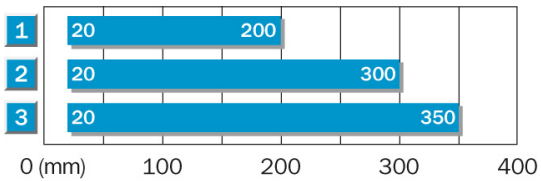

1	Scanning distance on black, 6 % Remission
2	Scanning distance on grey, 18 % Remission
3	Scanning on white, 90 % Remission

**Australia**

Phone +61 3 9497 4100  
1800 334 802 – tollfree  
E-Mail sales@sick.com.au

**Belgium/Luxembourg**

Phone +32 (0)2 466 55 66  
E-Mail info@sick.be

**Brasil**

Phone +55 11 3215-4900  
E-Mail sac@sick.com.br

**Canada**

Phone +1(952) 941-6780  
1 800-325-7425 – tollfree  
E-Mail info@sickusa.com

**Ceská Republika**

Phone +420 2 57 91 18 50  
E-Mail sick@sick.cz

**China**

Phone +852-2763 6966  
E-Mail ghk@sick.com.hk

**Danmark**

Phone +45 45 82 64 00  
E-Mail sick@sick.dk

**Deutschland**

Phone +49 211 5301-301  
E-Mail kundenservice@sick.de

**España**

Phone +34 93 480 31 00  
E-Mail info@sick.es

**France**

Phone +33 1 64 62 35 00  
E-Mail info@sick.fr

**Great Britain**

Phone +44 (0)1727 831121  
E-Mail info@sick.co.uk

**India**

Phone +91-22-4033 8333  
E-Mail info@sick-india.com

**Israel**

Phone +972-4-999-0590  
E-Mail info@sick-sensors.com

**Italia**

Phone +39 02 27 43 41  
E-Mail info@sick.it

**Japan**

Phone +81 (0)3 3358 1341  
E-Mail support@sick.jp

**Magyarország**

Phone +36 1 371 2680  
E-Mail office@sick.hu

**Nederlands**

Phone +31 (0)30 229 25 44  
E-Mail info@sick.nl

**Norge**

Phone +47 67 81 50 00  
E-Mail austefjord@sick.no

**Österreich**

Phone +43 (0)22 36 62 28 8-0  
E-Mail office@sick.at

**Polska**

Phone +48 22 837 40 50  
E-Mail info@sick.pl

**România**

Phone +40 356 171 120  
E-Mail office@sick.ro

**Russia**

Phone +7 495 775 05 30  
E-Mail info@sick.ru

**Schweiz**

Phone +41 41 619 29 39  
E-Mail contact@sick.ch

**Singapore**

Phone +65 6744 3732  
E-Mail admin@sicksgp.com.sg

**South Africa**

Phone +27 11 472 3733  
E-Mail info@sickautomation.co.za

**South Korea**

Phone +82-2 786 6321/4  
E-Mail info@sickkorea.net

**Slovenija**

Phone +386 (0)1-47 69 990  
E-Mail office@sick.si

**Suomi**

Phone +358-9-25 15 800  
E-Mail sick@sick.fi

**Sverige**

Phone +46 10 110 10 00  
E-Mail info@sick.se

**Taiwan**

Phone +886 2 2375-6288  
E-Mail sales@sick.com.tw

**Türkiye**

Phone +90 216 528 50 00  
E-Mail info@sick.com.tr

**United Arab Emirates**

Phone +971 4 8865 878  
E-Mail info@sick.ae

**USA/México**

Phone +1(952) 941-6780  
1 800-325-7425 – tollfree  
E-Mail info@sickusa.com

More representatives and agencies  
at [www.sick.com](http://www.sick.com)