



FUNCTION MODULE FOR AS-I, DIRECT START,
SCREW CONNECTION,
MOUNTED ON CONTACTORS 3RT2 S00/ S0 COMM.
CAPABLE CONTACTOR REQUIRED

General technical data:

product brand name		Sirius
product designation		set direct starter AS-i screw terminal
Design of the product		direct starter function
Size of the contactor / can be combined / company-specific		S00, S0
Protection class IP / on the front		IP20
Degree of pollution		3
Insulation voltage / with degree of pollution 3		
• rated value	V	690
Installation altitude / at a height over sea level / maximum	m	2,000
Ambient temperature		
• during storage	°C	-40 ... +80
• during operating	°C	-25 ... +60
• during transport	°C	-40 ... +80
EMC immunity to interference		
• according to IEC 60947-1		ambience A (industrial sector)
EMC emitted interference		
• according to IEC 60947-1		CISPR11, ambience A (industrial sector)
Conductor-bound parasitic coupling BURST		
• according to IEC 61000-4-4		2 kV network connection / 1 kV control connection

Conductor-bound parasitic coupling conductor-earth SURGE		1 kV
• according to IEC 61000-4-5		
Conductor-bound parasitic coupling conductor-conductor SURGE		0.5 kV
• according to IEC 61000-4-5		
Electrostatic discharge		8 kV
• according to IEC 61000-4-2		
Field-bound parasitic coupling		10 V/m
• according to IEC 61000-4-3		
Resistance against shock		11g / 15 ms
Resistance against vibration		10 ... 55 Hz / 0.35 mm
Item designation		K
• according to DIN 40719 extendable after IEC 204-2 / according to IEC 750		
• according to DIN EN 61346-2		K
Acceptability for application		Yes
• direct starter		No
• star-delta starter		No
• reversing starter		No

Communication:

Product function

- bus-communication
- control circuit interface with AS interface

Yes
Yes

Control circuit:

Design of the surge suppressor

suppressor diode

Type of voltage / of the controlled supply voltage

DC

Control supply voltage / 1 / for DC / rated value

V

24

Installation/mounting/dimensions:

mounting position

any

Type of mounting

can be plugged into contactor

Width

mm

45

Height

mm

37

Depth

mm

75

Connections:

Product function

- removable terminal for auxiliary and control circuit

Yes

Design of the electrical connection

<ul style="list-style-type: none"> • for auxiliary and control current circuit 	screw-type terminals
Type of the connectable conductor cross-section <ul style="list-style-type: none"> • for auxiliary contacts <ul style="list-style-type: none"> • solid • finely stranded <ul style="list-style-type: none"> • with conductor end processing • for AWG conductors / for auxiliary contacts 	0.5 ... 4 mm ² , 2x (0.5 ... 2.5 mm ²) 1x (0.5 ... 2.5 mm ²), 2x (0.5 ... 1.5 mm ²) 2x (20 ... 14)

Certificates/approvals:

Verification of suitability

CE / UL / CSA

General Product Approval

Test Certificates



[Special Test Certificate](#)

[Type Test Certificates/Test Report](#)

Shipping Approval



Shipping Approval

other



[Declaration of Conformity](#)

[other](#)

Further information:

Information- and Downloadcenter (Catalogs, Brochures,...)

<http://www.siemens.com/industrial-controls/catalogs>

Industry Mall (Online ordering system)

<http://www.siemens.com/industrial-controls/mall>

CAX-Online-Generator

<http://www.siemens.com/cax>

Service&Support (Manuals, Certificates, Characteristics, FAQs,...)

<http://support.automation.siemens.com/WW/view/en/3RA2712-1AA00/all>

Image database (product images, 2D dimension drawings, 3D models, device circuit diagrams, ...)

http://www.automation.siemens.com/bilddb/cax_en.aspx?mlfb=3RA2712-1AA00

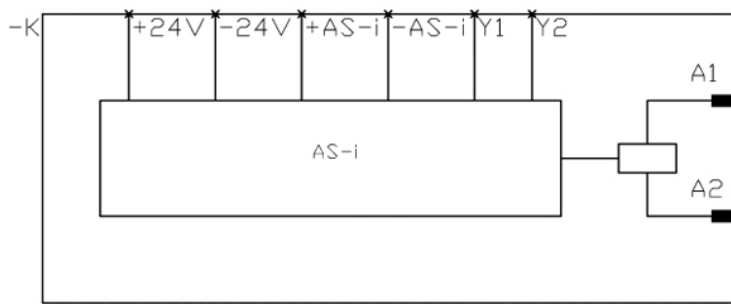
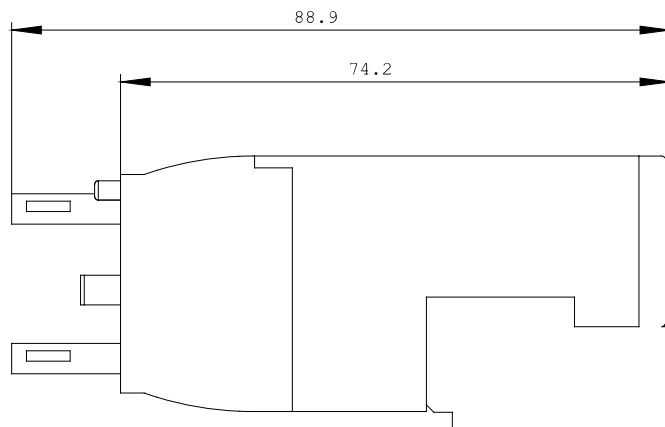
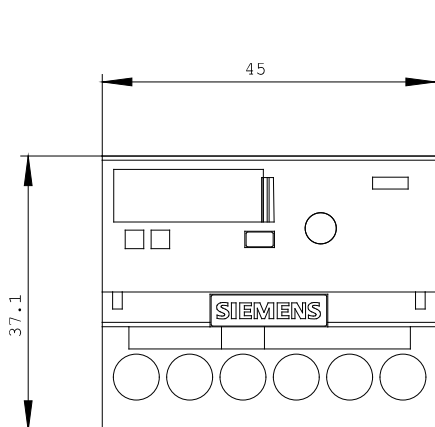

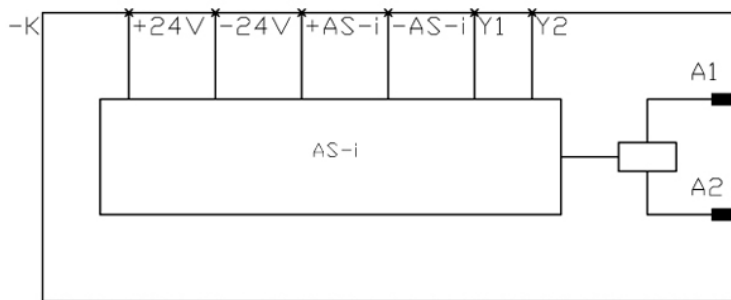

last change:

Apr 13, 2012