



8500 Series  
Subminiature Pushbutton Switches



A

Pushbutton

SWITCH FUNCTION

NO. POLES	MODEL NO.	RATING	SWITCH FUNCTION		TOTAL TRAVEL	ACTUATION FORCE	SCHEMATIC
			POS. 1	POS. 2			
SP	8531	1 AMP	OFF	MOM.	.095 (2,41) TYP. with overtravel .042 (1,07) TYP.	7.7 oz (220g) TYP.	N.O. with overtravel
	8551	3 AMPS					

SPST

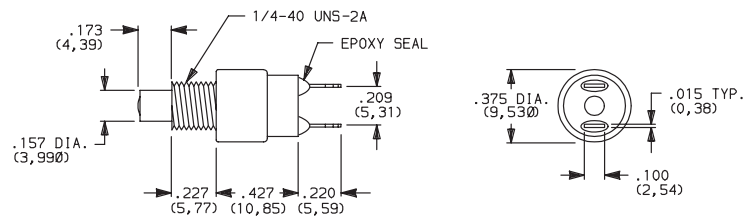

Part number shown: 8531MZQE2

SP	8532	1 AMP	OFF	MOM.	.050 (1,27) TYP.	6 oz (170g) TYP.	N.O.
	8552	3 AMPS					

SPST

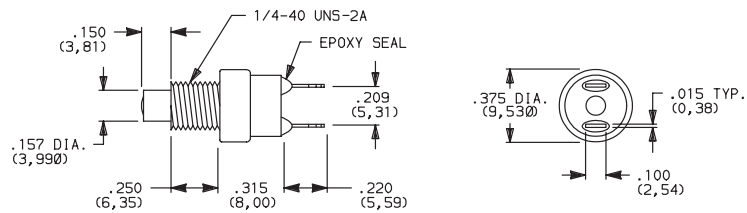

Part number shown: 8532MZQE2

SP	8533	1 AMP	ON	MOM.	.080 (2,03) TYP. with pretravel .057 (1,45) TYP.	11.5 oz (456 g) TYP.	N.C. with pretravel
	8534	1 AMP	ON	MOM.	.032 (0,81) TYP. with overtravel .028 (0,71) TYP.	10.3 oz (282g) TYP.	N.C. with overtravel

SPST

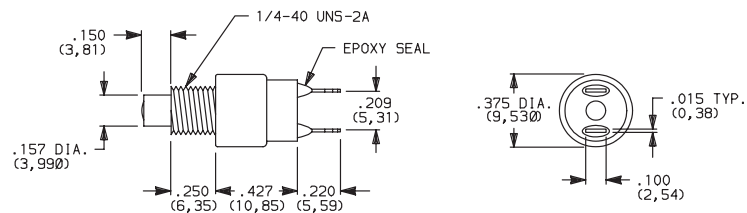

Part number shown: 8533MZQE2

MOM. = Momentary  
All models  with all options when ordered with G or Q contact material.

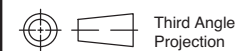

Dimensions are shown: Inches (mm)  
Specifications and dimensions subject to change

www.ck-components.com

**A****Pushbutton**

# 8500 Series Subminiature Pushbutton Switches

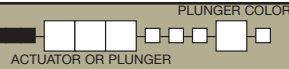
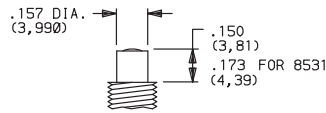
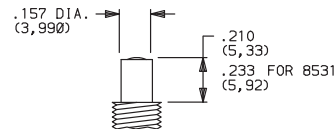
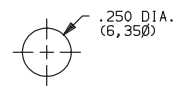
**PLUNGER****M** .150" HIGH PLUNGER**S** .210" HIGH PLUNGER**PANEL MOUNTING**

OPTION CODE	PLUNGER COLOR
<b>2</b>	BLACK
<b>3</b>	RED

**NOTE:** One mounting nut and lockwasher supplied with all actuators (except T actuator: two nuts supplied).

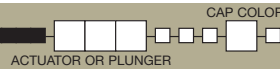
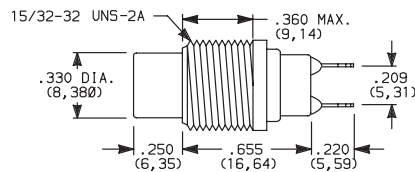
**ACTUATOR****T** 15/32 BUSHING

**NOTE:** No frame color choice required.

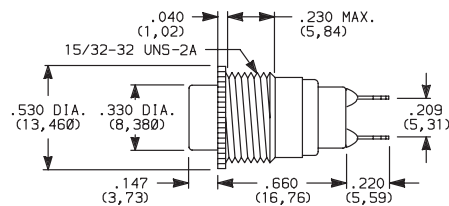
**T1** 15/32 BUSHING WITH FRAME

**NOTE:** No frame color choice required.  
Available with 8532 and 8534 models only.

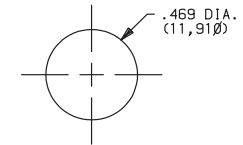
**PANEL MOUNTING**

OPTION CODE	CAP COLOR
<b>2</b>	BLACK
<b>1</b>	WHITE
<b>3</b>	RED
<b>9</b>	GRAY

Cap Finish: gloss. Other colors available, consult Customer Service Center.

One mounting nut and lockwasher supplied with all actuators (except T actuator: two nuts supplied).

**NOTE:** Caps available for plunger options, see page A-65.

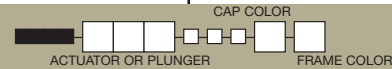
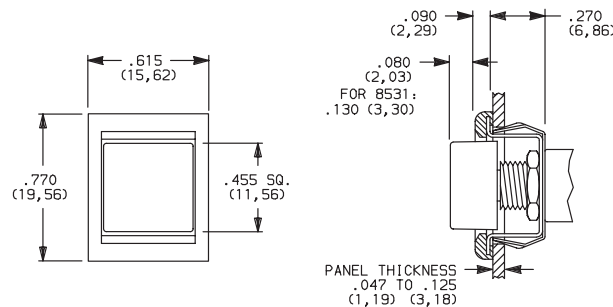
**ACTUATOR—SNAP-IN FRONT MOUNT****J81** SNAP-IN WITH FRAME

OPTION CODE	CAP AND FRAME COLOR
<b>2</b>	BLACK

Cap and Frame Finish: matte. Other colors available, consult Customer Service Center.

One mounting nut and lockwasher supplied with all actuators.

**NOTE:** Caps & frames available separately, see pages A-65 and A-66.

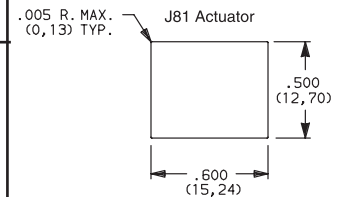
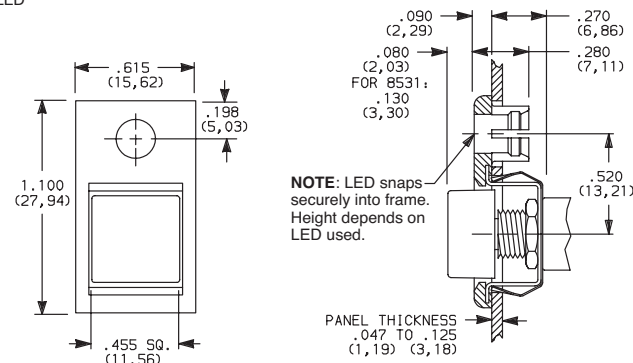
**PANEL MOUNTING****J82** SNAP-IN WITH FRAME FOR LED

**NOTE:** LED snaps securely into frame. Height depends on LED used.

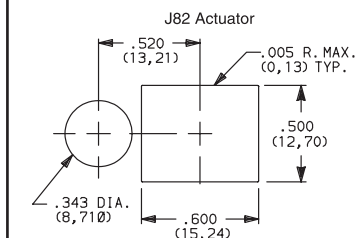

**LED not included.**  
For LED information, see page A-66.



Dimensions are shown: Inches (mm)  
Specifications and dimensions subject to change

**C&K**

# 8500 Series Subminiature Pushbutton Switches



A

Pushbutton

## TERMINATIONS



**Z**

SOLDER LUG

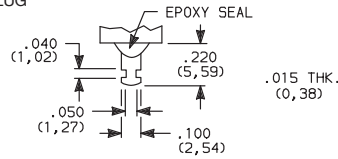

**C**

PC THRU-HOLE

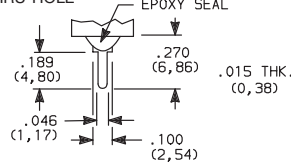

PC MOUNTING

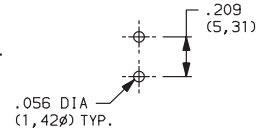

**AV**

RIGHT ANGLE, PC THRU-HOLE

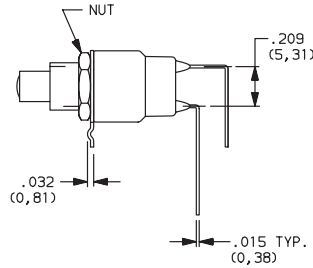
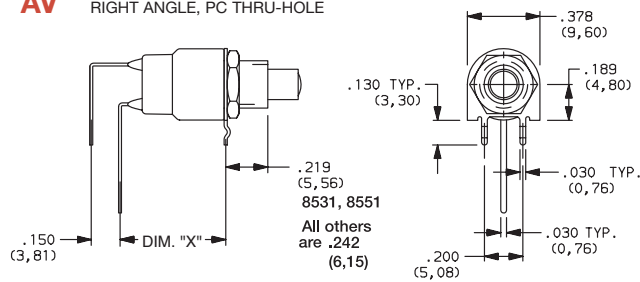

PC MOUNTING

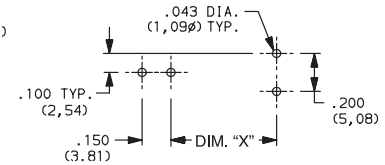

Available with

MODEL NO.	DIM "X"
8531, 8533	0.550
8532, 8534	0.438

**NOTE:** Available with M or S plunger models, and B contact material only.

## CONTACT MATERIAL



OPTION CODE	RoHS COMPLIANT *	RoHS COMPATIBLE *	TERMINAL PLATING	CONTACT MATERIAL	RATINGS	
<b>B</b>	YES	YES	GOLD <sup>1</sup>	GOLD	LOW LEVEL/DRY CIRCUIT	0.4 VA MAX. @ 20 V AC OR DC MAX.
<b>Q</b>	YES	YES	SILVER <sup>4</sup>	SILVER <sup>5</sup>	POWER	853X MODELS: 1 AMP @ 120 V AC OR 28 V DC. 855X MODELS: 3 AMPS @ 120 V AC OR 28 V DC.
<b>G</b>	YES	YES	GOLD OVER SILVER <sup>2</sup>	GOLD <sup>3</sup>	LOW LEVEL/DRY CIRCUIT OR POWER	0.4 V MAX @ 20 V AC OR DC MAX. OR 853X MODELS: 1 AMP @ 120 V AC OR 28 V DC. 855X MODELS: 3 AMPS @ 120 V AC OR 28 V DC.

\* Note: See Technical Data section of this catalog for RoHS compliant and compatible definitions and specifications.

<sup>1</sup> CONTACTS & TERMINALS: Copper alloy, with gold plate over nickel plate.

<sup>2</sup> CONTACTS: Coin silver, with gold plate over nickel plate.

<sup>3</sup> TERMINALS: Copper alloy, with gold plate over nickel plate.

<sup>4</sup> CONTACTS: Coin silver, silver plated.

<sup>5</sup> TERMINALS: Copper alloy, silver plated.

**NOTE:** Any models supplied with Q, B or G contact material are RoHS compliant.

All models with all options when ordered with G or Q contact material.

Q contact material standard with C, Z terminations.

8551 & 8552 available with Q contact material only.

## SEAL



**E**

EPOXY SEAL

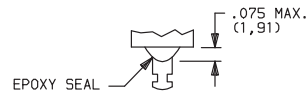

## REPLACEMENT HARDWARE

Cap for 0.157" dia. plungers

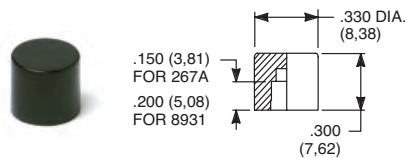

PART NO.

**267A01000** WHITE  
**267A02000** BLACK  
**267A03000** RED  
**267A09000** GRAY

85X2T, 8534T models only

Material: Nylon  
Finish: Gloss

PART NO.

**893101000** WHITE  
**893102000** BLACK  
**893103000** RED  
**893109000** GRAY

85X1T, 8532T1, 8533T, 8534T1 models only

Material: Nylon  
Finish: Gloss

Cap, J80, J81 & J 82 options only

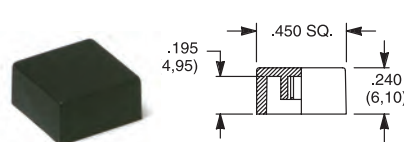

PART NO.

**448901000** WHITE  
**448902000** BLACK  
**448903000** RED  
**448909000** GRAY

Material: Nylon  
Finish: Gloss or matte

Frame



PART NO.

**613302263** BLACK

Material: Nylon  
Finish: Matte

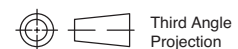

Third Angle Projection

Other colors available, consult Customer Service Center.



Dimensions are shown: Inches (mm)  
Specifications and dimensions subject to change

[www.ck-components.com](http://www.ck-components.com)



A

Pushbutton

# 8500 Series Subminiature Pushbutton Switches

## AVAILABLE HARDWARE

### Frame

#### PART NO.

**615602263** BLACK

Material: Nylon  
Finish: Matte



**NOTE:** Additional nuts, locking rings and lockwashers available separately, see section "Technical Data and Additional Hardware".  
Other colors available, consult Customer Service Center.

Frames snap into panel opening and are independent from switch mounting. Accurate positioning of the PC mounted switch relative to the panel opening is necessary to provide proper clearance between actuator and frame. Available in two basic styles and four panel thicknesses .047-.125 in. Material: Nylon. Finish: Matte.

### TYPICAL APPLICATION

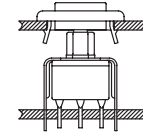

.047" (1,19) PANEL THK.

#### PART NO.

**432502263**

.062" (1,57) PANEL THK.

#### PART NO.

**432602263**

.090" (2,29) PANEL THK.

#### PART NO.

**432702263**

.125" (3,18) PANEL THK.

#### PART NO.

**432802263** BLACK

### PANEL MOUNTING

For part numbers  
4325xxxxx, 4326xxxxx

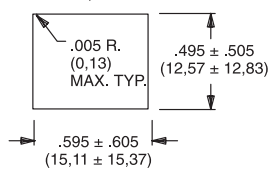

For part numbers  
4327xxxxx, 4328xxxxx

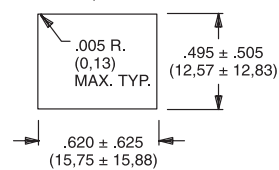

### Panel Inserts

L.E.D. (.200 DIA. (5,08)) SNAPS  
SECURELY INTO INSERT (P/N 8949).  
HEIGHT DEPENDS ON L.E.D. USED.

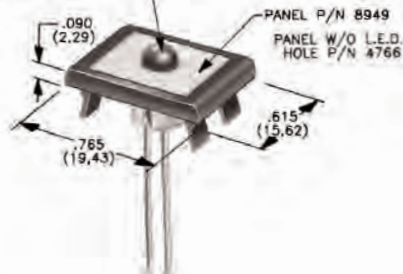

Above frames (part nos. 432XXXXXX) are also available with insert which accepts LED for indicator light assembly. Order insert separately from frame. Blank insert panel (without hole for LED) also available. **LED not included.**

PANEL INSERT  
WITH HOLE FOR LED

#### PART NO.

**894902000**

BLANK PANEL INSERT  
WITHOUT HOLE FOR LED

#### PART NO.

**476602000** BLACK

Special colors, custom markings available, consult Customer Service Center.

## LED INFORMATION

**Process Information:** Soldering to LED leads must be completed within 5 seconds at 500°F (260°C) maximum.  
LEDs are not supplied with J82 option. LED snaps into switch frame surrounding actuator and is wired externally.

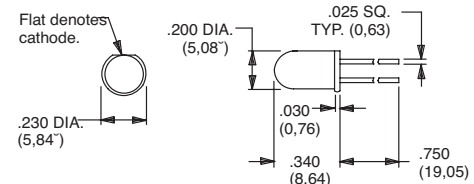

Suggested LED for J82 option.  
Dimensions for reference only.

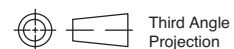

Dimensions are shown: Inches (mm)  
Specifications and dimensions subject to change

[www.ck-components.com](http://www.ck-components.com)