

THIS COPY IS PROVIDED ON A RESTRICTED BASIS AND IS NOT TO BE USED IN ANY WAY DETRIMENTAL TO THE INTERESTS OF PANDUIT CORP.

NOTES:

1. HIGH STRENGTH ELECTROLYTIC
COPPER HIGHLY RESISTANT TO
CORROSION AND SEASON CRACKING.
2. FOR COPPER AND COPPERWELD
WIRES ONLY.
3. *CONNECTOR CAN BE USED WITH
3 WIRES, BUT IS NOT CSA APPROVED
WITH 3 WIRES.
4. **THE CONDUCTOR SIZES SHOWN ARE FOR
EQUAL RUN AND TAP COMBINATIONS FOR
BOTH SOLID AND STRANDED UNLESS OTHERWISE
LISTED.

CATALOG NUMBER	COPPER CONDUCTOR		MAX CONDUCTOR	WIRE DIAMETER RANGE		APPROXIMATE DIMENSIONS (IN INCHES)				REQUIRED TORQUE (IN. - LB.)	
	RANGE OF EQUAL RUN & TAP		MIN TAP WITH ONE MAX RUN								COPPER WELD
	MIN.	MAX		STR.	TYPE A	(IN INCHES)	A	B	C		D
*SBC8L-C	16 STR	8 STR	16 STR	-----	-----	.08-.15	0.15	0.38	0.5	0.84	80
*SBC2L-C	14 STR	2 STR	14 STR	3 NO. 7	3A	.16-.29	0.33	0.63	0.81	1.55	275
SBC750-1	350 kcmil	750 kcmil	8 SOL	19 NO. 5	-----	.68-1.00	1.03	1.94	2.13	3.75	1000
SBC1000-1	500 kcmil	1000 kcmil	8 SOL	-----	-----	.82-1.15	1.22	2.25	2.50	4.00	1100

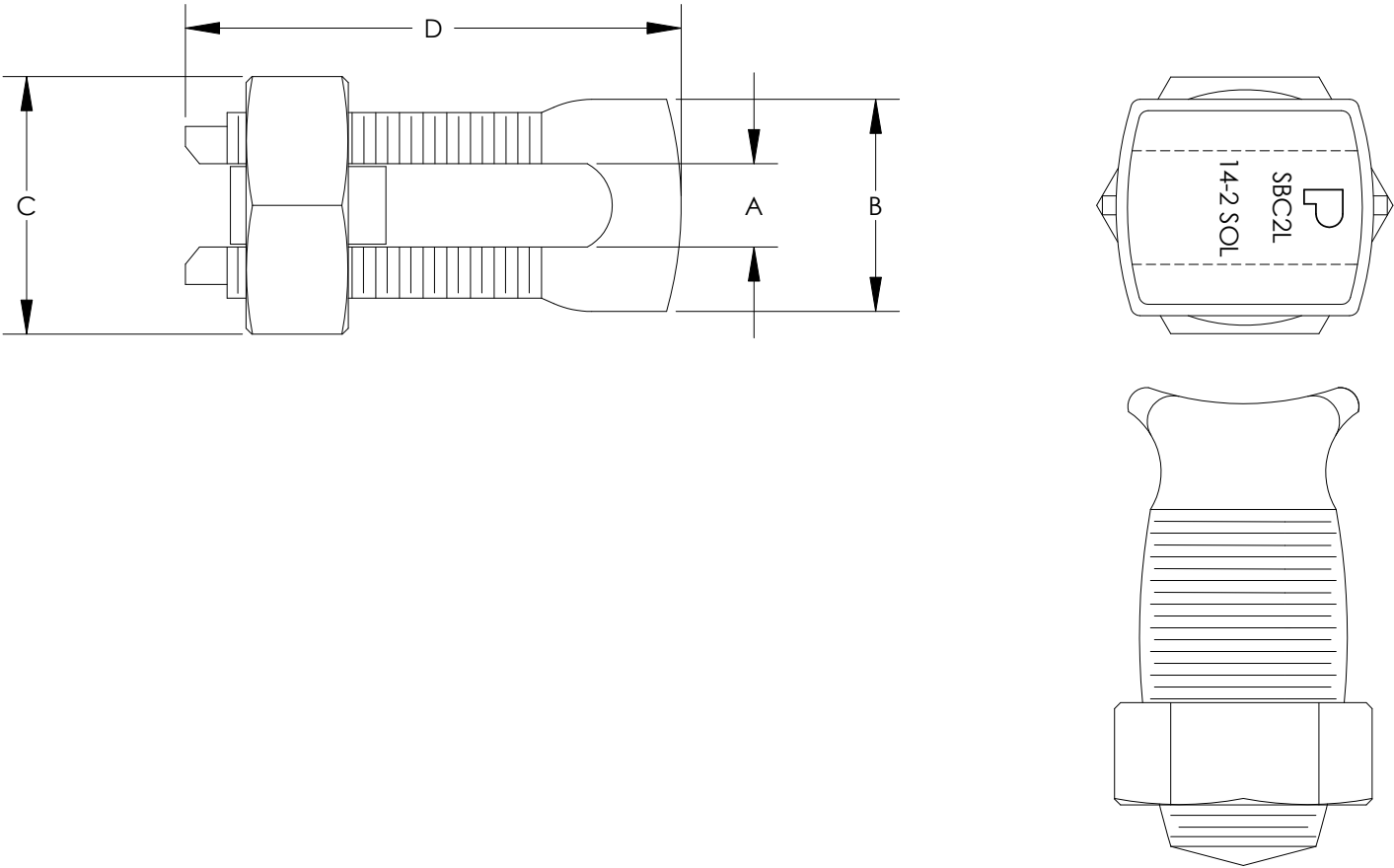
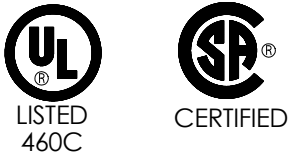

C41188_07

								PANDUIT CORP. TINLEY PARK, ILLINOIS			
								SBC SERIES - COPPER SPLIT BOLT CONNECTOR CUSTOMER DRAWING			
								UNLESS OTHERWISE SPECIFIED DIMENSIONAL TOLERANCES ARE: (.X) ± (.XXX) ± (.XX) ± ANGLES ±		UNLESS OTHERWISE SPECIFIED, ALL DIMENSIONS ARE GIVEN IN INCHES, THIRD ANGLE PROJECTION	
07	2/11	JHNU	RWK	REV'D RANGE OF EQUAL RUN & TAP FOR SBC750-1: 350 kcmil MIN. WAS 8 SOL MIN. REV'D RANGE OF EQUAL RUN & TAP FOR SBC1000-1: 500 kcmil MIN. WAS 8 SOL MIN.	N10850BN-C41188	FLD	FLD	DRAWN BY EJD	SEE NOTE 1 ABOVE	SCALE NONE	
								DATE		DRAWING NO / CAD FILE	DWG B SIZE
REV	DATE	BY	CHK	DESCRIPTION	ECN	-R	SUP	CHK'D		C41188	

Mouser Electronics

Authorized Distributor

Click to View Pricing, Inventory, Delivery & Lifecycle Information:

Panduit:

SBC2L-C