

P17 Tempra and Hypra Plugs and Sockets

**P17 Tempra
plugs and
sockets**



P. 344
Surface mounting
sockets

**Hypra Prisinter
and Hypra
plugs and sockets**



P. 345
Prisinter
panel mounting
sockets

**P17 Tempra
Combined
units**



P. 344
Interlocked switched
sockets without
protection

**Metra
plugs and
sockets**



P. 360
Sockets

Dimensions



P. 353-354
P17 Tempra plugs
and sockets



P. 344
Inclined panel
mounting sockets



P. 344
Straight panel
mounting sockets

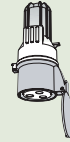

P. 344
Mobile sockets

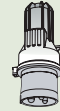

P. 344
Straight plugs



P. 345
Straight plugs
IP 44-7

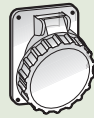

P. 345
Inclined
panel mounting
sockets

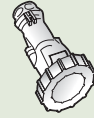

P. 345
Mobile sockets

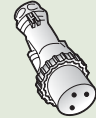

P. 345
Straight plugs
IP 67-7

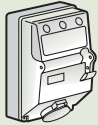

P. 344
Interlocked switched
sockets with DIN rail

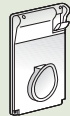

P. 344
Panel mounting with
inter locked
switched sockets

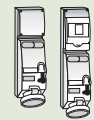

P. 344
Interlocked switch
socket combined
units



P. 360
Plugs



P. 358-359
Hypra Prisinter and
Hypra plugs and
sockets



P. 355
P17 Tempra
Combined units



P. 361
Metra plugs and
sockets

P17 temprra and hypra plugs and sockets

For safe connection which you can depend on. Ensures the protection of personnel at electrical installation



› P17 Tempra plugs and sockets

- 16 Amps to 125 Amps
- Fast fix captive screws
- Screwless cable clamp
- IP 44, IP 66/67
- Surface mounting, panel mounting and mobile sockets, (straight or inclined)
- Straight plugs
- IK 09



› Hypra prisinter and Hypra plugs and sockets

- For extremely harsh environment
- With 2 half clamps for uniform grip on cable, in case of plugs
- IP 44, IP 66/67
- Panel mounting and mobile sockets
- Straight plugs
- IK 09



› P17 Tempra combined units

- 2 sizes only
- Transparent flap with fastener
 - View of Lexic modular protection devices
 - Easy maintenance
 - Guaranteed weatherproofing
- Locking handle for a more accurate reading of ON/OFF positions
- IP 44, IP 55, IP 66
- IK 09



> P17 Tempra combined units

- Fast and reliable wiring
- DIN rail for fitting Lexic modular protection device
- Plug-in system : fast wiring of the socket in the cover on site, independently of the box already mounted on the wall Automatic and reliable connection of the socket when mounting in the box



> Metra metallic plugs and sockets

- With aesthetically elegant, white plugs and sockets
- Metal clad plugs and sockets for trouble free termination of air conditioners



> Ekinox plug and socket DB's for P17 Tempra

- 16 A and 20 A plug and socket distribution boards suitable for SP / DP MCBs or DP RCCBs
- 32 A and 63 A plug and socket distribution boards suitable for TP / FP MCBs or FP RCCBs or FP Loadstop RCBOs

P17 Tempra

quicker to install

New P17 Tempra Plugs & Sockets, from 16 A to 32 A is faster to connect & lock, thus saving your time on site.

Instant locking with screwless clamping

Perfect positioning of the head with its locking pin

Maximum cable grip easy with the screwless cable clamp.

Direct connection with universals screws all terminals facing the same direction.

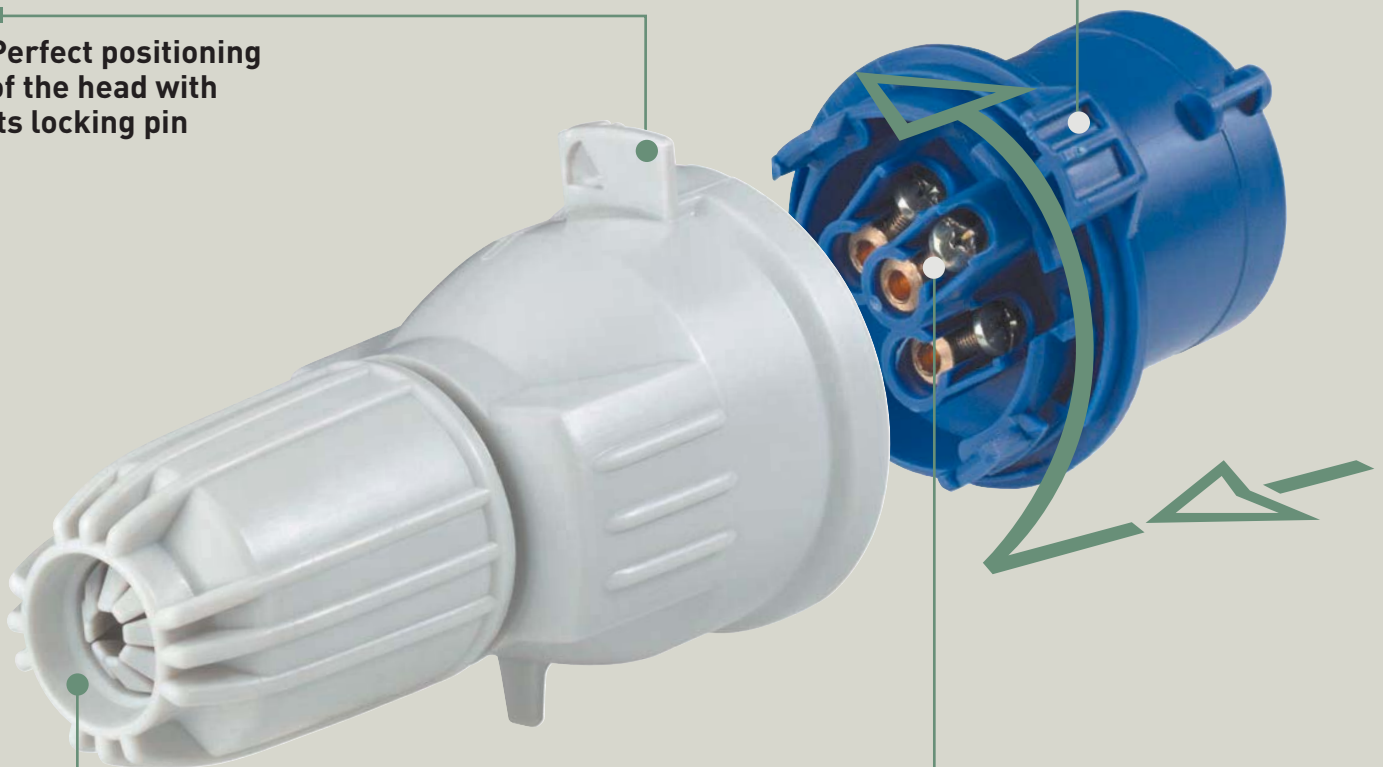



The larger body size makes wiring very easy.



Maximum safety: The elongated earth pin is disconnected last.



For surface mounting sockets: The unit clips directly onto the base.



IP 67 plug has fast fix, captive screws (with $\frac{3}{4}$ rotation) reduce fixing time. Mixed screw heads enable use of 2 types of screw drivers.

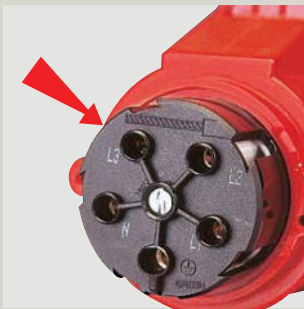

Stripping template engraved on internal plate for optimal areas of contact.



Marking space for label.



Specially designed cable gland ensures waterproofing in IP 67 plug and mobile socket



Ribbed grip. Thumb operated socket lids for easy one handed operation.



Marking of opening and closing position of the socket on the ring, guaranteeing IP 67 protection.



Hand grips on the sides of plugs and sockets for ease of use.

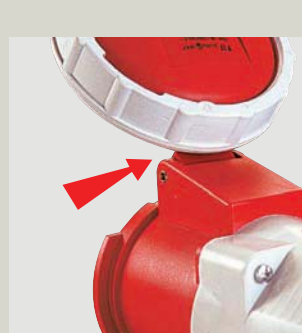

Flap held in open position due to retaining system. Enables easier plugging of products.

plugs & sockets - P17 Tempra

16 to 32 A

LV												
			Surface mounting sockets		Panel mounting sockets - inclined		Panel mounting sockets straight		Mobile sockets		Straight Plugs	
			IP 44		IP 44		IP 44		IP 44		IP 44	
			Cat nos.	Pack	Cat nos.	Pack	Cat nos.	Pack	Cat nos.	Pack	Cat nos.	Pack
200 to 250 V ~ 50/60 Hz	16 A / 20 A	2 P + ⊕	0555 53	10	0576 11	5/50	0573 54	5/50	0575 14	10	0574 34	10
	32 A	2 P + ⊕	0555 73	10	0576 12	5/25	0580 54	5/25	0582 14	10	0581 34	10
380 to 415 V ~ 50/60 Hz	16 A / 20 A	3 P + ⊕	0555 57	10	0576 17	5/25	0573 58	5/50	0575 18	10	0574 38	10
		3 P + N + ⊕	0555 58	10	0576 23	5/50	0573 59	5/50	0575 19	10	0574 39	10
	32 A	3 P + ⊕	0555 77	10	0576 18	5/25	0580 58	5/50	0582 18	10	0581 38	10
		3 P + N + ⊕	0555 78	10	0576 24	5/25	0580 59	5/25	0582 19	10	0581 39	10

✦ - With isometric threaded cable entries : 16 A = M 20, 32 A = M 25, 63 A = M 32.
 * In IEC 38, the network voltage value of 230/400 V AC has been standardised. This value should progressively supercede the values of 220/380 V AC and 240/415 V AC. Wherever there is a reference to 230 V or 400 V, they may be read as 220 V or 240 V and 380 V or 415 V respectively.

plugs & sockets - interlocked switched sockets

16 to 63 A

LV														
			Surface mounting		Surface mounting				Surface mounting without protection					
			Without protection 125 X 220 mm		With din rail 125 X 280 mm				Panel mounting 125 x 220 mm					
			IP 44		IP 55		IP 44		IP 66		IP 44		IP 55	
Cat nos.	Pack	Cat nos.	Pack	Cat nos.	Pack	Cat nos.	Pack	Cat nos.	Pack	Cat nos.	Pack			
200 to 250 V ~ 50 Hz	16 A / 20 A	2 P + ⊕	0566 01	1	0566 21	1	0566 41	1	0566 61	1	0572 01	1	0572 21	1
	32 A	2 P + ⊕	0566 09	1	0566 29	1	0566 49	1	0566 69	1	0572 09	1	0572 29	1
380 to 415 V ~ 50 Hz	32 A	3 P + ⊕	0566 13	1	0566 33	1	0566 53	1	0566 73	1	0572 13	1	0572 33	1
		3 P + N + ⊕	0566 14	1	0566 34	1	0566 54	1	0566 74	1	0572 14	1	0572 34	1
380 to 415 V ~ 50/60 Hz	63 A	3 P + ⊕			0572 98		1				0589 18		1	
					0572 98		1				0589 18		1	
		3 P + N + ⊕			0589 10		1				0572 99		1	
					0589 10		1				0572 99		1	

Bold catalogue numbers are products normally available with Legrand (India) stockists.

Cat. nos. that are not bold - delivery within 4 weeks from the date of order.

Bold packing quantity is our mandatory packing. Orders to be placed by Legrand (India) stockists in multiples of the same.





plugs & sockets - P17 Tempra

16 to 125 A

<ul style="list-style-type: none"> • Conforming to IEC 60309-1/60309-2 • Material : Plastic • Self-extinguishing : 850°C • IK 09 according to IEC 62262 										
			Surface mounting sockets \diamond		Panel mounting sockets - inclined		Mobile sockets		Straight Plugs	
			IP 67		IP 67		IP 67		IP 67	
			LV	Cat nos.	Pack	Cat nos.	Pack	Cat nos.	Pack	Cat nos.
200 to 250 V \sim^* 50/60 Hz	16 A / 20 A	2 P + \perp	0553 03	-	0576 51	5/50	-	-	0563 03	5/20
	32 A	2 P + \perp	0553 23	-	0576 52	5/25	-	-	0563 23	5/20
380 to 415 V \sim^* 50/60 Hz	32 A	3 P + \perp	0553 07	-	0576 58	5/25	-	-	0563 27	5/20
		3 P + N + \perp	-	-	0576 64	5/25	-	-	0563 28	5/20
	63 A	3 P + N + \perp	0587 45	2	0587 25	2	0587 15	2	0587 05	2
	125 A	3 P + N + \perp	0591 07	1	0591 17	1	0591 37	1	0591 27	1
\diamond - With isometric threaded cable entries : 16 A = M 20, 32 A = M 25, 63 A = M 32.										

plugs & sockets - Hypra

16 to 125 A

<ul style="list-style-type: none"> • Conforming to IEC 60309-1/60309-2 • Material : Plastic • IK 09 according to IEC 62262 										
			Prisinter panel mounting sockets		Panel mounting sockets		Mobile sockets		Straight plugs	
			IP 44		IP 44		IP 44		IP 44	
			LV	Cat nos.	Pack	Cat nos.	Pack	Cat nos.	Pack	Cat nos.
200 to 250 V \sim^* 50/60 Hz	16 A / 20 A	2 P + \perp	0520 02	1/10	-	-	-	-	0520 42	-
	32 A	2 P + \perp	0527 02	1/6	-	-	-	-	0527 42	-
380 to 415 V \sim^* 50/60 Hz	16 A / 20 A	3 P + \perp	-	-	0522 23	5/50	0522 83	5/50	0522 43	5/50
		3 P + \perp	0529 03	1/6	-	-	-	-	0529 43	-
	32 A	3 P + N + \perp	0529 04	1/6	-	-	-	-	0529 44	5/15
		3 P + \perp	-	-	0538 23	1	-	-	0538 43	1/5
	63 A	3 P + N + \perp	0536 04	1	-	-	-	-	0538 44	1/5
	125 A	3 P + N + \perp	-	-	-	-	-	-	-	-

* In IEC 38, the network voltage value of 230/400 V AC has been standardised. This value should progressively supercede the values of 220/380 V AC and 240/415 V AC. Wherever there is a reference to 230 V or 400 V, they may be read as 220 V or 240 V and 380 V or 415 V respectively.

P17 Tempra combined units - LV 16 to 63 A

to be composed

- IK 08 according to IEC 62262
- Self-extinguishing: 650 °C
- Max. IP 66

Technical characteristics (p. 357)

Example of combined unit configuration

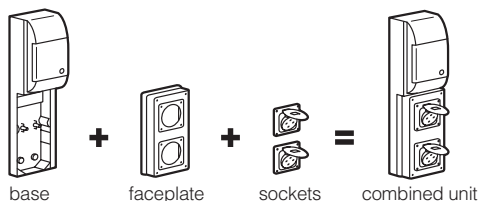

COMBINED UNITS HEIGHT 220 MM TO 441 MM

BASES FOR 220 x 125 MM FACEPLATES

Surface mounting box	Base up to 2 sockets 16 A	Base up to 3 sockets 16 A	Base up to 6 sockets 16 A
220 x 125 mm ⁽⁴⁾	371 x 125 mm ⁽⁴⁾ Rail 5 Lexic modules	441 x 265 mm ⁽⁴⁾ Rail 12 Lexic modules	441 x 405 mm ⁽⁴⁾ Rail 18 Lexic modules
Pack : Cat.No	Pack : Cat.No	Pack : Cat.No	Pack : Cat.No
2 : 0577 10	1 : 0589 38	1 : 0577 05	1 : 0577 06

220 X 125 MM FACEPLATES

1 for socket 16 or 32 A	2 for sockets 16 A	1 for socket 63 A	Plain plate
Pack : Cat.No	Pack : Cat.No	Pack : Cat.No	Pack : Cat.No
5 : 0577 12	5 : 0577 13 ⁽¹⁾	2 : 0577 17	5 : 0577 15

COMBINED UNITS HEIGHT 280 MM TO 501 MM

BASES FOR 280 x 125 MM FACEPLATES

Surface mounting box	Base up to 3 sockets 16 A	Base up to 6 sockets 16 A	Base up to 9 sockets 16 A
280 x 125 mm ⁽⁴⁾	421 x 125 mm ⁽⁴⁾ Rail 5 Lexic modules	501 x 265 mm ⁽⁴⁾ Rail 12 Lexic modules	501 x 405 mm ⁽⁴⁾ Rail 18 Lexic modules
Pack : Cat.No	Pack : Cat.No	Pack : Cat.No	Pack : Cat.No
3 : 0577 11	1 : 0577 20	1 : 0577 03	1 : 0577 04

280 x 125 MM FACEPLATE

2 sockets 16 or 32 A	1 socket 16 or 32 A and 1 socket 63 A	3 for socket 16 A ⁽³⁾	Plain plate
Pack : Cat.No	Pack : Cat.No	Pack : Cat.No	Pack : Cat.No
4 : 0577 18 ⁽¹⁾	2 : 0577 19 ⁽¹⁾	4 : 0577 14 ⁽¹⁾	4 : 0577 16

(1) Supplied with blanking plate (2) To be fixed horizontally except 16 A domestic pin sockets, vertically (IP 44 - connected)
 (3) IP 54 cover closed - IP 44 connected (4) External dimensions: H x W

Bold catalogue numbers are products normally available with Legrand (India) stockists.

Cat. nos. that are not bold - delivery within 4 weeks from the date of order.

Bold packing quantity is our mandatory packing. Orders to be placed by Legrand (India) stockists in multiples of the same.

EXAMPLE OF SOCKETS

schuko socket (p. 350)			IP 54	
250 V	16 A	2P+⏚	0576 72	
LV (p. 348)			IP 44	IP 67
200/250 V~	16 A	2P+⏚	0576 11	0576 51
	32 A	2P+⏚	0576 12	0576 52
380/415 V~	16 A	3P+⏚	0576 17	0576 57
		3P+N+⏚	0576 23	0576 63
	32 A	3P+⏚	0576 18	0576 58
		3P+N+⏚	0576 24	0576 64

Possible combinations with bases for 220 x 125 mm faceplates

Cat.No	Nb of sockets	Intensity			Number of faceplates		
		16 A	16 A or 32 A	63 A	0577 12	0577 13	0577 17
With box or base							
0577 10 or 0589 38	1 socket	-	1	-	1	-	-
	2 sockets	-	-	1	-	-	1
0577 05	2 sockets	-	-	-	-	1	-
		-	2	-	2	-	-
	3 sockets	-	1	1	1	-	1
		-	-	2	-	-	2
	4 sockets	3	-	-	1	1	-
		2	1	-	1	1	-
0577 06	3 sockets	2	-	1	-	1	1
		2	-	-	-	2	-
		-	3	-	3	-	-
	4 sockets	-	-	3	-	-	3
		-	1	2	1	-	2
		-	2	1	2	-	1
5 sockets	2	1	1	1	1	1	
	2	2	-	2	1	-	
	2	-	2	-	1	2	
6 sockets	4	1	-	1	2	-	
	4	-	1	-	2	1	
6	-	-	-	-	3	-	

EXAMPLE OF SOCKETS

Schuko Socket (p. 350)			IP 54	
250 V	16 A	2P+⏚	0576 72	
LV (p. 348)			IP 44	IP 67
200/250 V~	16 A	2P+⏚	0576 11	0576 51
	32 A	2P+⏚	0576 12	0576 52
380/415 V~	16 A	3P+⏚	0576 17	0576 57
		3P+N+⏚	0576 23	0576 63
	32 A	3P+⏚	0576 18	0576 58
		3P+N+⏚	0576 24	0576 64

Possible combinations with bases for 280 x 125 mm faceplates

Cat.No	Nb of sockets	Intensity			Number of faceplates		
		16 A	16 A or 32 A	63 A	0577 18	0577 19	0577 14
With box or base							
0577 11 or 0577 20	2 sockets	-	2	-	1	-	-
	3 sockets	-	1	1	-	1	-
0577 03	4 sockets	3	-	-	-	-	1
		-	4	-	2	-	-
	5 sockets	-	2	2	-	2	-
		-	3	1	1	1	-
	6 sockets	3	1	1	-	1	1
		3	2	-	1	-	1
0577 04	6 sockets	6	-	-	-	-	2
		-	6	-	3	-	-
		-	3	3	-	3	-
	7 sockets	-	5	1	2	1	-
		-	4	2	1	2	-
		3	2	2	-	2	1
	8 sockets	3	4	-	2	-	1
		3	3	1	1	1	1
		6	1	1	-	1	2
9 sockets	6	2	-	1	-	2	
	9	-	-	-	-	3	

Bold catalogue numbers are products normally available with Legrand (India) stockists.

Cat. nos. that are not bold - delivery within 4 weeks from the date of order.

Bold packing quantity is our mandatory packing. Orders to be placed by Legrand (India) stockists in multiples of the same.

P 17 Tempra IP 44 - LV 16 and 32 A

sockets, plugs and mobile sockets



0555 53



0573 54



0574 34



0575 14

Technical characteristics (p. 353-354)

Terminal connection:

- Panel and surface mounting sockets

16 A: max. 1 x 4 mm² rigid

32 A: max. 1 x 10 mm² rigid

- Plugs & mobile sockets:

16 A: max. 1 x 2.5 mm² flexible

32 A: max. 1 x 6 mm² flexible

IP 44 according to IEC 60529 and EN 60529

IK 09 according to IEC 62262 and EN 62262

Material: plastic

Self-extinguishing: 850 °C (support of active parts)/650 °C (plastic housing)

- 25 °C to + 40 °C according to IEC 60309-1

Pack	Cat.Nos		Surface mounting sockets
10	16 A 0555 53	32 A 0555 73	200/250 V~ 2 P + ⊥
10	0555 57	0555 77	380/415 V~ 3 P + ⊥
10	0555 58	0555 78	3 P + N + ⊥

Pack	Cat.Nos		Straight plugs
10	16 A 0574 34	32 A 0581 34	200/250 V~ 2 P + ⊥
10	0574 38	0581 38	380/415 V~ 3 P + ⊥
10	0574 39	0581 39	3 P + N + ⊥

Pack	Cat.Nos		Panel mounting sockets inclined outlet
10	16 A 0576 11	32 A 0576 12	200/250 V~ 2 P + ⊥
10	0576 17	0576 18	380/415 V~ 3 P + ⊥
10	0576 23	0576 24	3 P + N + ⊥

Pack	Cat.Nos		Mobile sockets
10	16 A 0575 14	32 A 0582 14	200/250 V~ 2 P + ⊥
10	0575 18	0582 18	380/415 V~ 3 P + ⊥
10	0575 19	0582 19	3 P + N + ⊥

Pack	Cat.Nos		Panel mounting sockets straight outlet small flange
5	16 A 0573 54	32 A 0580 54	Cannot be fixed on pre-drilled faceplates 200/250 V~ 2 P + ⊥
5	0573 58	0580 58	380/415 V~ 3 P + ⊥
5	0573 59	0580 59	3 P + N + ⊥

P 17 Tempra IP 66/67 - LV 16 and 32 A sockets, plugs and mobile sockets



0553 07

Technical characteristics (p. 355)

Terminal connection:

- Panel and surface mounting sockets

16 A: max. 1 x 4 mm² rigid

32 A: max. 1 x 10 mm² rigid

- Plugs & mobile sockets:

16 A: max. 1 x 2,5 mm² flexible

32 A: max. 1 x 6 mm² flexible

IP 66/67 according to IEC 60529 and EN 60529

IK 09 according to IEC 62262 and EN 62262

Material: plastic

Self-extinguishing: 850 °C (support of active parts)/650 °C (plastic housing)

Temp. rating: - 25 °C to + 40 °C

Conform to IEC 60309-1 and IEC 60309-2

Pack	Cat.Nos		Surface mounting sockets
5	16 A	32 A	200/250 V~
	0553 03	0553 23	380/415 V~
5	0553 07	0553 27	3 P + ⊕
5	0553 08	0553 28	3 P + N + ⊕

Pack	Cat.Nos		Panel mounting sockets
5	0576 51	0576 52	200/250 V~
	0576 57	0576 58	380/415 V~
5	0576 63	0576 64	3 P + ⊕
5	0576 63	0576 64	3 P + N + ⊕

Pack	Cat.Nos		Straight plugs
5	0563 03	0563 23	200/250 V~
	0563 07	0563 27	380/415 V~
5	0563 08	0563 28	3 P + ⊕
5	0563 08	0563 28	3 P + N + ⊕

Pack	Cat.Nos		Mobile sockets
5	0562 03	0562 23	200/250 V~
	0562 07	0562 27	380/415 V~
5	0562 08	0562 28	3 P + ⊕
5	0562 08	0562 28	3 P + N + ⊕

P 17 Tempra IP 66/67 - LV 63 and 125 A sockets, plugs and mobile sockets



0587 05



0587 14

Technical characteristics (p. 354)

Terminal connection:

- Panel and surface mounting sockets

63 A: max. 1 x 25 mm² rigid

125 A: max. 1 x 70 mm² rigid

- Plugs & mobile sockets:

63 A: max. 1 x 16 mm² flexible.

125 A: max. 1 x 50 mm² flexible

IP 66/67 according to IEC 60529 and EN 60529

IK 09 according to IEC 62262 and EN 62262

Material: plastic

Self-extinguishing: 850 °C (support of active parts)/650 °C (plastic housing)

Temp. rating: - 25 °C to + 40 °C

Conform to IEC 60309-1 and IEC 60309-2

Pack	Cat.Nos		Surface mounting sockets
2	63 A	125 A	200/250 V~
	0587 40		380/415 V~
2/1	0587 44	0591 06	3 P + ⊕
2/1	0587 45	0591 07	3 P + N + ⊕

Pack	Cat.Nos		Panel mounting sockets
2	0587 20		200/250 V~
	0587 24	0591 16	380/415 V~
2/1	0587 24	0591 16	3 P + ⊕
2/1	0587 25	0591 17	3 P + N + ⊕

Pack	Cat.Nos		Straight plugs
2	0587 00		200/250 V~
	0587 04	0591 26	380/415 V~
2/1	0587 04	0591 26	3 P + ⊕
2/1	0587 05	0591 27	3 P + N + ⊕

Pack	Cat.Nos		Mobile sockets
2	0587 10		200/250 V~
	0587 14	0591 36	380/415 V~
2/1	0587 14	0591 36	3 P + v
2/1	0587 15	0591 37	3 P + N + ⊕

Bold catalogue numbers are products normally available with Legrand (India) stockists.

Cat. nos. that are not bold - delivery within 4 weeks from the date of order.

Bold packing quantity is our mandatory packing. Orders to be placed by Legrand (India) stockists in multiples of the same.

NEW

P 17 Tempra IP 44 - LV 16A

schuko sockets



0576 71



0576 69

Technical characteristics (p. 355)

Schuko std. sockets
 IK 09 according to IEC/EN 62262
 IP 44 connected
 IP 54 cover closed
 Material: plastic
 Self-extinguishing: 850 °C (support of active parts) / 650-°C (plastic housing)
 Temp. rating: - 50 °C to + 80 °C

Pack	Cat.Nos	Panel mounting sockets
20	Schuko standard 16 A 0576 72	Can be fixed on faceplate 200/250 V~ 2 P + ±

Pack	Cat.Nos	Panel mounting sockets with small flange
20	0576 70	Cannot be fixed on pre-drilled faceplate 200/250 V~ 2 P + ± (colour: blue)
20	0576 69	2 P + ± (colour: white)

P17 IP44, 54, 66/67 - LV 16-125A

Combined Unit - Interlock Switch Sockets & refrigerated container use



6571 06

- Conforming to IEC 60695-1/60695-2
- Material - Plastic
- IK 08 as per IEC 62262
- Selfextinguishing : 750 C
- IEC/EN 62262 (refrigerated container use)

Pack	Cat. nos.		
	16 A	32 A	
1	0566 01	0566 09	IP44 Interlock Switch Sockets with surface mounting box 250 V, 2P+E
1	-	0566 13	415 V, 3P+E
1		0566 14	415 V, 3P+N+E
1	0566 21	0566 29	IP55 Interlock Switch Sockets with surface mounting box 250 V, 2P+E
1		0566 33	415 V, 3P+E
1		0566 34	415 V, 3P+N+E
1	0566 41	0566 49	IP44 Interlock Switch Sockets with surface mounting box and din rail for 5 module Lexic protection 250 V, 2P+E
		0566 53	415 V, 3P+E
		0566 54	415 V, 3P+N+E
1	0566 61	0566 69	IP66 Interlock Switch Sockets with surface mounting box and din rail for 5 module Lexic protection 250 V, 2P+E
1		0566 73	415 V, 3P+E
1		0566 74	415 V, 3P+N+E

Pack	Cat. nos.		
	63 A		
1	0572 98		IP66 Interlock Switch Sockets with surface mounting box 415 V, 3P+E
1	0589 10		415 V, 3P+N+E
1	0589 18		IP66 Interlock Switch Sockets with surface mounting box and din rail for 5 module Lexic protection 415 V, 3P+E
1	0572 99		415 V, 3P+N+E

Pack	Cat. nos.		Combined units for refrigerated containers
			IP 66/67 plastic P 17 Tempra
			32 A - 440 V~ - 50/60 Hz - 3 P + ± - 3 hours IK 09 Plastic body and cover Stainless steel screws Combined unit with interlocked switched socket Double mechanical interlock Cable glands are not supplied Straight plug With cable grip Ø 12 to 21.5 mm
1	6571 06		Mobile socket With cable grip Ø 12 to 21.5 mm
1	6571 26		
1	6571 46		



Safe and simple, Ideal for industry



■ Technical data

- The IEC 60309-1 ensures the protection of personnel at electrical installations.
- The IEC 60309-2 ensures interchangeability of dimensions and harmonisation of pin configurations.

Each polarity has a clockwise index. Thus, these plastic plugs and sockets are suitable for any plugs and sockets that conform to the standard IEC 60309-2.

■ Socket voltage identification (front view of socket)

LV : indicated by the position of the earth pin socket in relation to the groove on the base

240 V~ - 50-60 Hz - Blue

200 to 250V 200 to 250V 120/208 to 144/250V

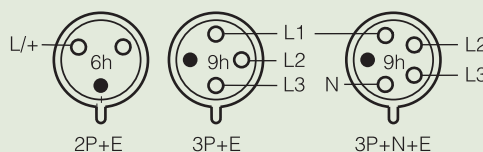

- Earth contact

415 V~ - 50-60 Hz - Red

380 to 415V 380 to 415V 200/340 to 240/415V

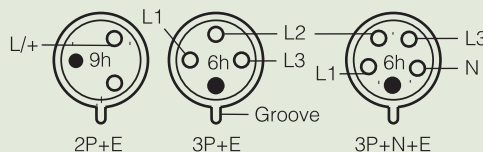

- Earth contact

LV : indicated by the position of the earth pin socket in relation to the groove on the base

Legrand plugs and sockets conform to the universal standard IEC 60309 - 2. Therefore, these plugs and sockets are compatible with any plug and socket conforming to the same standard, whether in Austria or Australia.

The terminal connection capacities for rigid cables are :

LV 16 A	1 to 4 mm ²
LV 32 A	2.5 to 10 mm ²
LV 63 A	6 to 25 mm ²
LV 125 A	25 to 70 mm ²

- Rated voltages - 240 V~ and 415 V~
- Protection categories - IP 44 and IP 67
- Colour coding for voltage identification
Blue Colour for 240 V~
Red Colour for 415 V~
- Material of plugs and sockets special high grade plastic. Shock proof at low and high temperatures.

typical application

■ Technical data

The choice of the right type of industrial plugs and sockets must take into account the following:

- Whether the equipment is mobile or stationary
- The current rating and voltage
- The required degree of IP protection

Socket outlets: "Panel mounting sockets" are fixed directly on the panel door, while "surface mounting sockets" are fixed on a wall. "Switched sockets" include a built-in switch.

Mobile sockets: are installed at the end of the cable.

Plugs: are installed at the end of the cable and form part of the electrical portable or mobile equipment. When connected with a mobile socket, they make an extension lead, thus activating a distant outlet.

Appliance inlets: installed on machines and other mobile electrical equipment, to receive current necessary for operation through their mobile socket.

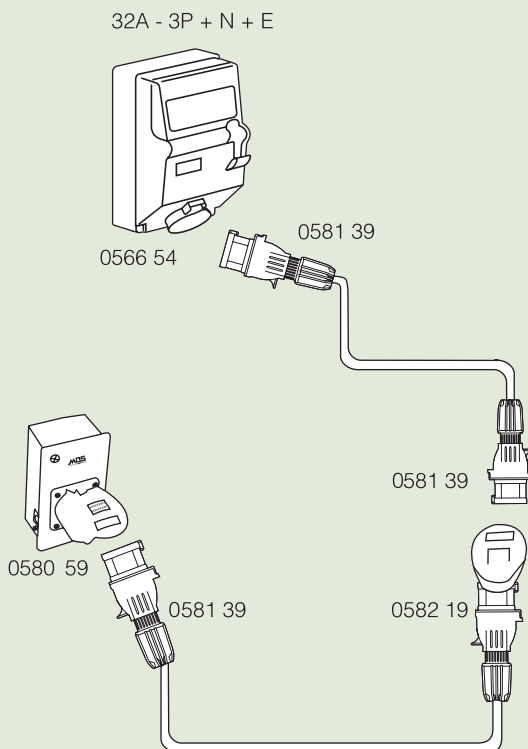

■ Hypra Prisinter socket



Safe to close
the power is connected only when the plug is locked



Safe to open
the plug cannot be unlocked until the power has been disconnected

Simple to use

Switched ON by simply rotating the plug

Safety of personnel

Earth continuity maintained even when the plug is not in use

Operating safety

Colour coding and 309-2 pin configuration prevent incorrect plugging

Switch performance

Increased safety

Breaking capacity:

	16A	32A	63A
AC ₁	16A	32A	63A
AC ₂₃	8.4kw	16.8 kw	33 kw
AC ₃	8.4kw	16.8 kw	33 kw

■ Hypra plug



Weatherproof seal
cable gland held in position

Stainless steel external screws

Tensile force safety
2 half-clamps provide uniform grip for protection against accidental disconnection

Note : AC₁ = Non inductive or slightly inductive load e.g., resistance furnace
AC₃ = Inductive load e.g., squirrel cage motor, switching OFF motors while running

P17 Tempra plastic

■ Dimensions

IP 44 - LV 16/32 A

Surface mounting sockets - 230 V~ to 380/415 V~

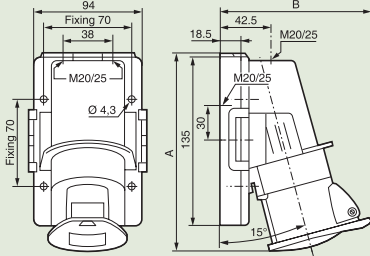

	LV 16A			LV 32A		
	2P+⊥	3P+⊥	3P+N+⊥	2P+⊥	3P+⊥	3P+N+⊥
A	158	158	171	181	181	192
B	121	123	130	135	135	140
Cat no	0555 53	0555 57	0555 58	0555 73	0555 77	0555 78

Panel mounting sockets (Inclined outlet)

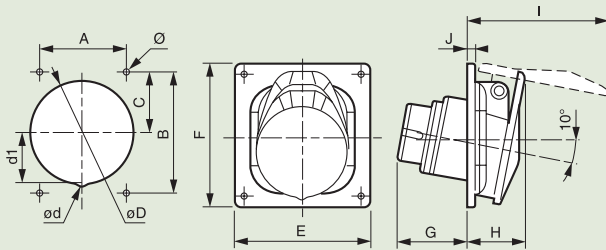

	Cat. no	Weight (kg)	A	B	C	ØD	Ød	d1	E	F	G	H	I	J	Ø
LV 16A															
2P+⊥	0576 11	0.110	70	70	35	76.2	-	-	84	84	42	33	83.5	4.5	4.2
3P+⊥	0576 17	0.140	70	70	35	76.2	-	-	84	84	43	34.5	91.3	4.5	4.2
3P+N+⊥	0576 23	0.165	70	70	35	76.2	-	-	84	84	43	36.5	100	4.5	4.2
LV 32A															
2P+⊥	0576 12	0.220	70	70	35	76.2	-	-	84	94	54	44	112	4.5	4.2
3P+⊥	0576 18	0.208	70	70	35	76.2	-	-	84	94	54	44	115	4.5	4.2
3P+N+⊥	0576 24	0.255	70	70	35	76.2	8	36	84	94	54	45	120	4.5	4.2

Straight panel mounting socket (small flange)

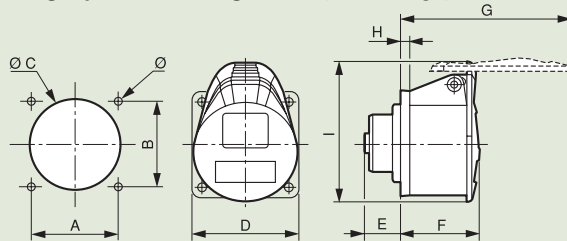

	Cat. no	Weight (kg)	A	B	ØC	D	E	F	G	H	I	Ø
LV 16A												
2P+⊥	0573 54	0.105	47	47	47	58	22.4	50	98.5	5.5	78.5	5.5
3P+⊥	0573 58	0.127	52	52	55	65	22.4	50.5	104	5.5	85.6	5.5
3P+N+⊥	0573 59	0.148	52	52	55	70	22.4	51	113	5.5	93.5	5.5
LV 32A												
2P+⊥	0580 54	0.197	60	60	57.1	75	31.4	61.3	127	5.5	97.5	5.5
3P+⊥	0580 58	0.197	60	60	57.1	75	31.4	61.3	127	5.5	97.5	5.5
3P+N+⊥	0580 59	0.246	60	60	63.5	77	31.4	61.7	134	5.5	104.5	5.5

Mobile sockets

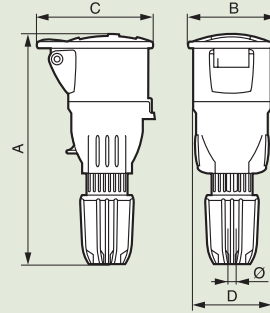

	Cat no	A	B	C	D	Ø
LV 16A						
2P+⊥	0575 14	153 to 169	55	78	56	8 to 14
3P+⊥	0575 18	153 to 169	62	85	56	8 to 14
3P+N+⊥	0575 19	164 to 180	70	94	65	10 to 18
LV 32A						
2P+⊥	0582 14	174 to 190	71	98	65	10 to 18
3P+⊥	0582 18	174 to 190	71	98	65	12 to 20
3P+N+⊥	058219	177 to 191	77	101	72	14 to 21

Straight plugs

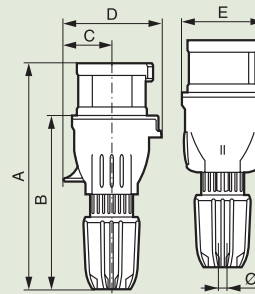

	Cat no	A	B	C	D	E	Ø
LV 16A							
2P+⊥	0574 34	143 to 159	106 to 122	30	65	56	8 to 14
3P+⊥	0574 38	143 to 159	106 to 122	34	69	56	8 to 14
3P+N+⊥	0574 39	152 to 168	115 to 131	38	78	65	10 to 18
LV 32A							
2P+⊥	0581 34	161 to 177	115 to 131	39	79	65	10 to 18
3P+⊥	0581 38	161 to 177	115 to 131	39	79	65	12 to 20
3P+N+⊥	0581 39	167 to 181	121 to 135	45	88	72	14 to 21

IP 67 - LV 16 A

Panel mounting sockets (inclined outlet)

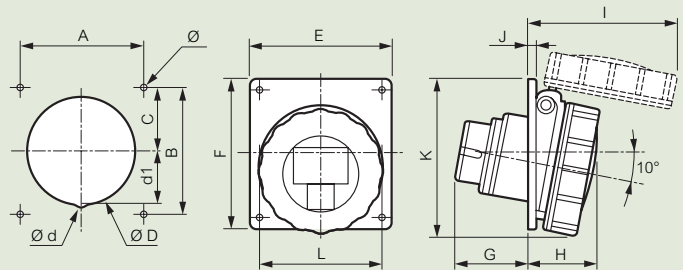

	Cat. no	Weight (kg)	A	B	C	ØD	Ød	d1	E	F	G	H	I	J	K	L	Ø
LV 16A																	
2P+⊥	0576 51	0.140	70	70	35	76.2	-	-	84	84	42	39	83	4.5	90	72.5	4.2

P17 Tempra plastic

■ Dimensions

IP 67 – LV 32 A

Panel mounting sockets (inclined outlet)

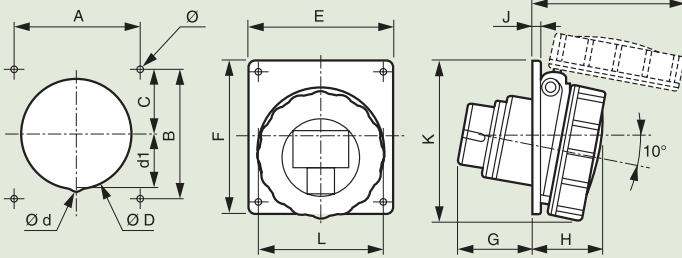

	Cat. no	Weight (kg)	A	B	C	ØD	Ød	d1	E	F	G	H	I	J	K	L	Ø
LV 32 A																	
2P+±	0576 52	0.240	70	70	35	76.2	-	-	84	94	54	50	113	4.5	101	94.5	4.2
3P+±	0576 58	0.240	70	70	35	76.2	-	-	84	94	54	50	113	4.5	101	94.5	4.2
3P+N+±	0576 64	0.270	70	70	35	76.2	8	36	84	94	54	51	120	4.5	103	101	4.2

Straight plugs with membrane gland

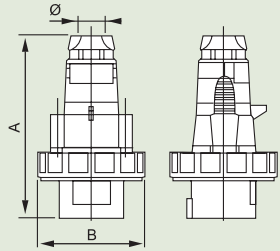

	Cat. no	Weight (kg)	A	B	Ø
LV 16A					
2P+±	0563 03	0.165	122	72.5	8 to 14
LV 32A					
2P+±	0563 23	0.255	152	94.5	10 to 17.5
3P+±	0563 27	0.276	152	94.5	12 to 21.5
3P+N+±	0563 28	0.325	158	101	12 to 21.5

IP 67 – LV 63 A

Surface mounting sockets

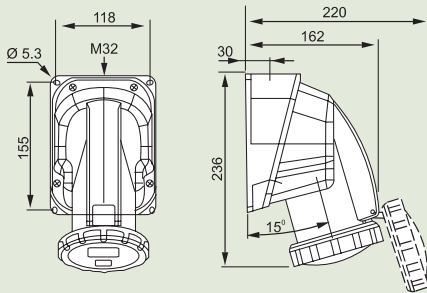

	Cat. no	Weight (kg)
LV 63A		
3P+N+±	0587 45	0.95

Panel mounting sockets (inclined outlet)

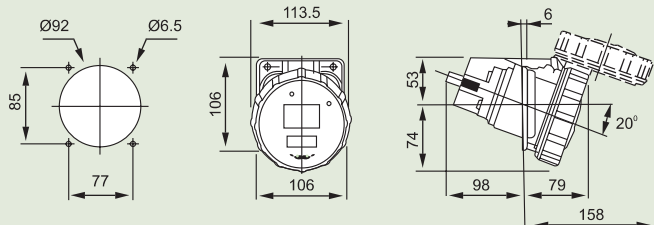

	Cat. no	Weight (kg)
LV 63A		
3P+N+±	0587 25	0.77

Mobile sockets with cable gland

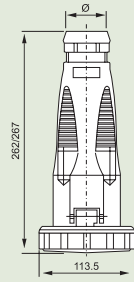

	Cat. no	Weight (kg)	Ø
LV 63A			
3P+N+±	0587 15	0.85	21.3 to 31.3

Straight plugs with cable gland

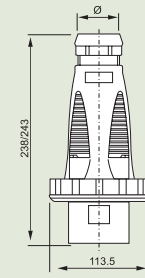

	Cat. no	Weight (kg)	Ø
LV 63A			
3P+±	0587 04	0.57	19.3 to 28.5
3P+N+±	0587 05	0.64	21.3 to 31.3

IP 67 – LV 125 A

Surface mounting sockets

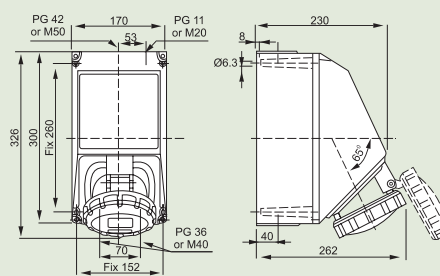

	Cat. no	Weight (Kg)
3P+N+±	0591 07	2.73

Panel mounting sockets (inclined outlet)

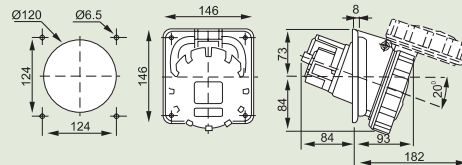

	Cat. no	Weight (Kg)
3P+N+±	0591 17	1.2

Mobile Sockets

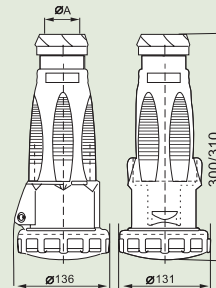

	Cat. no	Weight (Kg)	Ø A
3P+N+±	0591 37	1.53	28.5 to 50

Straight plugs

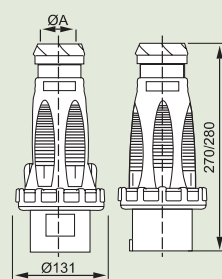

	Cat. no	Weight (Kg)	Ø A
3P+N+±	0591 27	1.22	28.5 to 50

P17 Tempra IP 66/67 - LV 32A

refrigerated container use

■ IP 66/67 plastic P 17 Tempra

Cat.No 6571 06

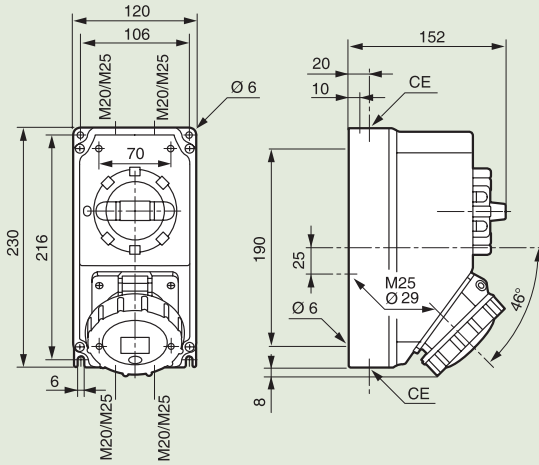

Straight plugs

Cat.No 6571 26

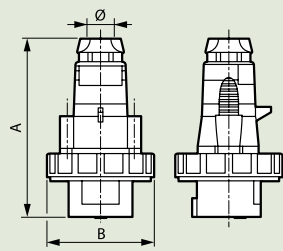

	Weight (kg)	A	B	Ø
LV 32 A				
3 P+±	0.276	152	94.5	12 to 21.5

Mobile sockets

Cat.No 6571 46

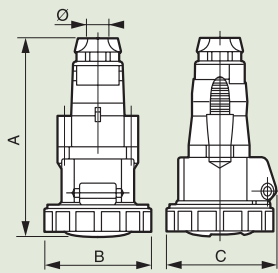

	Weight (kg)	A	B	C	Ø
LV 32 A					
3 P+±	0.320	171	94.5	103	12 to 21.5

■ Dimensions

Domestic pin configuration sockets

Cat.No 0576 69

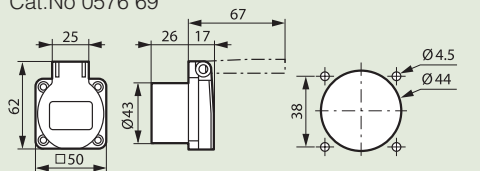

Weight: 0.046 Kg

Cat.No 0576 72

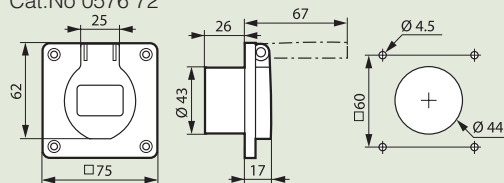

Weight: 0.052 Kg

P17 Tempra combined units

■ Dimensions

IP 44 according to IEC 60529 and EN 60529
 IP 66 according to IEC 60529 and EN 60529
 IP 55 according to IEC 60529 and EN 60529
 IK 08 according to EN 50102

Interlocked switch sockets with DIN rail

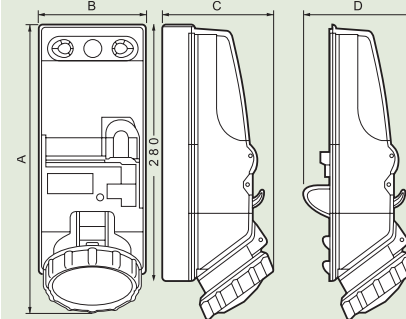

	IP 44 Cat. no	A	B	C	D	IP 66 Cat. no	A	B	C	D
LV 16A										
2P+±	0566 40/41	290	125	155	135	0566 60/61	300	125	155	135
LV 32A										
2P+±	0566 49	295	125	155	145	0566 69	310	125	155	145
3P+±	0572 53	295	125	155	145	0572 73	310	125	155	145
3P+N+±	0572 54	295	125	155	145	0572 74	310	125	155	144

Interlocked switch sockets without protection

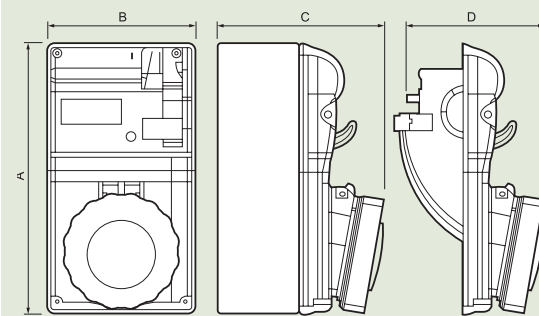

	IP 44 Cat. no	A	B	C	D	IP 55 Cat. no	A	B	C	D
LV 16A										
2P+±	0566 00/01 0572 00/01	220	125	127	122	0566 20/21 0572 20/21	220	125	133	128
3P+N+±	0572 06	220	125	130	125	0572 26	220	125	135	130
LV 32A										
2P+±	0566 09 0572 09	220	125	138	133	0566 29 0572 29	220	125	143	138
3P+±	0566 13 0572 13	220	125	138	133	0566 33 0572 33	220	125	143	138
3P+N+±	0566 14 0572 14	220	125	139	134	0566 34 0572 34	220	125	144	139

IP 66 - LV 63A

Without protection

Cat.Nos 0572 98 and 0589 10

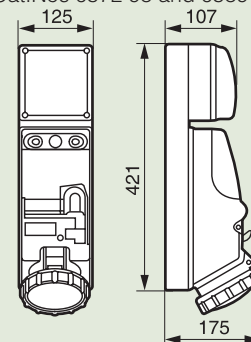

With empty Din rail -

Cat.Nos 0589 18 and 0572 99

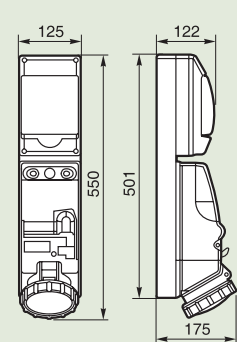

P 17 Tempra combined units
to be composed

■ **Dimensions**

Bases

Cat.No 0589 38

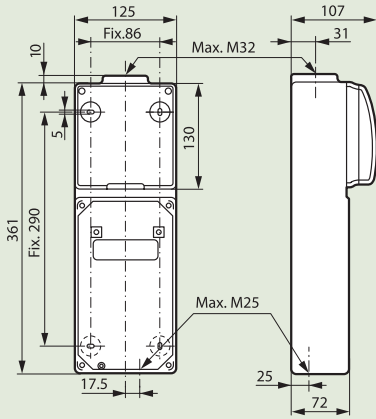

Cat.No 0577 20

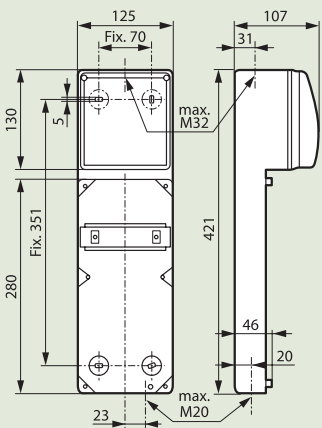

Cat.No 0577 05

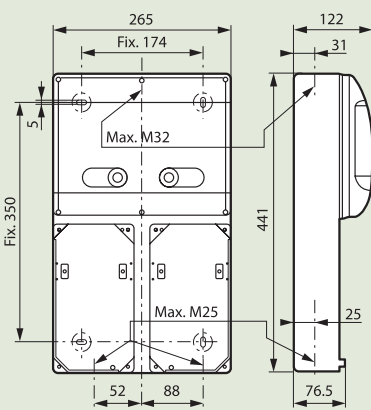

Cat.No 0577 06

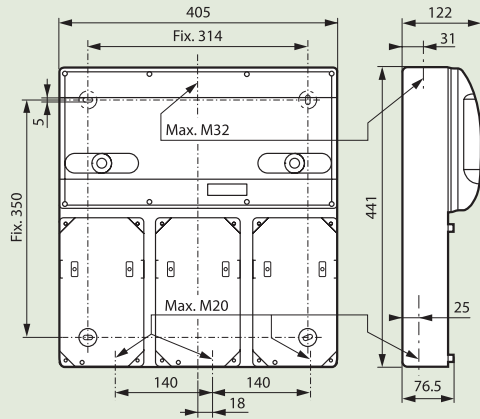

Cat.No 0577 03

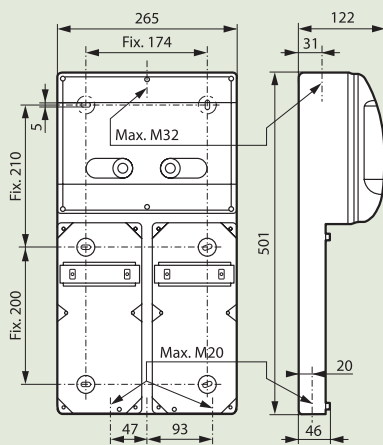

Cat.No 0577 04

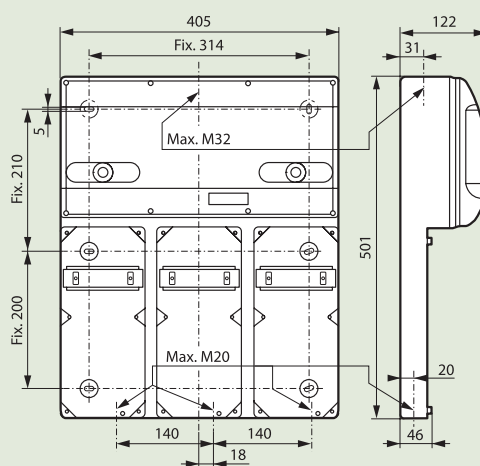

All dimensions are in mm
1 inch = 25.4mm
Accuracy of dimensions = ± 2mm

P 17 Tempra combined units to be composed

P17 Tempra Combined Units

closed... it's connected!

Surface mounting boxes

Cat.No 0577 10

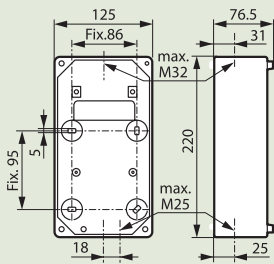

Cat.No 0577 11

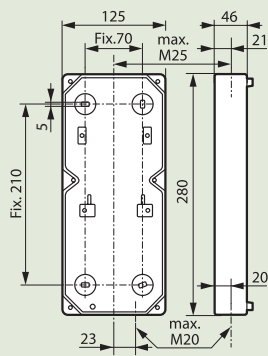

Faceplates

Cat.No 0577 12

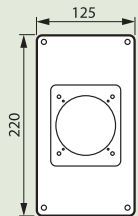

Cat.No 0577 13

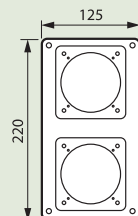

Cat.No 0577 17

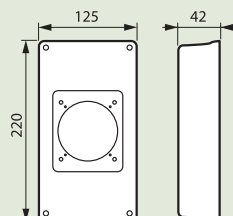

Cat.No 0577 18

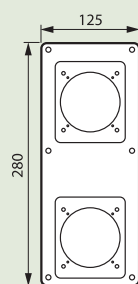

Cat.No 0577 19

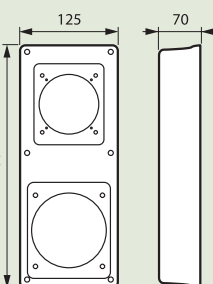

Cat.No 0577 14

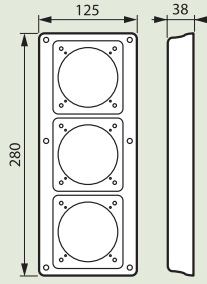

Cat.No 0577 15

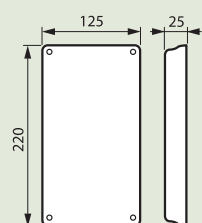

Cat.No 0577 16

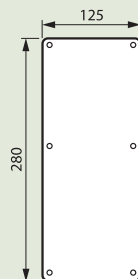

Fix the base onto the wall.

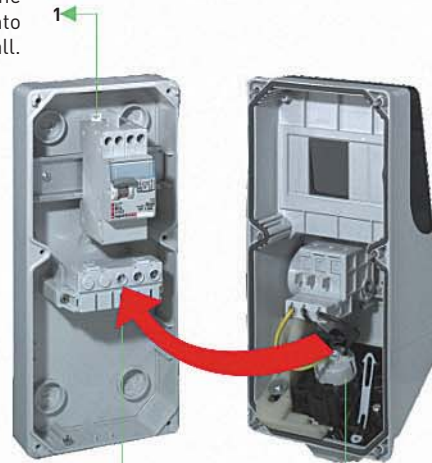

Automatic connection between the base and the faceplate with the Legrand plug-in system.

Interlocked socket wired on the faceplate independently of the base.



Transparent window
For quick viewing of protection devices.



Din rail
For full access to all Legrand Lexic modular functions upto 5 module.



Double interlock
Switch cannot be turned on unless a plug has been inserted (1st safety position). Plug cannot be removed when the switch is on (2nd safety position).

Bold cat. nos. are products normally available with Legrand (India) Stockists. **Cat nos. that are not bold** - delivery within 4 weeks from the date of order. **Bold packing quantity** is our mandatory packing. Orders to be placed by Legrand (India) Stockist in multiples of the same.

All dimensions are in mm
1 inch = 25.4mm
Accuracy of dimensions = ± 2mm

■ Dimensions

Prisinter - panel mounting sockets - LV 16-32-63 A

According to IEC/EN 605 29

- 16-32 A • IP 44 connected with an IP 44 plug
- IP 55 connected with an IP 66/67-55 Hypra plug
- IP 55 cover closed
- 63 A • IP 44 connected with any plug
- IP 55 cover closed

Dust resistance IP may be increased by rubber push-button (on request)

Icc 10 kA according to CEI 60309-1

IK according to IEC 62262: Plastic = IK 09

Padlockable

Screws in stainless steel - Nickel-plated contacts

In case of extension, use a mobile Prisinter available on request

Max terminal connection:

- 16 A: 1 x 4 mm² or 2 x 2.5 mm² rigid
- 32 A: 1 x 10 mm² or 2 x 6 mm² rigid
- 63 A: 1 x 25 mm² rigid

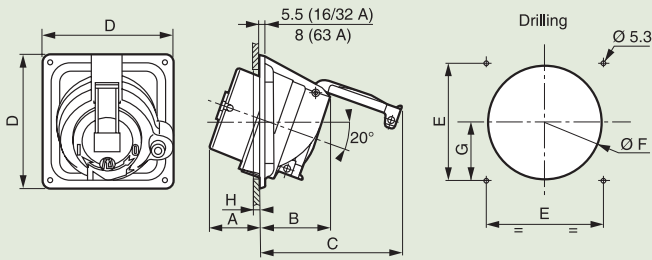

	Cat. no	Material	Weight (kg)	A	B	C	D	E	F min	F max	G	H max
16A												
2P+±	0520 02	Plastic	0.42	46	70	132	115	100	92	98	46	6 to 10
32A												
2P+±	0527 02	Plastic	0.57	54	77	153	143	125	115	122	58.5	10 to 20
3P+±	0529 03	Plastic	0.61	54	77	153	143	125	115	122	58.5	10 to 20
3P+N+±	0529 04	Plastic	0.65	55	79	169	143	125	119	122	58.5	9 to 13
63A												
3P+N+±	0536 04	Plastic	0.98	55	99	205	143	125	120	122	59.5	10 to 20

External screws in stainless steel - Nickel-plated contacts

Max terminal connection:

- ELV 16/32 A: 1 x 10 mm² flexible
- LV 16 A: 1 x 2.5 mm² flexible
- LV 32 A: 1 x 6 mm² flexible
- LV 63 A: 1 x 16 mm² flexible
- LV 125 A: 1 x 50 mm² flexible

■ Straight plugs IP 44

ELV and LV 16/32 A

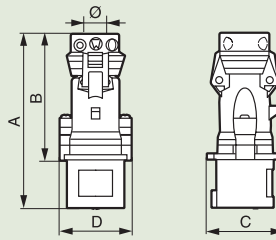

LV 63 A

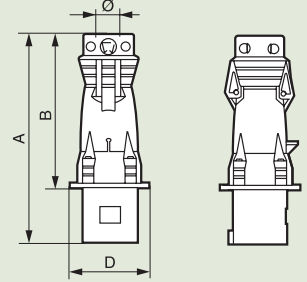

	Cat. no.	Material	Weight (kg)	Dimensions				Ø clamping and grip
				A	B	C	D	
LV - 16 A								
2 P + ±	0520 42	Plastic	0.150	135	100	57	55	8 to 15
3 P + ±	0522 43	Plastic	0.175	139	103	65	60	8 to 15
3 P + N + ±	0522 44	Plastic	0.210	154	118	73	66	10 to 18
LV - 32 A								
2 P + ±	0527 42	Plastic	0.260	164	119	78	70,5	10 to 18
3 P + ±	0529 43	Plastic	0.260	164	119	78	70,5	12 to 22
3 P + N + ±	0529 44	Plastic	0.300	170	125	86	77	12 to 22
LV - 63 A								
2 P + ±	0536 42	Plastic	0.580	255	188.5	-	102	16 to 26
3 P + ±	0538 43	Plastic	0.640	255	188.5	-	102	18.5 to 29
3 P + N + ±	0538 44	Plastic	0.700	255	188.5	-	102	20.5 to 32

IP 44 - ELV 16 and 32 A - LV 16 to 63 A

IK 09 (plastic), IK 10 (metal)

External screws in stainless steel - Nickel-plated contacts

Max terminal connection:

- ELV: 1 x 10 mm² rigid
- LV 16 A: 1 x 4 mm² rigid
- LV 32 A: 1 x 10 mm² rigid
- LV 63 A: 1 x 25 mm² rigid

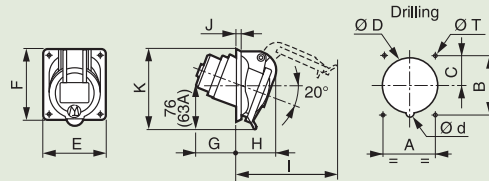

	Cat. no.	Material	Weight (kg)	Drilling			Dimensions									
				A	B	C	øD	ød	øT	E	F	G	H	I	J	K
LV - 16 A																
2 P + ±	0520 23	Plastic	0.110	52	60	28	55	14.5	4.2	64	72	41	40	94	5.5	78.5
3 P + ±	0522 23	Plastic	0.140	60	70	31	63.5	14.5	5.2	74	84	44	40	98	5.5	88
3 P + N + ±	0522 24	Plastic	0.165	60	70	33	70.6	-	5.2	80	84	44	44	110	5.5	93
LV - 63 A																
2 P + ±	0536 22	Plastic	0.600	77	85	-	92	-	6.5	106	106	98	70	160	6	129
3 P + ±	0538 23	Plastic	0.640	77	85	-	92	-	6.5	106	106	98	70	160	6	129
3 P + N + ±	0538 24	Plastic	0.700	77	85	-	92	-	6.5	106	106	98	70	160	6	129



The plug cannot be unlocked until the power has been disconnected

refer p.345



Plugs and Sockets enclosures

from 10 A to 63 A

IP 44 – LV 16 A

Mobile sockets

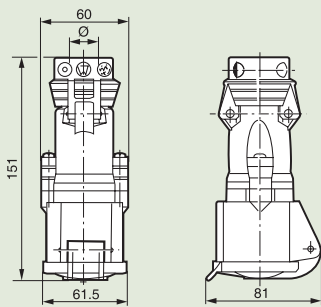

	Cat. no	Weight (kg)	Ø Clamping & grip
3P+⊥	0522 83	0.2	8 to 15

Notes :

- External screw in stainless steel
- Nickel plated contact

Lexic



Surface mounting
SPN enclosure



FP RCBO enclosure

Metra plug & socket selection chart

- Metal clad plugs and sockets with scrapping earth conforming to IS 8804
- Body made of cast aluminium alloy duly powder coated
- Plug sleeves and protection caps made of high grade plastic
- Colour coding : Blue for 250V \sim and Red for 440V \sim



			Colour	Plugs	Sockets
250 V \sim	10 A	2 P + \perp	Blue	6500 02 Pack - 1/10/100	6500 03 Pack - 1/10/100
			Ivory	6500 22 Pack - 1/10/100	6500 23 Pack - 1/10/100
	20 A	2 P + \perp	Blue	6500 08 Pack - 1/10/100	6500 09 Pack - 1/10/100
			Ivory	6500 28 Pack - 1/10/100	6500 29 Pack - 1/10/100
440 V \sim	20 A	3 P + \perp	Red	6500 10 Pack - 1/10/100	6500 11 Pack - 1/10/100
	32 A	3 P + \perp	Red	6500 16 Pack - 1/10/100	6500 17 Pack - 1/10/100

METRA METALLIC

Salient features of metra metallic plugs and sockets

> Metra metallic plug and socket

- Standards conform to IS 8804 and to BS 4343.
- The plugs are ivory coloured for superior aesthetics in domestic and commercial application. International voltage colour coding for industry: Blue - 250V and Red - 440V
- The plug sleeve is designed in such a way that it grips the cable and prevents load on the cable ends connected to terminals.
- The octagonal shape of plug top and socket cap provides better grip.
- While plugging, earth connection is made before phase connection. During disconnection, earth connection is broken after phase connection.
- The plastic base for the socket acts as a "Drilling Template" for accurate installation of the socket.



Bold catalogue numbers are products normally available with Legrand (India) stockists.
Cat. nos. that are not bold - delivery within 4 weeks from the date of order.

Bold packing quantity is our mandatory packing. Orders to be placed by Legrand (India) stockists in multiples of the same.

metra plugs and sockets

■ Dimensions

10A/20A 2P+E

Plug

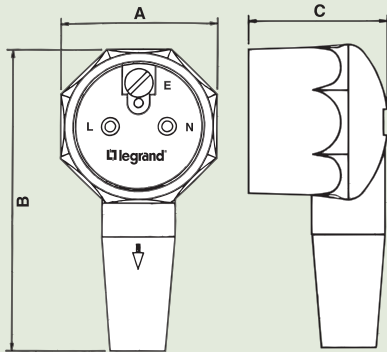

Socket

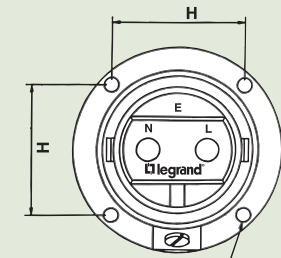

Ø'I', 4 Nos. HOLES
EQUISPACED ON PCD 'J'

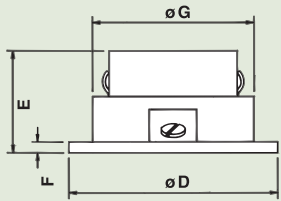

Drilling plan

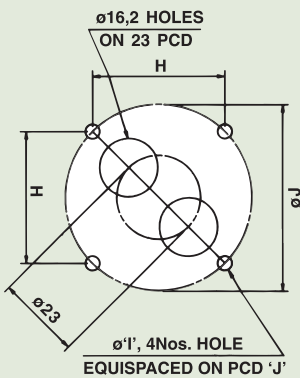

Plug	A	B	C
10 A - 2P+ $\frac{1}{2}$	43	83	38
20 A - 2P+ $\frac{1}{2}$	51	93	46
20 A - 3P+ $\frac{1}{2}$	57.3	103	47
32 A - 3P+ $\frac{1}{2}$	70.1	132.1	74.04

20A/32A 3P+E

Plug

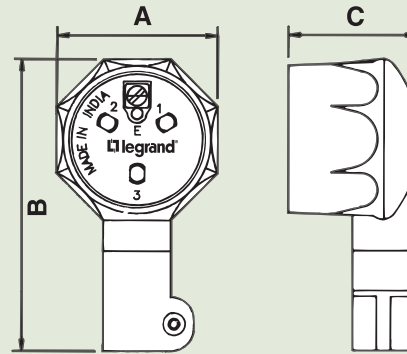

Socket

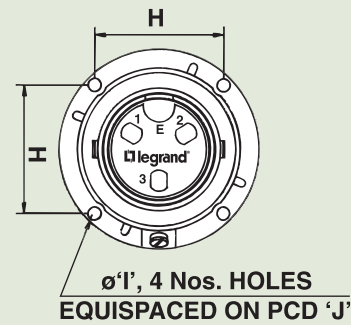

Ø'I', 4 Nos. HOLES
EQUISPACED ON PCD 'J'

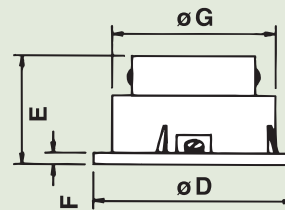

Drilling plan

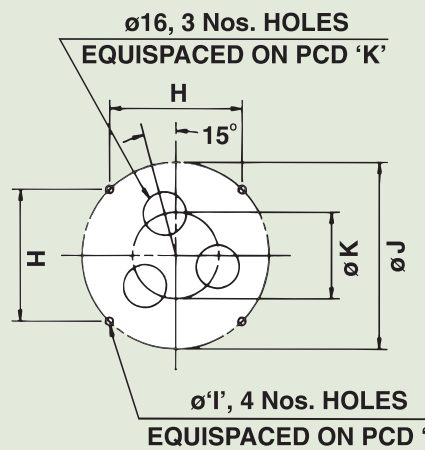

Plug	ØD	E	F	ØG	H	ØI	ØJ	ØK
10 A - 2P+ $\frac{1}{2}$	57	28	3	44	36	4	51	—
20 A - 2P+ $\frac{1}{2}$	69	39	3	52	42	5	60	—
20 A - 3P+ $\frac{1}{2}$	76	41.5	4.5	61.9	48.79	5	69	32
32 A - 3P+ $\frac{1}{2}$	83.8	55.5	4.5	68	53.99	5	76.86	37



Hypra multi-pin connectors
Plug & Sockets

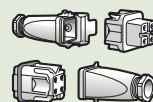

P. 366
multi-pin connectors
kit 10A, 16A, 32A
Plug & Sockets

Dimensions



P. 372-375
multi-pin connectors

Technical data



P. 376-377
multi-pin connectors

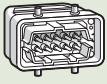

P. 367
multi-pin connectors
function offer
10A Plug & Sockets

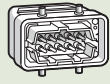

P. 367
multi-pin connectors
function offer
16 to 32A Plug & Sockets

Hypra multi-pin connectors

to meet the need for power and control circuits

Range for different uses.



Side entry plug +
flush mounting socket
with lock



Side entry plug with lock
+
flush mounting socket
with flap



Flush mounting socket
with lock
+
vertical plug



Side entry
socket with lock
+
vertical plug



Flush mounting
socket
with lock



Flush mounting
socket
with flap



Side entry
plug with lock



Protection
cover



Top entry
plug



Flush mounting
socket with lock



Vertical
plug



Side entry
socket



Side entry
plug



Vertical hood
socket with lock



Protection
cover



Foolproofing
pins

Total compatibility with the current standard

Weatherproof IP 55
(IP 65 with protective cover)
and impact resistant (IK 08)



A single screwdriver for
connecting and fixing

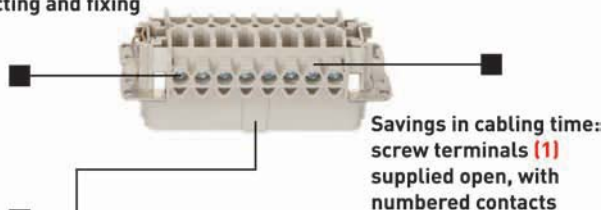

Tamperproof
system



Captive adhesive seals
ensuring weatherproof
protection

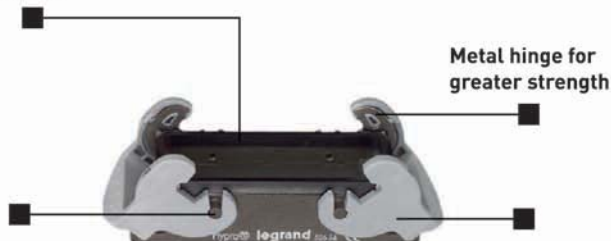

Double locking for greater
strength when suspended

Plastic fastener providing
resistance to corrosion

(1) Also available with spring terminals for automatic
connection (complete kits 500V-16 A).

FEATURES

- 10A, 16A & 32 A.
- 250V, 400V & 500 VAC
- Plastic housing for 3P + E and 4P + E
- Metal housing from 3P + E to 48 P + E
- IP 55, IP 65
- IEC 61984, UL, CSA
- Socket - flush & surface mounting
- Plug - top & side entry
- Locking with plastic and metal hinge which gives resistance against corrosion and double locking ensures proper connection

Hypra[®] multi-pin connectors

10, 16, 32 A

KIT OFFER - 10 A, 250 V & 400 V, PLASTIC AND METAL

								
			Plastic	Metal	Plastic	Metal	Plastic	Metal
250 V	10 A	3P+⊕	0526 18	0531 18	0531 20	0531 22	0526 16	0531 16
400 V	10 A	4P+⊕	0526 19	0531 19	0531 21	0531 23	0526 17	0531 17

KIT OFFER-16A, 500V & 32A, 400V-METAL

							
400 V	32 A	6P+⊕	0526 15	0526 05	-	-	-
500 V	16 A	6P+⊕	0526 10	0526 00	-	0526 20	0526 06
		10P+⊕	0526 11	0526 01	0531 01	0526 21	0526 07
		16P+⊕	0526 12	0526 02	0531 02	0526 22	0526 08
		24P+⊕	0526 13	0526 03	0531 03	0526 23	0526 09
		32P+⊕	0526 14	0526 04	-	0526 24	-

(1) Double verrouillage de 10P+T a 32P+T

Bold catalogue numbers are products normally available with Legrand (India) stockists.

Cat. nos. that are not bold - delivery within 4 weeks from the date of order.

Bold packing quantity is our mandatory packing. Orders to be placed by Legrand (India) stockists in multiples of the same.

Hypra[®] multi-pin connectors

kit offer-plastic & metal

10A, 16A to 32 A



For power and control circuits. Temperature rating : -40°C to 100°C
 Confirms to IEC 61984 Agreements : UL, CSA IK08, IP55.

For power and control circuits. Temperature rating : -40°C to 100°C
 Confirms to IEC 61984 Agreements : UL, CSA IK08, IP65, Unloosable sealed gasket.
 Double locking system

Pack	Cat. No	Top entry plug + flush mounting socket with lock, plastic
10	0526 18	250 V~ - 10 A 3P+⊕
10	0526 19	400 V~ - 10 A 4P+⊕
		Top entry plug + flush mounting socket with lock, metal
8	0531 18	250 V~ - 10 A 3P+⊕
8	0531 19	400 V~ - 10 A 4P+⊕
		Top entry plug + flush mounting socket with lock (side entry), plastic
8	0531 20	250 V~ - 10 A 3P+⊕
8	0531 21	400 V~ - 10 A 4P+⊕
		Top entry plug + flush mounting socket with lock (side entry), metal
8	0531 22	250 V~ - 10 A 3P+⊕
8	0531 23	400 V~ - 10 A 4P+⊕
		Top entry plug + vertical hood socket with lock, plastic
10	0526 16	250 V~ - 10 A 3P+⊕
10	0526 17	400 V~ - 10 A 4P+⊕
		Top entry plug + vertical hood socket with lock, metal
8	0531 16	250 V~ - 10 A 3P+⊕
8	0531 17	400 V~ - 10 A 4P+⊕
		Accessoires
10	0526 69	Protection 3P+⊕ / 4P+⊕ (insert socket)

Pack	Cat. No	Top entry plug + flush mounting socket with lock, metal
2	0526 15	400 V~ - 32 A 6P+⊕
3	0526 10	500 V~ - 16 A 6P+⊕
3	0526 11	10P+⊕
3	0526 12	16P+⊕
3	0526 13	24P+⊕
2	0526 14	32P+⊕
		Side entry plug + flush mounting socket with lock, metal
2	0526 05	400 V~ - 32 A 6P+⊕
3	0526 00	500 V~ - 16 A 6P+⊕
3	0526 01	10P+⊕
3	0526 02	16P+⊕
3	0526 03	24P+⊕
2	0526 04	32P+⊕
		Side entry plug with lock + flush mounting socket with flap, metal
3	0531 01	500 V~ - 16 A 10P+⊕
3	0531 02	16P+⊕
3	0531 03	24P+⊕
		Side entry plug and flush mounting socket with lock, screwless clamp connection, metal
3	0526 20	500 V~ - 16 A 6P+⊕
3	0526 21	10P+⊕
3	0526 22	16P+⊕
3	0526 23	24P+⊕
2	0526 24	32P+⊕
		Side entry plug + surface mounting socket with lock, metal
3	0526 06	500 V~ - 16 A 6P+⊕
3	0526 07	10P+⊕
3	0526 08	16P+⊕
3	0526 09	24P+⊕

Bold catalogue numbers are products normally available with Legrand (India) stockists.
Cat. nos. that are not bold - delivery within 4 weeks from the date of order.
Bold packing quantity is our mandatory packing. Orders to be placed by Legrand (India) stockists in multiples of the same.

Hypra[®] multi-pin connectors plastic and metal

10, 16 to 32 A

FUNTION OFFER - 10 A, 250 V TO 400 V, PLASTIC & METAL

<i>Technical data (p.376-377)</i>			Flush mounting, socket with lock  		Flush mounting, socket with lock (side entry) 		Top entry plug  	
			Plastic	Metal	Plastic	Metal	Plastic	Metal
250 V	10 A	3P+\perp	0526 50	0531 50	0531 06	0531 08	0526 40	0531 40
400 V	10 A	4P+\perp	0526 51	0531 51	0531 07	0531 09	0526 41	0531 41

FUNTION OFFER-16 A, 500 V & 32 A - 400 V, METAL

<i>Technical data (p.376-377)</i>			Flush mounting socket with lock 	Flush mounting socket with lock Automatic screwless connections (spring) earth at left 	Flush mounting socket with lock Automatic screwless connections (spring) earth at right 	Flush mounting socket with flap 
400 V	32 A	6P+\perp	0526 57	-	-	-
500 V	16 A	6P+\perp	0526 52	0531 80	0531 84	-
		10P+\perp	0526 53	0531 81	0531 85	0531 53
		16P+\perp	0526 54	0531 82	0531 86	0531 54
		24P+\perp	0526 55	0531 83	0531 87	0531 55
		32P+\perp	0526 56	-	-	-
		48P+\perp	0526 58	-	-	0531 58

Bold catalogue numbers are products normally available with Legrand (India) stockists.

Cat. nos. that are not bold - delivery within 4 weeks from the date of order.

Bold packing quantity is our mandatory packing. Orders to be placed by Legrand (India) stockists in multiples of the same.

Side entry plug		Vertical hood, socket with lock		Accessories
Plastic	Metal	Plastic	Metal	Insert socket
0531 10	0531 12	0526 26	0531 26	0526 69
0531 11	0531 13	0526 27	0531 27	0526 69

Surface mounting socket with lock	Surface mounting socket with lock & two cable entry	Surface mounting socket with flap & two cable entry	Top entry plug	Top entry socket with lock	Side entry plug	Side entry plug with lock	Protection cover
-	-	-	0526 47	-	0526 35	-	0526 76
0526 60	-	-	0526 42	-	0526 30	-	0526 70
0526 61	0531 71	0531 61	0526 43	0531 43	0526 31	0531 31	0526 71
0526 62	0531 72	0531 62	0526 44	0531 44	0526 32	0531 32	0526 76
0526 63	0531 73	0531 63	0526 45	0531 45	0526 33	0531 33	0526 73
-	-	-	0526 46	-	0526 34	-	0526 74
0526 65	-	0531 65	0526 48	-	0526 36	-	-

Hypra[®] multi-pin connectors

10A function offer - plastic and metal



0526 50 + 0526 69



0531 50



0531 08



0526 40



0531 40



0531 12



Dimension (p. 372-375)

For power and control circuits. Temperature rating : 40°C to 100°C
 Confirms to IEC 61984 Agreements : UL, CSA IK08, IP55.

Pack	Cat. No	Flush mounting socket with lock, plastic
10	0526 50	250 V~ - 10 A 3P+⊥
10	0526 51	400 V~ - 10 A 4P+⊥
Pack	Cat. No	Flush mounting, socket with lock, metal
10	0531 50	250 V~ - 10 A 3P+⊥
10	0531 51	400 V~ - 10 A 4P+⊥
Pack	Cat. No	Flush mounting socket with lock (side entry) plastic
10	0531 06	250 V~ - 10 A 3P+⊥
10	0531 07	400 V~ - 10 A 4P+⊥
Pack	Cat. No	Flush mounting socket with lock (side entry) metal
10	0531 08	250 V~ - 10 A 3P+⊥
10	0531 09	400 V~ - 10 A 4P+⊥
Pack	Cat. No	Top entry plug, plastic
10	0526 40	250 V~ - 10 A 3P+⊥
10	0526 41	400 V~ - 10 A 4P+⊥

Pack	Cat. No	Top entry plug, metal
10	0531 40	250 V~ - 10 A 3P+⊥
10	0531 41	400 V~ - 10 A 4P+⊥
Pack	Cat. No	Side entry plug, plastic
10	0531 10	250 V~ - 10 A 3P+⊥
10	0531 11	400 V~ - 10 A 4P+⊥
Pack	Cat. No	Side entry plug, metal
10	0531 12	250 V~ - 10 A 3P+⊥
10	0531 13	400 V~ - 10 A 4P+⊥
Pack	Cat. No	Vertical hood socket with lock plastic
10	0526 26	250 V~ - 10 A 3P+⊥
10	0526 27	400 V~ - 10 A 4P+⊥
Pack	Cat. No	Vertical hood socket with lock metal
10	0531 26	250 V~ - 10 A 3P+⊥
10	0531 27	400 V~ - 10 A 4P+⊥

Pack	Cat. No	Accessories
10	0526 69	Protection cover 3P+⊥ / 4P+⊥ (insert socket)

Bold catalogue numbers are products normally available with Legrand (India) stockists.

Cat. nos. that are not bold - delivery within 4 weeks from the date of order.

Bold packing quantity is our mandatory packing. Orders to be placed by Legrand (India) stockists in multiples of the same.

Hypra[®] multi-pin connectors

16 to 32A function offer - metal



0531 54



0531 81
Automatic connection.



0526 58



0526 61



0531 62



0526 43

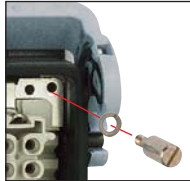

Exemple de détournage avec plot réf. 526 80



0526 71

Dimension (p. 372-375)

For power and control circuits. Temperature rating : 40°C to 100°C
 Confirms to IEC 61984 Agreements : UL, CSA IK08, IP55, IP65 (with cover) Unloosable sealed gasket.
 Double locking system

Pack	Cat. No		
			Flush mounting socket
	With lock	With flap	
4	0526 57		400 V\sim - 32 A 6P+ \perp
			500 V\sim - 16 A
5	0526 52		6P+ \perp
5	0526 53	0531 53	10P+ \perp
5	0526 54	0531 54	16P+ \perp
5	0526 55	0531 55	24P+ \perp
4	0526 56		32P+ \perp
2	0526 58	0531 58	48P+ \perp
			Flush mounting socket with lock. Automatic screwless connections, (spring), earth at left
			500 V\sim - 16 A
3	0531 80		6P+ \perp
3	0531 81		10P+ \perp
2	0531 82		16P+ \perp
2	0531 83		24P+ \perp
			Flush mounting socket with lock. Automatic screwless connections (spring) earth at right
			500 V\sim - 16 A
3	0531 84		6P+ \perp
3	0531 85		10P+ \perp
2	0531 86		16P+ \perp
2	0531 87		24P+ \perp
			Surface mounting socket
	With lock	With flap	
5	0526 60		500 V\sim - 16 A 6P+ \perp
5	0526 61	0531 61	10P+ \perp
5	0526 62	0531 62	16P+ \perp
5	0526 63	0531 63	24P+ \perp
2	0526 65	0531 65	48P+ \perp
			Surface mounting socket with lock with two cable entry
			500 V\sim - 16 A
4	0531 71		10P+ \perp
4	0531 72		16P+ \perp
4	0531 73		24P+ \perp

Pack	Cat. No		
			Top entry plug
			400 V\sim - 32 A
4	0526 47		6P+ \perp
			500 V\sim - 16 A
5	0526 42		6P+ \perp
5	0526 43		10P+ \perp
5	0526 44		16P+ \perp
5	0526 45		24P+ \perp
4	0526 46		32P+ \perp
2	0526 48		48P+ \perp
			Top entry socket with lock
			500 V\sim - 16 A
5	0531 43		10P+ \perp
5	0531 44		16P+ \perp
5	0531 45		24P+ \perp
			Side entry plug
	without lock	with lock	
4	0526 35		400 V\sim - 32 A 6P+ \perp
			500 V\sim - 16 A
5	0526 30		6P+ \perp
5	0526 31	0531 31	10P+ \perp
5	0526 32	0531 32	16P+ \perp
5	0526 33	0531 33	24P+ \perp
4	0526 34		32P+ \perp
2	0526 36		48P+ \perp
			Accessories
			Protection cover plastic
5	0526 70		6P+ \perp
5	0526 71		10P+ \perp
5	0526 76		16P+ \perp / 6P+ \perp (32 A)
5	0526 73		24P+ \perp
2	0526 74		32P+ \perp
			Foolproofing pins
			Supplied in bags of 16
10	0526 80		Enables the differentiation of juxtaposed bases thanks to several possible combinations

Hypra[®] multi-pin connectors

plastic, metal

10, 16, 32A

■ DIMENSIONS

Top entry plug + flush mounting socket with lock
Cat. nos. 0526 18/19 & 531 18/19

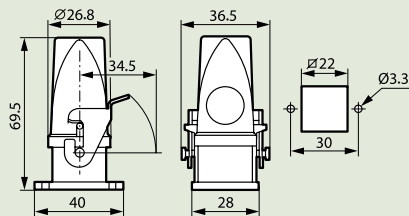

Top entry plug + flush mounting socket with lock (side entry)
Cat. nos. 0531 20/21/22/23

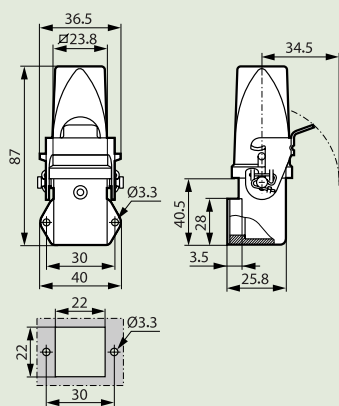

Top entry plug + vertical hood sockets with lock
Cat. nos. 0526 16/17 to 531 16/17

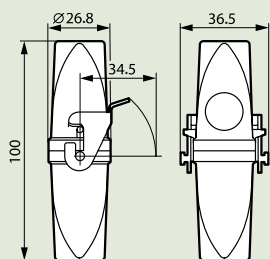

Flush mounting socket with lock

250 V - 10 A - 3P+⊥ and 400 V - 10 A - 4P+⊥ plastic
Cat.nos. 0526 50/51 **and metal** Cat.nos. 0531 50/51

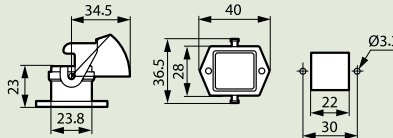

Flush mounting socket with lock (side entry)

250 V - 10 A - 3P+⊥ and 400 V - 10 A - 4P+⊥ plastic
Cat.nos. 0531 06/07 **and metal** Cat.nos. 0531 08/09

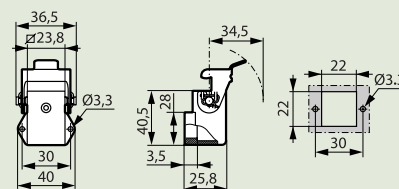

Top entry plug

250 V - 10 A - 3P+⊥ and 400 V - 10 A - 4P+⊥
Cat.nos. 0526 40/41 and 0531 40/41

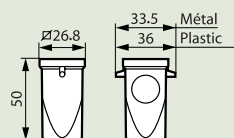

Side entry plug

250 V - 10 A - 3P+⊥ and 400 V - 10 A - 4P+⊥
Cat. nos. 0531 10/11/12/13

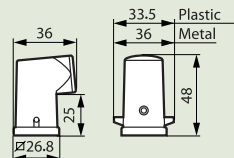

Vertical hood socket with lock

250 V - 10 A - 3P+⊥ and 400 V - 10 A - 4P+⊥
Cat. nos. 0526 26/27 and Cat. nos. 0531 26/27

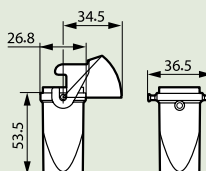

Protection on cover 3P+ \pm and 4P+ \pm
 Cat. nos. 0526 69

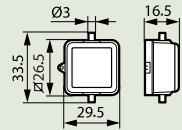

Flush mounting socket with lock

500 V - 16 A - 6P+ \pm
 Cat.nos. 0526 52

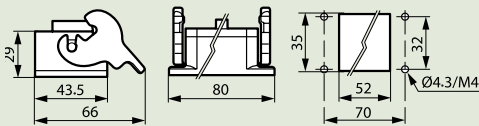

400 V - 32 A - 6P+ \pm Cat.nos. 0526 57
and 500 V - 16 A - 10 to 32P+ \pm
 Cat.nos. 0526 53/54/55/56

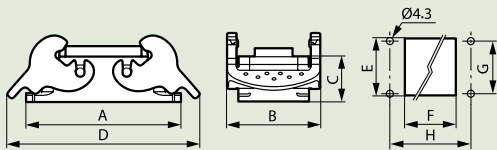

Intensity	Cat. nos.	No. of poles	A	B	C	D	E	F	G	H	Ø
16 A	0526 53	10P+T	93	43	28	115	35	65	32	83	4,3/M4
	0526 54	16P+T	113	43	28	137	35	85,5	32	103	4,3/M4
	0526 55	24P+T	140	43	28	164	35	112	32	130	4,3/M4
32 A	0526 56	32P+T	124	84	35	158	71	86	65	110	4,3/M4
	0526 57	6P+T	113	43	28	137	35	85,5	32	103	5,5/M5

500 V - 16 A - 48P+ \pm
 Cat.nos. 0526 58

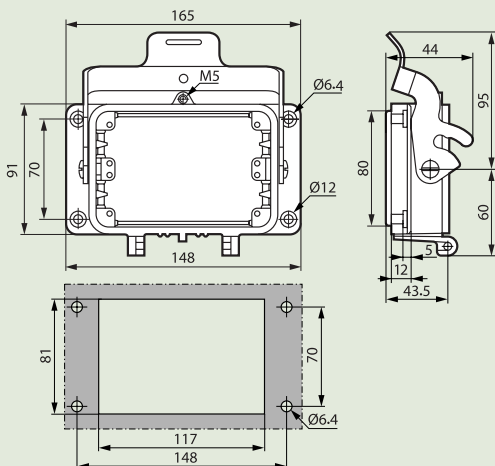

Flush mounting socket with lock
Automatic screwless connection (springs)

500 V - 16 A - 6P+ \pm
 Cat.nos. 0531 80/84/88/92

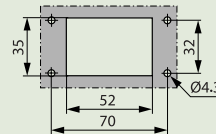
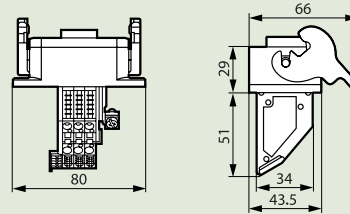

500 V - 16 A - 10 to 24P+ \pm
 Cat.nos. 0531 81/82/83/85/86/87

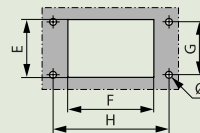
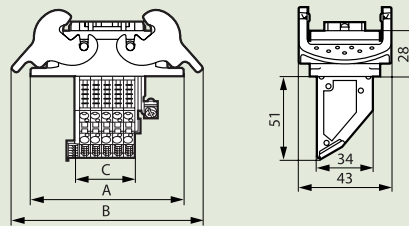

Intensity	No of poles	A	B	C	E	F	G	H	Ø
16 A	10P+T	93	115	36,5	35	65	32	83	4,3/M4
	16P+T	113	137	56,6	35	85,5	32	103	4,3/M4
	24P+T	140	164	83,4	35	112	32	130	4,3/M4

Flush mounting

500 V - 16 A - 10 to 24P+ \pm
 Cat.nos. 0531 53/54/55

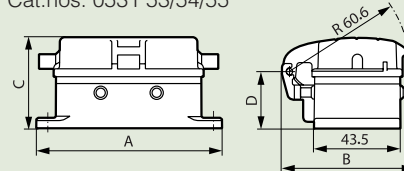

Découpe pour fixation

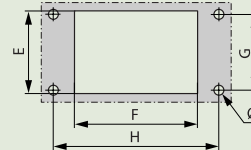

Intensity	No of poles	A	B	C	D	E	F	G	H	Ø
16 A	10P+T	93	67	46	29	35	65	32	83	4,5/M4
	16P+T	113	66	46	29	35	85,5	32	103	4,5/M4
	24P+T	140	67	46	29	35	112	32	130	4,5/M4

Hypra[®] multi-pin connectors
plastic, metal
10, 16 to 32A

500 V - 16 A - 48P+_±

Cat.nos. 0531 58

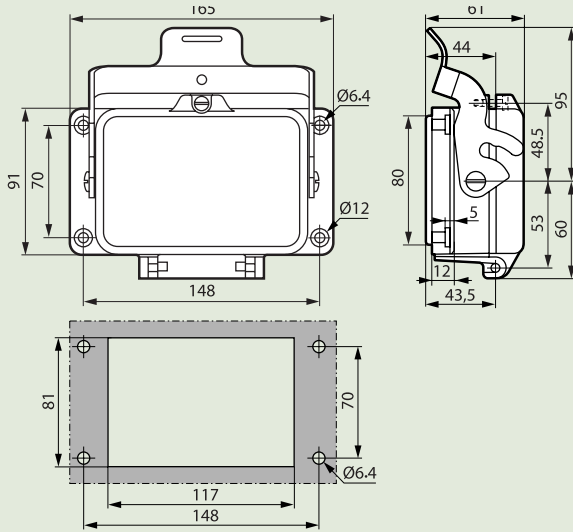

Surface mounting socket with lock

500 V - 16 A - 6P+_±

Cat.nos. 0526 60

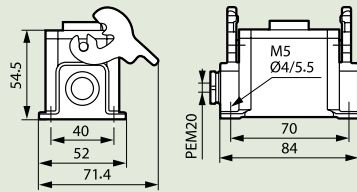

500 V - 16 A - 10 to 24P+_±

Cat.nos. 0526 61/62/63

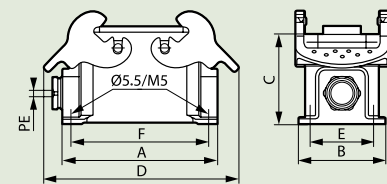

Intensity	Cat. nos.	No of poles	A	B	C	D	E	F	PE	Ø
16 A	0526 61	10P+T	94	52	54,5	117	40	82	M20	3-14,5
	0526 62	16P+T	117	57	56,5	138	45	105	M25	7,5-19
	0526 63	24P+T	144	57	56,5	164	45	132	M25	7,5-19

500 V - 16 A - 48P+_±

Cat.nos. 0526 65

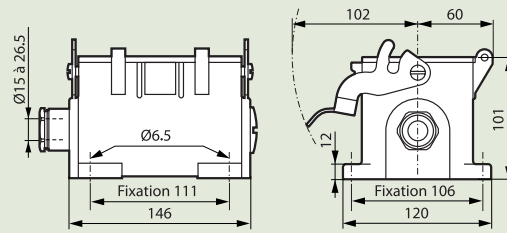

Surface mounting socket with lock & two cable entries.

500 V - 16 A - 10 to 24P+_±

Cat.nos. 0531 71/72/73

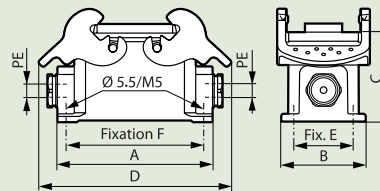

Intensity	No of poles	A	B	C	D	E	F	PE	Ø
16 A	10P+T	94	52	54,5	117	40	82	M20	3-14,5
	16P+T	117	57	56,5	138	45	105	M25	7,5-19
	24P+T	144	57	56,5	164	45	132	M25	7,5-19

Surface mounting socket with flap & two cable entries.

500 V - 16 A - 10 to 24P+_±

Cat.nos. 0531 61/62/63

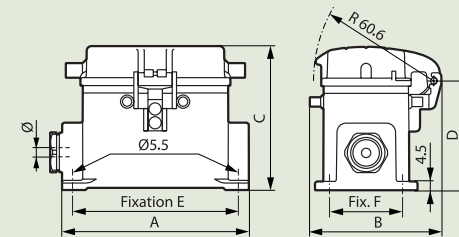

Intensity	No of poles	A	B	C	D	E	F	PE	Ø
16 A	10P+T	94	67	72	55,6	82	40	M20	3-14,5
	16P+T	117	67	74	57,6	105	45	M25	7,5-19
	24P+T	144	67	74	57,6	132	45	M25	7,5-19

500 V - 16 A - 48P+_±

Cat.nos. 0531 65

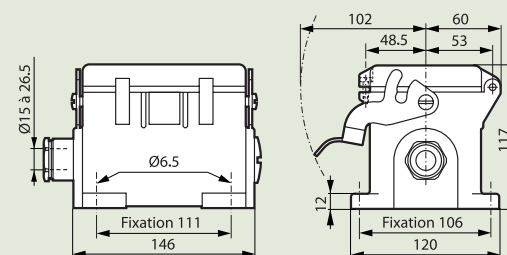

Top entry plug

400 V - 32 A - 6P+ \pm and 500 V - 16 A - 6P+ \pm to 48P+ \pm

Cat. nos. 0526 42 to 526 48

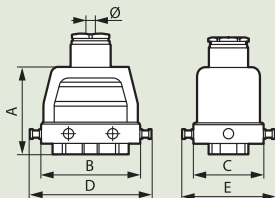

Intensity	Cat. nos.	No of poles	A	B	C	D	E	PE	Ø
16 A	0526 42	6P+T	47,5	60	43	73,5	-	M20	3-14,5
	0526 43	10P+T	53	73	43	-	56	M20	3-14,5
	0526 44	16P+T	60	93,5	43	-	56	M25	7,5-19
	0526 45	24P+T	70	120	43	-	56	M25	7,5-19
	0526 46	32P+T	94	93,5	82,5	-	97,5	M32	15-26,5
	0526 48	48P+T	107	132	90	146	-	M32	15-26,5
32 A	0526 47	6P+T	60	93,5	43	-	56	M25	7,5-19

Top entry socket with lock

500 V - 16 A - 10P+ \pm to 24P+ \pm Cat. nos. 0531 43/44/45

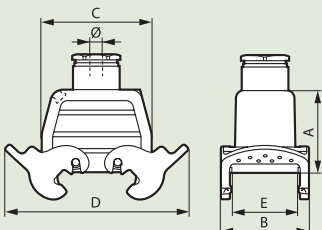

Intensity	No of poles	A	B	C	D	E	PE	Ø
16 A	10P+T	53	57,2	73	119	43	M20	3-14,5
	16P+T	60	57,2	93,5	139	43	M25	7,5-19
	24P+T	70	57,2	120	166	43	M25	7,5-19

Side entry plug

400 V - 32 A Cat. nos. 0526 35

- 6P+ \pm and 500 V - 16 A - 6P+ \pm to 32P+ \pm

Cat. nos. 0526 30/31/32/33/34/36

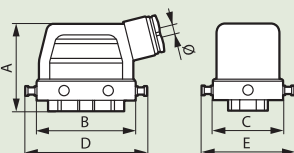

Intensity	Cat. nos.	No of poles	A	B	C	D	E	PE	Ø
16 A	0526 30	6P+T	47,5	60	43	73,5	-	M20	3-14,5
	0526 31	10P+T	53	73	43	-	56	M20	3-14,5
	0526 32	16P+T	60	93,5	43	-	56	M25	7,5-19
	0526 33	24P+T	70	120	43	-	56	M25	7,5-19
	0526 34	32P+T	94	93,5	82,5	-	97,5	M32	15-26,5
	0526 36	48P+T	107	132	90	146	-	M32	15-26,5
32 A	0526 35	6P+T	60	93,5	43	-	56	M25	7,5-19

Side entry plug with lock

500 V - 16 A - 10P+ \pm to 24P+ \pm

Cat. nos. 0531 31/32/33

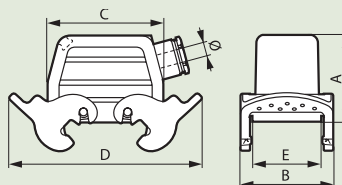

Intensity	No of poles	A	B	C	D	E	PE	Ø
16 A	10P+T	53	56	73	119	43	M20	3-14,5
	16P+T	60	56,4	93,5	139	43	M25	7,5-19
	24P+T	70	56,4	120	166	43	M25	7,5-19

6P+ \pm to 32P+ \pm Cat. nos. 0526 70/71/73/74/76

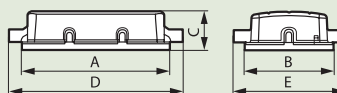

Intensity	Cat. nos.	No of poles	A	B	C	D	E
16 A	0526 70	6P+T	62,5	45,5	20	75	-
	0526 71	10P+T	75,5	45,5	20	-	57,2
	0526 76	16P+T	96	45,5	20	-	57,2
	0526 73	24P+T	122,5	45,5	20	-	57,2
32 A	0526 76	6P+T	96	45,5	20	-	57,2

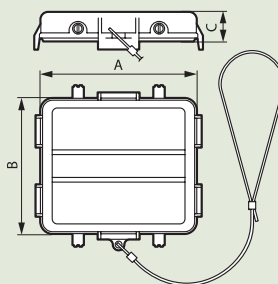

Intensity	Cat. nos.	No of poles	A	B	C
16 A	0526 74	32P+T	93,5	82,5	23

Foolproofing pins

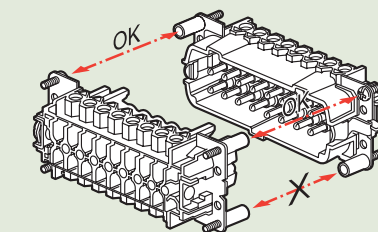

3, 4, 6, 16, 24 poles/poles

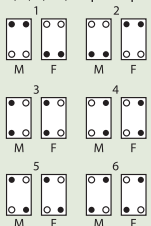

32 poles/poles

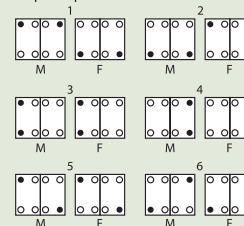

● Coding pins
○ Fixing screws

M Male connector part
F Female connector part

technical data

■ Definition

The main function of Hypra multi-pins connectors is to answer the connection needs of power and control circuits.

- All types of industry (carmakers, steel, etc.)
- Machine tool industry
- Industrial automation
- Information controls and transport, signalling

These products provide for various uses that can be combined or not on the same connector :

- Provision of low-intensity electric current (up to 32A)
- Control of remote controls and PLCs.
- Transmission of data to control lights and indicators
- Star/delta motor starting for three-phase asynchronous motors that enables machines to be connected to 230V (delta) and 380V (star)
- Three-phase motor polarity change (e.g.: change of speed for Dahlander type two-speed motors, change in direction of rotation) These products are used on industrial equipment and secondarily on commercial equipment. This equipment is usually fixed, except in the case of three-phase motors. Type of equipment :

Type of equipment : injection presses, lifts, escalators and elevators, hoists, overhead cranes, automated lines, industrial robots, packaging machines, sound studios, building illumination, three-phase asynchronous electric motors, automation cabinets

- Full compatibility with existing equipment
- Available in complete kit (male part + female part) it's possible to reserve the insert in the metal or plastic bodies
- Available by function (male part or female part)
- Spare parts on special request

■ Use

Functionalities

Bulkhead-mounting housing for cabinet mounting
 Surface-mounting housing for offset mounting
 Side hood : easy installation in reduced space
 Top hood : for suspended use (e.g.: overhead crane)

Current and Voltage

10, 16A and 32A
 250V in 3P+E
 400V in 10A 4P+E and 32A 6P+E
 500V for all other polarities

Polarity

3P+E and 4P+E in 10A
 6P+E in 16A and 32A
 from 10P+E to 48P+E in 16A

Locking

Single locking

- For products 3P+E, 4P+E, 6P+E (16A) and 48P+E.

Double locking

- For products 32A of 6P+E and 16A from 10P+E to 32P+E.

Connection/disconnection cycles

Rated current	Connection	Connection cycles
16 A	Screw	200
16 A	Automatic (spring)	500
32 A	Screw	200
10 A	Screw	3-pole 50 4-pole 400

Breaking Capacities

There is no breaking capacity requirement in IEC 61 984. Connectors must not be connected or disconnected on load.

Cable entries

The cable entries of hoods and housings have metric thread.

Top hood

16A 6P+E to 10P+E = M20
 16A 16P+E to 24P+E = M25
 16A 32P+E and 48P+E = M32
 32A 6P+E = M25

Side hood

16A 6P+E to 10P+E = M20
 16A 16P+E to 24P+E = M25
 16A 32P+E = M32
 32A 6P+E = M25

Surface-mounting housing

16A 6P+E to 10P+E = M20
 16A 16P+E to 24P+E = M25
 16A 48P+E = M32

■ Connection

- Increasing numbering of contacts marking on both sides
- Fool proofing system by insert shape
- Power screwdrivers can be used thanks to the screwdriver guide

Screw connection

- Captives screws
 - Terminals supplied open
- 10A : 0.5 – 2.5 mm (22-12 AWG) – 4 mm stripping
 16A : 0.5 – 2.5 mm (20-12 AWG) – 7 mm stripping
 32A : 2.5-6mm (14-8 AWG) – 10 mm stripping

Spring connection

- For the complete kit (flush-mounting base + side output cover) in 16A From 6P + E to 24P + E
- 16A : 0.14 – 2.5mm (26-12 AWG) – 7 mm stripping

NOTE :

The earth conductors must have a cross-section at least equivalent to the largest cross-section of the phase conductors

- For flush-mounting base with terminal block functions 16A : 0.5 – 2.5mm (20-12 AWG) – 9 mm stripping

Conductors

Number of conductors which can be introduced in the screw terminal

10A screw : 2 times 0.5 mm up to 2 times 1.5 mm²
 16A screw : 2 times 0.5 mm up to 2 times 1.5 mm²
 32A screw : 2 times 0.5 mm up to 2 times 4.0 mm²
 16A spring : it is not possible to connect more than one conductor per pole.

■ General Characteristics

The various tests

6.1 Glow wire and Use temperatures

- 850° contact support (inserts)
- 650° enclosure (plastic)
- Use temperature :- 40°C /+100°C

UV Resistance

- No alteration of the material
- Radiation intensity:550 W/m
- Test duration:168 hours
- Infrared and ultra-violet filter in order to get as close to the solar spectrum as possible

Shock withstand voltage and degree of pollution

6 kilovolts

4 kilovolts for 10A products

Degree of pollution : 3

Weatherproofing and IK

10A IP55

16A/32A IP65

- Captive adhesive seals
- The covers and bases are IK 08.

Material of components

ROHS compliance

Without cover and without connection:

- Base and hood body :metal
- The 3P+E and 4P+E versions are also available in plastic
- Contacts:traited brass
- Contact supports : plastic
- Insert fixing screws : zin-coated steel
- Connection screws : tinned steel
- Seal:neoprene

■ Compliance with the standards

- Compliance with standards NF EN 61 984 and IEC 61 984
- Compliance with standards NF EN 60 529 and IEC 60 529 (IP)
- Compliance with standards NF EN 62 262 and IEC 62 262 (IK)
- Approvals :UL,CSA
- Compliance with ROHS

Basic curve and hard curve

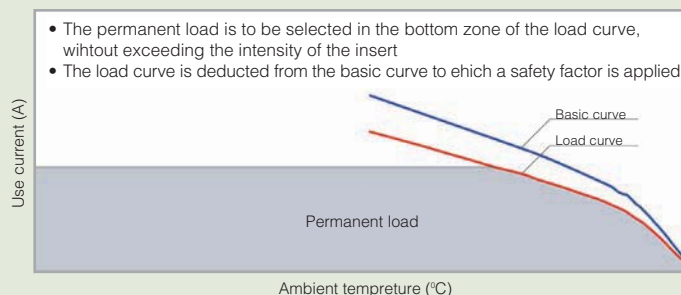

- The permanent load is to be selected in the bottom zone of the load curve, without exceeding the intensity of the insert
- The load curve is deducted from the basic curve to which a safety factor is applied

PRACTICAL TRAINING FOR PROFESSIONALS

For training and information

To facilitate sales team, external n internal customers to have hands on experience of the subject and products



Please contact us for
more information
Legrand area manager

quality certificate
a stamp of recognition

Our vision of achieving higher standards of quality has earned us the coveted ISO 9001: 2000 certification. The production units of Legrand at Jalgaon and Sinnar has been assessed and approved by Bureau Vertias Quality International for maintaining international quality standards in every stage of production. Our quest for quality doesn't end here. This achievement has further inspired us to set higher standards of quality through innovation and advanced R&D activities. Thereby assuring optimum consumer satisfaction.



Current rating chart

for copper and aluminium

Estimated current ratings for copper and aluminium conductors, vulcanised rubber, PVC, or polythene insulated cables (single, twin, three and four core)

Item	Standard copper conductor		Continuous current rating* (Subject to voltage drop)				Standard aluminium conductor		
	Area (Sq. inches)	Strand (Inches)	In conduit troughing or casing - 2 single core cables (A)	Bunched in free air or open trench		One twin core DC or AC (A)	1, 3 or 4 core cable balanced 3 phase (A)	Area (Sq. mm)	Strand (mm)
				2 single core cables (A)	3 or 4 single core cables (A)				
1	2	3	4	5	6	7	8	9	10
1	.0015	1/.044	5	5	55	5	5		
2	.002	3/.029	10	10	10.9	10	8/7	1.5	1/1.40
3	.003	3/.036	15	15	13/12	15	10/11	2.5	1/1.80
4	.0045	7/.029	20	20	15	20	15	4	1/2.24
5			20	20	17	20	14		
6	.007	7/.036	27	27	24	27	19	6	1/2.80
7			28	28	25	28	20		
8	.01	7/.044	34	34	31	34	25	10	1/3.55
9			36	36	32	36	25		
10	.0145	7/.052	43	43	39/38	43	30	16	7/1.70
11	.0225	7/.064	53	53	48	53	37	25	7/2.24
12			59	59	54	59	42		
13	.03	19/.044	62	62	56	62	43	35	7/2.50
14	.04	19/.052	69	69	62	69	48		
15			74	74	67	74	52		
16	.06	19/.064	19	19	82	91	62	50	7/3.00
17			97	97	88	97	68		
18	.075	19/.072		123	107	115	78	70	19/2.24
19				134	118	118	82		
20	.1	19/.083		153	138	135	94	95	19/2.50
21				160	140	140	98		
22	.12	37/.064		177	158	158	109	120	37/2.06
23				184	170	162	114		
24	.15	37/.072		205	185	180	126	150	37/2.24
25				210	185	181	124		
26	.2	37/.083		246	216	209	146	185	37/2.50
27				250	220	218	153		
28	.25	37/.093		290	248	240	169	225	37/2.80
29				293	260	252	178		
30	.3	37/.103		335	295	284	199	300	61/2.50
31				354	302	289	202		
32	.4	61/.093		425	360	342	240	400	61/3.00
33				435	372				
34	.5	61/.103		480	410			500	91/2.65
35				480	411				
36	.75	91/.103		565	484			625	91/3.00
37				610	520				
38	1.0	127/.103		740	630				

*Ratings at ambient temperature 30°C

For ambient temperature other than 30°C, the current ratings should be multiplied by the following rating factors

	25°C	35°C	40°C	45°C
Rating factor	1.13	0.86	0.69	0.47

In the above table, current ratings (subject to voltage drop) have been given for copper conductor cables (in conventional British standard sizes) and also for cables with aluminium conductors (in the new metric sizes as per IS 1753 - 1961). From this chart, the required size of aluminium conductor can be established if either the current rating or the size of the copper conductor is known.

To establish the size of the aluminium conductor against your requirement, read off the current rating for the conventional copper conductor cable (say, 7/.064) and select the conductor size from the last two columns (25 sq. mm.) which has a current rating equal to, or nearest to, that of the copper conductor cable.

Current carrying capacity chart

for copper and aluminium busbars

Copper busbars : Constructional details and current carrying capacity at 35°C ambient temperature and 30°C temp. rise

Size in mm	Cross sectional area in mm ²	weight (approx) kg./metre	Continuous current carrying capacity in Amps.								
			AC no. of buses				DC no. of buses				
			1 I	2 II	3 III	4 II 50 II	1 I	2 II	3 III	4 IIII	
12x2	23.5	0.209	110	200				115	205		
15x2	29.5	0.262	140	200				145	245		
15x3	44.5	0.396	170	300				175	305		
20x2	39.5	0.351	185	315				190	325		
20x3	59.5	0.529	220	380				225	390		
20x5	99.1	0.882	295	500				300	510		
25x3	74.5	0.663	270	460				275	470		
25x5	124.0	1.11	350	600				355	610		
30x3	89.5	0.796	315	540				320	560		
30x5	149.0	1.33	400	700				410	720		
40x3	119.0	1.06	420	710				430	740		
40x5	199.0	1.77	520	900				530	930		
40x10	399.0	3.55	760	1350	1850	2500		770	1400	2000	
50x5	249.0	2.22	630	1100	1650	2100		650	1150	1750	
50x10	499.0	4.44	920	1600	2250	3000		960	1700	2500	
60x5	299.0	2.66	760	1250	1760	2400		780	1300	1900	2500
60x10	599.0	5.33	1060	1900	2600	3500		1100	2000	2800	3600
80x5	399.0	3.55	970	1700	2300	3000		1000	1800	2500	3200
80x10	799.0	7.11	1380	2300	3100	4200		1450	2600	3700	4800
100x5	499.0	4.44	1200	2050	2850	3500		1250	2250	3150	4050
100x10	999.0	8.89	1700	2800	3650	5000		1800	3200	4500	5800
120x10	1200.0	10.7	2000	3100	4100	5700		2150	3700	5200	6700
160x10	1600.0	14.2	2500	3900	5300	7300		2800	4800	6900	9000
200x10	2000.0	17.8	3000	4750	6350	8800		3400	6000	8500	10000

Aluminium busbars : Constructional details and current carrying capacity at 35°C ambient temperature and 30°C temp. rise

Size in mm	Cross sectional area in mm ²	weight (approx) kg./metre	Continuous current carrying capacity in Amps.								
			AC no. of buses				DC no. of buses				
			1 I	2 II	3 III	4 II 50 II	1 I	2 II	3 III	4 IIII	
12x2	23.5	0.0633	80	140				80	145		
15x2	29.5	0.0795	95	170				95	175		
15x3	44.5	0.120	115	210				115	220		
20x2	39.5	0.107	120	220				125	225		
20x3	59.5	0.161	145	270				150	280		
20x5	99.1	0.268	195	350				200	370		
25x3	74.5	0.201	180	330				185	340		
25x5	124.0	0.335	230	430				235	440		
30x3	89.5	0.242	205	385				220	400		
30x5	149.0	0.403	270	500				275	520		
40x3	119.0	0.323	280	500				285	525		
40x5	199.0	0.538	350	650				360	660		
40x10	399.0	1.08	515	975	1350	1800		540	1000	1420	
50x5	249.0	0.673	425	780	1120	1500		445	815	1220	
50x10	499.0	1.35	625	1150	1600	2160		655	1220	1730	
60x5	299.0	0.808	500	900	1300	1730		530	960	1420	1850
60x10	599.0	1.62	730	1330	1900	2500		770	1430	2030	2600
80x5	399.0	1.08	680	1170	1650	2230		700	1260	1850	2400
80x10	799.0	2.16	940	1700	2360	3150		985	1840	2640	3400
100x5	499.0	1.35	820	1440	2000	2600		855	1550	2220	2900
100x10	999.0	2.70	1150	2050	2800	3700		1200	2240	3200	4200
100x15	1500.0	4.04	1450	2500	3350	4400		1500	2750	4000	5200
120x10	1200.0	3.24	1350	2400	3250	4300		1420	2700	3900	5100
120x15	1800.0	4.86	1650	2900	3900	5000		1750	3250	4800	6300
160x10	1600.0	4.32	1750	3000	4150	5300		1850	3450	5000	6500
160x15	2400.0	6.47	2100	3600	4850	6250		2300	4300	6200	8100
200x10	2000.0	5.40	2150	3650	4950	6400		2300	4300	6200	8100
200x15	3000.0	8.09	2550	4200	5600	7300		2850	5250	7650	10100

index of protection : IPxx and IK

IPXX

Index of protection

IP** index of protection of enclosures of electrical equipment in accordance with standards IEC 529, BS 5490, DIN 400 50 and NF C 20-010
 Up to 1000 V_~ and 1500 V₌ (standard UTE C 20 010)

1st figure:- protection against solid bodies		
IP	tests	
0		No protection
1	Ø 50 mm	Protected against solid bodies larger than 50 mm (eg:- accidental contact with the hand)
2	Ø 12.5 mm	Protected against solid bodies larger than 12 mm (eg:- finger)
3	Ø 2.5 mm	Protected against solid bodies larger than 2.5 mm (eg:- tools, wires)
4	Ø 1 mm	Protected against solid bodies larger than 1 mm (eg:- fine tools and small wires)
5		Protected against dust (no harmful deposit)
6		Completely protected against dust

2nd figure:- protection against liquids		
IP	tests	
0		No protection
1		Protected against vertically-falling drops of water (condensation)
2		Protected against drops of water falling at up to 15° from the vertical
3		Protected against drops of rain water at up to 60° from the vertical
4		Protected against projections of water from all directions
5		Protected against jets of water from all directions
6		Protected against jets of water of similar force to heavy seas
7		Protected against the effects of immersion
8		Protected against prolonged effects of immersion under pressure

IK

Protection against mechanical impact: protection index - IK
 According to standard: IEC 62262, BS EN 62262 and NF EN 62262
 • This table can be used to ascertain the resistance of a product to an impact given in Joules from the IK code (graduated from 00 to 10)
 It can also be used to ascertain the correspondence with the old IP code 3rd digit and the corresponding external "Ag" conditions

IK	Tests	Impact energy (in Joules)	"Ag" of NF C 15-100
IK 00		0	
IK 01		0.15	
IK 02		0.2	AG1
IK 03		0.35	
IK 04		0.5	
IK 05		0.7	
IK 06		1	
IK 07		2	AG2
IK 08		5	AG3
IK 09		10	
IK 10		20	AG4

The contents of all the above charts are for guidance only, if you have any doubt as to the interpretation of the information contained therein, please refer either to the standard itself or contact Legrand.

In accordance with our policy of continuous improvement, Legrand reserves the right to change specifications and designs without notice. All information given here is correct at the time of going to press.