

DETAILS

Product Number	C13118_STRADA-SQ-A-T
Family	Strada-SQ
Type	Lens
Color	clear
Diameter	25 + 25 mm
Height	9 mm
Style	square
Optic Material	PMMA
Holder Material	
Fastening	screw, pin, glue
Status	ready
ROHS Compliant	Yes
Date Updated	22/10/2012



OPTICAL PROPERTIES

LED	Viewing Angle	Light Beam	Efficiency	cd/lm	connector
LUXEON M	Asymmetric degrees		93 %	0.300	-
XM-L2	Asym degrees		94 %	0.700	-
LUXEON MZ	Asym degrees		93 %	0.800	-
XM-L	Asymmetric degrees		93 %	0.300	-

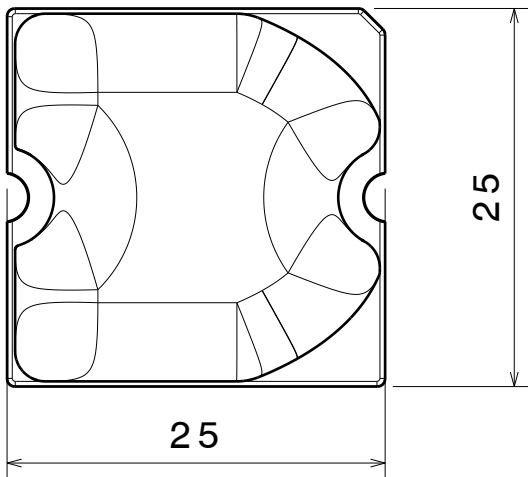
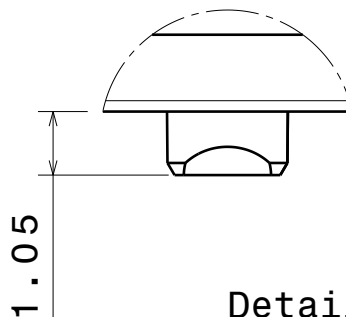
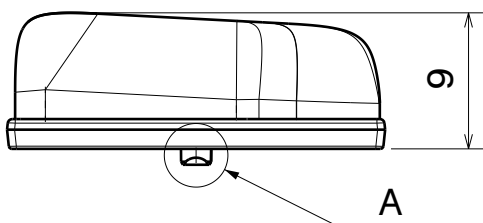
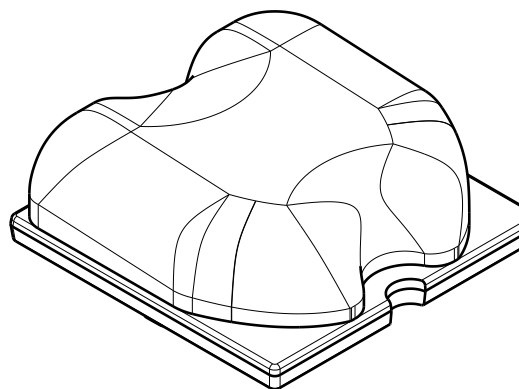
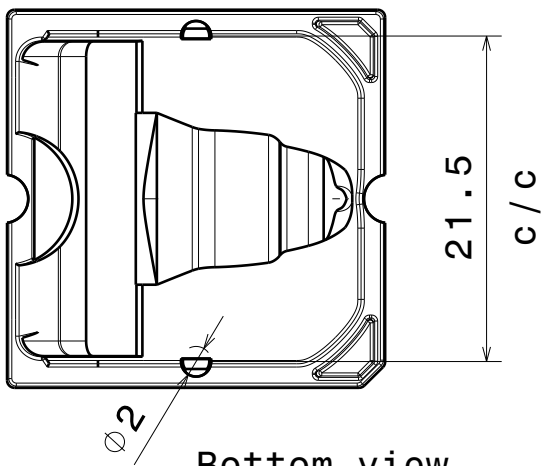

Tolerances if not otherwise shown:
According to DIN ISO 2768-1
Linear measures:
Up to 30mm class M, otherwise class C.

According to DIN ISO 2768-2
Form and position:
class L

Control for SPC marked dimensions.

This drawing is our property.
It can't be reproduced
or communicated without
our written agreement.

LEDiL

Ledil Oy
Salorankatu 10
FIN 24240 SALO
Finland

DRAWING TITLE

Mechanical drawing

DRAWN BY

as

DATE

25.9.2012

STRADA-SQ-A-T

CHECKED BY

VS

DATE

-

SIZE

A4

PART NUMBER

REV

001

DESIGNED BY

-

DATE

-

SCALE

2:1

WEIGHT

4,80 g

SHEET

1/1

Luminaire: LEDiL Oy C13118_ & CA13119_STRADA-SQ-A-T-LuxM (Luxeon M 362lm @ 250mA) Efficiency=93%
Lamps: 1 x Luxeon M 362lm @ 250mA

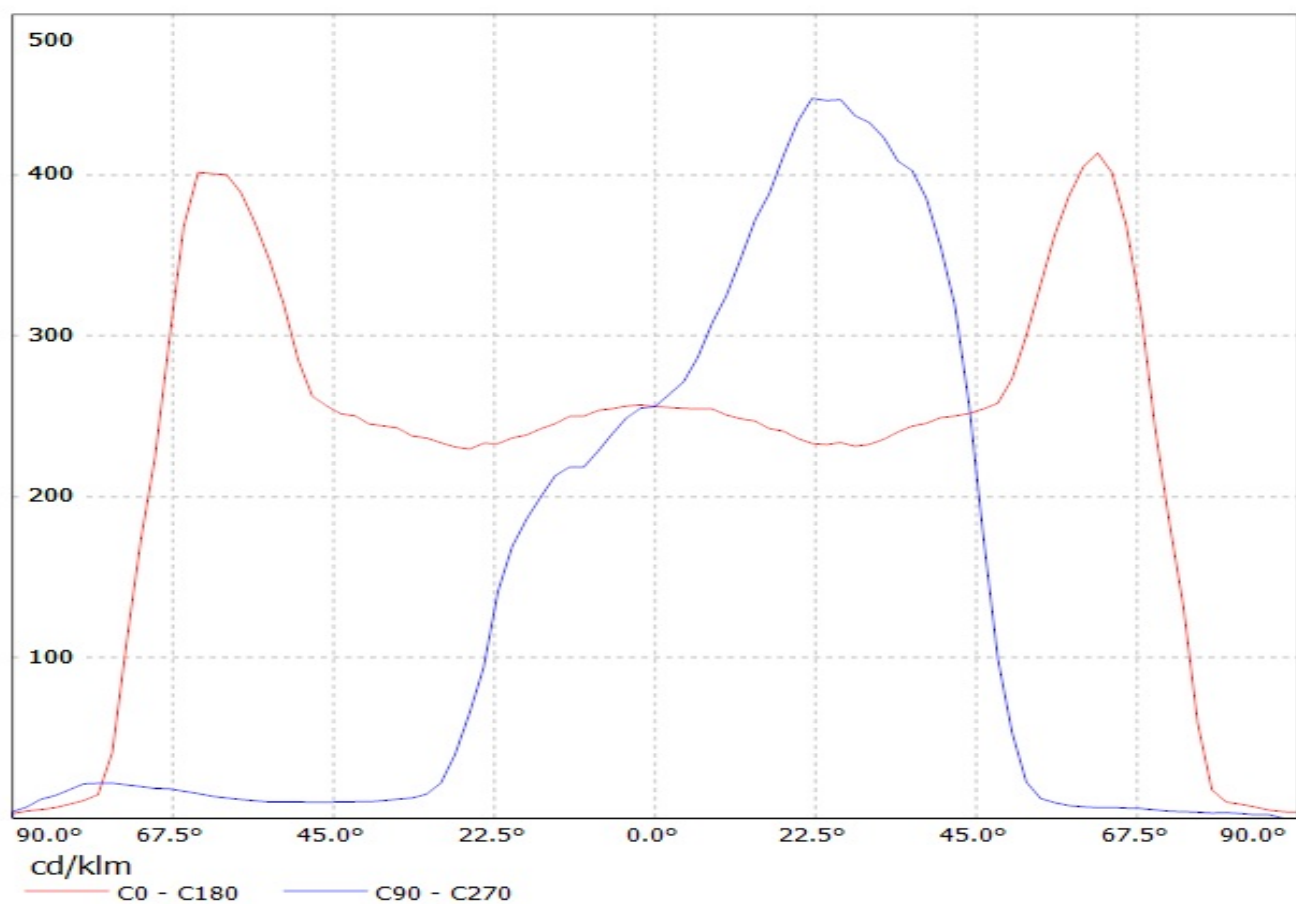

Luminaire: LEDil Oy C13118_STRADA-SQ-A-T_(XM-L2) Efficiency=94%
Lamps: 1 x Cree XM-L2 (XMLBWT-0-7B4*T30-0L-0001) 91lm @ 250mA CCT=3200K P=0.7W I=250mA

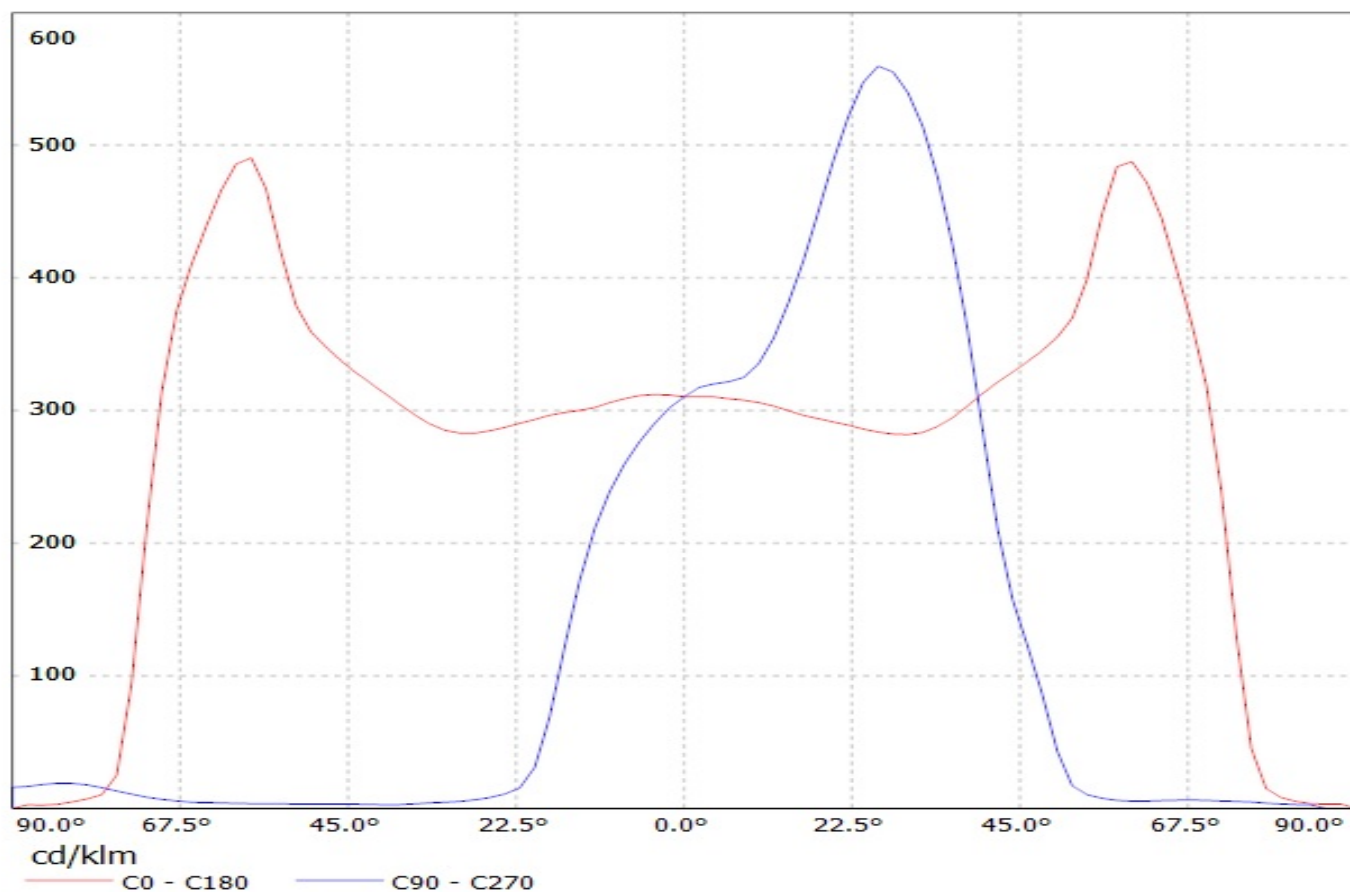

Luminaire: LEDiL Oy CA13119_STRADA-SQ-A-T_(LUXEON-MZ) Eff. 93%
Lamps: 1 x LUXEON-MZ_263.073lm@250mA_P=2.7399W_I=249.9mA

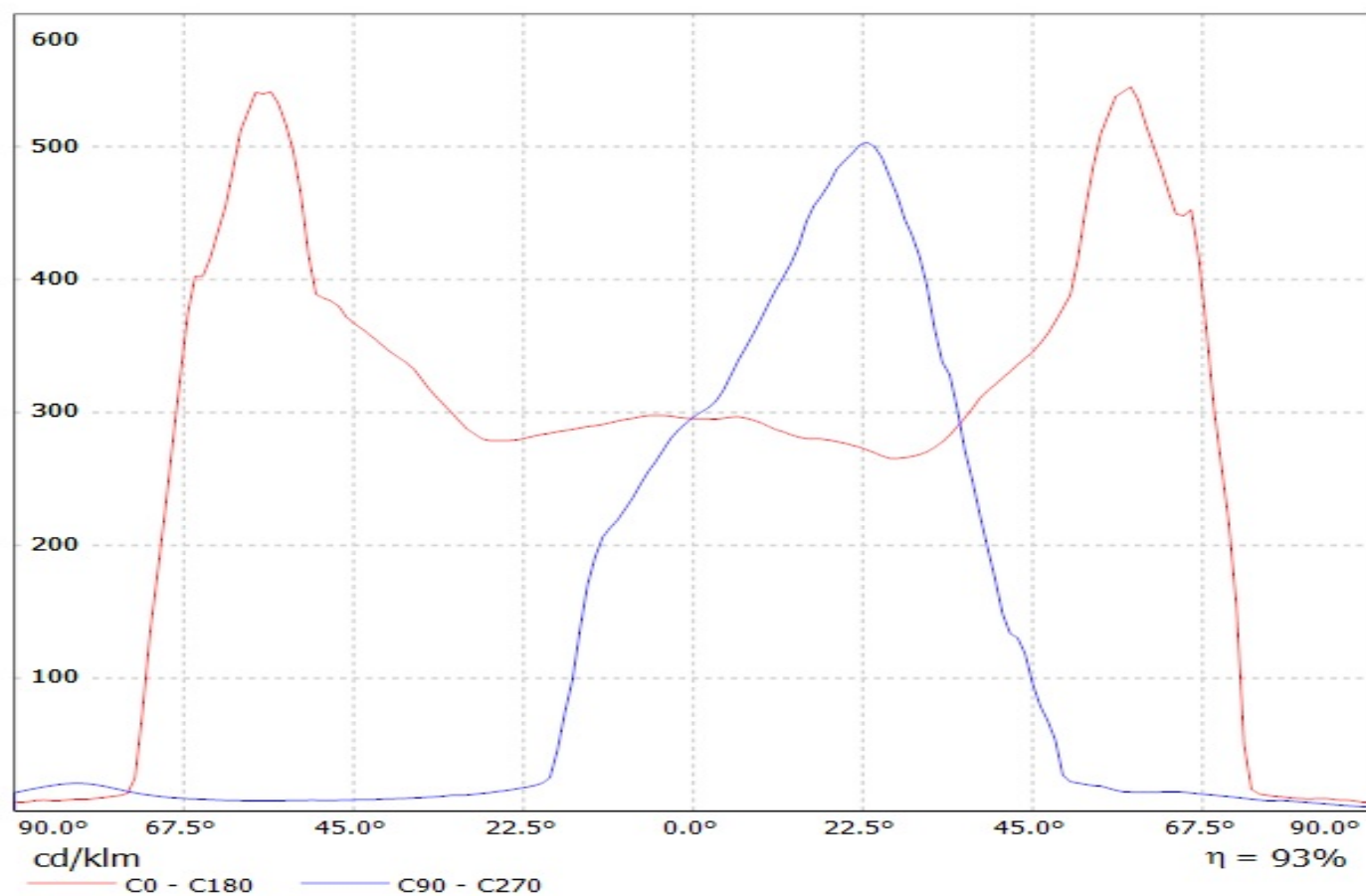

Luminaire: LEDiL Oy C13118_ & _CA13119_STRADA-SQ-A-T-XML (Cree XM-L 84lm@250mA) Efficiency=93%
Lamps: 1 x Cree XM-L (84lm@250mA)

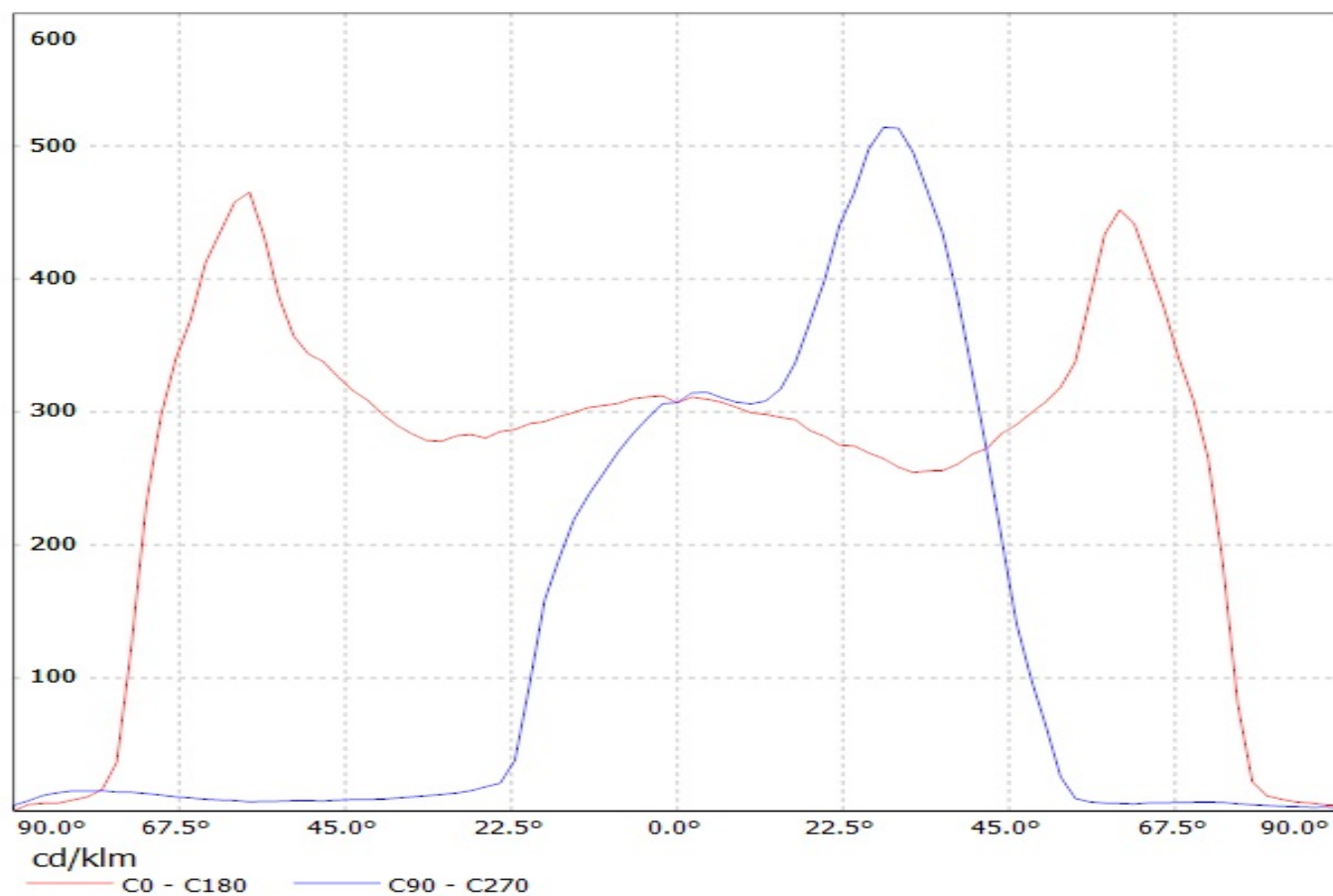

Luminaire: LEDiL Oy C13118_&_CA13119_STRADA-SQ-A-T-LuxM (Luxeon M 362lm @ 250mA) Efficiency=93%
Lamps: 1 x Luxeon M 362lm @ 250mA

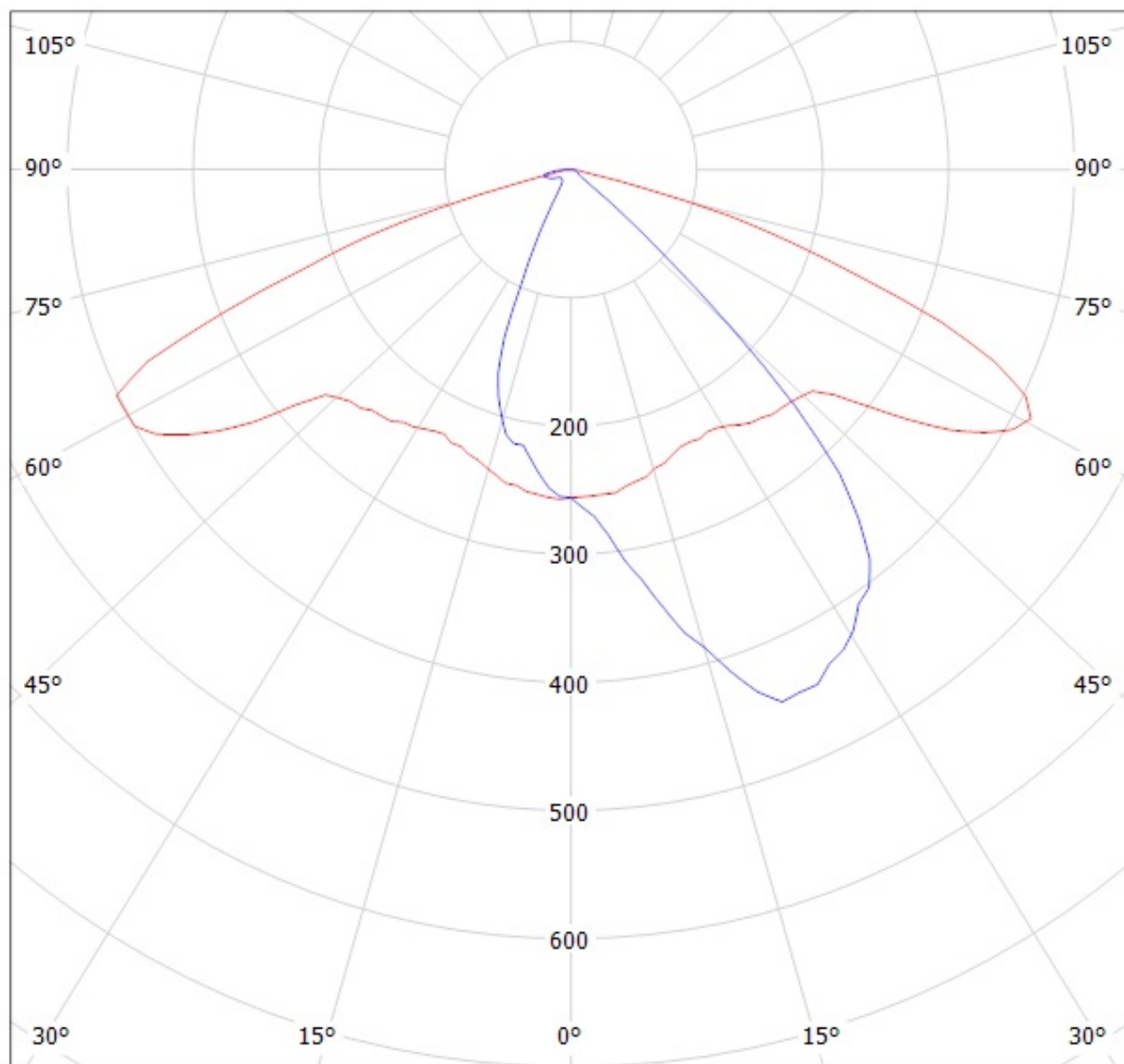

cd/klm

— C0 - C180

— C90 - C270

Luminaire: LEDil Oy C13118_STRADA-SQ-A-T_(XM-L2) Efficiency=94%

Lamps: 1 x Cree XM-L2 (XMLBWT-0-7B4*T30-0L-0001) 91lm @ 250mA CCT=3200K P=0.7W I=250mA

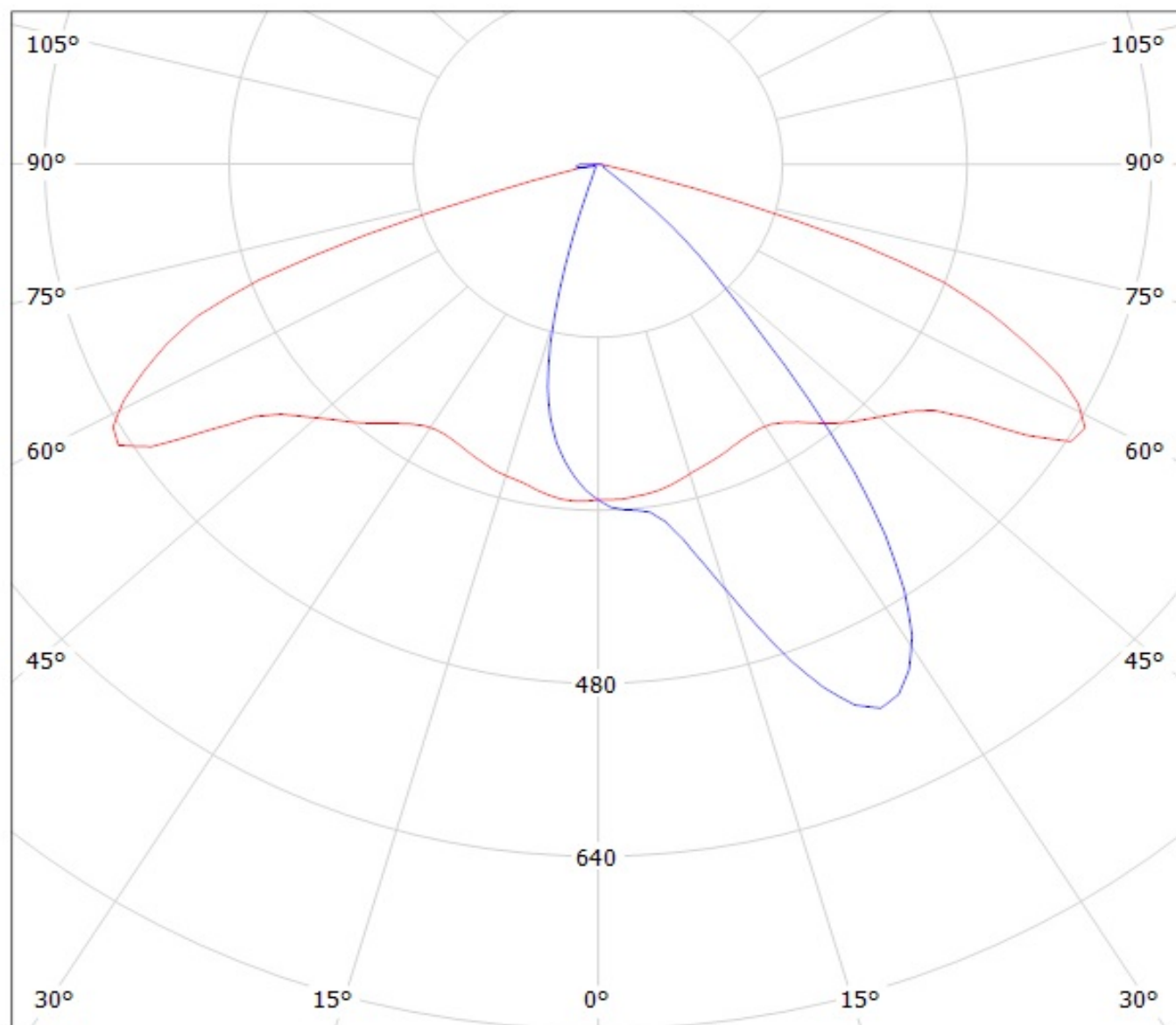

cd/klm

— C0 - C180

— C90 - C270

Luminaire: LEDiL Oy CA13119_STRADA-SQ-A-T_(LUXEON-MZ) Eff: 93%
Lamps: 1 x LUXEON-MZ_263.073lm@250mA_P=2.7399W_I=249.9mA

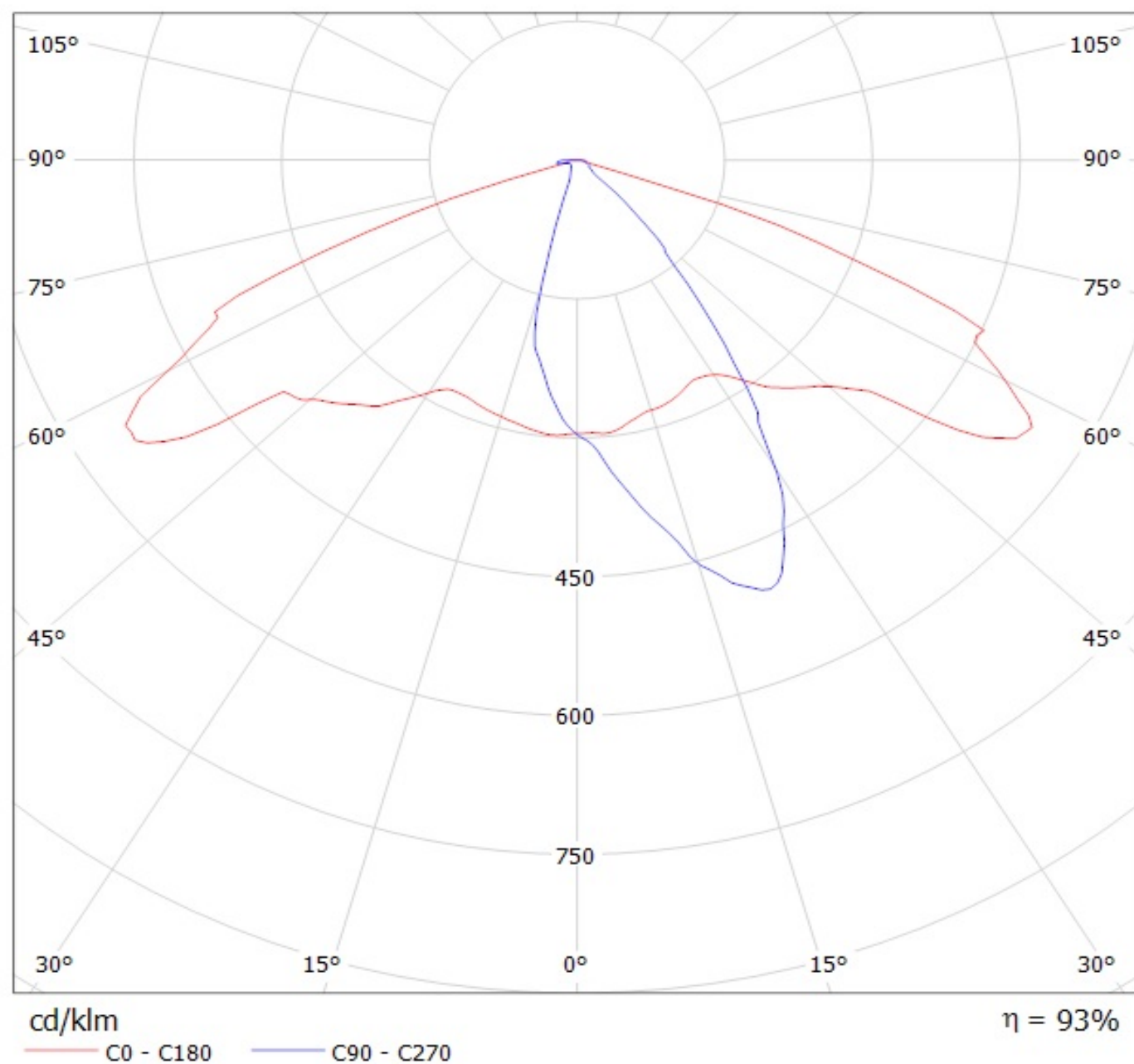

Luminaire: LEDiL Oy C13118_ & CA13119_STRADA-SQ-A-T-XML (Cree XM-L 84lm@250mA) Efficiency=93%
Lamps: 1 x Cree XM-L (84lm@250mA)

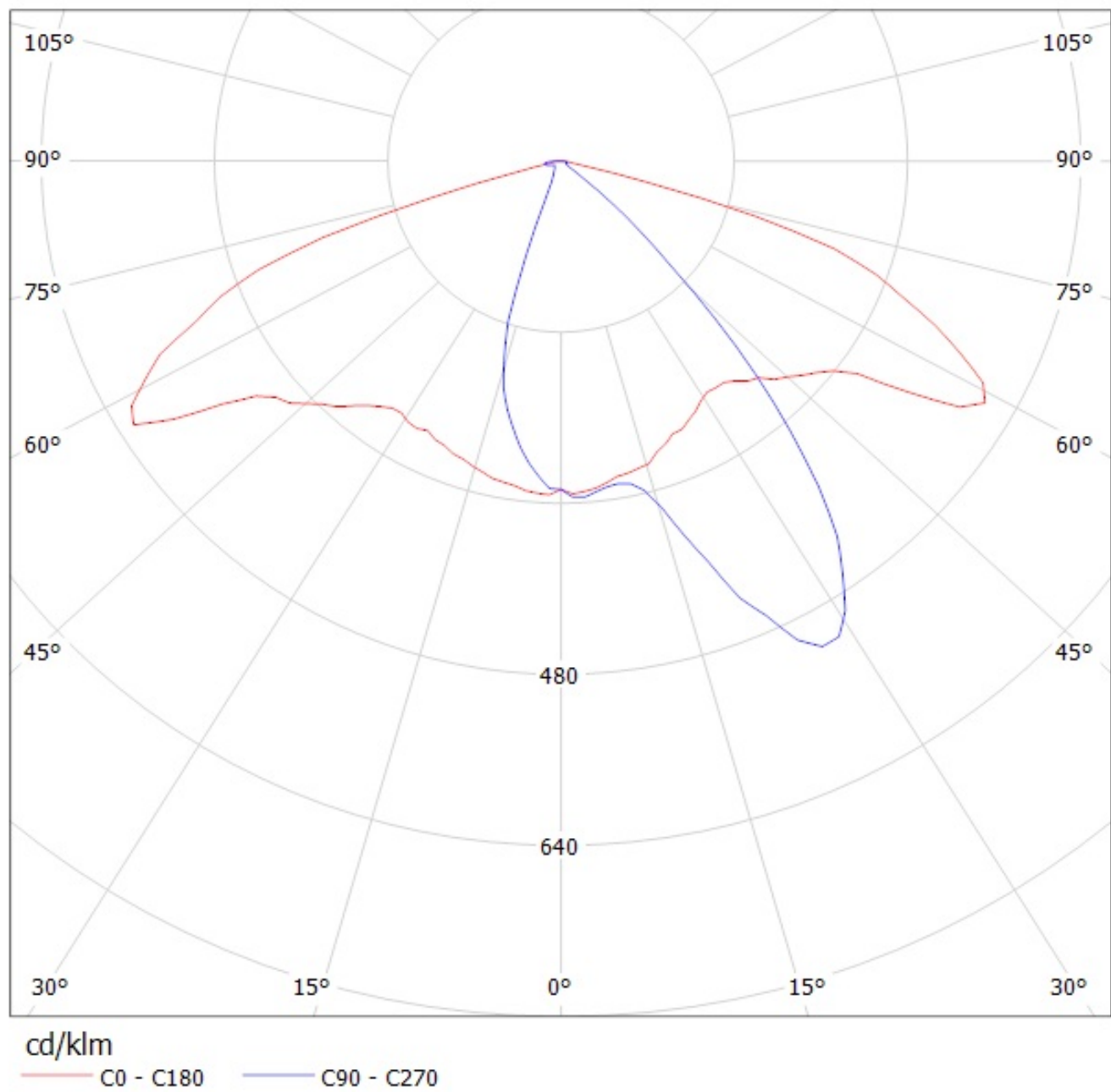

NOTE: The typical divergence will be changed by different color, chip size and chip position tolerance. The typical total divergence is the full angle measured where the luminous intensity is half of the peak value.