

TOP VIEW

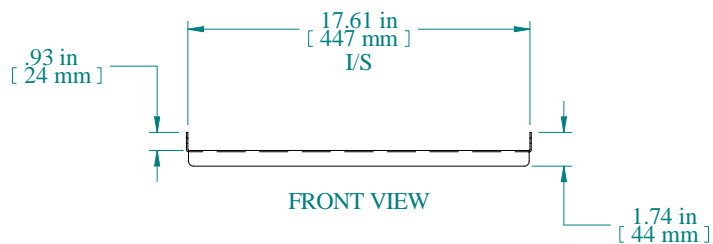

FRONT VIEW

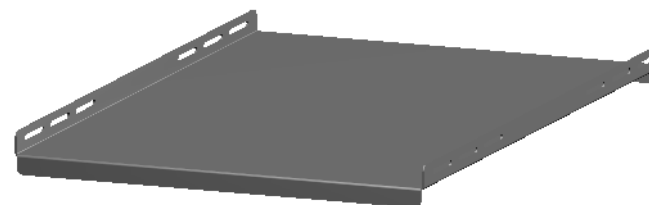
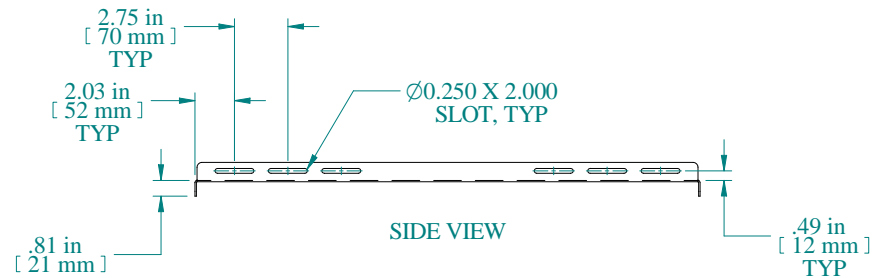

SIDE VIEW

PART NUMBERS

RFUS1926BK1	PAINTED BLACK TEXTURED
RFUS1926CG1	PAINTED GREY/BEIGE TEXTURED

NOTES

Maximum weight 350 lb
Includes all mounting hardware

Data subject to change without notice. Isometric drawing not to scale.



Mouser Electronics

Authorized Distributor

Click to View Pricing, Inventory, Delivery & Lifecycle Information:

Hammond:

[RFUS1926CG1](#) [RFUS1926BK1](#)