

JACK SCREWS

- Equivalent to AMP, CANNON & TRW Jack Screws • "D" subminiature connector mounting screw • Custom lengths available • Hardware supplied unassembled and in bulk

SPECIFICATIONS: **YELLOW:** Steel, Zinc Plate and Yellow Chromate; **CLEAR:** Steel, Zinc Plate and Clear Chromate; **STAINLESS:** Stainless Steel

STANDARD JACK SCREWS

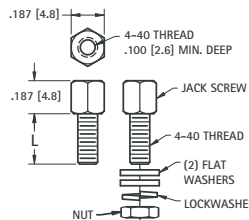

| JACK ONLY | | | L LENGTH | JACK WITH HARDWARE* | | |
|--------------------|-------------------|-----------------------|-------------|---------------------|-------------------|-----------------------|
| YELLOW CAT. NO. | CLEAR CAT. NO. | STAINLESS CAT. NO. | | YELLOW CAT. NO. | CLEAR CAT. NO. | STAINLESS CAT. NO. |
| 7228 | 7228-5 | 7248 | .250 (6.4) | 7229 | 7229-5 | 7249 |
| 7230 | 7230-5 | 7250 | .312 (7.9) | 7231 | 7231-5 | 7251 |
| 7241 | 7241-5 | 7252 | .375 (9.5) | 7242 | 7242-5 | 7253 |
| 7243 | 7243-5 | 7254 | .500 (12.7) | 7244 | 7244-5 | 7255 |
| 7232 | 7232-5 | 7256 | .625 (15.8) | 7233 | 7233-5 | 7257 |

*Hardware supplied unassembled in bulk

SEMS JACK SCREWS

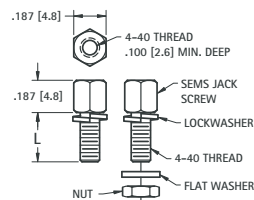

| SEMS JACK ONLY | | L LENGTH | SEMS JACK WITH HARDWARE* |
|-------------------|-----------------------|-------------|--------------------------|
| CLEAR CAT. NO. | STAINLESS CAT. NO. | | CLEAR CAT. NO. |
| 7235 | 7236 | .285 (7.3) | 7236 |
| 7237 | 7238 | .347 (8.8) | 7238 |
| 7239 | 7240 | .660 (16.8) | 7240 |

*Hardware supplied unassembled in bulk

SLOTTED JACK SCREWS

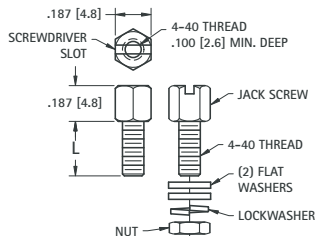

• Slot provides ability to install jack with a screwdriver.

| JACK ONLY | | | L LENGTH | JACK WITH HARDWARE* | |
|--------------------|-------------------|-----------------------|-------------|---------------------|-------------------|
| YELLOW CAT. NO. | CLEAR CAT. NO. | STAINLESS CAT. NO. | | YELLOW CAT. NO. | CLEAR CAT. NO. |
| 7270 | 7275 | 7290 | .250 (6.3) | 7290 | 7295 |
| 7271 | 7276 | 7291 | .312 (7.9) | 7291 | 7296 |
| 7272 | 7277 | 7292 | .375 (9.5) | 7292 | 7297 |
| 7273 | 7278 | 7293 | .500 (12.7) | 7293 | 7298 |
| 7274 | 7279 | 7294 | .625 (15.8) | 7294 | 7299 |

*Hardware supplied unassembled in bulk

JACK SCREWS WITH NYLON PATCH

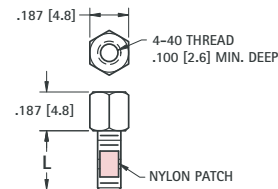

• Nylon patch holds jack firmly in vibration applications.

| JACK WITH NYLON PATCH | | | |
|-----------------------|-------------------|-----------------------|-------------|
| YELLOW CAT. NO. | CLEAR CAT. NO. | STAINLESS CAT. NO. | L LENGTH |
| 7260 | 7261 | 7262 | .250 (6.4) |
| 7263 | 7264 | 7265 | .312 (7.9) |
| 7266 | 7267 | 7268 | .375 (9.5) |

TURNABLE JACK SCREWS

DIRECT ACCESS

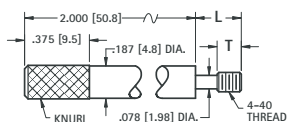

MATERIAL: Steel, Black Oxide

| WITHOUT SLOT CAT. NO. | WITH SLOT CAT. NO. | T DIM. | L DIM. |
|--------------------------|-----------------------|------------|-------------|
| 2064 | 2065 | .125 (3.2) | .250 (6.4) |
| 2066 | 2067 | .250 (6.4) | .437 (11.1) |

STRAIGHT KNURL

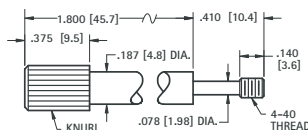

MATERIAL: Steel, Zinc Plate & Clear Chromate

| WITHOUT SLOT CAT. NO. | WITH SLOT CAT. NO. |
|--------------------------|-----------------------|
| 2072 | 2073 |

SLIM LINE

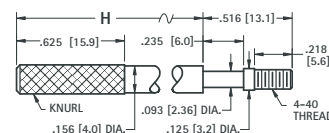

MATERIAL: Steel, Nickel Plate

| WITHOUT SLOT CAT. NO. | WITH SLOT CAT. NO. | H DIM. |
|--------------------------|-----------------------|--------------|
| 2068 | 2069 | 1.250 (31.8) |
| 2070 | 2071 | 1.750 (44.5) |

PANEL MOUNTING HARDWARE

"U" CLIP



Supplied Unassembled

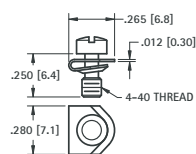

MATERIAL:
Clip & Screw: Steel, Zinc Plate & Yellow Chromate

CAT. NO. 2062

"BOW TIE" RETAINING CLIP



Supplied Unassembled

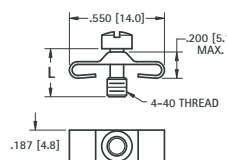

MATERIAL:
Clip & Screw: Steel, Zinc Plate & Yellow Chromate

| CAT. NO. | L |
|----------|------------|
| 2060 | .250 (6.4) |
| 2061 | .281 (7.1) |

SADDLE WASHER



Supplied Unassembled

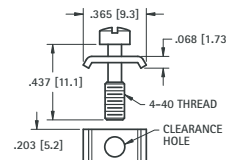

MATERIAL:
Clip & Screw: Steel, Zinc Plate & Yellow Chromate

CAT. NO. 2063