



## Type 360291

Single terminal block, solderable, horizontal wire entry, lift system, with molded housing, double solder pins, screw brought down by hand (transport safety)

### Technical Data

**RIA** V / A / AWG 50 / 15 / 22 - 14

**SP** V / A / AWG 50 / 15 / 22 - 14

Insulation co-ordination according to EN 60664-1

Tightening torque UL 4.4 lb-in max.

Solder pin dimension 2 x 1.0 mm

Recommended pc board hole dia. Ø 1.5 mm

Solder pin length 3.5 mm

## Type 360271

Single terminal block, solderable, horizontal wire entry, lift system, with molded housing, single solder pin, screw brought down by hand (transport safety)

### Technical Data

**RIA** V / A / AWG 50 / 15 / 24 - 16

**SP** V / A / AWG 50 / 15 / 24 - 14

Insulation co-ordination according to EN 60664-1

Tightening torque UL 4.4 lb-in max.

Solder pin dimension 1.2 mm

Recommended pc board hole dia. Ø 1.5 mm

Solder pin length 2.9 mm

Color black

Dimensions in mm

1 mm = 0.0394 in.

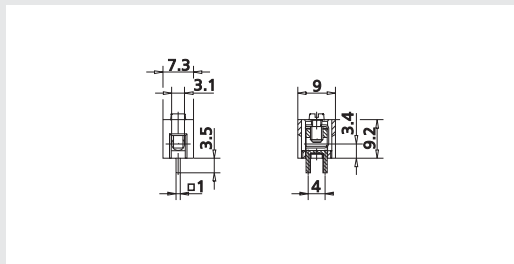

### Part numbers (P/N)

Type 360291

P/N 360291

Dimensions in mm

1 mm = 0.0394 in.

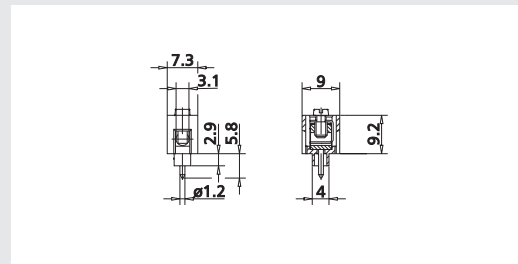

### Part numbers (P/N)

Type 360271

P/N 360271