

PRODUCT NUMBER  
10082201-YXX-XXLF

PLATING

1 = 0.76µm GOLD OR  
0.76µm GXT (PdNi WITH  
GOLD FLASH)  
ON CONTACT AREA  
2µm MATTE TIN ON TAIL

4 = 2µm MATTE TIN  
ON CONTACT AREA  
AND TAIL

8 = 0.38µm GOLD  
ON CONTACT AREA  
2µm MATTE TIN  
ON TAIL

RoHs COMPATIBLE, NOTE 7.

TOTAL NB OF POSITIONS  
02 TO 36

PACKAGING, NOTE 3.

| PIN STYLE | MATING SIDE | DIM "B" |
|-----------|-------------|---------|
| 01        | 5.84        | 2.50    |
| 02        | 6.75        | 2.50    |
| 03        | 5.84        | 3.00    |
| 04        | 6.75        | 3.00    |
| 05        | 11.60       | 3.00    |
| 06        | 9.50        | 4.30    |
| 07        | 8.07        | 3.00    |

NOTES:

- HOUSING MAT'L : HIGH TEMPERATURE THERMOPLASTIC. UL94V-0 COLOR: BLACK
- PIN MATERIAL : PHOSPHOR BRONZE
- PACKAGING.
  - = POLY BAGS
  - A = TAPE & REEL WITH CAP, AS AVAILABLE
  - K = TAPE & REEL WITHOUT PICK UP CAP, AS AVAILABLE
- 9N MIN RETENTION IN EITHER DIRECTION
- TO DETERMINE DIMENSIONS :  
N = NUMBER OF POSITIONS PER ROW  
EXAMPLE : 8 POS N x 2.54 = 20.32mm
- UNDERPLATING : 1.27µm Ni MIN
- RoHS COMPATIBLE PRODUCT SPECIFICATIONS

a - PLATING:

- "LF" MEANS THE PRODUCT IS LEAD-FREE,  
2µm MINIMUM MATTE TIN OVER 1.27µm  
MINIMUM NICKEL UNDERPLATE.

b - MANUFACTURING PROCESS COMPATIBILITY

- THE HOUSING WILL WITHSTAND EXPOSURE TO  
260°C PEAK TEMPERATURE FOR 30 SECONDES  
IN A CONVECTION, INFRA-RED OR VAPOR  
PHASE REFLOW OVEN.

c - LABELING:

- MEETS PACKAGING SPECS AS PER GS-14-920

d - LEGAL STATEMENT: SEE GS-47-0004

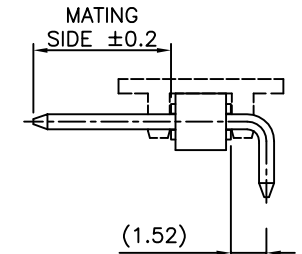
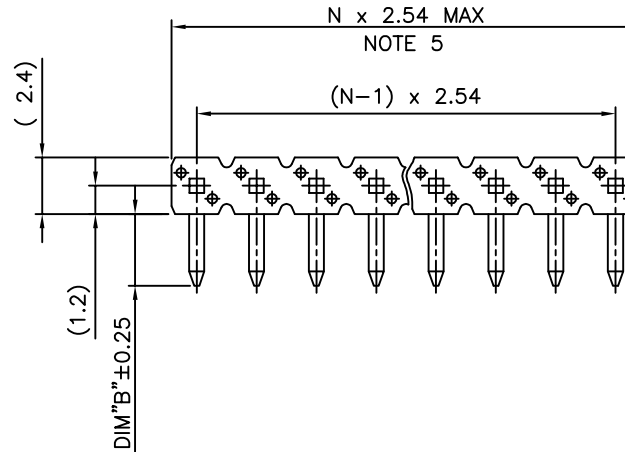
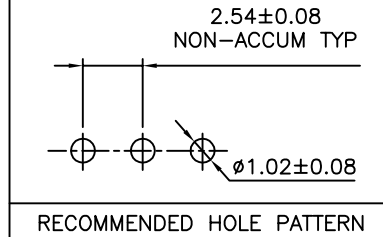
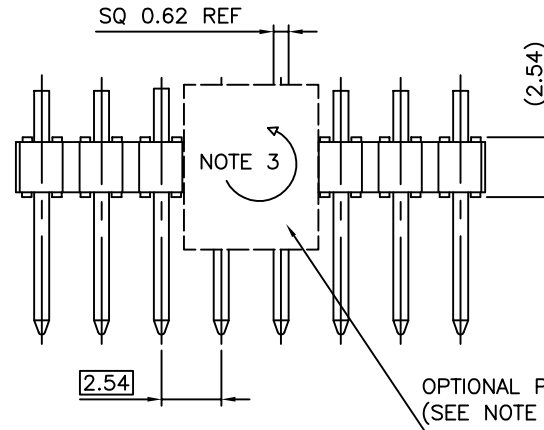

|                          |                |                     |                               |                                       |                                    |
|--------------------------|----------------|---------------------|-------------------------------|---------------------------------------|------------------------------------|
| mat'l. code<br>SEE NOTES |                | surface<br>ISO 1302 | tolerance<br>ISO 406 ISO 1101 | projection                            | product family<br>BERGSTIK         |
| ltr                      | ecn no         | dr                  | date                          | tolerances unless otherwise specified | title                              |
| A                        | F08-0104       | LMU                 | 08.01.15                      | angles                                | UNSHR.HEADER<br>RA SR PIN IN PASTE |
| B                        | F09-0072       | JCO                 | 09.07.23                      | linear                                |                                    |
| C                        | F12-0032       | LMU                 | 12.05.04                      | .X ±0.3<br>.XX ±0.15<br>.XXX ±0.05    | scale 5:1                          |
| D                        | B-18990        | LMU                 | 14.10.06                      | dr                                    | L.MULIN 08.01.15                   |
| E                        | B-20031        | AMA                 | 15.01.20                      | engr                                  | J.COMPAGNON 08.01.15               |
| F                        | F-23188        | AMA                 | 16.02.01                      | chr                                   |                                    |
|                          |                |                     |                               | appd                                  | J.M.C 08.01.15                     |
| sheet index              | revision sheet |                     |                               |                                       | type CUSTOMER Drawing              |