



**GUARDIAN**  
Electric Manufacturing

**ISO 9001 / AS9100 Certified Company**

Woodstock, IL 60098 Ph. (815)334-3600 Fax (815)337-0377

Or visit us at our website [www.guardian-electric.com](http://www.guardian-electric.com)

## Model LT12 x 19 Long-Life DC Tubular Solenoid

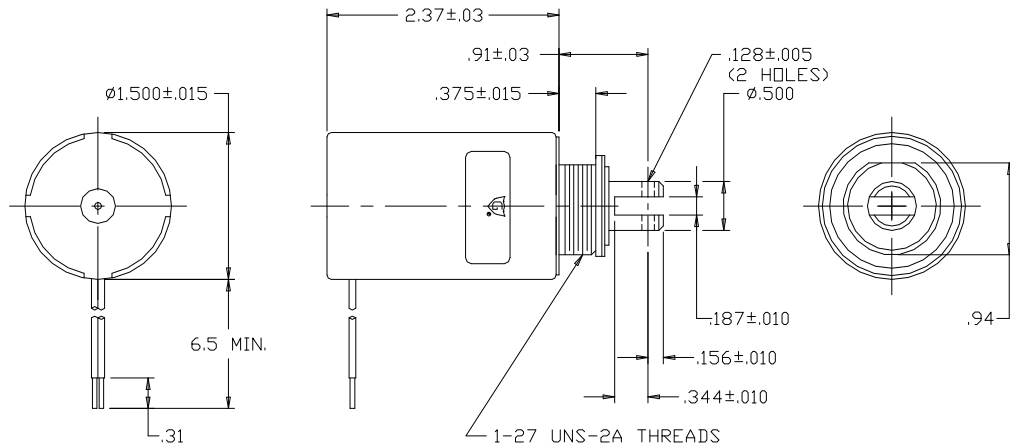

Solenoid shown energized and fully seated.

Supplied with mounting bracket, hex nut and lockwasher (not shown).

Spring kits are available (consult factory).

Total Weight: 14.6 oz.

Plunger Weight: 2.2 oz.

Model No.	Part No.	Duty Cycle	Voltage	Resistance (Ω)	Power (W)	Current
LT12x19-I-12	A420-064867-00	Intermittent	12VDC	4.6	32.4	2.58 A
LT12x19-C-12	A420-064866-00	Continuous	12VDC	14.8	10.2	811 mA
LT12x19-I-24	A420-064869-00	Intermittent	24VDC	18.6	32.5	1.29 A
LT12x19-C-24	A420-064868-00	Continuous	24VDC	71.8	8.4	334 mA

When ordering, please refer to Part No., as listed above.

Consult factory for custom configurations.

Pull Force (oz.)									Holding Force (oz.)
Stroke (in.)	0.050	0.125	0.250	0.375	0.500	0.625	0.750	1.000	-
Continuous Duty	110	70	32	20	15	8	5	3	139
Intermittent Duty	170	140	97	75	45	35	20	10	160

### UL Recognition

Recognized under the   
Component Recognition Program of  
**Underwriters Laboratories, Inc.**

### Continuous Duty

100% 'On' Time

### Intermittent Duty

25% 'On' Time, (100 Seconds 'On' Max.  
Followed By 300 Seconds 'Off' Min.)

### RoHS

These parts comply with **RoHS** Directive 2002/95/EC