

Major League Electronics .100 cl Surface Mount Box Contact - Vertical

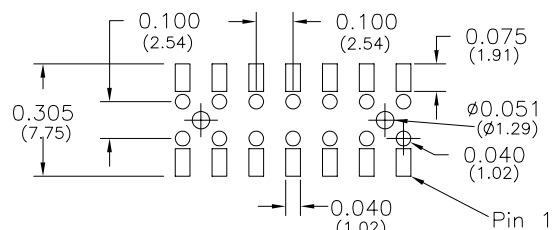

Recommended P.C. Board layout

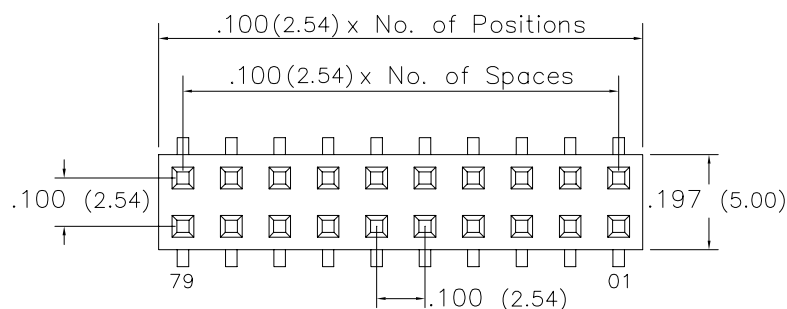
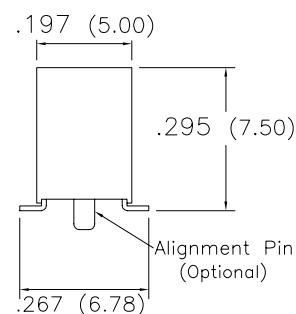
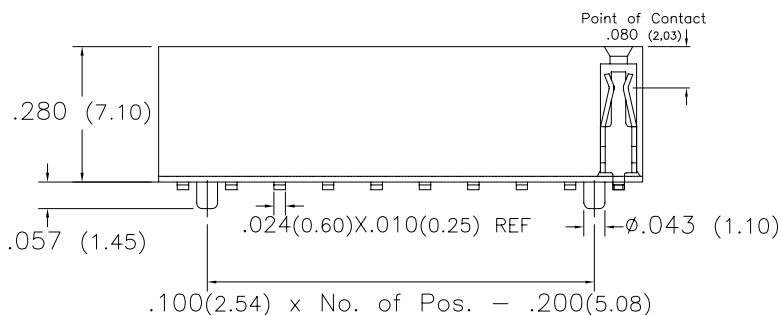

Tails may be clipped to achieve desired pin length

Ordering Information

SMBC-1 - D - 02 - - V - - - - - - LF

Pins Per Row
01 - 40

Row Specification
D = Dual Row

Surface Mount

Lead Free

AP - Alignment Pin
Leave blank if not needed

Plating Options	
30μ Gold on Contact Area / Matte Tin on Tail	H
Matte Tin all Over	T
10μ Gold on Contact Area / Matte Tin on Tail	GT
10μ Gold on Contact Area / Flash on Tail	G
Gold Flash over Entire Pin	F

Packing Information

TR-P = Tape and Reel with Plastic Pick and Place pad

TB-P = Tube with Plastic Pick and Place pad

TB-0 = Tube without Pick and Place Pad

If left blank, packaging at MLE's discretion
Pad may be metal, mylar or plastic

Polarized Position

Leave blank if not needed

If required, specify empty pin position, e.g. 012 for Pin 12

Vertical

Specifications

Insertion Depth: .145 (3,68) to .250 (6,35)

Insertion Force - Per Contact - H Plating:

5oz. (1,39N) avg with .025 (0,64mm) sq. pin

Withdrawal Force - Per Contact - H Plating:

3oz. (0,83N) avg with .025 (0,64mm) sq. pin

Current Rating: 3.0 Ampere

Insulation Resistance: 1000MΩ Min.

Dielectric Withstanding: 600V AC

Contact Resistance: 20 mΩ Max.

Operating Temperature: -40°C to + 105°C

Max. Process Temperature:

Peak: 260°C up to 20 secs.

Process: 230°C up to 60 secs.

Wave: 260°C up to 6 secs.

Reflow: 260°C up to 10 secs.

Manual Solder: 350°C up to 5 secs.

Materials

Contact Material: Phosphor Bronze

Insulator Material: Nylon 6T

Plating: Au or Sn over 50μ" (1,27) Ni

Products cut to specific sizes are uncancellable/nonreturnable

Parts are subject to change without notice

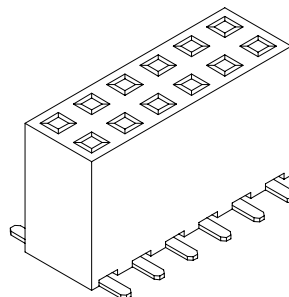

Mates with:

BSTC, TSHCR,
BSTCM, TSHCRE,
BSTCR, TSHCRSM,
BSTCRSM, TSHR,
BSTS, TSHRE,
LBSTCM, TSHS,
LTSHCR, TSHSCM,
LTSHCRE, TSHSM,
LTSHR, ULTSHSM,
LTSHRE, ULTSHC,
LTSHSM, ULTSHCR
TSHC,

SMBC-1-DV SERIES

.100 cl Dual Row
Surface Mount Box Contact - Vertical

29 JAN 07

Scale
NTS

UNLESS OTHERWISE SPECIFIED
DIMENSIONS IN INCHES (MM)
TOLERANCES ARE:

ONE PLACE DECIMALS ±.100
TWO PLACE DECIMALS ±.010
THREE PLACE DECIMALS ±.005
FOUR PLACE DECIMALS ±.0020

ANGLES
±5°



4235 Earnings Way, New Albany, Indiana, 47150, USA

1-800-782-3486 (USA/Canada/Mexico)

Tel: 812-944-7244

Fax: 812-944-7268

E-mail: mle@mlelectronics.com

Web: www.mlelectronics.com

Edition
1

Sheet
1/1