



### Ceramic Double Row Terminal Blocks

#### TYPE 338 (-F)

Single poles

Inventory Check



RoHS WEEE Pb free surface compliant

#### Description

These terminal blocks consist of a steatite base and of groove screw terminals. The grooves permit simple connection without special preparation of the conductors.

Recommended mounting hardware: M3 pan head screw (#6-32 pan head screw)

- Ceramic Double Row Terminal Block
- Medium Duty
- With Clamping Screws
- With Mounting Holes
- With Spring Washers and Plain Washers

#### Technical Data

##### Nominal Cross Section:

4 mm<sup>2</sup> (6199 mils<sup>2</sup>)

**Wire Stripping Length:** 10 mm (0.39 in.)

(maximum load at 40°C (104°F) ambient temperature)

**Recommended operating**

**Voltage:** 400 V

**Recommended operating**

**Current:** 34A

**Recommended operating Wire**

**Range:** 18-12 AWG

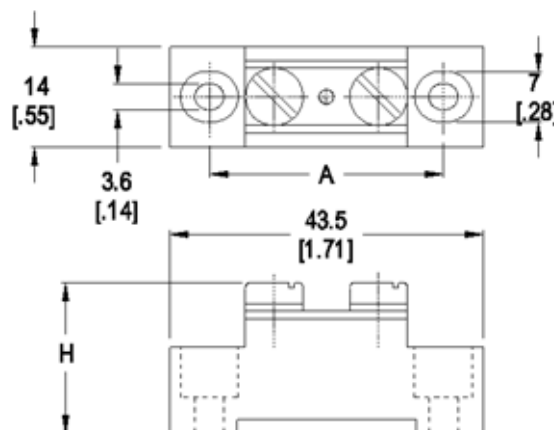

**Dimensions: mm (in.)**

H = 19.0 (0.75)

A = 32.5 (1.28)

(version F):

H = 21.0 (0.83)

A = 32.5 (1.28)

**When locating connector, allow 0.5 mm clearance around it for process-induced variations.**

#### Approval Information

##### Screw Tightening Torque:

10.0

#### Material

**Molding:** Steatite KER 220, DIN 40685, color white

**Temperature upper limit:** 200°C (392°F)

**Terminal Body:** Nickel plated brass

**Screw:** M4, Zinc plated blue passivated, steel substrate

**Item** 338 (-F)

#### Options

- ☐ G05: Gold Plating (5 micro inches)
- ☐ G30: Gold Plating (30 micro inches)
- ☐ S30: Silver Plating (30 micro inches)

**Ordering Note:** Plated component: terminal body

#### Accessories

SPRING WASHERS (DIN 127) AND PLAIN WASHERS:  
with: - F

338