

PRODUCT NUMBER

71600-YXXLF

- LEAD FREE, SEE NOTE 6
- TOTAL NB OF POSITION 04 TO 64 SEE SHEET 2
- OPTIONAL STRAIN RELIEF SEE SHEET 2

TRIANGLE INDICATES POSITION 1  
NOTE 5

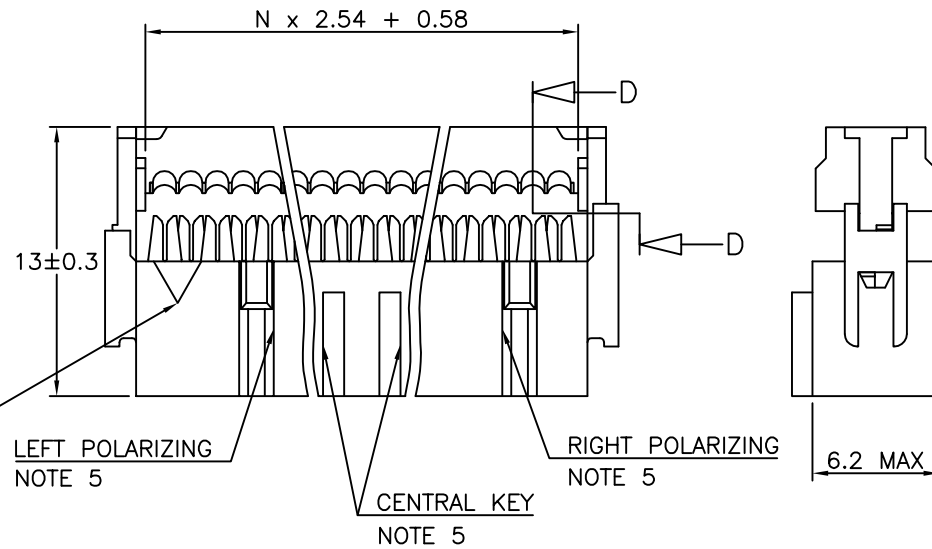

NOTES:

- 1 - PLASTIC MAT'L : GLASS FILLED HIGH TEMPERATURE THERMOPLASTIC. UL94V-0 COLOR: GREY
- 2 - PIN MATERIAL : PHOSPHOR BRONZE
- 3 - PRODUCT PACKAGED IN TUBES.
- 4 - TO DETERMINE DIMENSIONS :  
N = NUMBER OF POSITIONS PER ROW  
EXAMPLE : 8 POS N x 2.54 = 20.32mm
- 5 - 2x5, 2x6, 2x7 HAVE NO LEFT POLARIZING SLOT.  
- 2x2, 2x3 WITH CENTRAL KEY HAVE NO TRIANGLE, NO LEFT AND RIGHT POLARIZING SLOT.  
- 2x2 WITHOUT CENTRAL KEY HAS NO LEFT AND RIGHT POLARIZING SLOT.  
- 2x3, 2x4 WITHOUT CENTRAL KEY HAVE NO LEFT POLARIZING SLOT  
- 2x4 WITH CENTRAL KEY HAVE NO LEFT AND RIGHT POLARIZING SLOT
- 6 - THIS PRODUCT MEETS EUROPEAN UNION DIRECTIVES AND OTHER COUNTRY REGULATIONS AS PER GS-22-008.  
PACKAGING SPECIFICATION AS PER GS-14-920.

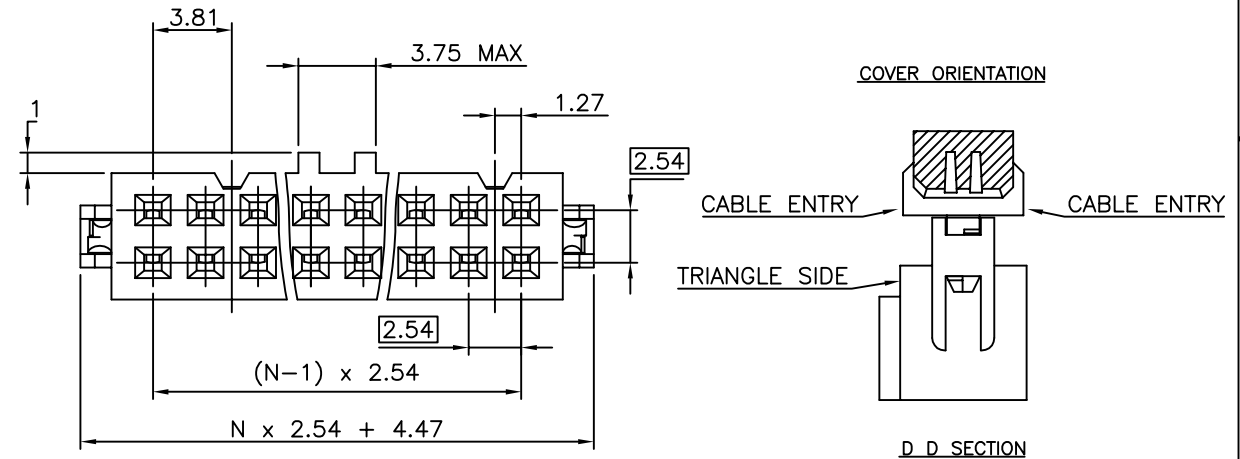

mat'l. code SEE NOTES		surface ISO 1302	tolerance ISO 406 ISO 1101	projection	product family 2.54MM IDC
ltr	ecn no	dr	date	tolerances unless otherwise specified	title
AP	F12-0046	LMU	12.04.25	angles X.X ±0.3	QUICKIE III FEM 0.76µm Au
AR	B-17851	LMU	14.06.05	linear X.XX ±0.13 X.XXX ±0.05	
AK	F05-0180	LMU	05.04.22	dr	D.LE 01.01.24
AL	F06-0270	LMU	06.09.12	engr	P.NZ 01.01.24
AM	F06-0274	LMU	06.09.25	chr	JF.N 01.01.24
AN	F09-0233	LMU	09.12.15	appd	P.NZ 01.01.24
sheet	revision	AR	AF		
index	sheet	1	2		

sheet 1 of 2  
71600  
CUSTOMER Drawing

STRAIN RELIEF OPTION AVAILABILITY	Nbr OF POSITIONS
1/6	04
0/1/2/3/6	06
0/1/2/3/6	08
0/1/2/3/6	10
0/1/2/3/6	14
0/1/2/3/6	16
0/1/2/3/6	18
0/1/2/3/6	20
0/1/3	24
0/1/2/3/6	26
0/1/2/3/6	30
0/1/2/3/6	34
0/1/2/3/6	40
0/1/2/3/6	50
0/1/2/3/6	60
0/1/2/3/6	64

624
304
204 / 224
004
DASHES NOT AVAILABLE

PLATING  
0.76µm GOLD ON CONTACT AREA  
1.27 µm Ni REMAINDER OF PRODUCT

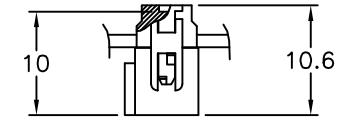

WITHOUT STRAIN RELIEF

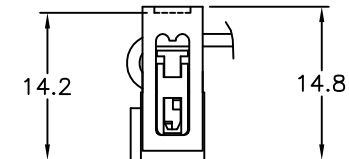

WITH LOW PROFILE STRAIN RELIEF

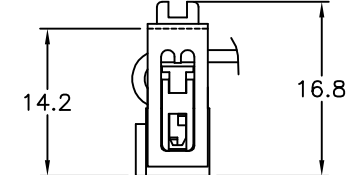

WITH STANDARD STRAIN RELIEF

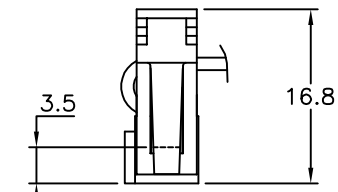

WITH LATCHING STRAIN RELIEF

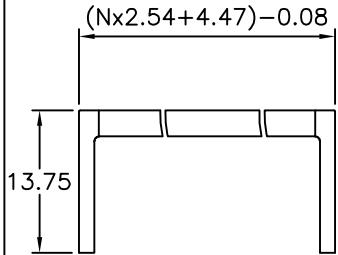

LOW PROFILE STRAIN RELIEF

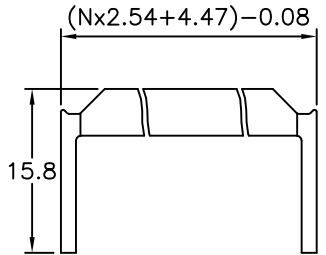

STANDARD STRAIN RELIEF

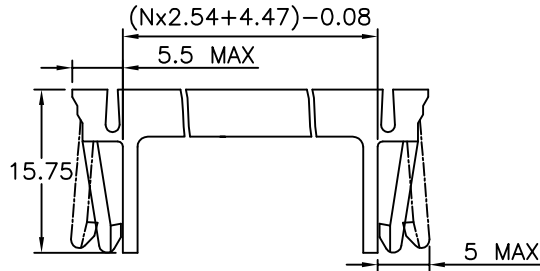

LATCHING STRAIN RELIEF FOR SLIM HEADER

PRODUCT NUMBER	WITH CENTRAL KEY	WITHOUT CENTRAL KEY	STANDARD STRAIN RELIEF	WITHOUT STRAIN RELIEF	LOW PROFILE STRAIN RELIEF	LATCHING STRAIN RELIEF
71600-6YYLF	●					●
71600-3YYLF		●	●			
71600-2YYLF	●				●	
71600-1YYLF	●				●	
71600-0YYLF	●		●			

mat'l. code		surface		tolerance		projection		product family	
		ISO 1302		ISO 406 ISO 1101		mm		QUICKIE	
ltr ecn no dr date		tolerances unless otherwise specified				title		IDC RECEPT DR	
AF B-17851 LMU 14.06.05		angles linear				scale N/A		sheet 2 of - size	
AA F10199 GCO 01.04.26						FCJ		71600 A3	
AB F03019 DLE 03.01.23 dr D.LE 01.01.24								type CUSTOMER Drawing	
AC F05-0180 LMU 05.04.22 engr P.NZ 01.01.24									
AD F06-0270 LMU 06.09.12 chr JF.N 01.01.24									
AE F06-0274 LMU 06.09.25 appd P.NZ 01.01.24									
sheet revision									
index sheet									

Copyright FCJ  
 FCconnect.com