

SMA MALE CONN.  
PER MIL-STD-348  
FIGURE 310-1

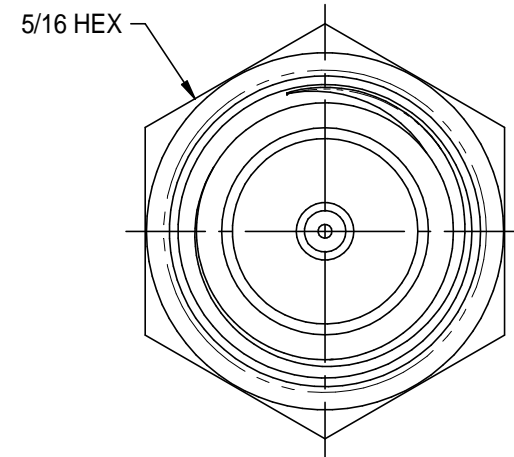

NOTES: UNLESS OTHERWISE SPECIFIED.

1. SPECIFICATIONS:

- 1.1 FREQUENCY RANGE: DC - 18.0 GHz
- 1.2 VSWR (MAX): 1.15:1
- 1.3 INPUT POWER: 1 WATT AVGERAGE, 100 WATTS PEAK
- 1.4 IMPEDANCE: 50 OHMS
- 1.5 WEIGHT: .25 OZ MAX.

2. MATERIALS AND FINISH:

HOUSING & COUPLING NUT: GOLD PLATED STAINLESS STEEL  
CENTER CONTACT: GOLD PLATED BERYLLIUM COPPER  
DIELECTRIC: PTFE (TEFLON)

<p>EMERSON Network Power Connectivity Solutions</p> <p><small>This PROPRIETARY Document is property of Emerson Network Power. Connectivity Solutions. It is confidential in nature, non-transferable, and issued with the clear understanding that it is not traced or copied without permission and is returnable upon demand.</small></p> <p><small>INTERPRET DRAWING IN ACCORDANCE WITH ASME Y14.5-2009.</small></p>	<p>3RD ANGLE PROJECTION</p> <p>RoHS <input checked="" type="checkbox"/></p> <p>2002/95/EC</p> <p>UNLESS OTHERWISE SPECIFIED UNITS: INCH</p> <p>.XX ±.02 .XXX ±.005 ANGLES ±2°</p>	<p><b>Midwest Microwave</b></p> <p>Title: TERMINATION</p>		
		Model No.	M39030/3-11(N OR S)	
Size A	DO NOT SCALE DRAWING	Date: 5/22/2013	Sheet 1 of 1	