



# Power Choke – L0451-AL

For ON Semiconductor  
MC33163 & MC34163

The L0451-AL is specified by ON Semiconductor for use with their MC33163 and MC34163 power switching regulators. This choke features a 10% inductance tolerance and 100 Vrms isolation from winding to core.

Request free evaluation samples by contacting Coilcraft or visiting [www.coilcraft.com](http://www.coilcraft.com).

Part number	Inductance $\pm 10\%^1$ ( $\mu\text{H}$ )	DCR max (Ohms)	SRF typ <sup>2</sup> (MHz)	Isat <sup>3</sup> (A)	Irms <sup>4</sup> (A)
L0451-AL	180	0.052	3.2	14	7

1. Inductance measured at 1 kHz, 0.1 Vrms, 0 Adc using an Agilent/HP 4192A impedance analyzer.
2. SRF measured on an Agilent/HP 8753D network analyzer.
3. DC current at which the inductance drops 10% (typ) from its value without current.
4. Average current for a 40°C rise above 25°C ambient.
5. Operating temperature range -40°C to +85°C.
6. Electrical specifications at 25°C.

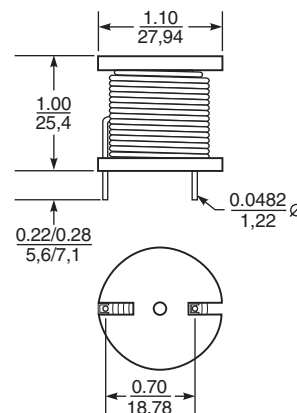

## Recommended Board Layout

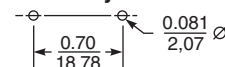

**Weight:** 49 g  
**Terminations:** Tin-silver over copper  
**Packaging:** 49 parts per tray

**Coilcraft**®

Specifications subject to change without notice.  
Please check our website for latest information.

Document 573 Revised 08/29/06

1102 Silver Lake Road Cary, Illinois 60013 Phone 847/639-6400 Fax 847/639-1469

E-mail [info@coilcraft.com](mailto:info@coilcraft.com) Web <http://www.coilcraft.com>