

Fuseholders 5 x 20 mm



- ▶ 5 x 20mm fuses
- ▶ Finger and tool release
- ▶ PC2 protection category
- ▶ Solder & 2.8mm terminals
- ▶ Proud & low profile bezels
- ▶ Snap to panel and screw fixing



6.3A 250Vac (max fuse rating*) T-55 to T+70 (ambient)
Maximum dissipation wattage: 1.5W



6.3A UL 94V2 UL file E92075 CSA file LR44770

RoHS

RoHS compliant

These products comply with safety category PC2.

*Users should be aware of the de-rating factors published by specialist manufacturers of fuses.

These fuseholders are fitted with combination (solder / 2.8) mid-body terminals. It has not been possible to show both views here.



ORDER FORMAT

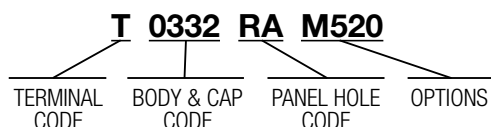

M520
Terminal Cover



A0033 00
In-line 5 x 20 fuseholder
Call factory for rating details

▶ TERMINAL

T

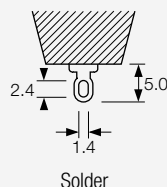

B

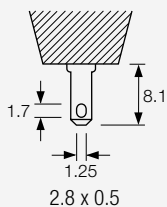

▶ BODY AND CAP

0332

Finger release



0333

Tool release



0340

Tool release



0341

Tool release



▶ PANEL HOLE

RA

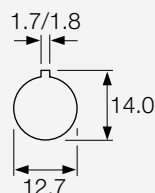

RD

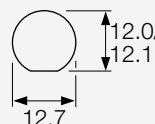

DIMENSIONS (mm)

0332 (T terminal shown)

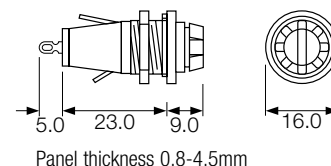

0333 (T terminal shown)

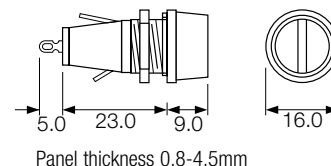

0340 (T terminal shown)

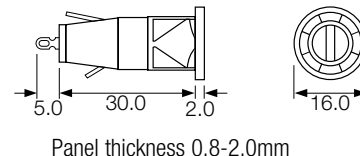

0341 (T terminal shown)

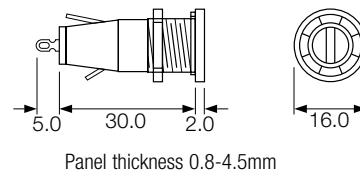

Fuseholders 6.3 x 32mm (1 1/4" x 1/4")



16A 250Vac (max fuse rating*) T-55 to T+70 (ambient)
Maximum dissipation wattage: 2.5W



16A UL 94V2 UL file E92075 CSA file LR44770

RoHS

RoHS compliant

These products comply with safety category PC2.

*Users should be aware of the de-rating factors published by specialist manufacturers of fuses.

Fuseholders with in-line termination have combination (4.8/6.3) terminals. It has not been possible to show both views here. Units with right angle terminals have user specified end terminals and combination mid-body terminals.

- ▶ 6.3 x 32mm fuses
- ▶ Tool release
- ▶ PC2 protection category
- ▶ 4.8, 6.3 and solder terminals
- ▶ Low profile bezel
- ▶ Snap to panel and screw fixing



ORDER FORMAT

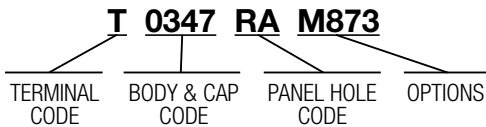

M873

Cover for C & T terminals



A0035 00

In-line 6.3 x 32 (1 1/4 x 1/4) fuseholder
 Call factory for rating details

▶ TERMINAL

C

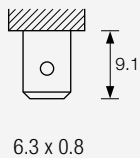

6.3 x 0.8

D

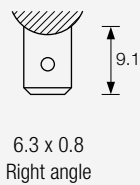

6.3 x 0.8
Right angle

T

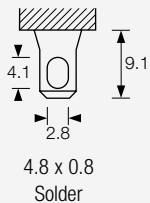

4.8 x 0.8
Solder

U

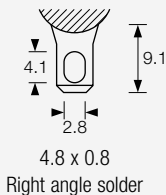

4.8 x 0.8
Right angle solder

▶ BODY AND CAP

0345 (C terminal shown)



0345 (D terminal shown)



0347 (T terminal shown)



0347 (U terminal shown)



▶ PANEL HOLE

RA

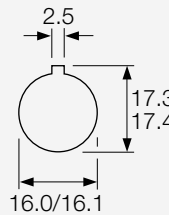

Panel thickness
 0.8 - 2.0mm for snap-in
 0.8 - 4.5mm for nut fixing

RD

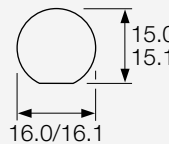

Panel thickness
 0.8 - 2.0mm for snap-in
 0.8 - 4.5mm for nut fixing

DIMENSIONS (mm)

0345 (C terminal shown)

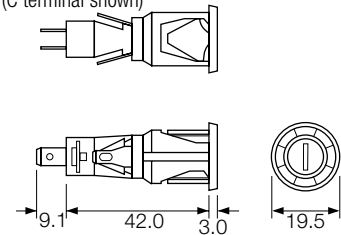

0345 (D terminal shown)

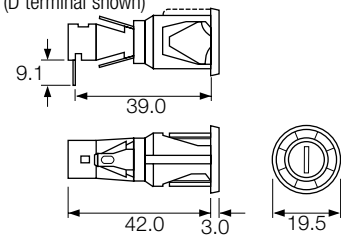

0347 (C terminal shown)

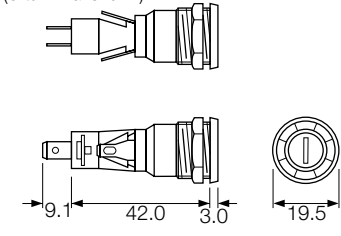

0347 (D terminal shown)

